

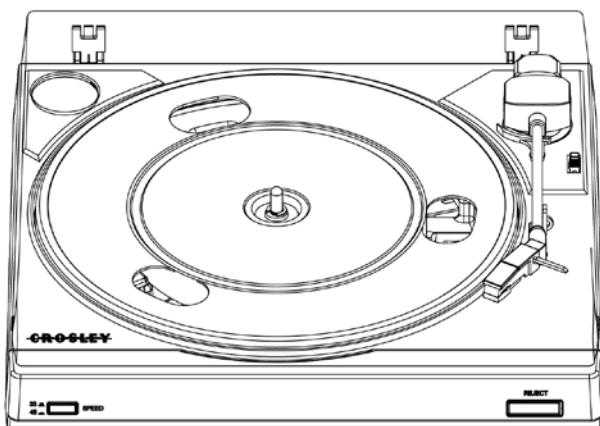

T200A
T200 Turntable
Instruction Manual



Questions, problems, missing parts?
Before returning to the store, call Customer Service
8 a.m. – 6 p.m., EST, Monday – Friday
1-888-CROSLEY
www.crosleyradio.com

Safety Instructions

Read and understand this entire manual before using this product. Keep these instructions for future reference.

1. Do not use this product near water.
2. This product should be operated only by the type of power source indicated on the marking label or in this instruction manual.
3. Do not defeat the safety purpose of the polarized plug. A polarized plug has two blades with one blade wider than the other. This plug will fit into the power outlet only one way. If you are unable to insert the plug fully into the outlet try reversing the plug. If the plug should still fail to fit, contact your electrician.
4. Protect the power cord from being walked on or pinched particularly at plugs, convenience receptacles, and the point where they exit from the product.
5. Do not overload wall outlets, extension cords, or integral convenience receptacles as this can result in a risk of fire or electric shock.
6. Never push objects of any kind into this product through openings as they may touch dangerous voltage points or short-out parts that could result in a fire or electric shock. Never spill liquid of any kind on the product.
7. Do not attempt to service this product yourself as opening or removing covers may expose you to dangerous voltage or other hazards. Refer all servicing to qualified service personnel.
8. Changes or modifications to this unit not expressly approved by the party responsible for compliance could void the user's authority to operate the equipment.
9. Do not use attachments not recommended by the product manufacturer as they may cause hazards.
10. A product and cart combination should be moved with care. Quick stops, excessive force, and uneven surfaces may cause the product and cart combination to overturn.
11. Slots and openings in the cabinet are provided for ventilation and to ensure reliable operation of the product and to protect it from overheating. Do not block or cover these openings.
12. Unplug the product during lightning storm or when unused for long periods of time.

Items in this package

Before throwing away any packaging materials, please check thoroughly and make sure you find the following items that come along with this package:

- Turntable
- Turntable Lid
- Turntable Slip Mat
- 45 RPM adapter
- USB Cable
- Power Adaptor

Please contact Crosley customer service if there is any accessory missing from the package. **Retain the original packaging materials for exchange or return purposes.**

Specifications

| | |
|----------------------------------|---|
| Power | AC power adaptor, DC output 12V 0.5A |
| Power Consumption | 6W |
| Turntable Speed | 33 ¹ / ₃ , 45 RPM |
| Wow and Flutter | ±0.2% |
| Turntable Dimensions (W x H x D) | 14.17" x 3.70" x 13.62" |
| Replacement Needle | NP11 |
| Needle Pressure | 3±0.5g |

Note:

- *Design and specifications are subject to change without notice.*

Product Description

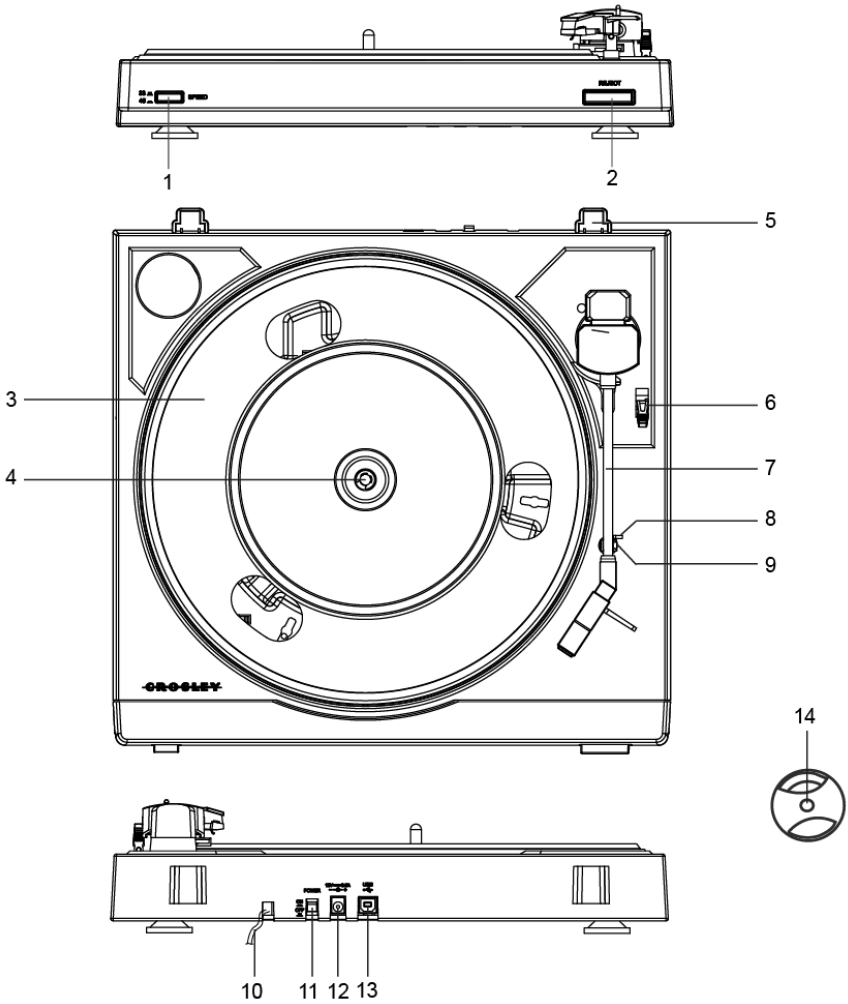

- 1. Speed Button
- 2. Reject Button
- 3. Turntable Platter
- 4. Turntable Spindle
- 5. Hinge
- 6. Cue Lever
- 7. Tonearm

- 8. Hold Down Clip
- 9. Tonearm Rest
- 10. RCA Cable
- 11. Power Button
- 12. Power Jack
- 13. USB Jack
- 14. 45 RPM Adapter

Initial Setup

Essential Setup

1. Place the unit on a flat and level surface. The selected location should be stable and free from vibration.
2. Install the turntable lid to the hinges.
3. Remove the tie-wrap that is holding the tonearm.
4. Place the slip mat on top of the turntable platter.
5. Connect AC adaptor to the **Power Jack** of the unit.

Note: Do not plug the AC power adaptor to power outlet before all the assembly is completed. Before turning the power on, make sure again all the connection settings are correct. Always turn off the power when connecting or disconnecting.

Drive Belt Assembly

The belt and turntable platter have been installed properly at the factory, if the belt is loose during transportation, you can fix it by following below instructions.

1. Remove the slip mat from the turntable platter. Remove the E clip from the turntable spindle and then remove the turntable platter.
2. Place the belt around the outside wall of the turntable platter's drive rim and make certain that the belt is smooth and flat all the way around.
3. Put the turntable platter back on the spindle, make certain it is fully seated, and align one of its openings over the brass motor pulley position.
4. Through the opening, carefully hook the turntable belt with a drive belt assembly tool (not provided) or a finger and put the belt over the brass motor pulley. Make sure the belt is not twisted between the pulley and the platter's drive rim.

Note:

- *Do not use a sharp object to perform the above step.*
 - *Make sure hands are clean while performing this job. Avoid oil or grease over the belt.*
5. Put the E clip back over the spindle and place the slip mat on the platter.

Auto Return Mechanism Reset

The auto return mechanism inside the turntable might have parts shifted during transportation which can cause malfunction of the auto return mechanism.

Always reset the auto return mechanism after the turntable is moved.

1. Use the cue lever to lift up the **Tonearm**.
2. Gently hold and move the **Tonearm** towards the **Turntable Spindle** until the Tonearm starts to pull back.
3. Release the Tonearm and it will return to the Tonearm Rest automatically. Now the mechanism is reset properly.

Stereo System Connection

RCA Jacks

- The RCA Jacks output analog line-level signals and could be connected directly with a pair of active/powerd speakers or the appropriate input of your stereo system.
- The Red plug connects with the Right channel and the White plug connects with the Left channel.

Note: The RCA Jacks are not designed to be connected directly to the passive/unpowered speakers. If connected to the passive speakers, the volume level will be very low.

Turntable Operation

1. Press the **Power Button** to turn on the power.
2. Press the **Speed Button** to select the platter speed accordingly.
3. Place the record on the turntable. Use the **45 RPM Adapter** if necessary.
4. Remove the stylus protector from the stylus assembly.

Note: To avoid stylus damage, make certain the included stylus guard is in place whenever the turntable is being moved or cleaned.

5. Release the tonearm **Hold Down Clip**.

Note: when the turntable is not in use, remember to lock back hold down clip.

6. Use the **Cue Lever** to lift up the tonearm.
7. Gently move the tonearm over the record where play is desired to begin. Set the **Cue Lever** back to the down position, the tonearm will descend slowly onto the record and begin playback.
8. When the record is finished playing, the tonearm will automatically return to its rest.
9. To stop the playback, press the **Reject Button** and the tonearm will return to the **Tonearm Rest** automatically.
10. Lock the **Tonearm Clip** to secure the tonearm.

Note:

- *When the tonearm is automatically returning to the tonearm rest, do not interfere with the tonearm's motion, or damage to the automatic return mechanism may occur.*

Needle Replacement

Removing Needle

1. Gently grasp the sides of the needle.
2. Pull needle away from the cartridge.

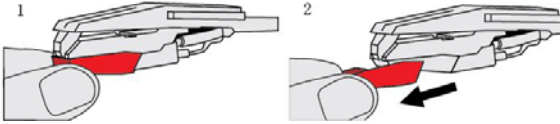

Installing Needle

1. Position the needle with its tip facing down.
2. Line up the needle with the cartridge.
3. Slide the needle onto the cartridge.

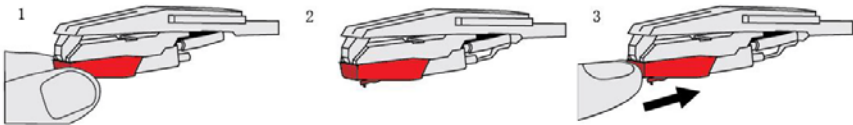

USB Recording

To record the vinyl into digital file formats such as MP3, you can use the **USB Output Jack** to connect this unit to your computer's USB port and use the recording program of your choice.

1. Use the supplied USB cable to connect the unit to your computer.
2. Turn on the power of the turntable.
3. Run the recording program of your choice.

Note:

- *In case you do not have a recording program installed, Audacity is a free software to use, distributed under the GNU General Public License (GPL). For most updated version of Audacity and instructions on how to use it, please visit Audacity website: <http://www.audacityteam.org/>. Crosley would not carry responsibility or support for third party software and all downloads should be carried out at user's own responsibility.*
- *Depending on the operating system and software that you are using, you may need to make some changes on settings of the operating system and/or software before starting the recording process. As a general guideline, the recording source/input should be set to Microphone USB audio codec. And it is recommended to set it to 2 channel, 16 bit, 48000Hz (DVD Quality)*
- *Make sure the USB connection is made to the USB jack of your computer directly instead of a USB hub to ensure a successful connection.*

Turntable Maintenance

1. Do not touch the stylus tip with your fingers. Avoid bumping the stylus on the turntable mat or a record's edge.
2. Clean the stylus frequently with a soft brush with a back-to-front motion only.
3. Clean the records to get rid of dust or grease with a record cleaning brush and record cleaning solution.
4. Clean the turntable lid and turntable cabinet with a slightly dampened microfiber cloth.

Note: Do not use cleanser other than that contains alcohol, benzene or any other harsh chemicals, which might damage the paint and finish of the turntable.

**** Crosley offers a product line of different cleaning accessories. Please ask your retailer or check out our website www.crosleyradio.com for more cleaning product information.**

Troubleshooting

There is no power

- Power adaptor is not connected correctly.
- No power at the power outlet.

Power is on, but the platter does not turn

- Turntable's drive belt has slipped off.

Turntable is spinning, but there is no sound, or sound not loud enough

- Stylus protector is still on.
- Tone arm is lifted up by the cue lever.

Record sounds too fast or too slow.

- Wrong speed selected for the record.

FCC Statements

FCC Caution:

1. This device complies with Part 15 of the FCC rules/ Industry Canada license-exempt RSS standard(s). Operation is subject to the following two conditions:
 - (1) This device may not cause harmful interference, and
 - (2) This device must accept any interference received, including interference that may cause undesired operation.
2. This device and its antenna(s) must not be co-located or operating in conjunction with any other antenna or transmitter.
3. Changes or modifications to this unit not expressly approved by the party responsible for compliance could void the user authority to operate the equipment.

FCC Radiation Exposure Statement:

This equipment complies with FCC radiation exposure limits set forth for an uncontrolled environment. This equipment should be installed and operated with minimum distance 20cm between the radiator & your body.

Note:

This equipment has been tested and found to comply with the limits for a Class B digital device, pursuant to Part 15 of the FCC Rules. These limits are designed to provide reasonable protection against harmful interference in a residential installation. This equipment generates, uses, and can radiate radio frequency energy and, if not installed and used in accordance with the instructions, may cause harmful interference to radio communications. However, there is no guarantee that interference will not occur in a particular installation. If this equipment does cause harmful interference to radio or television reception, which can be determined by turning the equipment off and on, the user is encouraged to try to correct the interference by one or more of the following measures:

- Reorient or relocate the receiving antenna.
- Increase the separation between the equipment and receiver.
- Connect the equipment into a circuit different from that to which the receiver is connected.
- Consult the dealer or an experienced radio TV technician for help.