

CLASS A HEADQUARTERS OPPORTUNITY



6400 WESTOWN PARKWAY
WEST DES MOINES, IA

AVAILABILITY

- ▶ Approximately 80,800 SF total
- ▶ 1st Floor: approx. 40,098 SF
- ▶ 2nd Floor: approx. 40,702 SF
- ▶ Immediate availability
- ▶ Spaces available from 5,000 SF

PROPERTY

- ▶ Class A headquarters caliber building
- ▶ Mix of executive offices & open areas
- ▶ Significant IT infrastructure in place
- ▶ Interstate monument signage
- ▶ Beautiful lake views

TERMS

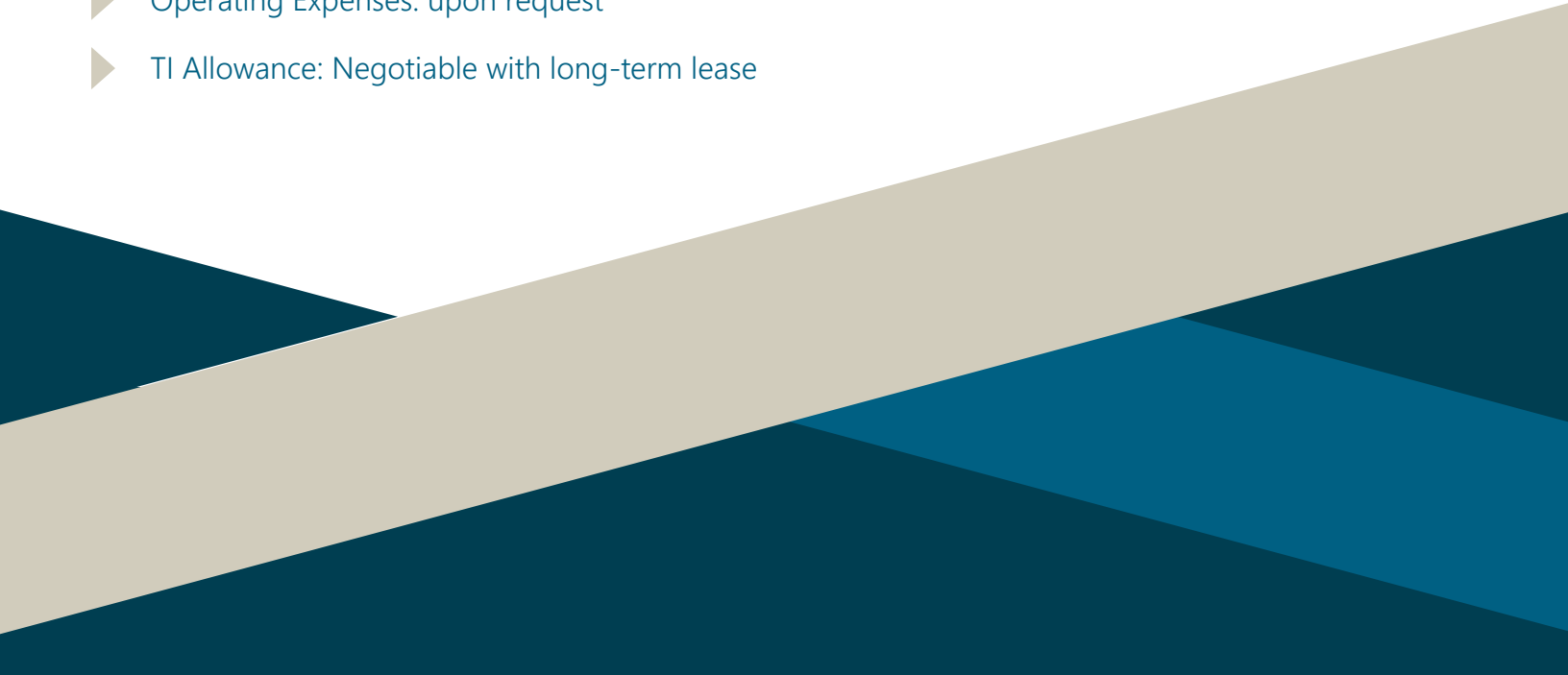
- ▶ Lease Rate: \$18.00/SF NNN
 - ▶ Operating Expenses: upon request
 - ▶ TI Allowance: Negotiable with long-term lease
- 

AMENITIES



Shared conference room



Easy freeway access



Fitness room featuring locker room and showers



Shared outdoor patio



Natural light throughout



Access to transit



Impressive multi-story, glass atrium common area



Great views



Ample free parking



Restaurants and shopping nearby



LOCATION

Immediate access to retailers and restaurants

Excellent interstate visibility



6400
Westtown
Parkway

FLOOR PLANS

FIRST FLOOR

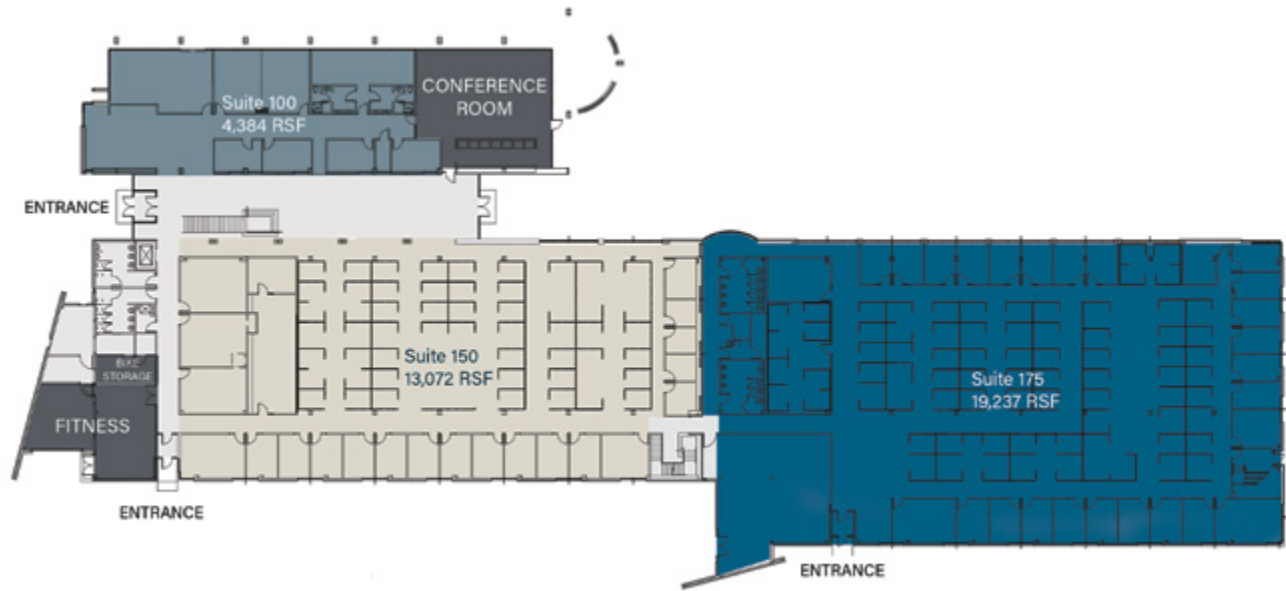

SECOND FLOOR

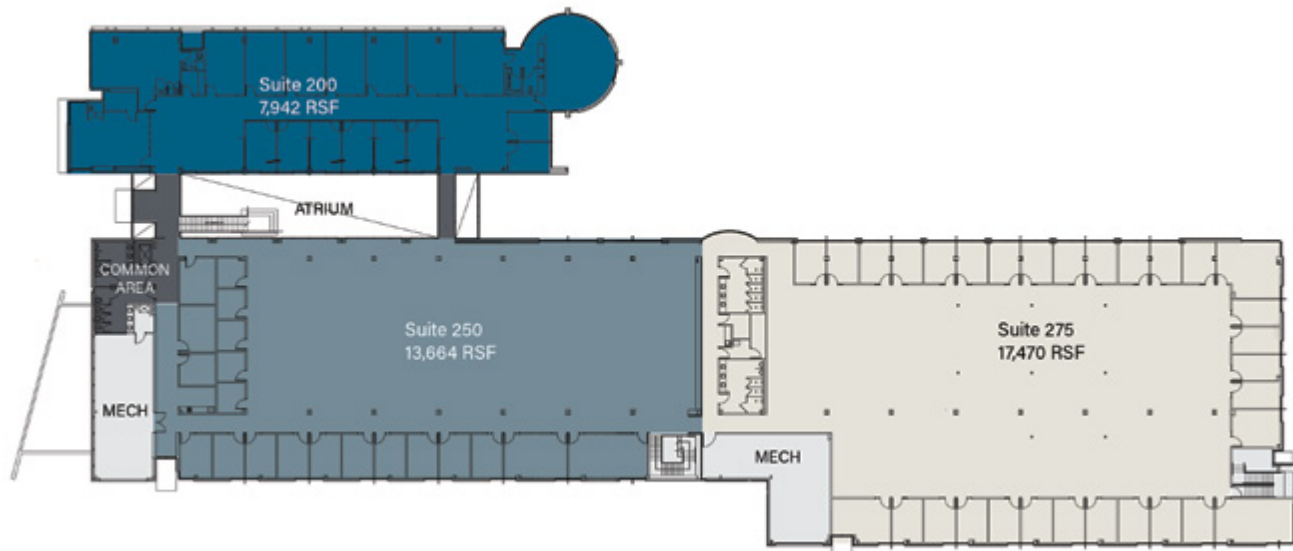





For leasing information, contact:

Justin Lossner, CCIM, SIOR
Managing Director
+1 515 371 0846
justin.lossner@am.jll.com

Kate Fanter Byus
Vice President
+1 515 865 8216
kate.byus@am.jll.com

The information contained herein has been given to us by the owner of the property or other sources we deem reliable. We have no reason to doubt its accuracy, but we do not guarantee it. All information should be verified prior to purchase or lease. Jones Lang LaSalle Brokerage, Inc. is a licensed broker in the State of Iowa.