

Summit Place



Sublease

6737 W. Washington St. Suite 4200, West Allis, WI

Specifications

| | |
|---------------------------|-----------------|
| Building Size: | 655,000 SF |
| Floors: | 5 |
| Class: | A |
| Floor Plate: | 131,000 SF |
| Parking Ratio: | 4.50 / 1,000 SF |
| Built / Renovated: | 1903 / 2003 |
| Fire Safety: | Wet sprinklered |

Lease Terms

| | |
|-----------------------|-----------------------|
| Sublease size: | 26,716 SF (2nd Floor) |
| Expiration: | 12/31/2022 |
| Lease rate: | \$18.00 / SF Gross |
| Use: | General Office |

Highlights

- Fitness center
- Controlled access
- On-site restaurant & banking
- Property manager on-site

floor plan

Second Floor
Suite 4200: 26,716 SF

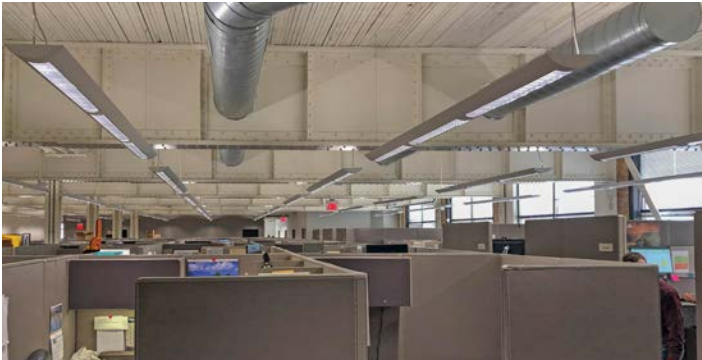
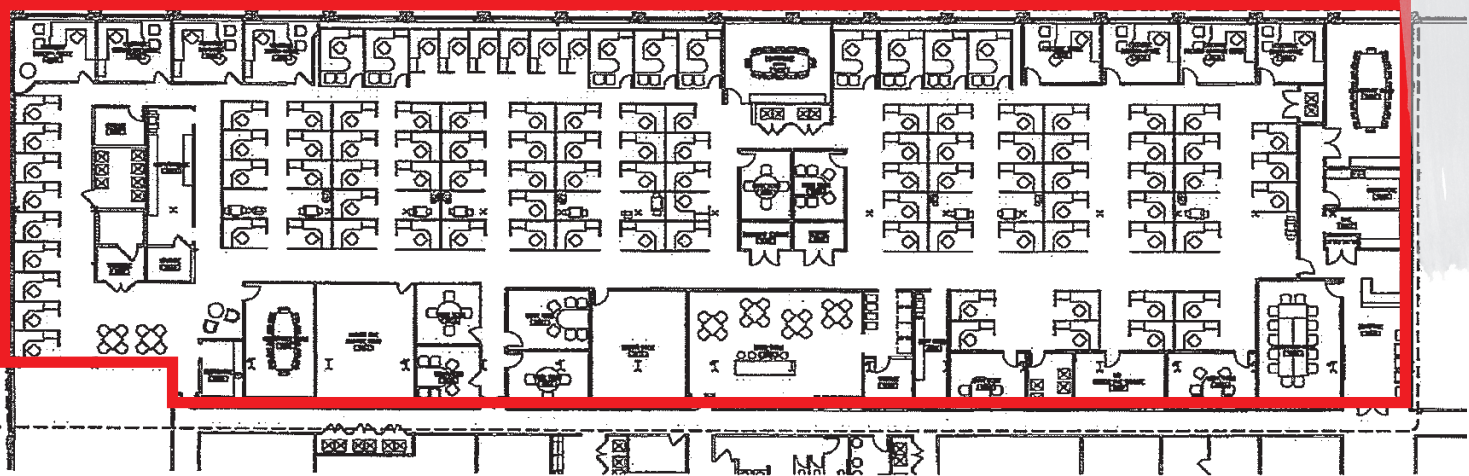
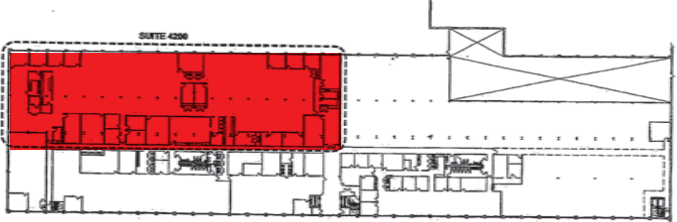

Aerial
6737 W. Washington St., West Allis

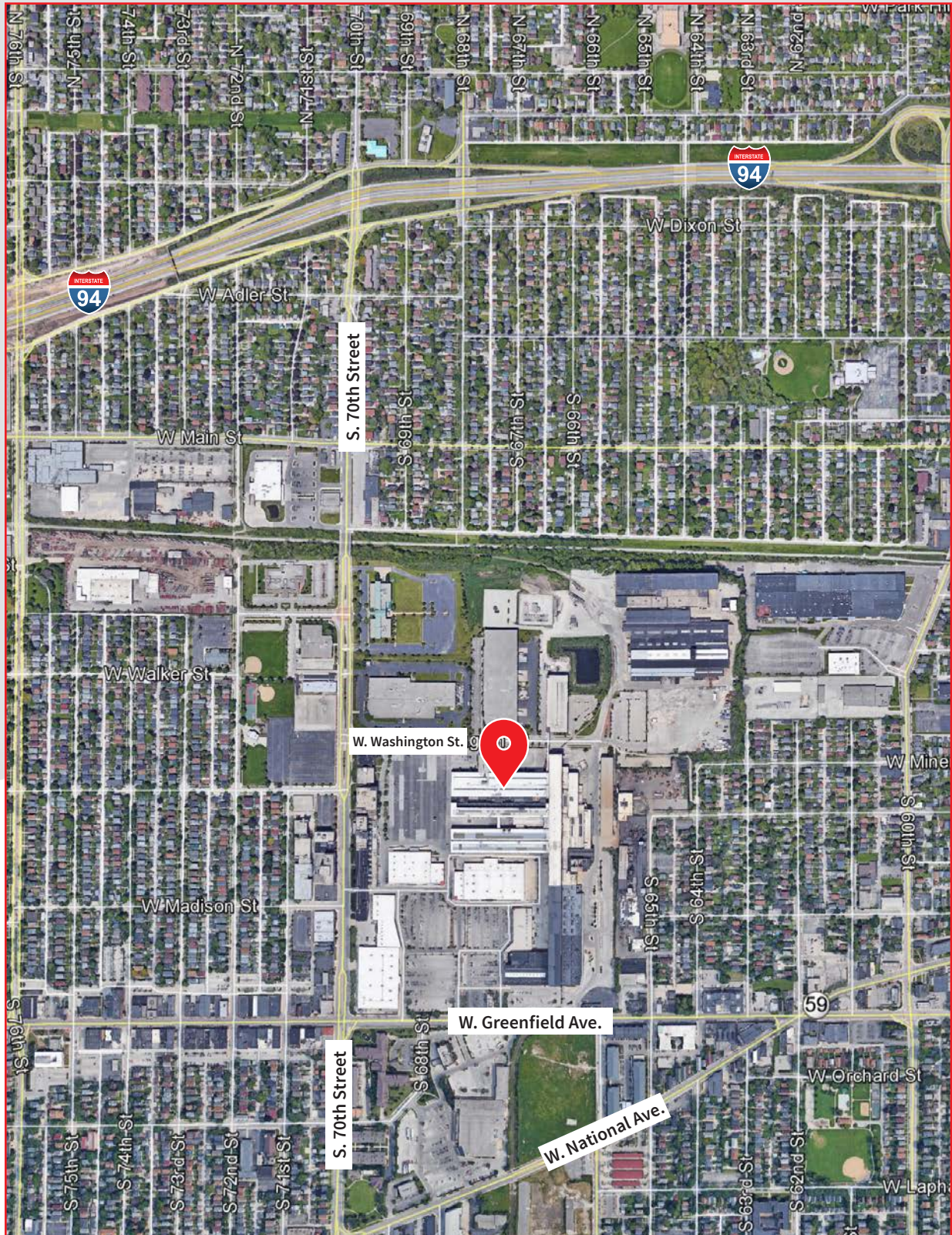

DISCLAIMER

disclaimer: Although information has been obtained from sources deemed reliable, Owner, Jones Lang LaSalle, and/or their representatives, brokers or agents make no guarantees as to the accuracy of the information contained herein, and offer the Property without express or implied warranties of any kind. The Property may be withdrawn without notice. If the recipient of this information has signed a confidentiality agreement regarding this matter, this information is subject to the terms of that agreement. ©2019. Jones Lang LaSalle. All rights reserved.





26,716 RSF

sublease

Summit Place
6737 W. Washington St. Suite 4200
West Allis, Wisconsin

Nick Hepner
Associate Broker
direct + 1 414 944 2107
nick.hepner@am.jll.com



DISCLAIMER

disclaimer: Although information has been obtained from sources deemed reliable, Owner, Jones Lang LaSalle, and/or their representatives, brokers or agents make no guarantees as to the accuracy of the information contained herein, and offer the Property without express or implied warranties of any kind. The Property may be withdrawn without notice. If the recipient of this information has signed a confidentiality agreement regarding this matter, this information is subject to the terms of that agreement. ©2019. Jones Lang LaSalle. All rights reserved.