



PRIME WATERFRONT RETAIL OPPORTUNITY

ONE BROOKLYN BRIDGE

IN BROOKLYN HEIGHTS AT BROOKLYN BRIDGE PARK

Join Ferguson, Everyday Athlete, One 15 Marina, Kaigo Coffee Room and more

- Immediately neighboring 700+ luxury residential units
- 1,500 sf to 19,044 sf available for lease—whiteboxed and pop-up ready
- 500-car attended public parking facility in the building
- Near the southern end of the 85-acre Brooklyn Bridge Park, with more than 6 million visitors annually





The shops at One Brooklyn Bridge front Brooklyn Bridge Park, which stretches 1.3 miles along the East River shore line and features playgrounds, boating, soccer fields, basketball courts, bike lanes, and more. The Park is visited by over six million people annually.

There are 700+ immediately adjacent, family-sized residential units between One Brooklyn Bridge Park, The Landing, and Quay Tower—Brooklyn’s newest, record-setting luxury condominium. These approximately 2,000 affluent residents further add to the pedestrian count at this location.

Recently added NYC Ferry service at Pier 6 – just across the street - seamlessly connects One Brooklyn Bridge to Manhattan (just 14 minutes to Wall Street) and other Brooklyn and Queens neighborhoods. There is also a 500-car attended public parking facility in the building.



LOCATION

On the Park side of 360 Furman Street (fronting Bridge Park Drive) between Joralemon Street and Atlantic Avenue

AVAILABLE SPACE

Ground Floor

Space A	1,579 sf†
Space B	3,065 sf** (vented)
Space C	11,750 sf*
Space D	2,650 sf**
Space E	1,500 sf

*divisible
†whiteboxed

Second Floor

Space E	21,000 sf
---------	-----------

TRANSPORTATION

- Borough Hall station located ten minutes away servicing the **2 3 4 5 R** lines
- NYC Ferry stops across the street at Pier 6, providing a 14-minute boat ride to Manhattan and easy access to Dumbo, Williamsburg, Greenpoint and other waterfront neighborhoods
- B63 MTA bus stops immediately in front of the space at Pier 6

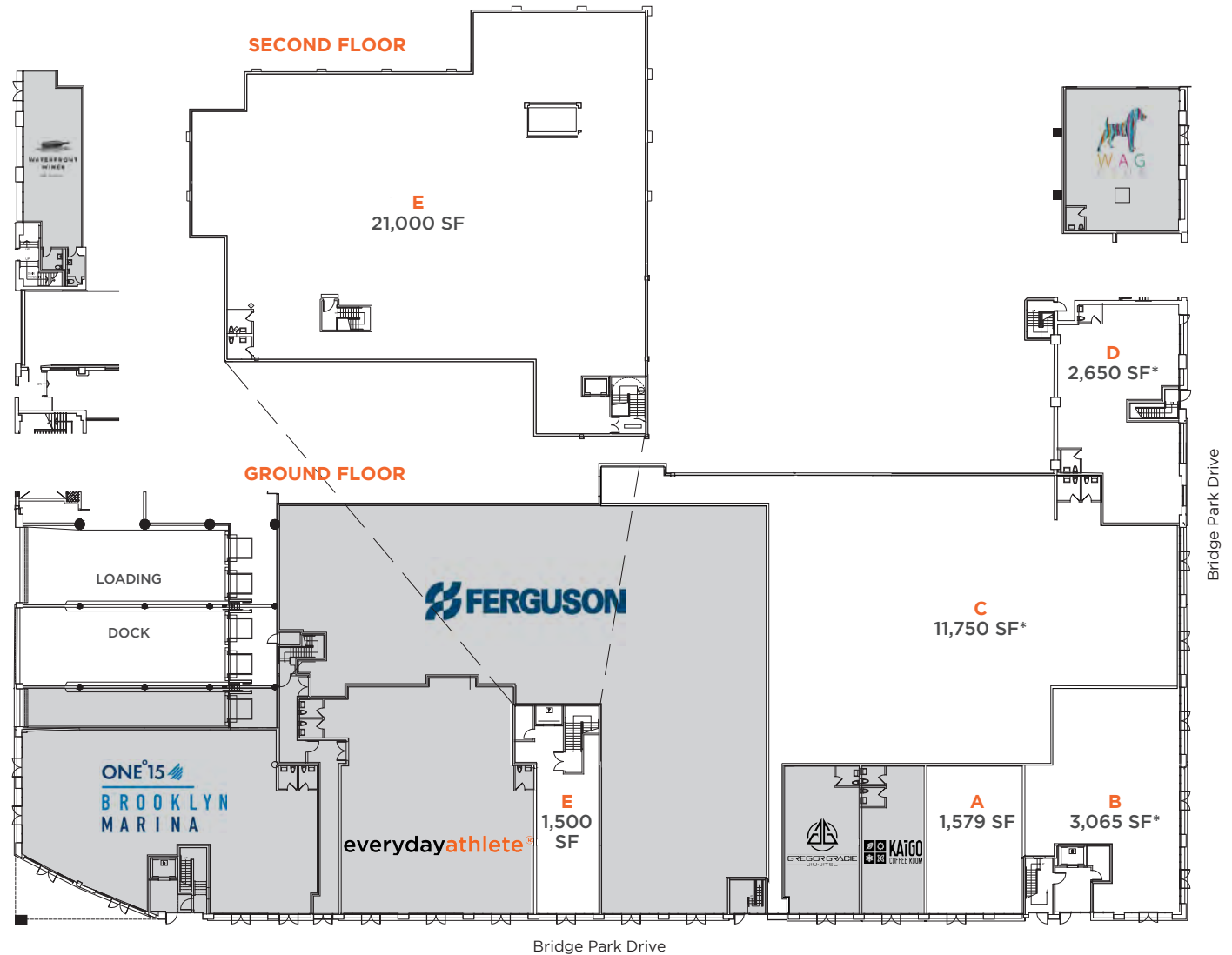



DEMOGRAPHICS

Radius	1/2 Mile	1 Mile	2 Miles
Population	24,782	85,436	376,950
Average Household Income	\$113,451	\$111,101	\$100,583
Ages 25-64	15,131	55,368	234,390
Percentage of Ages 25-64	61.06%	64.81%	62.18%



FOR FURTHER INFORMATION PLEASE CONTACT:

RYAN P. CONDREN
 +1 212 220 4117
 RYAN.CONDREN@AM.JLL.COM

GEORGE DANUT
 +1 212 220 4121
 GEORGE.DANUT@AM.JLL.COM



Jones Lang LaSalle Brokerage, Inc. | 330 Madison Avenue New York, NY 10017

DISCLAIMER

Although information has been obtained from sources deemed reliable, neither Owner nor JLL makes any guarantees, warranties or representations, express or implied, as to the completeness or accuracy as to the information contained herein. Any projections, opinions, assumptions or estimates used are for example only. There may be differences between projected and actual results, and those differences may be material. The Property may be withdrawn without notice. Neither Owner nor JLL accepts any liability for any loss or damage suffered by any party resulting from reliance on this information. If the recipient of this information has signed a confidentiality agreement regarding this matter, this information is subject to the terms of that agreement. ©2018 Jones Lang LaSalle IP, Inc. All rights reserved.

