



FOX PLAZA

RETAIL REBORN  
IN MID-MARKET

ESSEX  
PROPERTY TRUST, INC.



# THE NEIGHBORHOOD



# MID-MARKET

Located at the apex of Market, Ninth and Hayes Streets, Fox Plaza is situated at the nucleus of San Francisco's progressive mid-market neighborhood. The district is quickly gaining recognition as one of the city's hottest neighborhoods, and is widely regarded as the crossroads of technology, arts, cuisine, and culture. High-tech office neighbors, including Twitter, Yammer, Uber, Square, and Dolby Labs, are joined here by innovative restaurants, cutting-edge arts organizations, and an increasing array of retailers. The shops and restaurants in Hayes Valley and galleries and museums in SoMa are less than a ten-minute walk from Fox Plaza.

# HERE TODAY »» LIVE. WORK. PLAY.



**LIVE** | 126,302 RESIDENTS  
WITHIN ONE MILE

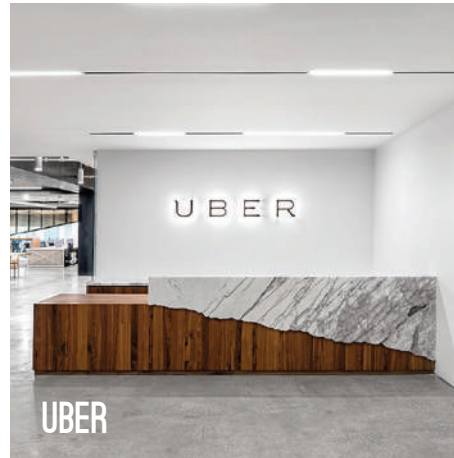

**PLAY** | 10 CULTURAL INSTITUTIONS  
WITHIN ONE MILE



**WORK** | OVER 8,000 EMPLOYEES  
WITHIN ONE BLOCK

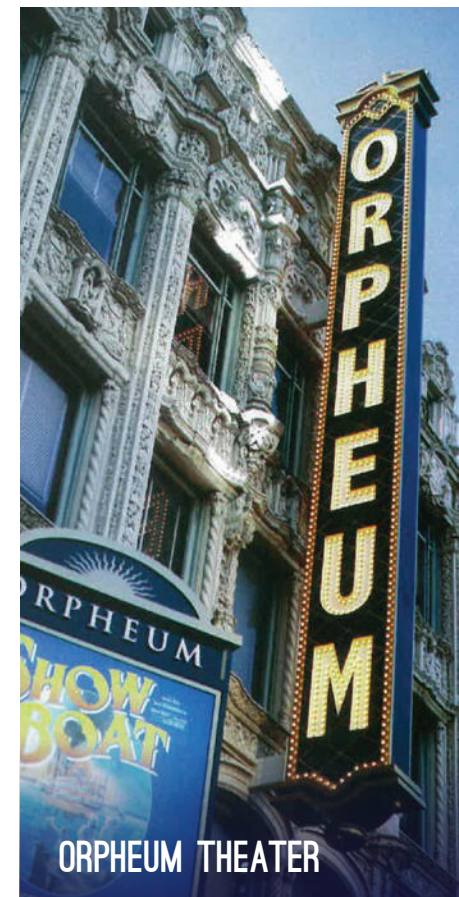

# HERE TOMORROW >> DEVELOPMENT



## RESIDENTIAL PROJECTS

### COMPLETED

- 1 100 VAN NESS 400 UNITS
- 2 101 POLK 162 UNITS
- 3 1321 MISSION 160 UNITS
- 4 1400 MISSION 190 UNITS
- 5 1415 MISSION 165 UNITS
- 6 217 EDDY 105 UNITS
- 7 388 FULTON 69 UNITS

### UNDER CONSTRUCTION

- 1 1075 MARKET 99 UNITS
- 2 1125 MARKET 164 UNITS
- 3 1169 MARKET 541 UNITS
- 4 150 VAN NESS 450 UNITS
- 5 1554 MARKET 110 UNITS
- 6 1 OAK 300 UNITS
- 7 10 S VAN NESS 767 UNITS
- 8 1601 MISSION 220 UNITS
- 9 1500 MISSION 600 UNITS
- 10 30 OTIS 354 UNITS
- 11 30 VAN NESS 560 UNITS
- 12 214 VAN NESS 140 UNITS
- 13 1270 MISSION 541 UNITS
- 14 600 VAN NESS 150 UNITS
- 15 101 HYDE 85 UNITS
- 16 198 MCALLISTER 970 UNITS
- 17 100 MCALLISTER 252 UNITS
- 18 1066 MARKET 304 UNITS
- 19 1028 MARKET 186 UNITS
- 20 950 MARKET 262 UNITS
- 21 1036 MISSION 83 UNITS

# NEW LOOK >> RENDERING



MARKET STREET  
FRONTING RETAIL SPACE

# RETAIL REDESIGNED >> FLOOR PLAN

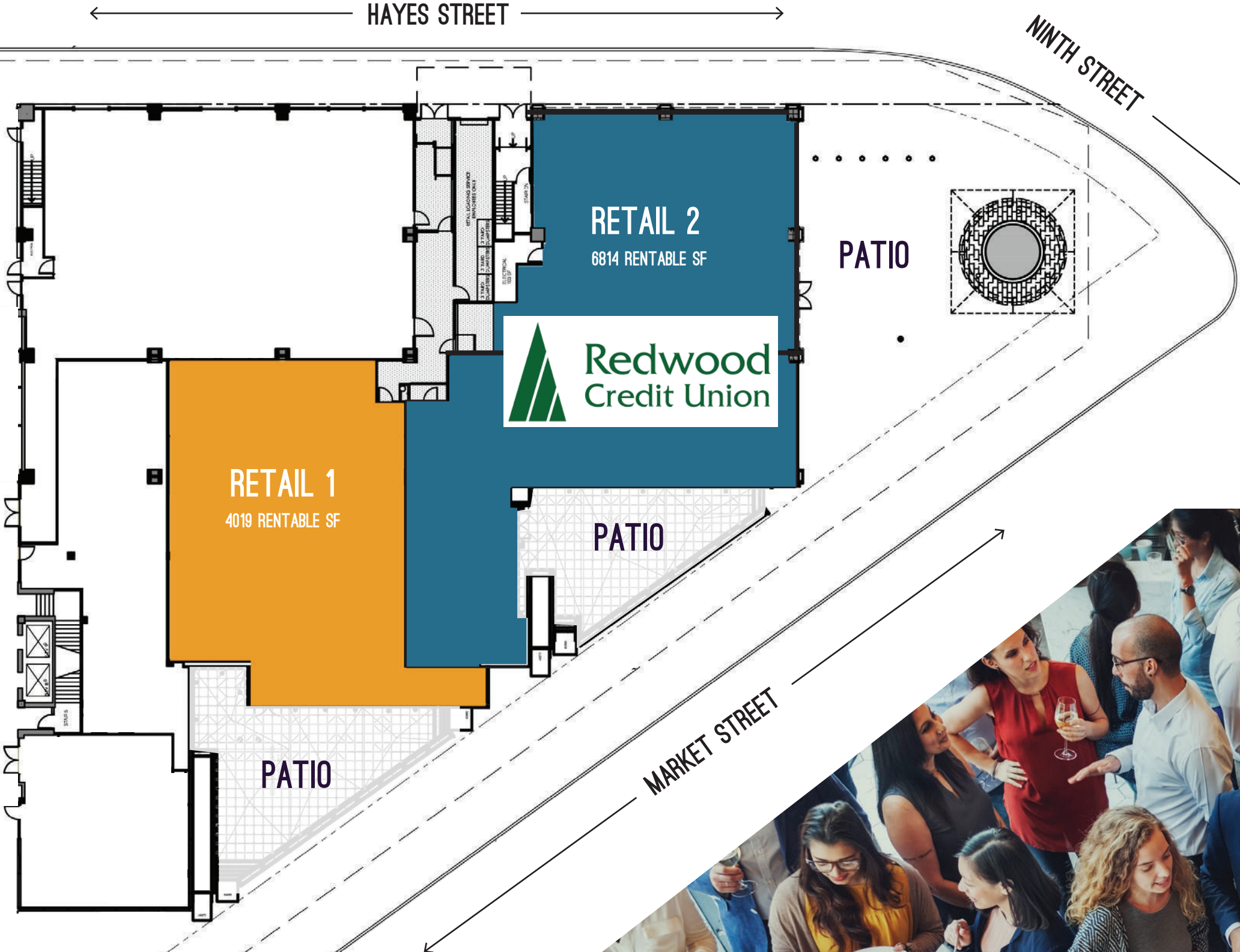

## FEATURES

With ample outdoor patio seating, wrapped glass and high ceilings, Retail 1 is a prime opportunity for a boutique fitness or food and beverage operator. The space can be fully vented (Type I) with loading capability from Hayes Street.



# PEOPLE » DEMOGRAPHICS



EQUATOR COFFEE



DIRTY WATER



THE MARKET



HUCKLEBERRY BICYCLES



FERMENTATION LAB

	0.5 MILES	1 MILE
TOTAL POPULATION	31,076	126,302
TOTAL DAYTIME POPULATION	59,278	202,587
RESIDENTIAL POPULATION	13,962	54,593
BACHELOR'S DEGREE & HIGHER	29.7%	31.1%

# CONTACT

---

## **BEN LAZZARESCHI**

Executive Vice President

+1 415 228 3070

[ben.lazzareschi@am.jll.com](mailto:ben.lazzareschi@am.jll.com)

RE License # 01414579

## **LAURA TINETTI**

Senior Vice President

+1 415 228 3072

[laura.tinetti@am.jll.com](mailto:laura.tinetti@am.jll.com)

RE License # 01358500



Jones Lang LaSalle Brokerage, Inc.  
RE License #01856260