

10,000-28,000 RSF

Available

1919 McKinney

CREATIVE SPACE

4.0/1,000 PARKING



1919 MCKINNEY AVE. | DALLAS, TEXAS 75201

BUILDING FACTS

- 100,146 RSF, 3 Stories
- Building Expandable to 119,310 gsf
- 3rd Floor - 28,350 gsf
- 4th Floor - 14,439 gsf (expansion space)
- Built in 1924; Renovated 1998 & 2016
- Parking Ratio of 4.0:1,000
- 29 Surface Visitor Spaces
- 371 sf Penthouse
- Loading Dock

BUILDING AMENITIES

- Full renovated interiors
- Energy management system
- Multiple HVAC zones
- McKinney Avenue Trolley Stop in front of building
- Card key access system
- Exposed ceilings
- High design space - exposed ceilings and spiral ducts



Configuration options

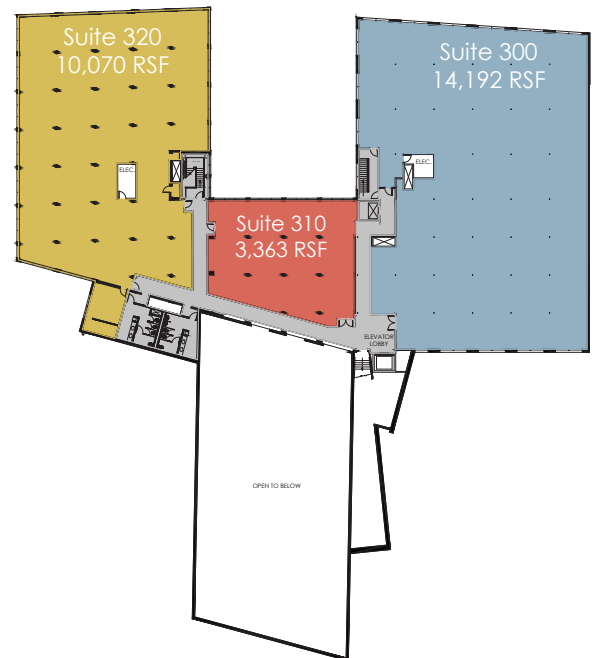
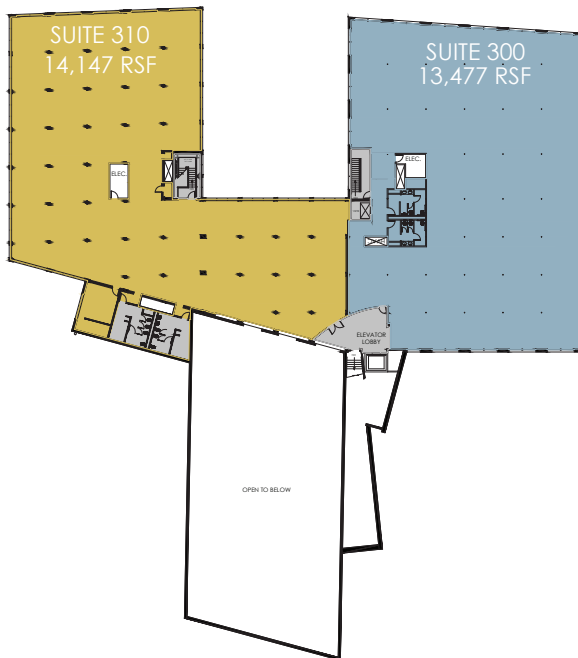
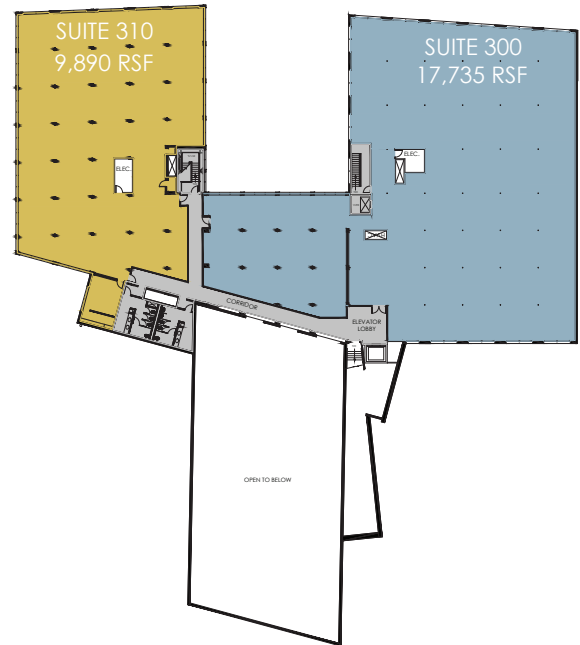
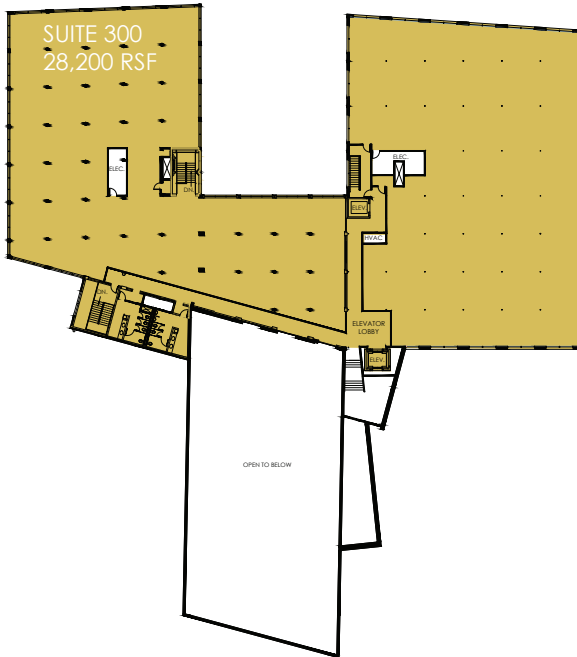

For more information, contact:

TREVOR FRANKE

+1 214 220 0600

trevor.franke@am.jll.com

GINI ROUNSAVILLE

+1 214 220 0600

gini.rounsaville@am.jll.com

Although information has been obtained from sources deemed reliable, neither Owner nor JLL makes any guarantees, warranties or representations, express or implied, as to the completeness or accuracy as to the information contained herein. Any projections, opinions, assumptions or estimates used are for example only. There may be differences between projected and actual results, and those differences may be material. The Property may be withdrawn without notice. Neither Owner nor JLL accepts any liability for any loss or damage suffered by any party resulting from reliance on this information. If the recipient of this information has signed a confidentiality agreement regarding this matter, this information is subject to the terms of that agreement. ©2019. Jones Lang LaSalle IP, Inc. All rights reserved

