



**13365**

**WASHINGTON  
BLVD.**

**RETAIL/FOOD/  
FINANCIAL INSTITUTION  
END CAP OPPORTUNITY**



[JLLRETAIL.COM](http://JLLRETAIL.COM)



# Property

## HIGHLIGHTS

**Size: Approximately 2,500 RSF**

**Rent: Negotiable**

**Availability: Immediate**

- Highly visible *end cap* space
- Bright unit with tremendous window frontage
- Perfect space for a variety of different uses; *financial institutions, medical, dental, and food uses without a hood*
- **15** dedicated parking spaces
- Average household income \$128,927

Nearby Tenants: *Lodge Bread, A-Frame, Hatchet Hall, Culver Public Market (coming soon), Uzumaki, Copenhagen Pastry, Firestone Walker Brewery, Ginger's Divine Ice Cream, The Corner Door, and Rockenwagner, Equinox, Coffee Bean, Starbucks, AMC Marina Marketplace, Ralphs, Ritz Carlton, Gelson's, Waterside at Marina del Rey*



**2,500 SF**

Unique  
Retail/Food/  
Financial  
Institution  
Opportunity



LESS THAN A MILE  
FROM FAMOUS  
ABBOT KINNEY BOULEVARD  
& MARINA DEL REY

# Neighboring

TENANTS



THE RITZ-CARLTON



MARINA DEL REY



uzumaki



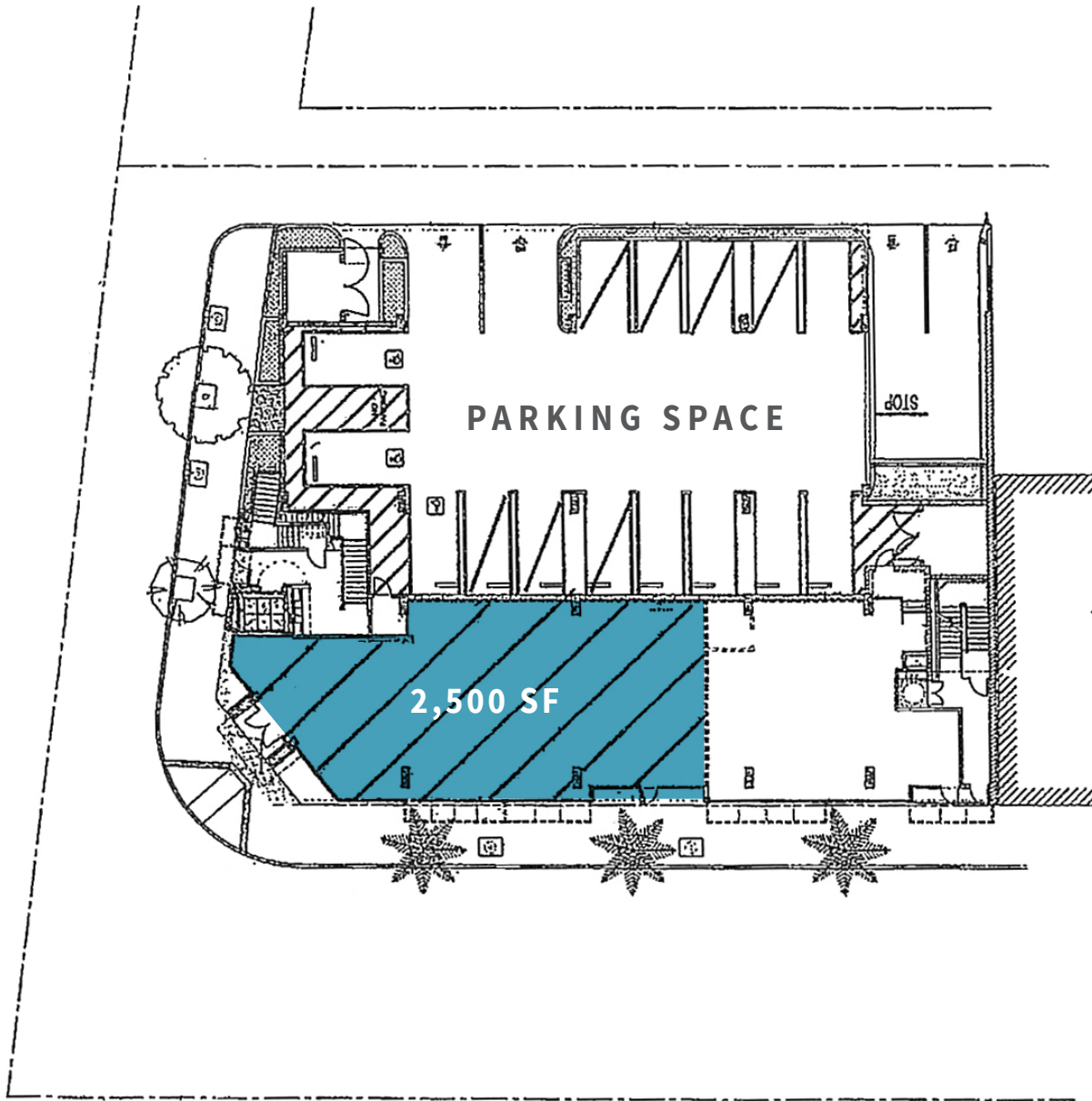

FLOOR  
Plan







jllretail.com



For more information, please contact:

**GREG BRIEST**

Vice President  
Lic #01949565  
Tel +1 310 595 3623  
Greg.Briest@am.jll.com

**DEVIN KLEIN**

Retail Brokerage Advisor  
Lic #01471525  
Tel +1 310 595 3641  
Devin.Klein@am.jll.com

**HOUMAN MAHBOUBI**

Executive Vice President  
Lic #01450237  
+1 310 595 3621  
houman.mahboubi@am.jll.com

Although information has been obtained from sources deemed reliable, Owner, Jones Lang LaSalle, and/or their representatives, brokers or agents make no guarantees as to the accuracy of the information contained herein, and offer the Property without express or implied warranties of any kind. The Property may be withdrawn without notice. If the recipient of this information has signed a confidentiality agreement regarding this matter, this information is subject to the terms of that agreement. ©2018. Jones Lang LaSalle. All rights reserved.