

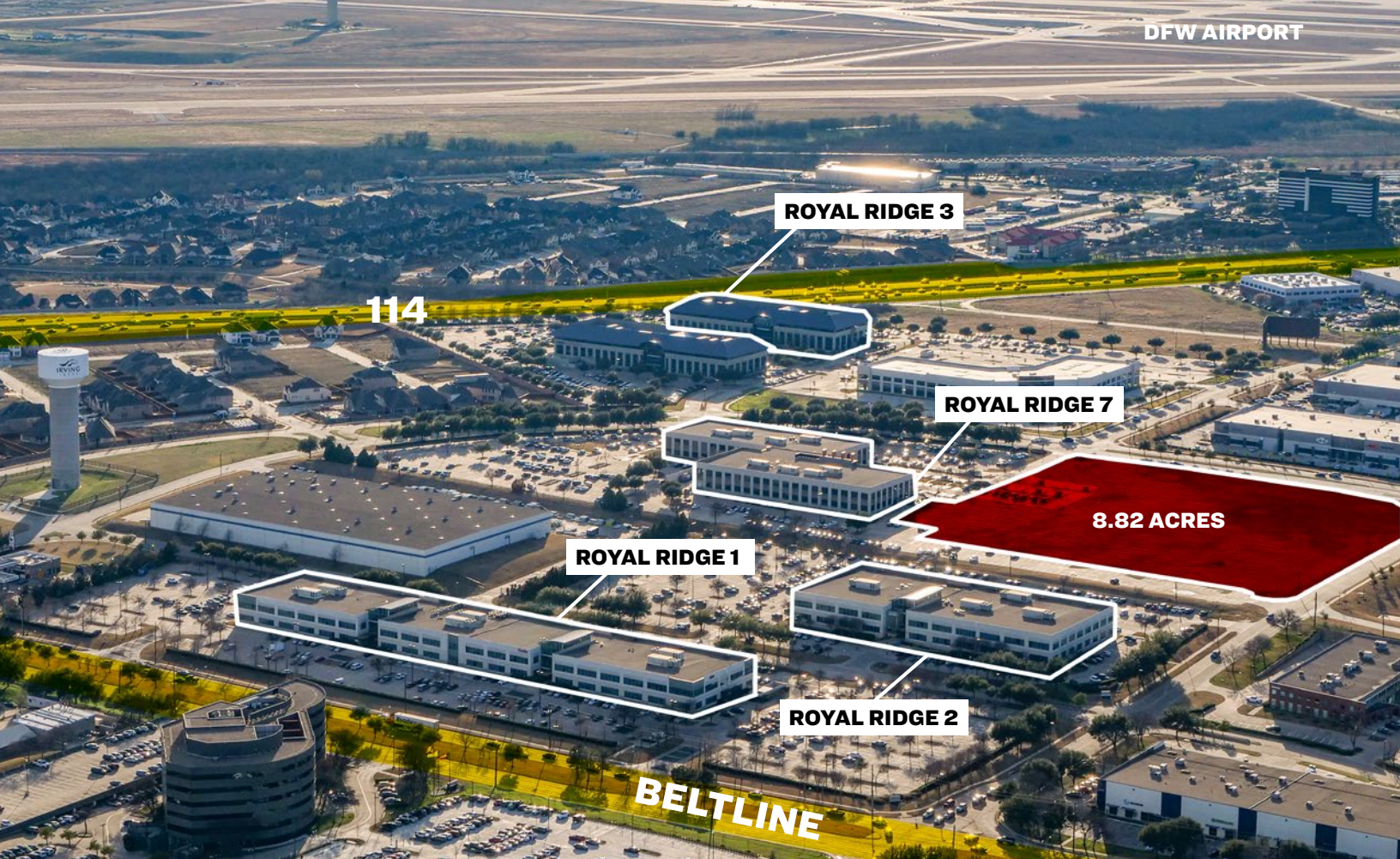

ROYAL RIDGE 1

- 144,943 RSF
- BUILDING SIGNAGE AVAILABLE
- 839 PARKING SPACES
- EXPANSION LAND AVAILABLE
- TWO - 1200 kW BACKUP GENERATORS WITH A 6,000 GALLON FUEL TANK



BUILDING INFORMATION

- 144,943 rsf; 2 Stories
- 839 Parking Spaces
- Top of Building Signage Available
- 38,000: Beltline Traffic Count /Per Day
- +/- 72,472 rsf Average Floor Plate Size
- Expansion Land Available
- Two - 1200 kW Backup Generators with a 6,000 Gallon Fuel Tank
- Card Key Access Security System
- Easy Access to 635 and 114

AMENITIES NEARBY

- Starbucks, Chipotle, Jimmy John's, Whataburger, McAllister's Deli, McDonald's, Local Diner, Cavali Pizza, Salsa's Mexican, Zushi Wok and Grill
- Approximately 20 Hotels in the Immediate Area Including The DFW Airport Marriott, Westin, and Sheraton
- Close Proximity to DFW Airport

FLOOR PLATES

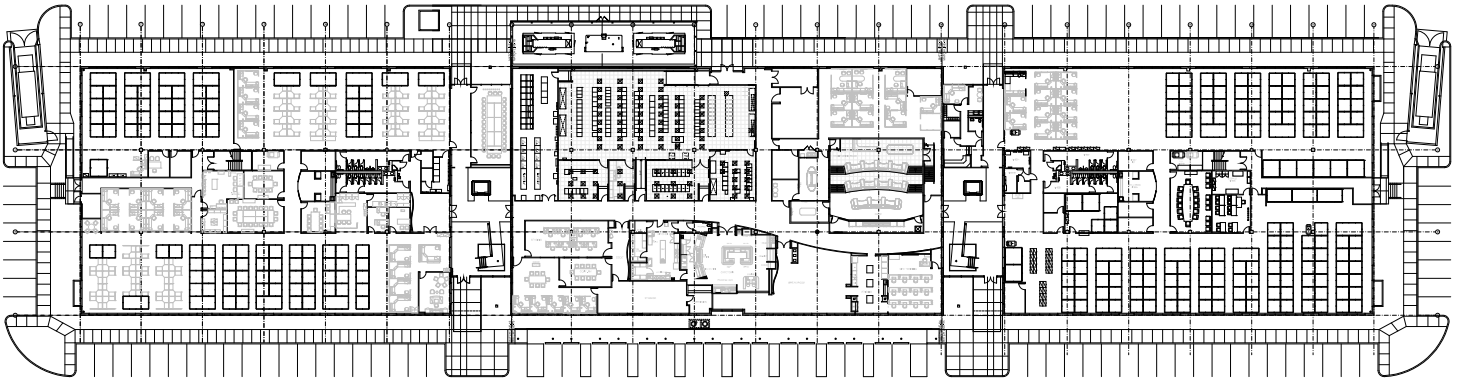

 **FIRST FLOOR** | +/- 72,067 RSF

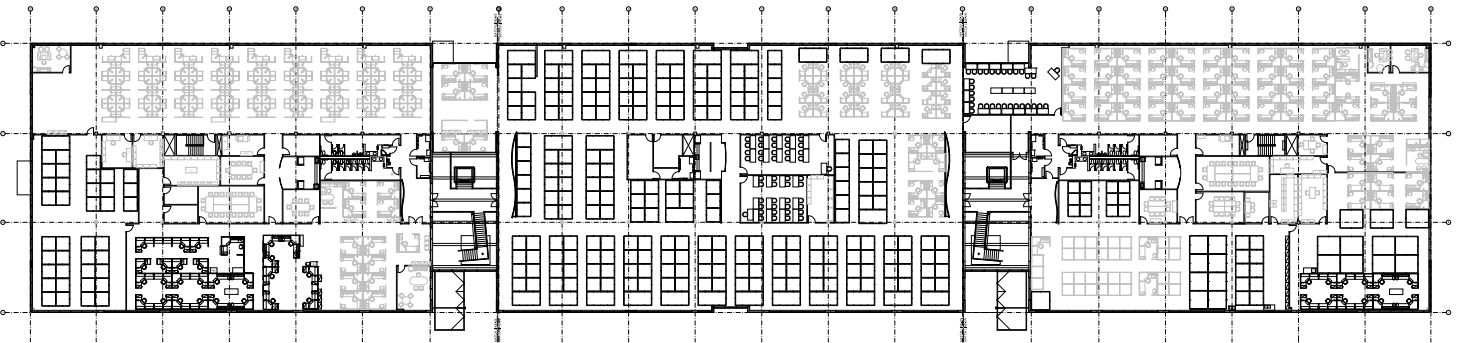

 **SECOND FLOOR** | +/- 72,876 RSF



7979 N Belt Line Road
Irving, TX 75063



FOR LEASING INFORMATION:
JOHN BROWNLEE | j.brownlee@am.jll.com
MICHAEL WILLIAMS | michaelc.williams@am.jll.com
+1 214 438 6100

Although information has been obtained from sources deemed reliable, neither Owner nor JLL makes any guarantees, warranties or representations, express or implied, as to the completeness or accuracy as to the information contained herein. Any projections, opinions, assumptions or estimates used are for example only. There may be differences between projected and actual results, and those differences may be material. The Property may be withdrawn without notice. Neither Owner nor JLL accepts any liability for any loss or damage suffered by any party resulting from reliance on this information. If the recipient of this information has signed a confidentiality agreement regarding this matter, this information is subject to the terms of that agreement. ©2019. Jones Lang LaSalle IP, Inc. All rights reserved.