

# TOWER | 1320

1320 GREENWAY, IRVING, TX 75038 | TOWER1320.COM



JEFF WOOD  
jeff.wood@am.jll.com | 214.438.6100





MULTI MILLION DOLLAR RENOVATION AT

TOWER | 1320



+ REDESIGNED WI-FI LOBBY

+ TENANT LOUNGE/GAME ROOM (PICTURED HERE)

+ CONFERENCE FACILITY

+ COMMON CORRIDORS & RESTROOMS

+ CAFE WITH  COFFEE BAR

+ FITNESS CENTER

+ BUILDING ENTRANCE

+ NEW ELEVATORS

+ FULL FLOOR WHITEBOX

+ SPEC SUITES



CONFERENCE CENTER



TENANT LOUNGE/GAME ROOM





CAFE WITH  COFFEE BAR



FITNESS CENTER



## AREA MAP

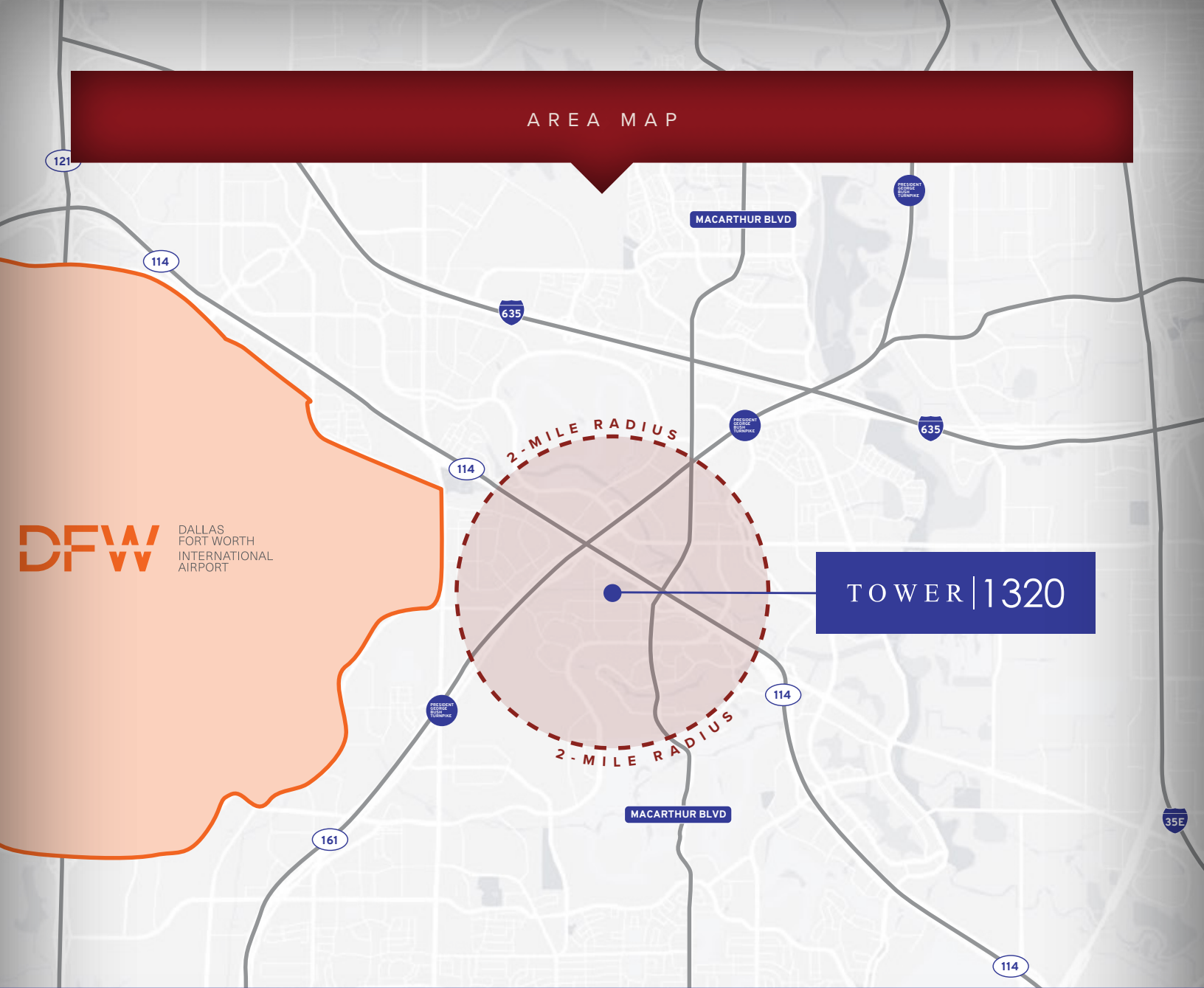

## LOCATION

Tower 1320 is located in an amenity rich environment with ease of access from all parts of the city by the multitude of highways and/or DART. Located 7 miles from DFW Airport and one block from MacArthur Blvd., which currently serves as the heart of Las Colinas' food and retail epicenter. The building is located within walking distance of Las Colinas' hottest new 28-acre development, which includes two high-end boutique style hotels, multi-family and approximately 50,000 SF of retail and restaurant space of all levels!

## OVER 100 RESTAURANTS IN A 2-MILE RADIUS!

The following is just a partial list of the many culinary options in close proximity: Hopdoddy, Moxies Bar & Grill, Sullivans, Uncle Julios, Breakers Korean BBQ, Starbucks, Via Real, McDonald's, Einsten Bros, Dickey's, Quiznos, Jack in the Box, Chick-Fil-A, Taco Bell, Subway, Pizza Hut, Wendy's, Boston Market, Sonic, Fuzzy's Tacos, Snappy Salads, Zoës Kitchen, Shake Shack, Red Hot & Blue, Taco Diner, SmashBurger, Blue Fish, The Keg, The Ranch, Champps, WingStop, In & Out Burger, Fast & Furious, la Madeleine, Five Guys, Bread Zeppelin



## BUILDING FACTS

**BUILDING** | Class A Office, 10 Floors

**RENOVATED** | 2019

**TOTAL SIZE** | 246,081 SF

**FLOOR SIZE** | 25,000 SF

**COMMON AREA FACTOR** | 18.43%

**PARKING** | Up to 6/1,000 may be provided

**SECURITY** | MON - FRI 7:30 - 11:30, SAT 8:00 - 1:00

**AMENITIES** | Fitness Center, Conference Facility, Cafe, Tenant Lounge/  
Game Room, WiFi Lobby, On-Site Management

**TELECOM/FIBER** | Verizon, TW Telecom, Logix, Cbeyond, Ntegrated

## TYPICAL FLOORPLAN

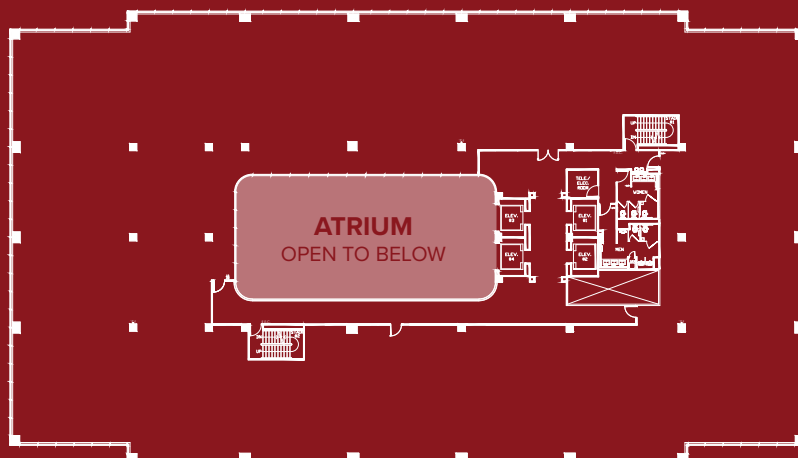



# TOWER | 1320



J E F F W O O D

[jeff.wood@am.jll.com](mailto:jeff.wood@am.jll.com)

214.438.6100

Although information has been obtained from sources deemed reliable, neither Owner nor JLL makes any guarantees, warranties or representations, express or implied, as to the completeness or accuracy as to the information contained herein. Any projections, opinions, assumptions or estimates used are for example only. There may be differences between projected and actual results, and those differences may be material. The Property may be withdrawn without notice. Neither Owner nor JLL accepts any liability for any loss or damage suffered by any party resulting from reliance on this information. If the recipient of this information has signed a confidentiality agreement regarding this matter, this information is subject to the terms of that agreement. ©2019. Jones Lang LaSalle IP, Inc. All rights reserved.