

3270

W. BIG BEAVER  
TROY, MI



# NOW AVAILABLE



8,000- 110,000 SF  
office building  
located on the  
Golden Corridor  
in Troy



\$17.50 PSF Gross  
+ electricity



Headquarter  
opportunity



Big Beaver  
building signage  
available



27,500 RSF  
floorplate;  
modern and open  
layout



Parking: Ratio of  
5.50/1,000 RSF



Excellent location  
in close proximity  
to Troy's Somerset  
Collection, I-75 and  
other amenities



300 person  
conference room



Comcast, AT&T,  
123Net Fiber.  
Two 24 x 7  
Generators



Move in ready  
medical office  
space

approximately

# 110,000 SF

## OFFICE BUILDING BIG BEAVER CORRIDOR



**Ben Schrode**

+1 248 581 3325

[ben.schrode@am.jll.com](mailto:ben.schrode@am.jll.com)

**A.J. Weiner**

+1 248 581 3335

[aj.weiner@am.jll.com](mailto:aj.weiner@am.jll.com)

©2020 Jones Lang LaSalle IP, Inc. All rights reserved. All information contained herein is from sources deemed reliable; however, no representation or warranty is made to the accuracy thereof.



# LOCATION

3270 W Big Beaver Rd, Troy

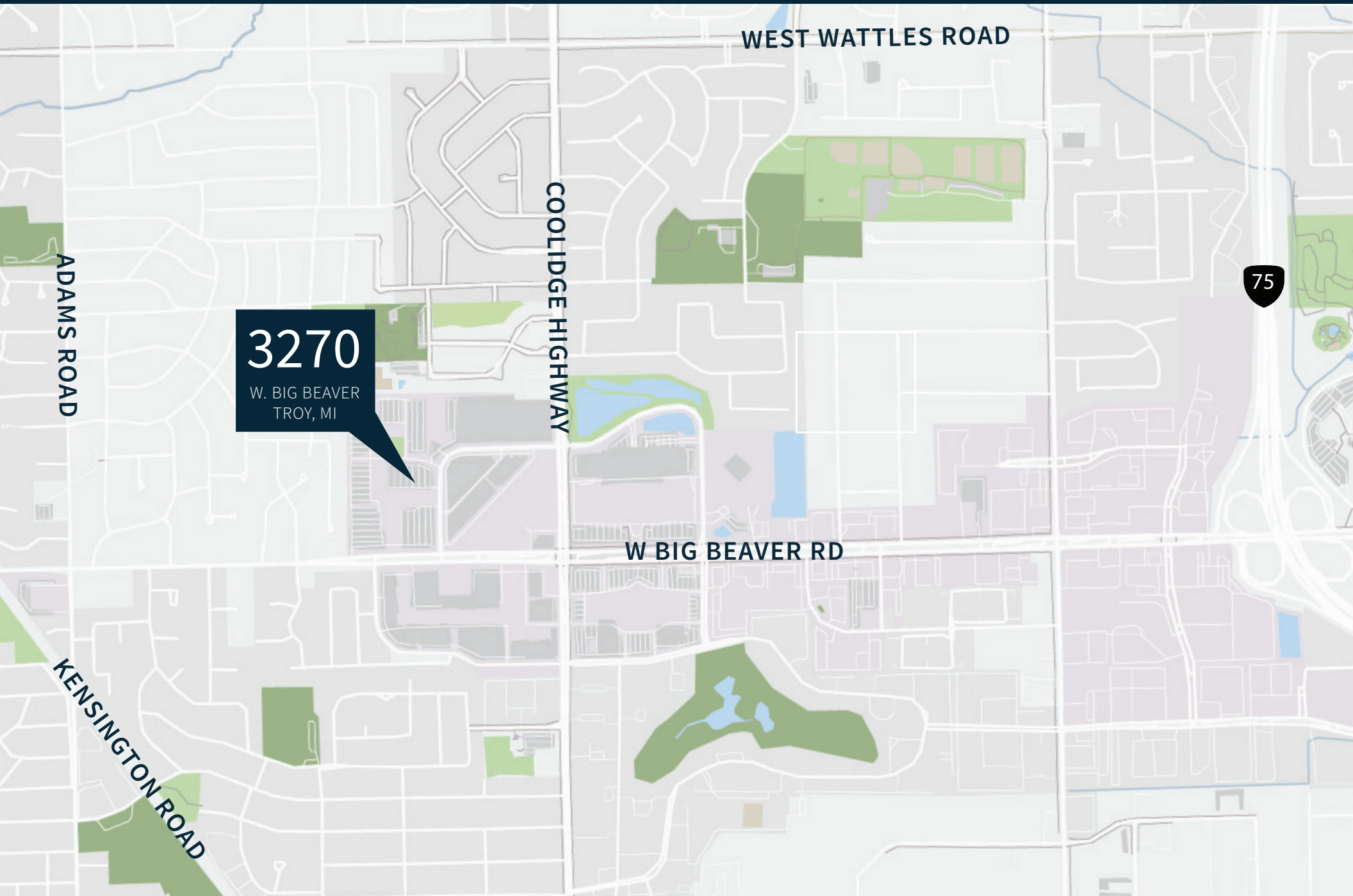

# FIRST FLOOR

8,071- 23,780 RSF

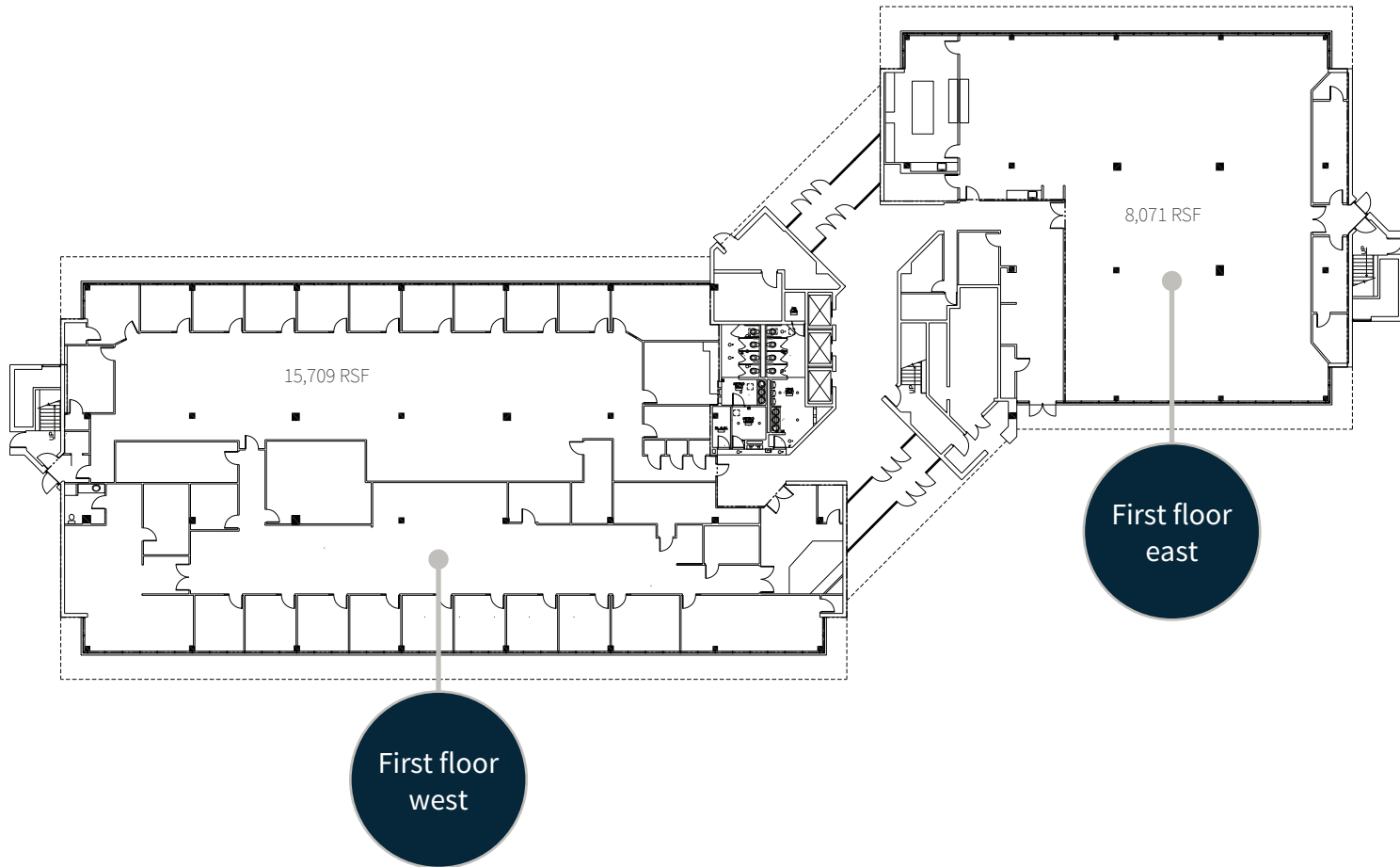

# SECOND FLOOR

10,460- 27,952 RSF

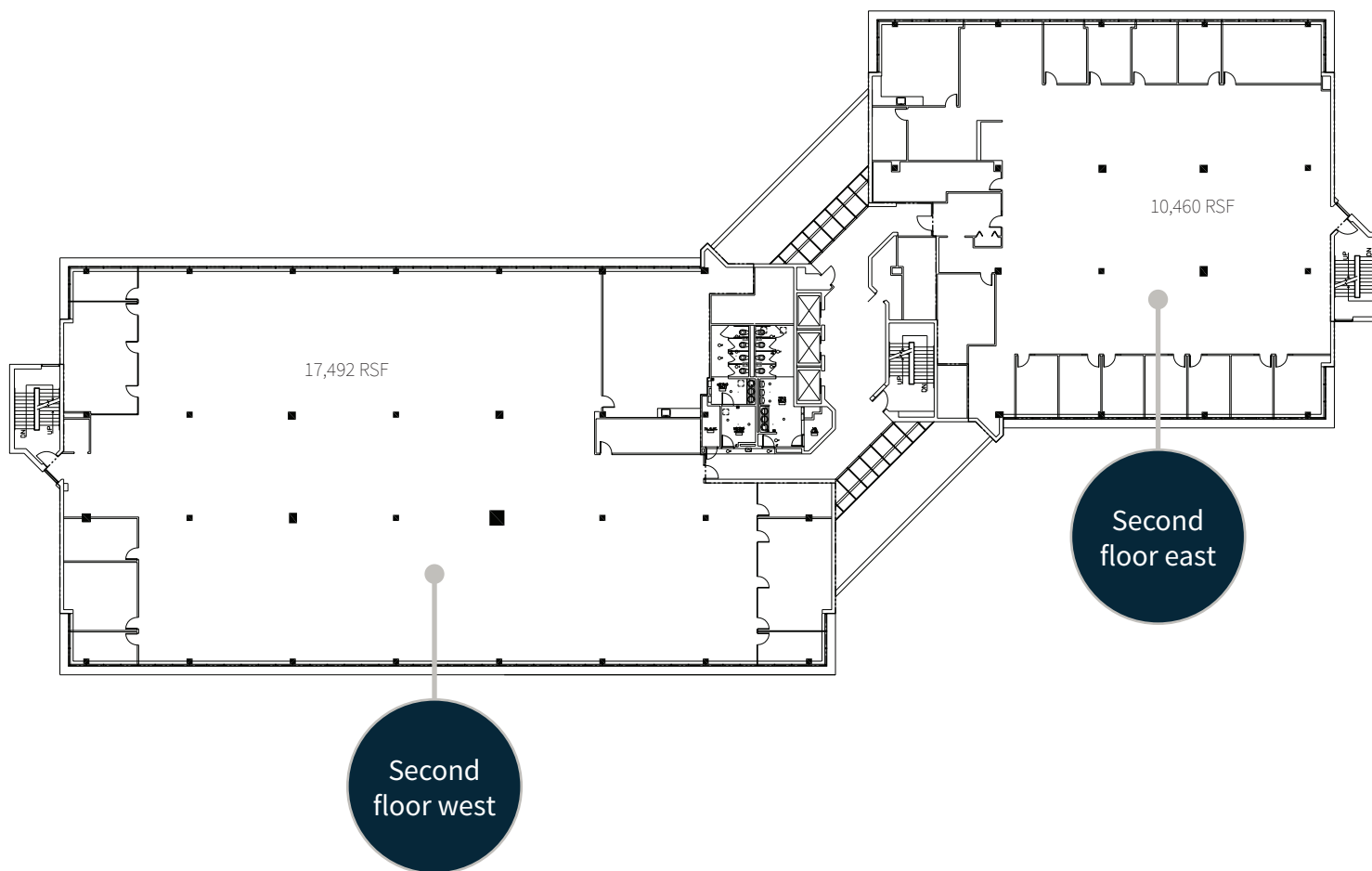

# THIRD FLOOR

10,818- 28,376 RSF

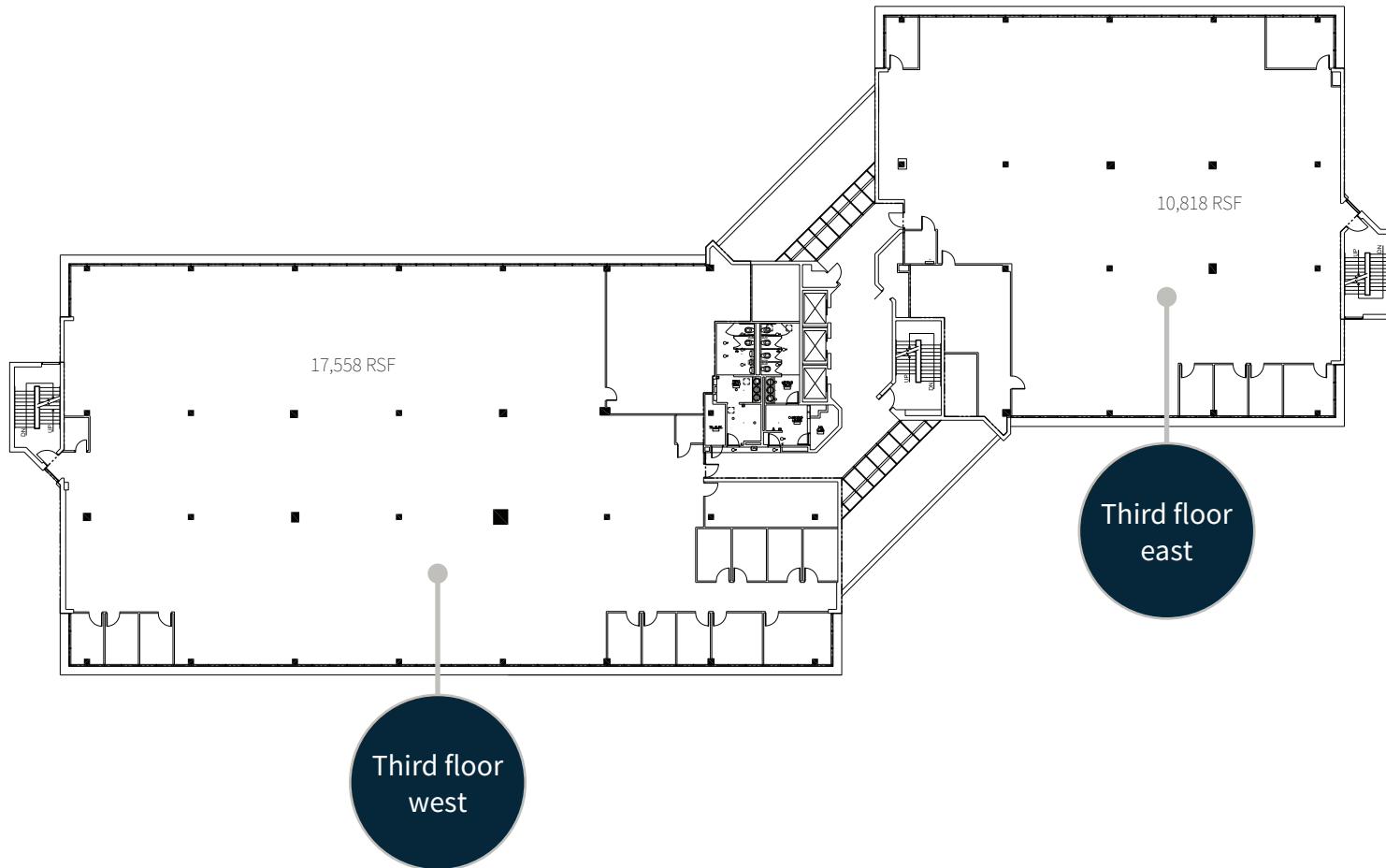

# FOURTH FLOOR

10,801- 27,216 RSF

Turn Key Medical Office suite on 4th floor



3270  
W. BIG BEAVER  
TROY, MI



**Ben Schrode**  
+1 248 581 3325  
ben.schrode@am.jll.com

**A.J. Weiner**  
+1 248 581 3335  
aj.weiner@am.jll.com



**About JLL**

JLL (NYSE: JLL) is a leading professional services firm that specializes in real estate and investment management. Our vision is to reimagine the world of real estate, creating rewarding opportunities and amazing spaces where people can achieve their ambitions. In doing so, we will build a better tomorrow for our clients, our people and our communities. JLL is a Fortune 500 company with annual revenue of \$16.3 billion, operations in over 80 countries and a global workforce of over 90,000 as of December 31, 2018. JLL is the brand name, and a registered trademark, of Jones Lang LaSalle Incorporated.

For further information, visit [jll.com](http://jll.com).