

Welcome to the David Rubenstein Atrium at Lincoln Center!



Photo credit: The New York Times

We are thrilled to welcome you to the David Rubenstein Atrium, where arts and civic engagement meet!

The Atrium is located at 61 West 62nd Street, between Broadway and Columbus Avenue, with the main entrance on Broadway, between 62nd and 63rd Streets.

Getting to the David Rubenstein Atrium

Travel Options:

The David Rubenstein Atrium is on the Upper West Side of Manhattan, between West 62nd and 63rd Streets and Broadway and Columbus Avenue.

BY SUBWAY: The David Rubenstein Atrium is a short distance from the **A, B, C, D** or **1** trains at 59th Street—Columbus Circle. It is a slightly longer distance from the **1** train at West 66th Street. Both subway stations are accessible via elevator.



BY BUS: The **BXM2, M5, M7, M10, M11, M20, M66, and M104** bus lines all stop within one block of the David Rubenstein Atrium.

Access-A-Ride:

The recommended Access-A-Ride address for drop off closest to the main entrance is **1883 Broadway**, between 62nd and 63rd Streets.

Pick-Up/Drop-Off:

The main entrance for performances at the Atrium is on Broadway, between 62nd and 63rd Streets. This entrance is accessible and has automatic doors.



Performance Venue: David Rubenstein Atrium

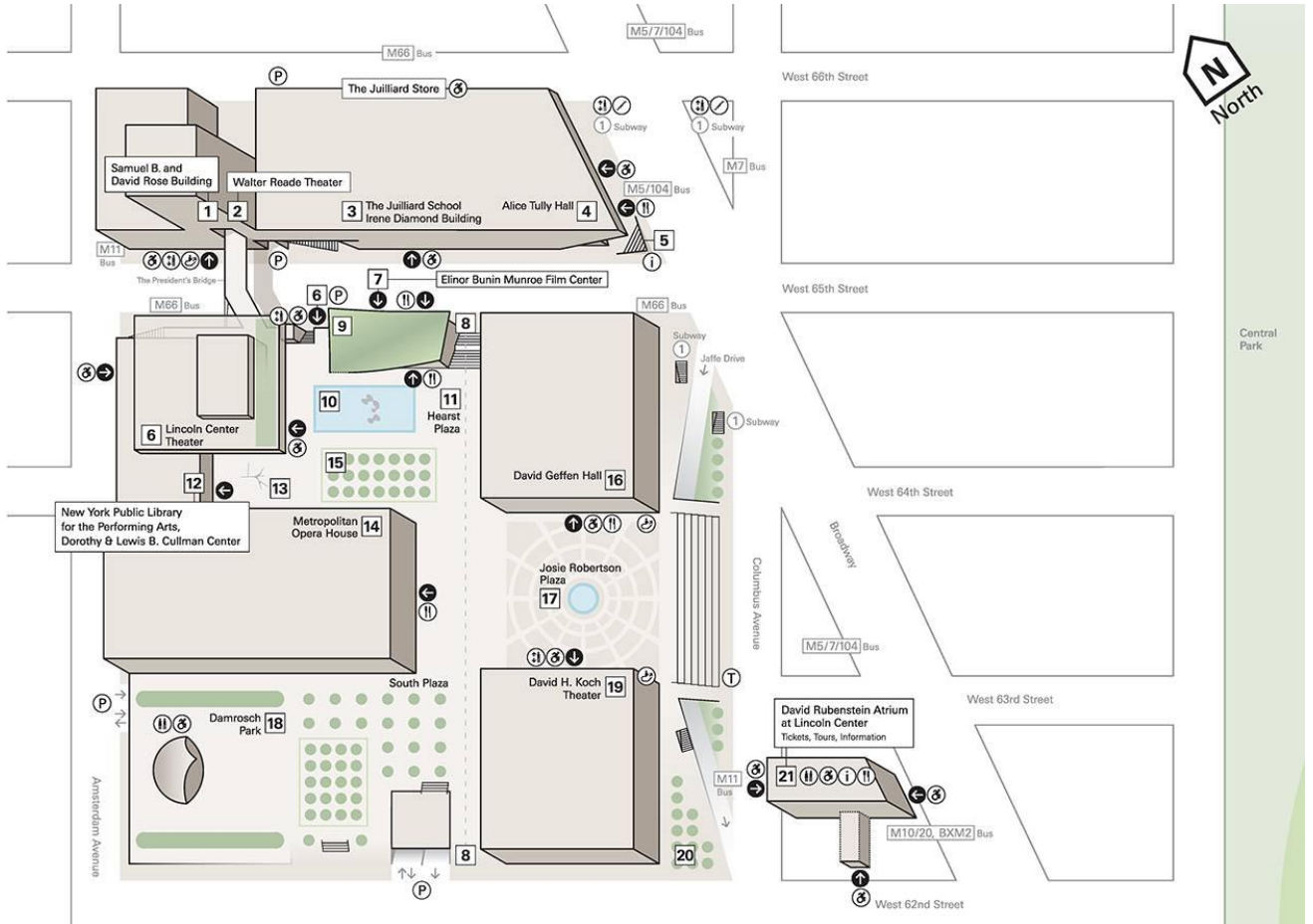

The David Rubenstein Atrium is located on Broadway and Columbus between 62nd and 63rd Streets.

Accessible Entry:

There are three accessible entrances to the Atrium. For daily public use, beginning at 8:00 am on weekdays and 9:00 am on weekends, guests are welcome to use any of the three entrances, all of which have automatic doors.

For performances, guests enter on Broadway between 62nd and 63rd Streets.

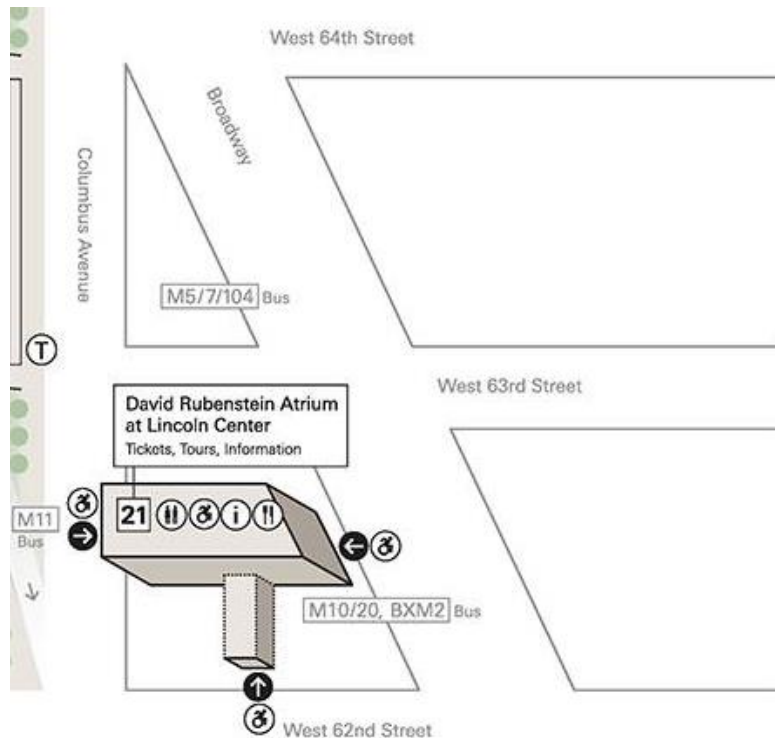

Audience Entrance and Security Checkpoint:

Tickets are not required for performances at the David Rubenstein Atrium, and admission is free and open to the public. Seating and entry are first-come, first-served; the line will form at the Atrium's entrance on Broadway, between 62nd and 63rd Street. Guests will be greeted by Lincoln Center staff who will verify proof of full vaccination received at least 14 days prior to event, along with photo ID. Boosters are encouraged but not required.

Guests will enter through a security checkpoint to scan for weapons in a quick and touchless manner.



Performance Space:

Lincoln Center staff will be available to assist in finding accessible seating and directing guests.

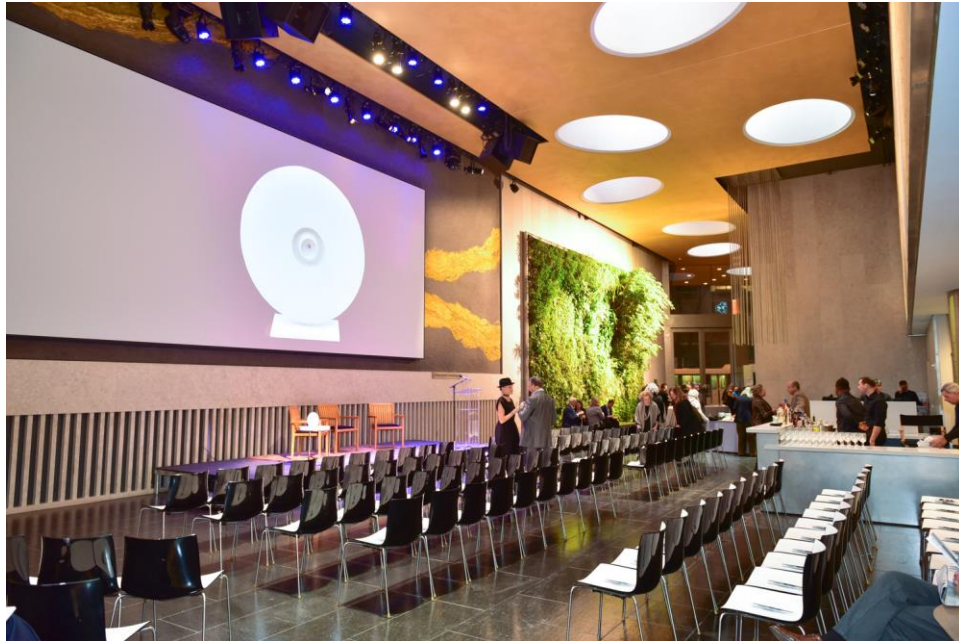

Accommodations:

There will be an Accessibility table to assist with accommodations including ear plugs and Assistive Listening Devices with headsets and neck loops.



Guests are encouraged to bring their own headphones and standard jack headsets.

Wheelchairs are available to borrow during the performance and on campus. If you require any additional accommodations, please contact access@lincolncenter.org or [212 875 5375](tel:2128755375).

Restrooms:

Guests who arrive early are advised to use the restroom if needed. Once inside the Atrium, Accessible, gender-neutral restrooms and changing tables are available. Guests are able to enter and leave seating area as needed throughout performance, as capacity allows.

While You Wait:

Guests who arrive early can explore the public areas on campus while they wait. The **Josie Robertson Plaza** features a large fountain and spectacular views of Lincoln Center.



The New York Public Library for the Performing Arts is located to the right of the Metropolitan Opera House, next to Lincoln Center Theater.



The **David Rubenstein Atrium** features beautiful plant wall installations for viewing.

