

## REFRIGERATOR TO KEGERATOR CONVERSION INSTRUCTIONS

For converting a compact  
refrigerator to a draft beer system

Your kit should include the following items:

- 1 ea: CO2 Pressure Regulator
- 2 ea: Keg Couplers, American "D" Style
- 2 ea: Beer Faucets and Knobs
- 1 ea: Draft Tower W/Beer Lines and Washers
- 2 ea: 5/16" Gas Line Assemblies, W/Clamps
- 1 ea: Spanner Wrench
- 4 ea: 10-32 x 3-1/2" Screws
- 4 ea: 10-32 Hex Nuts
- 4 ea: Flat Washer

Additional tools required (not included)

- Tape Measure
- Power Drill
- 1/4" Drill Bit
- 3" Hole Saw
- Crescent Wrench
- Phillips Head Screwdriver
- Pliers

### STEP 1:

Locate and mark on the top of the refrigerator where you would like the beer tower to be. Make sure there is enough room in front of the tower for a drip tray (not included), about 5". You may want to use masking tape to cover this area to prevent scratching. Drill a 1/4" pilot hole through the top of the refrigerator. Keep the drill as perpendicular to the top as possible. Next, cut a 3" hole through the top using the hole saw and the pilot hole as your guide. You may need to cut from both sides of the top.

### STEP 2

Take the tower and drop the beer lines through the hole you just cut. Position the tower with the faucets facing the front of the refrigerator. Mark the location of the (4) mounting holes. Remove the tower and drill the marked holes with the 1/4" drill bit.

### STEP 3

Again, take the tower and drop the beer lines through the 3" hole. Attach the tower using the provided screws, washers and nuts.

### STEP 4

Attach the beer lines to the keg couplers. Remove the blue caps from the keg couplers and attach the wing nuts to the coupler. Make sure the black beer washers are in place to prevent any leaks. (See FIGURE 1)

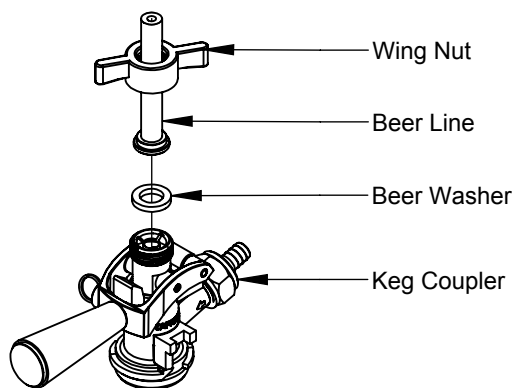

FIGURE 1

### STEP 5

Attach the gas lines to the keg couplers. Soak the gas lines in HOT water for a minute to soften the lines. Once the lines are softened, simply slide the lines over the barbed gas inlets of the couplers. Using a pliers, squeeze the plastic clamps to tighten. (See FIGURE 2)

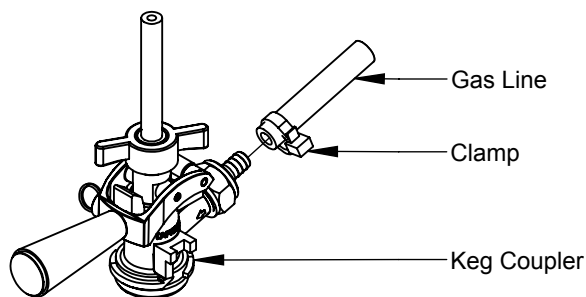

FIGURE 2

### STEP 6

Attach the other end of the gas lines to the CO2 regulator. Again, soak the lines in HOT water to soften. Slip the lines onto the barbed outlet of the CO2 regulator and clamp. (SEE FIGURE 3)

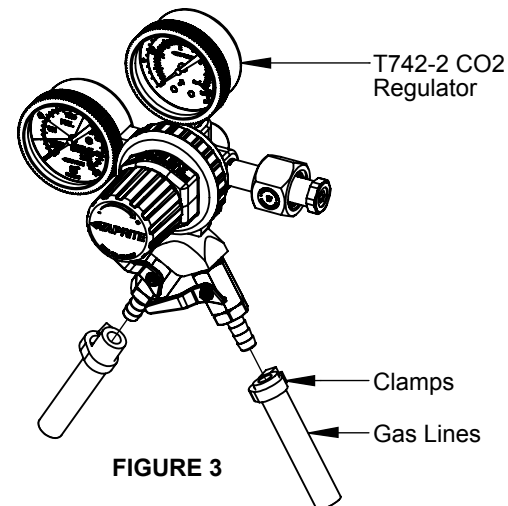

FIGURE 3

### STEP 7

Attach the faucets to the draft tower using the spanner wrench to tighten. (SEE FIGURE 4)

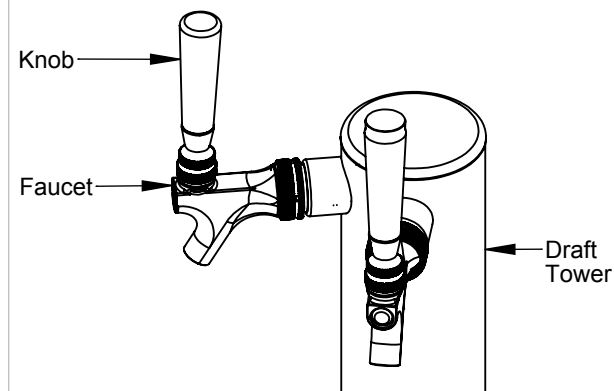

FIGURE 4

You are now ready to attach the regulator to a CO2 tank, tap your first keg and enjoy a draft beer at home! For tips and tricks on how to get the most out of your draft beer system visit [www.draughtquality.org](http://www.draughtquality.org). Enjoy!