

Capresso

frothTM
PLUS

Automatic Milk Frother

- Operating Instructions
- Warranty



Model #204

Visit www.capresso.com
for fun and delicious milk frother recipes.

Patented Frothing Technology

Read all instructions before operating the appliance.

IMPORTANT SAFEGUARDS

When using electrical appliances, basic safety precautions should always be followed, including the following:

- Read all instructions.
- After having the packaging removed, check that the appliance is intact. If in doubt do not use the appliance and contact your sales agent.
- The parts of the packaging, plastic bags etc. must not be left within the reach of children as they are potential sources of danger.
- DO NOT touch hot surfaces. Use handles or knobs.
- To protect against fire, electric shock and personal injury do not immerse cord, plugs, or appliance in water or other liquid.
- Never immerse the base in water or any other liquid for cleaning.
- The appliance is not intended for use by persons (including children) with reduced physical, sensory or mental capabilities, or lack of experience and knowledge, unless they have been given supervision or instruction.
- Close supervision is necessary when any appliance is used by or near children.
- Unplug from outlet when not in use and before cleaning. Allow to cool before putting on or taking off parts, and before cleaning the appliance.
- DO NOT operate any appliance with a damaged cord or plug or if the appliance has been damaged in any manner. Return the appliance to the nearest shop for examination or repair or send back to company.
- The use of accessory attachments not recommended by the appliance manufacturer may result in fire, electric shock or personal injury.
- DO NOT use outdoors.
- DO NOT let cord hang over edge of table or counter, or touch hot surfaces.
- DO NOT place on or near a hot gas or electric burner, or in a heated oven.
- Always attach plug to appliance first, then plug cord into the wall outlet.
- To disconnect, turn the power switch off, then remove plug from wall outlet.
- DO NOT use appliance for other than intended use.
- Use extreme caution when disposing hot steam.
- The milk pitcher is not suited for microwave use.
- Only the supplied milk pitcher can be placed on heating platform of the base.
- DO NOT use a cracked pitcher or a pitcher having a loose or weakened handle.

SAVE THESE INSTRUCTIONS FOR HOUSEHOLD USE ONLY.

SPECIAL CORD SET INSTRUCTIONS

Regarding your Cord Set:

- A.** A short power-supply cord (or detachable power-supply cord) is provided to reduce risks resulting from becoming entangled in or tripping over a longer cord.
- B.** Longer detachable power-supply cords or extension cords are available and may be used if care is exercised in their use.
- C.** If a long detachable power-supply cord or extension cord is used, (1) the marked electrical rating of the detachable power-supply cord or extension cord should be at least as great as the electrical rating of the appliance, (2) if the appliance is of the grounded type, the extension cord should be a grounding type 3-wire cord, and (3) the longer cord should be arranged so that it will not drape over the counter top or table top where it can be pulled on by children or tripped over.

Notice: This appliance has a 3-prong grounded plug. To reduce the risk of electrical shock, this plug will fit in an outlet only one way. If the plug does not fit in the outlet, contact a qualified electrician. DO NOT modify the plug in any way.

CAUTION:

This appliance is for household use. Any servicing other than cleaning and user maintenance should be performed by an authorized service representative.

- Do not immerse base in water or try to disassemble.
- To reduce the risk of fire or electric shock, do not remove the base. No user serviceable parts inside.
- Repair should be done by authorized service personnel only.
- Check voltage to be sure that the voltage indicated on the name plate agrees with your voltage.
- Keep your hands and the cord away from hot parts of the appliance during operation.
- Never clean with scouring powders or hard implements.

WELCOME AND THANK YOU

Thank you for choosing the Capresso froth PLUS™. This compact and space saving item froths and heats your milk completely and automatically. It is easy to use, easy to clean. Use it for hot chocolate, frothed milk and iced cappuccinos. Use the second heat setting to serve hot chocolate at the right temperature for small children. Please read all of the instructions in this booklet before operating your new machine. Understanding and complying with these instructions is essential to ensure that the machine is utilized without risk and to ensure safety during operation and maintenance.

HOW TO REACH JURA CAPRESSO

Should you require further information or if particular problems occur that are not covered in this manual, please

- CALL our toll free HELP LINE: 1-800-767-3554 Monday -Thursday 8AM to 9PM, Friday 8AM to 8PM and Saturday 9AM to 5PM Eastern Standard Time.
 - FAX us at 1-201-767-9684
 - E-MAIL us at contact@jura-capresso.com
 - VISIT our website at www.capresso.com
 - WRITE to Jura Capresso Inc., Customer Service, P.O. Box 775, Closter, NJ 07624
-

Fig. 1

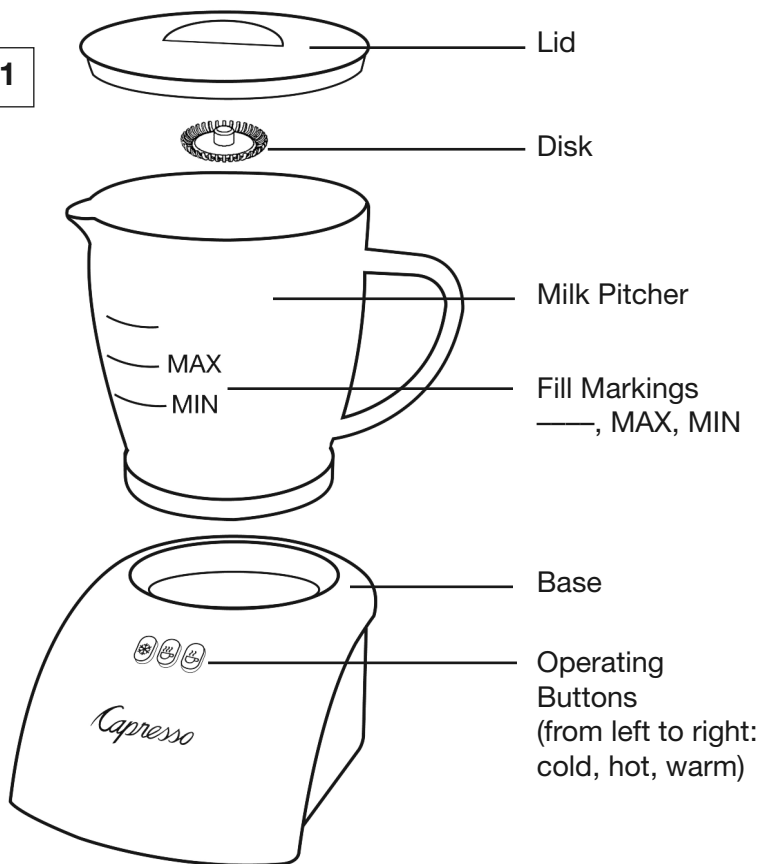
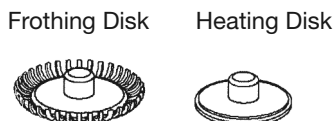
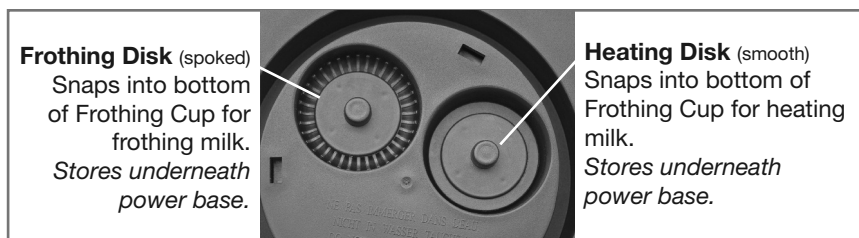

Fig. 1a



Using the froth PLUS™

The froth PLUS™ Automatic Milk Frother comes equipped with a milk pitcher with lid, two frothing disks, one heating disk and the base unit. One of the disks is installed inside the milk pitcher. The other disk and the heating disk are stored underneath the base of the appliance.



Before First Use

Clean the milk pitcher and the disks under running warm water. Make sure the underside of the milk pitcher is completely dry.

CAUTION:

Maximum Capacity - FROTHING: never fill more than 8 oz.
(see MAX marking inside milk pitcher)

Maximum Capacity - HEATING: never fill more than 12 oz.
(see "—" marking inside milk pitcher)

Using the Frothing Disk

Never fill more than 8 oz. of milk or chocolate milk into the milk pitcher ("MAX" marking); otherwise, hot milk could spill over the milk pitcher onto the heating platform. This may damage the interior parts of the machine.



Using the Heating Disk:

Never fill more than 12 oz. of milk or chocolate milk into the milk pitcher ("—" marking).

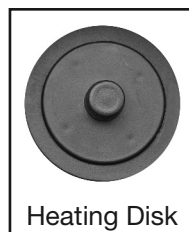

Making Milk Froth

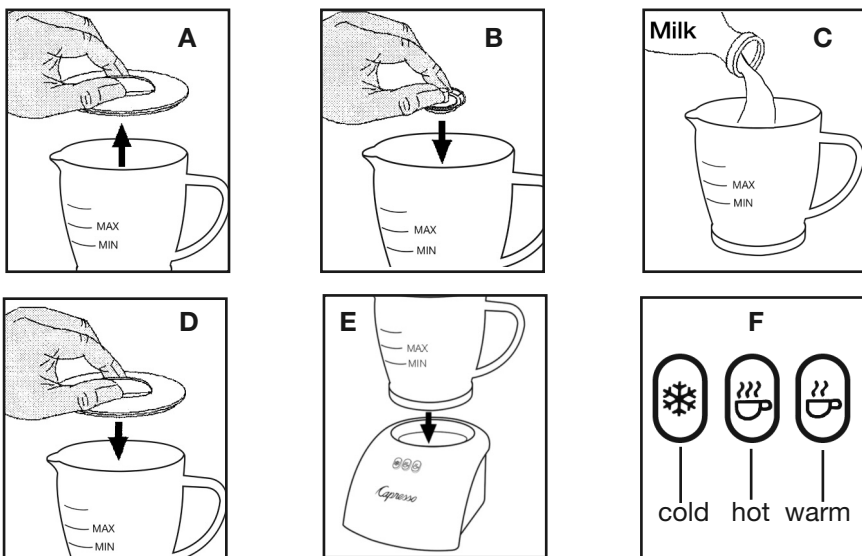

Hot Frothing and Heating Milk

Good for hot beverages such as cappuccinos, lattes, hot chocolate, milk steamers.

1. Plug in appliance.
2. Remove lid from milk pitcher. (A)
3. Place one of the frothing disks or the heating disk into the bottom of the milk pitcher. Ensure the disk is completely snapped in. (B)
4. Make sure underside of the milk pitcher is dry.
5. Pour fresh cold milk into the milk pitcher (C) and replace lid. (D)
6. Place pitcher on heating platform. (E)
7. For frothing and heating push the middle button (hot) or right button (warm). (F)
8. The button illuminates and the frothing/heating action starts automatically.
9. When the milk has reached the maximum temperature, the appliance will automatically shut off. The indicator light turns off and the frothing action stops.

CAUTION: The milk pitcher is now very warm; the bottom of the pitcher is hot. Only place the milk pitcher on a heat resistant surface.

10. Let the warm, frothed milk sit for a few seconds.
11. Pour the warm milk into your cup and spoon the froth on top.
12. Always unplug from outlet when not in use and before cleaning. Allow to cool before putting on or taking off parts, and before cleaning the appliance

Cold Frothing and Mixing Milk

Good for cold beverages such as iced cappuccinos, iced fruit lattes, cold malts, mixing chocolate milk.

Follow steps 1 through 6 above in “Frothing and Heating Milk”

1. For cold frothing or cold mixing (incorporating chocolate syrup into milk, mixing malt powder, etc) push the left button (cold). (F)
2. The button lights and the frothing/mixing action starts automatically.
3. After a few minutes, the appliance will automatically shut off. The indicator light turns off and frothing stops. Alternatively, you can press the cold button again to stop frothing or mixing at any time.
4. Pour milk into cup and spoon froth on top.
5. Always unplug from outlet when not in use and before cleaning.

Please note:

- When you remove the milk pitcher from the appliance during operation, the item will automatically shut off. When replacing the pitcher, you need to push one of the three buttons to start it again.
- If the heating plate or the bottom of the milk pitcher is still hot, the appliance may not turn on. In this case, remove the milk pitcher. Cool it down by running it under cold water. Make sure the underside bottom is dry and start over.

CAUTION: Do not place the milk pitcher in the microwave oven or on any other heating surface.

Types of Milk

All kinds of milk can be used with this appliance (Whole, 2%, 1%, skim, soy milk, almond milk, rice milk). Skim milk will produce the thickest, most stable froth. Soy milk will produce froth with somewhat larger bubbles, but the froth is not as stable.

Cleaning

1. Unplug the item and let it cool down.
2. Remove the frothing disk or the heating disk from the milk pitcher. Clean under running warm water.
3. The milk pitcher and lid are dishwasher safe (top-rack).
4. Wipe the heating plate with a moist cloth.
5. Discoloration of the heating plate may occur if milk spills onto the heating plate. Scrub lightly with baking soda.

Froth / Heating Disk Storage

One disk can be kept inside the milk pitcher. The two other disks can be stored underneath the base of the appliance.

Additional Milk Pitcher and Disks

Order an additional milk pitcher or disks by calling our Customer Service Hotline at: **1-800-767-3554** or by visiting **www.capresso.com**.

LIMITED WARRANTY

This warranty covers your Capresso machine Model # 204. This warranty is in effect for one year from the date of the first consumer purchase and is limited to the United States of America. This warranty covers all defects in materials or workmanship (parts and labor). Jura Capresso will repair or replace your machine within one year from the date of the first consumer purchase. Jura Capresso will pay for the repair or replacement and the freight back to your destination within the United States.

The warranty does not cover:

- Any machine not distributed by Jura Capresso within the United States.
- Any machine not purchased from an Authorized Jura Capresso Dealer.
- Commercial use of the machine.
- Damage caused by accident, abuse, negligence, misuse, improper operation or failure to follow instructions contained in this manual.
- Any service or alteration performed by an unauthorized person, company or association.
- Any used machines bought at auctions and unauthorized websites.

Other limitations and exclusions:

Any implied warranties including fitness for use and merchantability are limited in duration to the period of the express warranty set forth above and no person is authorized to assume for Jura Capresso any other liability in connection with the sale of the machine.

Jura Capresso expressly disclaims liability for incidental and consequential damages caused by the machine. The terms "incidental damages" refers to the loss of the original purchaser's time, loss of the use of the machine or other costs relating to the care and custody of the machine. The term "consequential damages" refers to the cost of repairing or replacing other property which is damaged when this machine does not work properly. The remedies provided under this warranty are exclusive and in lieu of all others. This warranty gives you specific legal rights, and you may also have other rights which vary from state to state.

Jura Capresso Inc.

81 Ruckman Road, PO Box 775

Closter, NJ 07624

Tel: 800-767-3554

Fax: 201-767-9684

Email: contact@jura-capresso.com

Website: www.capresso.com