

Installation Guide

PERLATO

Perlato Slat Tall Cabinet

IMPORTANT

Before beginning installation, make sure that the cabinet is the correct model and size and conduct a thorough inspection.

1. Separate the two hanging brackets by bending and cracking apart the included hardware.

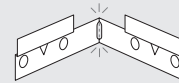

2. Determine where on the wall you would like to hang your cabinet and mark appropriately using the following guides:

Calculate the vertical position

The top edge of the hanging bracket should be positioned $1\frac{3}{4}$ " below the cabinet top.

Calculate the horizontal position

The hanging brackets should be hung with the external edges set in $\frac{3}{4}$ " from the cabinet edge.

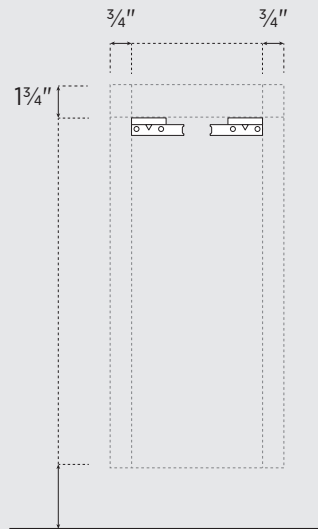

3. Drill mounting holes in wall and fasten wall brackets with screws.

Ensure brackets will be anchored to wall studs or reinforce wall for support.

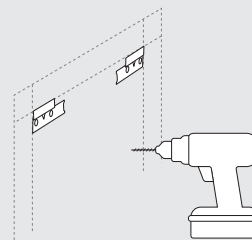

4. Remove glass shelves for protection. Hook cabinet onto wall brackets. Mount support bracket onto wall directly under cabinet base.

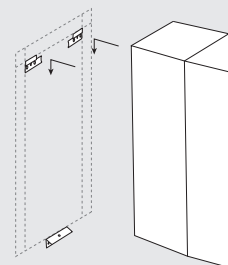

5. Adjust metal hooks if necessary to properly level cabinet and secure it to wall.

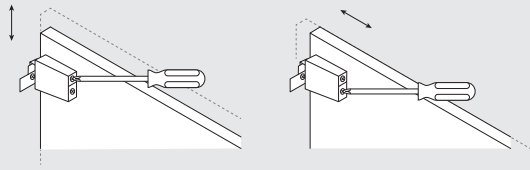

6. Replace glass shelves. Refer to instructions below if door position needs adjustment.

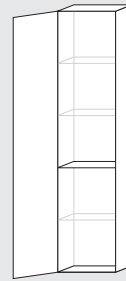

Door Adjustments *optional*

Rotate setting on hinge to align door horizontally.

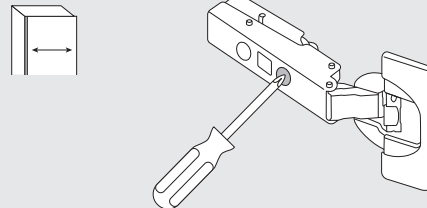

Rotate setting on hinge to align door vertically.

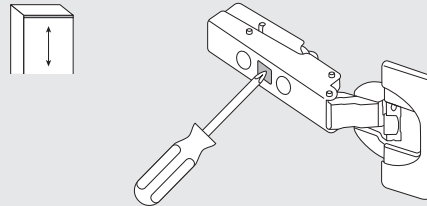

Rotate setting on hinge to bring door closer to or farther from cabinet body.

