



## **TABLE OF CONTENTS**

Experience Wichita	7
Transportation	23
Hotels & Facilities	31
Visit Wichita Services	77
Testimonials	81

# VISIT THE PERFECT LOCATION FOR YOUR MEETING WICHITA

## YOUR SEARCH ENDS HERE

If you're looking to entertain convention guests with big-city things to do like sports, the arts and nightlife, Wichita has it. If you're looking for Midwest hospitality and service to make your meeting run smoothly, your search ends in Wichita.

## ENTERTAINMENT IN THE CITY

With 33 museums, 28 art galleries and 17 festivals, Wichita is a top Midwest destination for things to do. It's the only place in the world where you can feed a rhino by hand, see one of the largest collections of American art and enjoy a night of entertainment in Old Town, a "Top 10 Best Neighborhood."

## YOUR ENTREPRENEURIAL EDGE

Come take advantage of Wichita's entrepreneurial spirit. Home to nearly 40 percent of general aviation production, Koch Industries and thriving energy and agriculture sectors, Wichita can turn your business interests into returns on investments.

## ROOM FOR YOUR GROWTH

200,000 contiguous square feet. Work with space when planning your meeting at Wichita's centrally located convention center, Century II Performing Arts & Convention Center. Connected to more than 300 hotel rooms, CII can meet the needs of your guests.

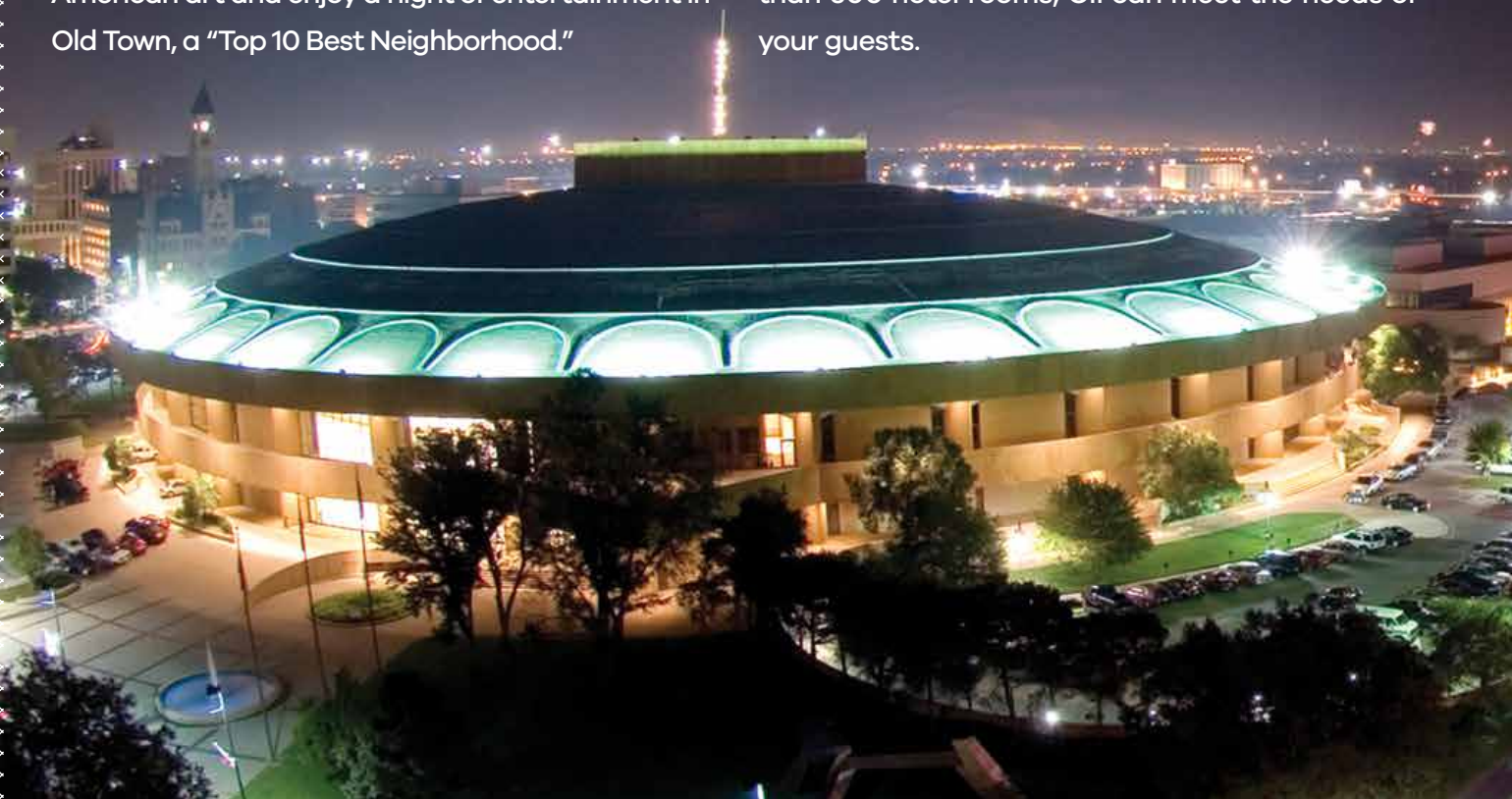



**200,000**  
square  
feet exhibition  
space

**8,000+**  
hotel rooms

**1,200+** hotel rooms  
downtown

**1** new  
airport  
terminal  
2015 | **5** major  
airlines

**1,000+**  
restaurants

**22** | **33**  
attractions | museums

**15,000**  
seat arena

[VisitWichita.com](http://VisitWichita.com)

## CROSSROADS OF THE COUNTRY

State of the art is how you'll describe Wichita's new 2015 airport terminal. You'll fly with ease on one of five major carriers including Southwest Airlines with nonstop options to most major hubs. To top it off, when you arrive you're an easy 10-minute drive to downtown Wichita's beautiful hotels on the river.

## THE NEWEST VENUES

With one of the best arenas in the country, the brand new Kansas Star Casino or modernized yet historic Drury Plaza Hotel Broadview, you'll find the best venue for your Wichita event. Let Visit Wichita help identify one-of-a-kind spaces to really impress your VIP guests.

Approximately six million visitors to Wichita, Kansas experience friendly residents, beautiful weather and easy access to many great attractions and entertainment options.



# TOP 5 WICHITA experiences

## 1. The Keeper of the Plains

The iconic Keeper of the Plains pays tribute to the Native Americans who made the area their home before the arrival of settlers. The **Keeper Plaza** embodies a sacred hoop and the four elements that make up life – earth, air, water and the “Ring of Fire,” which is lit nightly.

## 2. Wichita’s Wildlife

Take a walk with wildlife in Wichita! The **Sedgwick County Zoo** is the seventh-largest zoo in the country with world-class animal exhibits. **Tanganyika Wildlife Park** features once-in-a-lifetime interactive experiences like petting ring-tailed lemurs, giraffes and rhinos.

## 3. Vibrant Cultural Arts

Wichita’s cultural attractions are nationally known. Independent artists showcase beautiful collections during the monthly **Final Friday** art gallery crawl. **Music Theatre Wichita** is a springboard for Broadway-bound talent. The **Wichita Symphony’s** repertoire ranges from Bach to the Beatles. See other quality theater performances at **Mosley Street Melodrama** and **Roxy’s Downtown**.

## 4. Museums on the River

At **Botanica, The Wichita Gardens**, stroll through the new Chinese Garden of Friendship or a formal rose garden and enjoy the graceful fountain in the Shakespearean Garden. Don’t miss **Exploration Place, Old Cowtown Museum, Wichita Art Museum** and the **Mid-America All-Indian Center**.

## 5. Old Town Red-Brick District

The Old Town red-brick warehouse district in downtown Wichita is full of eateries and retail shops in the day and then transforms into the centerpiece of the city’s nightlife. Nightclubs offer a variety of music – rock, jazz, country, blues and reggae – within walking distance.



2



3



4



5







The spacious Gallery of Nations level of the Mid-America All-Indian Center has a spectacular view of the Keeper of the Plains and the surrounding downtown area.





## EXPERIENCE WICHITA





# MUSEUMS & ATTRACTIONS



Wichita has grown into an eclectic city with some of the best arts and entertainment in the Midwest.

## Botanica, The Wichita Gardens

701 N. Amidon • Wichita, KS 67203  
316.264.0448 • [botanica.org](http://botanica.org)

Take a guided tour through the lovely gardens of Botanica, which includes nearly 10 acres and 24 themed gardens. *Fee*

## The Coleman Company Factory Outlet Museum

235 N. St Francis • Wichita, KS 67202  
316.264.0836

Find products from the greatest name in the great outdoors, Coleman, at outlet prices. Located downtown, the Coleman Company Factory Outlet includes a museum of the company's famous products dating from 1902. *No admission fee*

## Exploration Place

300 N. McLean Blvd. • Wichita, KS 67203  
316.660.0600 • [exploration.org](http://exploration.org)

Encounter Exploration Place's hands-on exhibit areas... flight, health and Kansas environments. Looking for a fun and different team building program? Try the KEVA exhibit. Travel to faraway destinations in the CyberDome Theater. *Fee*

## Kansas Aviation Museum

3350 George Washington Blvd. Wichita, KS 67210 • 316.683.9242  
[kansasaviationmuseum.org](http://kansasaviationmuseum.org)

See some of the most notable planes in history with a Kansas connection: a Beech Starship, Boeing B-52 Stratofortress, 1934 Stearman Trainer, Boeing model 717, KC 135E refueling tanker and a 1927 Swallow. The museum also houses an archive of 200,000 photographs and documents of aviation-related memorabilia. *Fee*







## The Kansas African American Museum

601 N. Water • Wichita, KS 67203  
316.262.7651 • [tkaamuseum.org](http://tkaamuseum.org)

Art and cultural museum dedicated to the acquisition, research, education, exhibition and preservation of visual art forms, artists, and documents reflective of African American culture. *Fee*

## Kansas Sports Hall of Fame

515 S. Wichita St. • Wichita, KS 67202  
316.262.2038 • [kshof.org](http://kshof.org)

The museum showcases Kansas sports heroes, coaches and teams including Olympians, world and national champions. Encounter legends like Barry Sanders, Wilt Chamberlain, Jim Ryun, Walter Johnson, Dean Smith, Dave Stallworth and Lynn Dickey. *Fee*

## Karg Art Glass

111 N. Oliver St. • Kechi, KS 67067  
316.744.2442 • [rollinkarg.com](http://rollinkarg.com)

Watch glass blowers hard at work creating beautiful glass artwork. Glass blowers present Monday, Tuesday, Thursday and Friday 8 a.m. to 3 p.m. and Saturday 8 to 11 a.m. *No admission fee*

## Keeper of the Plains

Confluence of the Little Arkansas and Arkansas Rivers

Native Wichita artist Blackbear Bosin created this famous 44-foot sculpture to stand on land where the Wichita tribe resided. *No admission fee*

## Mid-America All-Indian Center

650 N. Seneca • Wichita, KS 67203  
316.350.3340 • [theindiancenter.org](http://theindiancenter.org)

Located in the heart of the Museums on the River district along the banks of the Arkansas River, this spacious facility houses a museum of Indian artifacts and art from many different tribes. *Fee*

## Museum of World Treasures

835 E. First • Wichita, KS 67202  
316.263.1311 • [worldtreasures.org](http://worldtreasures.org)

You will be amazed at this museum and the knowledgeable tour guides. See "Princess" the Egyptian mummy, rare coins, war artifacts, sports memorabilia and more. *Fee*

## Old Cowtown Museum

1865 Museum Blvd. • Wichita, KS 67203  
316.219.1871 • [oldcowtown.org](http://oldcowtown.org)

An accredited living history museum, Old Cowtown celebrates life in 1865-1880. The museum provides an interactive experience with costumed interpreters at a working blacksmith, newspaper office, and saloon. For group reservations call 316.350.3321. *Fee*

## Old Town Marketplace

[oldtownwichita.com](http://oldtownwichita.com)

Check out the high-energy nightclubs, one of the nation's finest movie theaters, distinctive restaurants, quaint and contemporary retail shops. *No admission fee*

## Sedgwick County Zoo

5555 Zoo Blvd. • Wichita, KS 67212  
316.660.9453 • [scz.org](http://scz.org)

From African elephants to zebras, encounter over 2,500 different animals from around the world. Visit the top outdoor family attraction in Kansas. Open 364 days a year. *Fee*

## Wichita Art Museum

1400 W. Museum Blvd.  
Wichita, KS 67203 • 316.268.4921  
[wichitaartmuseum.org](http://wichitaartmuseum.org)

Discover an internationally renowned collection of American art, dine at The Muse Cafe, shop at the Museum Store, and create your own works of art in the interactive gallery. Free admission on Saturdays. *Fee*

## Wichita-Sedgwick County Historical Museum

204 S. Main • Wichita, KS 67202  
316.265.9314 • [wichitahistory.org](http://wichitahistory.org)

A distinctive local landmark, Wichita's 1892 City Hall is home to the museum with a collection of materials reflecting the heritage of Wichita and Sedgwick County. *Fee*





# MUSIC & THEATER



## Ballet Wichita

1600 W. Douglas Ave.  
Wichita, KS 67203 • 316.687.5880  
[balletwichita.com](http://balletwichita.com)

Since 1974, Ballet Wichita has been a leading force in dance in Kansas, performing original and classical full-length dance productions in Wichita and communities throughout the state. The company's annual Nutcracker Ballet performed at Century II, with a full symphony orchestra and guest artists from across the country is one of the city's treasured cultural events. *Fee*

## Chamber Music at the Barn

4055 N. Tyler • Maize, KS 67201  
316.721.7666 • [cmatb.org](http://cmatb.org)

Each Friday and Saturday evening during the summer, enjoy wonderful professional music... everything from chamber music to jazz in a comfortable relaxed setting at the Prairie Pines Christmas Tree Farm. Have dinner in the barn or in the garden. Dinner is at 6:30 p.m. (reservations only). Doors open for the concert at 7:45 p.m. *Fee*

## The Forum Theatre Company

332 E. First Street • Wichita, KS 67208  
316.618.0444 • [forumwichita.com](http://forumwichita.com)

Located at the historic Wichita Scottish Rite, the Forum is a perfect choice for musicals, fabulous shows and high energy entertainment. Shows run Thursdays through Saturdays at 8 p.m. and Sundays at 2p.m. *Fee*

## Mosley Street Melodrama

234 N. Mosley • Wichita, KS 67202  
316.263.0222 • [mosleystreet.com](http://mosleystreet.com)

Mosley Street Melodrama lies in the heart of Wichita's historic Old Town. Reviving the 40-year-old tradition of melodrama in Wichita, Mosley Street Melodrama takes you back to the Old West where the villains abound and heroes save the day. Most of all, you are part of the action! Thursday-Saturday. *Fee*

## Music Theatre Wichita

Century II Concert Hall  
225 W. Douglas, Suite 202  
Wichita, KS 67202 • 316.265.3253  
[MTWichita.org](http://MTWichita.org)

Music Theatre of Wichita is the largest subscribed arts organization in Kansas with an international reputation for excellence. It is one of the nation's top 10 summer music theaters and is also one of the few organizations to mount all of its own Broadway scale musicals. *Fee*







**Orpheum Performing  
Arts Centre, Ltd.**

200 N. Broadway, Suite 102  
Wichita, KS 67202 • 316.263.0884  
[wichitaorpheum.com](http://wichitaorpheum.com)

The Historic Orpheum Theatre opened in 1922 as a vaudeville house. The Orpheum, the first atmospheric theater built by architect John Eberson, is ornately decorated from the plaster to a starlit ceiling. It is now being restored to its original grandeur, and is operating as a performing arts venue. The Orpheum hosts theater, musicals, concerts, movies, meetings. *Fee*

**Prairie Rose  
Chuckwagon Supper**

15231 S.W. Parallel Road • Benton, KS  
67017 316.778.2121  
[prairierosechuckwagon.com](http://prairierosechuckwagon.com)

Prairie Rose Chuckwagon Supper is a western attraction of cowboy music and entertainment and barbecue Thursday through Saturday with Sunday night gospel music. All-you-can-eat smoked brisket. Wagon and train rides. Reservations necessary. Thursday-Saturday, second and fourth Sunday. *Fee*

**Roxy's Downtown**

412 1/2 E. Douglas • Wichita, KS 67202  
316.928.2288 • [roxysdowntown.com](http://roxysdowntown.com)

Comedic, musical shows presented in a cabaret style theater. This live performance venue in downtown Wichita has the ambiance and comfort to make your entire experience one you remember. The next time you want to be entertained, create that perfect date, or simply wish to fly solo, spend a great evening with Roxy's Downtown. *Fee*

**Wichita Grand Opera**

225 W. Douglas Ave. • Wichita, KS 67202  
316.262.8054 • [wichitagrandopera.com](http://wichitagrandopera.com)

World-renowned singers, conductors, directors, and designers. Wichita Grand Opera has received awards from Opera America and the City of Wichita. Audiences will be able to derive inspiration from the "joy of opera" *Fee*

**Wichita Symphony  
Orchestra**

Century II Concert Hall • 225 W.  
Douglas Ave. • Wichita, KS 67202  
316.267.7658  
[wichitasymphony.org](http://wichitasymphony.org)

Hear performances by the state's largest symphony. With eight classic concerts, three pop concerts, two blue jean concerts and two free community concerts, the Wichita Symphony offers music for everyone. *Fee*

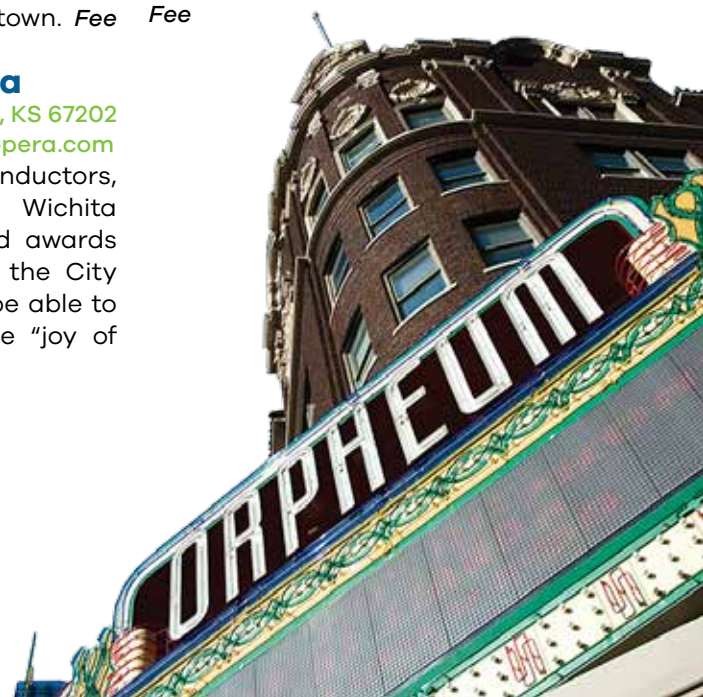





## 8 SHOPPING DISTRICTS

Looking for where to shop in Wichita? The eight don't-miss malls, boutiques and shopping centers include it all. Called "One of the most U.S. affordable cities" by NBC's Today Show, your dollar will go farther in Wichita.

### **Bradley Fair**

**2000 N. Rock Road • Wichita, KS 67206 • 316.630.9990**  
**bradleyfair.com**

With the best high-end shopping in Wichita, enjoy this beautiful open-air plaza.

### **Historic Delano**

**601 W. Douglas • Wichita, KS 67213**  
**historicdelano.com**

Home to history, eclectic shops, wonderful restaurants and a great nightlife.

### **NewMarket Square**

**2441 N. Maize Road • Wichita, KS 67205 • 316.263.3201**  
**newmarketsquare.com**

As Wichita's largest outdoor shopping center, you'll find all the name brands.

### **Old Town Marketplace**

**835 E. 1st St. • Wichita, KS 67202 • oldtownwichita.com**

With more than 100 businesses, Old Town is great shopping for art and Wichita gifts.

### **The Shops at Tallgrass**

**2111 N. Rock Road • Wichita, KS 67206 • 316.263.3201 • shopsattallgrass.com**

Stores to fit your lifestyle with everything from home décor to fashion and jewelry.

### **The Waterfront**

**1413 N. Waterfront Parkway • Wichita, KS 67206 • thewaterfrontwichita.com**

Welcome to one of Wichita's most fashionable locations and stunning views.

### **Towne East Square**

**7700 E. Kellogg Dr. • Wichita, KS 67207 • 316.686.3341**  
**towne-east-square.com**

Proudly offering more than 100 stores, Towne East is a regional destination for shopping.

### **Towne West Square**

**4600 W. Kellogg Dr. • Wichita, KS 67209 • 316.954.9374**  
**towne-west-square.com**

Towne West Square makes shopping simple, convenient and fun.





## SPECIALTY STORES

### Cocoa Dolce Artisan Chocolates

2132 N. Rock Road, Ste. 100  
Wichita, KS 67206 • 316.866.2906  
cocoadolce.com

Kansas' only Master Chocolatier creates exquisite handcrafted artisan confections. Enjoy chocolates, coffees and gelato in Kansas' only chocolate lounge. Now offering wine and chocolate pairings.

### Spice Merchant

1308 E. Douglas • Wichita, KS 67214  
316.263.4121  
thespicemerchant.com

A family-owned business, that started in 1980. Coffee freshly roasted in the shop! Spices, teas and specialty foods, bulk or small quantities. Many cooking accessories; exceptional greeting cards.

### Boot Barn

6501 W. Kellogg • Wichita, KS 67209  
316.946.3600 • bootbarn.com

Boot Barn, the largest western and work retailer, has stocked shelves with quality western wear and work wear for the entire family at a great value. At Boot Barn you'll find over 8,000 styles of boots, jeans, shirts, hats, belts, jewelry and more.

### Lucinda's

329 N. Mead • Wichita, KS 67202  
lucindasoldtown.com

You'll always find something at Lucinda's including cheeky gifts, distinctive clothing and unique accessories.

### Cero's Candies

3429 E. Douglas • Wichita, KS 67214  
316.264.5002 • ceroscandy.com

Cero's has been making gourmet quality chocolates in Wichita for more than 100 years. Visit and watch us make candy or shop online.

### Nifty Nut House

537 N. St. Francis Street  
Wichita, KS 67214 • 316.265.0571  
niftynuthouse.com

Who doesn't like a candy store?!? A Wichita tradition that has offered tremendous value, selection and service since 1937. See why Alton Brown calls it a "national treasure."





## ENTERTAINMENT & NIGHTLIFE



### ENTERTAINMENT

#### Warren Theatres East

11611 E. 13th St. N.  
Wichita, KS 67206  
316.685.3773

#### Warren Theatres West & Warren World Class IMAX

9150 W. 21st St.  
Wichita, KS 67205  
316.722.7967

#### Warren Old Town Theatre Grille

353 N. Mead  
Wichita, KS 67202  
Customer service: 316.262.7123



Teletickets: 316.773.3232  
Movie line: 316.691.9700  
[www.warrentheatres.com](http://www.warrentheatres.com)

Dinner and a movie all in one...  
Your meal is served while you  
watch the show! Warren Old  
Town Theatre boasts a full  
service restaurant. Catering  
and conference space available.

### OLD TOWN BARS & NIGHTCLUBS

**Joe's Old Town Bar & Grill** • 316.303.9885

**Heroes Sports Bar & Grill** • 316.264.4376

**Gianni Bacci** • 316.613.3350

**The Brickyard in Old Town** • 316.263.4044

**Mort's Martini & Cigar Bar** • 316.262.1785

**Oeno Wine Bar** • 316.440.5000

**River City Brewery & Loft 150** • 316.263.2739

**Emerson Biggins** • 316.303.9800

**Pumphouse** • 316.262.7867

**The Anchor** •  
316.260.8989







## MORE THAN 1,000 RESTAURANTS

Wichita has the best dining choices in Kansas. With more than 1,000 restaurants to choose from, fans of fine dining, American and ethnic food can indulge in Wichita.

Enjoy fine dining and some of the best steaks in Wichita at Chester's Chophouse and Wine Bar or the Hyatt Regency Hotel's Harvest Kitchen | Bar, which highlights locally sourced ingredients.

If you're looking for international cuisine, Wichita is as popular for hummus as potato salad with its Mediterranean choices. Authentic Vietnamese for soups and sides is a popular lunch option for Wichita's adventurous downtown



audience. Explore Wichita's Hispanic heritage by finding phenomenal street tacos and horchata at its many Latin restaurants.

See why Livability.com called Wichita a **"Top 10 Foodie City,"** and find one-of-a-kind eclectic food trucks, diners with 80-year traditions and a vibrant Restaurant Week that reflects Wichita's culinary culture.

## Wichita restaurant highlights include:

- More than 1,000 restaurants
- "The best ice cream in Kansas" by Food Network Magazine
- "One of the best food trucks in America" by thedaily meal.com
- "Best Bang for the Buck Cities" by Forbes.com





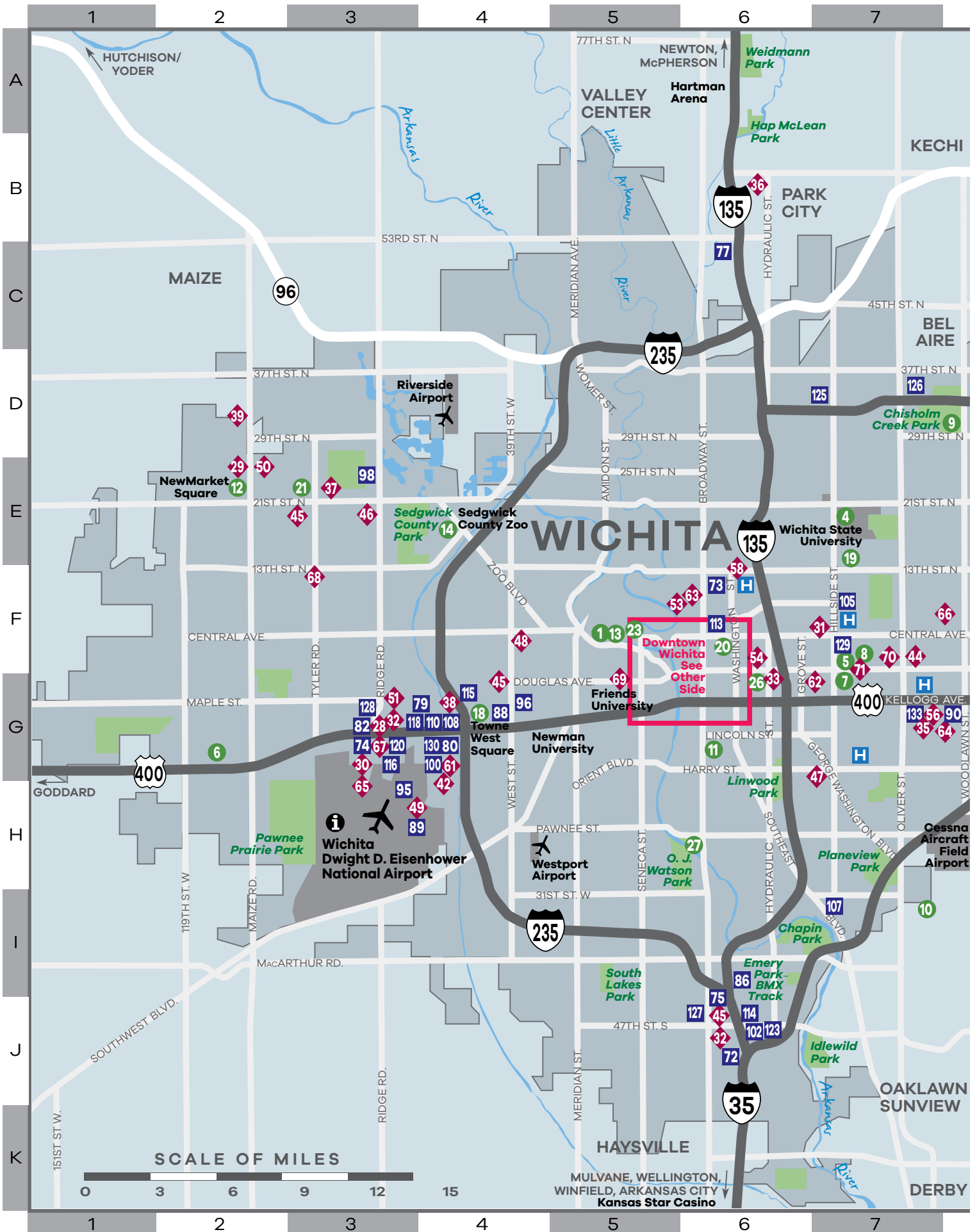



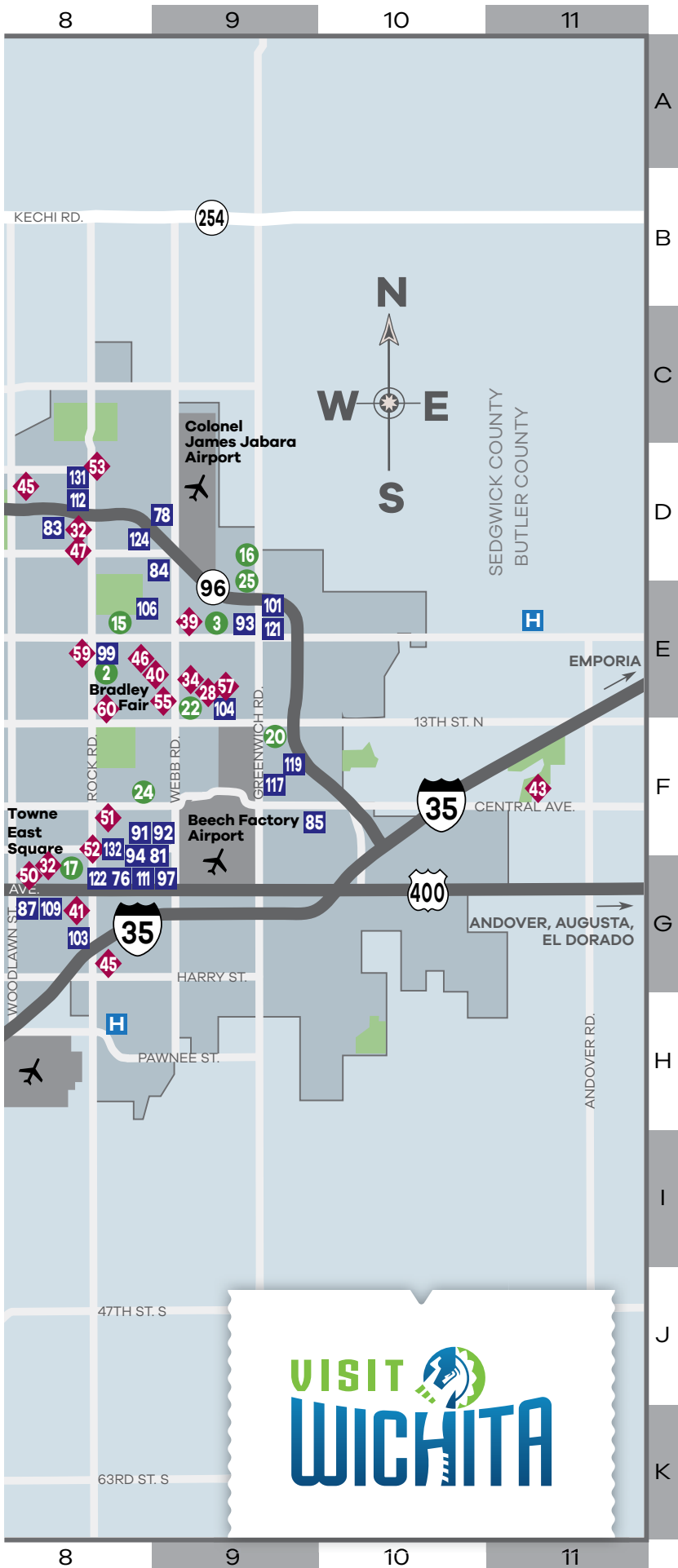

# GREATER WICHITA

**D** Dwight D. Eisenhower National Airport  
2299 S. Airport Road, 316-946-4700

## ● ATTRACTIONS

- 1 Botanica, The Wichita Gardens F-5
- 2 Bradley Fair at Wilson Estates E-8
- 3 Cabela's E-9
- 4 Charles Koch Arena E-7
- 5 Clifton Square Shopping & Offices Village F-7
- 6 The Cotillion G-2
- 7 Crown Uptown G-7
- 8 Frank Lloyd Wright-Allen House Museum F-7
- 9 Great Plains Nature Center D-7
- 10 Kansas Aviation Museum I-7
- 11 Kansas Firefighters Museum and Fallen Firefighters Memorial G-6
- 12 NewMarket Square E-2
- 13 Old Cowtown Museum F-5
- 14 Sedgwick County Zoo E-4
- 15 The Shops at Tallgrass E-8
- 16 Thunderbird Firearms Academy D-9
- 17 Towne East Square G-8
- 18 Towne West Square G-4
- 19 Ulrich Museum of Art E-7
- 20 Warren Theatres F-6, F-9
- 21 Warren Theatres IMAX E-3
- 22 The Waterfront E-9
- 23 Wichita Art Museum F-5
- 24 Wichita Center for the Arts F-9
- 25 Wichita Sports Forum D-9
- 26 Wichita Toy Train Club & Museum G-6
- 27 Wichita Water Center H-6

## ■ LODGING

- 72 Air Capital RV Park J-6
- 73 Auto Motel F-6
- 74 Best Western Airport Inn & Conference Center G-3
- 75 Best Western Governors Inn & Suites J-6
- 76 Best Western PLUS Eastgate Inn & Suites G-8
- 77 Best Western Wichita North Hotel & Suites C-6
- 78 Candlewood Suites Wichita Northeast D-9
- 79 Candlewood Suites-Wichita Airport G-4
- 80 Clarion Inn & Suites G-4
- 81 Comfort Inn East G-9
- 82 Comfort Suites Wichita Airport G-3
- 83 Country Inn & Suites by Carlson Wichita Northeast D-8
- 84 Courtyard by Marriott Wichita East D-9
- 85 CrestHill Suites F-9
- 86 Days Inn & Suites South I-6
- 87 Days Inn & Suites Wichita East G-8
- 88 Days Inn West G-4
- 89 DoubleTree by Hilton Wichita Airport H-3
- 90 English Village Inn G-8
- 91 Extended Stay America F-8
- 92 Fairfield Inn & Suites by Marriott Wichita East F-9
- 93 Hampton Inn & Suites Wichita Northeast E-9

## ◆ DINING

- 28 Abuelo's E-9, G-3
- 29 Avivo Brick Oven Pizzeria E-2
- 30 Best Western Restaurant & Catering and Wright Brothers at the Best Western Airport Inn G-3
- 31 Bocco Deli F-6
- 32 Carlos O'Kelly's Mexican Café G-3, J-6, G-8, D-8
- 33 Central Standard Brewing G-6
- 34 Chester's Chophouse & Wine Bar E-9
- 35 Churn & Burn G-7
- 36 Cracker Barrel Old Country Store B-6
- 37 Dudley's Sports Bar & Grill E-3
- 38 Flyers at the La Quinta Inn & Suites G-4
- 39 Granite City Food & Brewery D-2, E-9
- 40 Great American Grill-Hilton Garden Inn E-8
- 41 Green Mill Restaurant & Bar G-8
- 42 Hangar One Steakhouse H-4
- 43 Hereford House F-11
- 44 The Hill Bar & Grill F-7
- 45 Hog Wild Pit Bar-B-Q & Catering E-3, G-4, J-6, G-8, D-8
- 46 Jason's Deli E-8, E-3
- 47 Jimmie's Diner D-8, G-6
- 48 Le Monde Cafe & Deli F-4
- 49 Legends Restaurant & Lounge H-3
- 50 LongHorn Steakhouse G-8, E-2
- 51 McAlister's Deli F-8, G-3
- 52 MI Greatroom-Wichita Marriott G-8
- 53 Molino's Mexican Cuisine D-8, F-5
- 54 Monica's Bundt Cake F-6
- 55 Newport Grill E-8
- 56 O'Briens Irish Pub G-7
- 57 P.F. Chang's E-9
- 58 Pig In Pig Out BBQ F-6
- 59 Piccadilly Market, Grill & Bakery F-8
- 60 Redrock Canyon Grill E-8
- 61 Remington's Bar & Grill G-4
- 62 Reverie Coffee Roasters G-6
- 63 Saigon F-6
- 64 Scotch & Sirloin G-7
- 65 Solo's Diner at the Best Western Airport Inn & Conference Center H-3
- 66 Thai Tradition F-7
- 67 Texas Roadhouse G-3
- 68 Wichita Brewing Company F-3
- 69 Wichita Fish Company G-5
- 70 Wine Dive F-7
- 71 Ziggy's Pizza F-7
- 94 Hampton Inn East G-8
- 95 Hampton Inn Eisenhower Airport H-3
- 96 Hampton Inn Wichita-West G-4
- 97 Hawthorn Suites by Wyndham Wichita East G-9
- 98 Hawthorn Suites West at Reflection Ridge E-3
- 99 Hilton Garden Inn E-8
- 100 Holiday Inn Express & Suites Airport G-4
- 101 Holiday Inn Express Hotel & Suites Wichita Northeast E-9
- 102 Holiday Inn Express-Wichita South J-6
- 103 Holiday Inn Wichita East I-35 G-8
- 104 Homewood Suites by Hilton @ The Waterfront E-9
- 105 Inn at Glenstrae F-7
- 106 The Inn at Tallgrass E-8
- 107 K and R RV Park I-7
- 108 La Quinta Inn & Suites Airport G-4
- 109 La Quinta Inn & Suites Wichita East G-8
- 110 Motel 6 Airport G-4
- 111 Motel 6-East G-9
- 112 Northrock Suites D-8
- 113 Quality Inn Downtown F-6
- 114 Quality Inn South J-6
- 115 Quality Suites-Airport G-4
- 116 Regency Inn G-3
- 117 Residence Inn by Marriott East at Plazzio F-9
- 118 Scotsman Inn West, LLC G-3
- 119 SpringHill Suites by Marriott East at Plazzio F-9
- 120 SpringHill Suites Marriott Airport G-3
- 121 Staybridge Suites Wichita E-9
- 122 Super 8 East G-8
- 123 Super 8 South J-6
- 124 TownePlace Suites by Marriott D-8
- 125 USI RV Park D-7
- 126 Value Place Wichita North D-7
- 127 Value Place Wichita South J-6
- 128 Value Place Wichita West G-3
- 129 Wesley Inn F-7
- 130 Wichita Inn Airport G-4
- 131 Wichita Inn North D-8
- 132 Wichita Marriott Hotel F-8
- 133 Wichita Suites Hotel G-7



# DOWNTOWN HOTELS & ATTRACTIONS

## ATTRACTIONS

- 1 Botanic, The Wichita Gardens B-1
- 2 CityArts D-10
- 3 Coleman Factory Outlet & Museum D-9
- 4 Exploration Place D-3
- 5 Fountains at WaterWalk I-6
- 6 Gender Mountain I-5
- 7 Great Plains Transportation Museum F-10
- 8 Hatman Jack's Wichita Hat Works G-3
- 9 The Kansas African American Museum B-6
- 10 Kansas Sports Hall of Fame I-5
- 11 Keeper of the Plains Plaza C-2
- 12 Lawrence-Dumont Stadium H-4
- 13 Mid-America All-Indian Center C-2
- 14 Mesley Street Melodrama D-10
- 15 Museum of World Treasures E-10
- 16 Nifty Nuk House B-9
- 17 Old Cowtown Museum B-1
- 18 Orpheum Performing Arts Center E-8
- 19 Pinot's Palette C-10
- 20 Popul Urban Park F-7
- 21 Roxy's Downtown F-8
- 22 Warren Old Town Theatre Grille C-9
- 23 Wichita Art Museum B-1
- 24 Wichita Ice Center I-4
- 25 Wichita Scottish Rite Center E-8
- 26 Wichita-Sedgwick County Historical Museum G-7
- 27 YMCA C-7

## HOTELS AND LODGING

- 28 Ambassador Hotel Autograph Collection F-8
- 29 Courtyard by Marriott-Wichita at Old Town D-10
- 30 Drury Plaza Hotel Broadview F-5
- 31 Fairfield Inn & Suites by Marriott Wichita Downtown I-6
- 32 Hotel at Old Town E-10
- 33 Hotel at WaterWalk J-6
- 34 Hyatt Regency Wichita H-6
- 35 WaterWalk Apartments I-4
- 36 Wyndham Garden Wichita Downtown J-7

## Track Q-Line in real time

Jump on board the free Q-Line trolley and zip from Wichita's Old Town entertainment district to the Historic Delano shopping area. For more info, visit [parkdowntown.org](http://parkdowntown.org).





# DOWNTOWN DINING

- 1 The Anchor F-1
- 2 Angela's Cafe C-7
- 3 The Artchoke A-7
- 4 AVI Seabar & Chophouse E-5
- 5 B & C Barbeque C-11
- 6 The Beacon Restaurant F-10
- 7 Bite Me BBQ, Inc. E-9
- 8 Burn Out Bar & Grill I-2
- 9 Cafe Bel Ami G-7
- 10 Cow & Sow Deli F-9
- 11 Delano BBQ G-3
- 12 Delano Mexico Cafe G-4
- 13 District Taqueria F-10
- 14 Doo-Dah Diner I-7
- 15 Downtown Cafe G-7
- 16 Egg Cetera E-10
- 17 Emerson Biggins Old Town F-10
- 18 Espresso To Go G-9
- 19 Five Guys Burgers & Fries F-11
- 20 Garden Grill Cafe D-6
- 21 Gianni Bacchi's D-11
- 22 Hana Cafe D-10
- 23 Harvest Kitchen I Bar H-5
- 24 Heroes Sports Bar & Grill F-10
- 25 The Hungry Heart G-9
- 26 Joe's Old Town Bar & Grill E-11
- 27 Kyoto Garden E-6
- 28 La Galette French Bakery & Deli G-2
- 29 Larkspur Bistro & Bar F-10
- 30 Lotus Leaf Cafe E-10
- 31 Lou's Charcuteria G-9
- 32 McDonald's F-1, H-7
- 33 Mead's Corner Coffeehouse F-8
- 34 The Monarch G-4
- 35 The Muse B-1
- 36 Nu-Way G-1
- 37 Oeno Wine & Tapas Bar D-10
- 38 Old Chicago D-10
- 39 Old Mill Tasty Shop F-9
- 40 Papa John's Pizza F-6
- 41 Picasso's Pizzeria G-3
- 42 Pizza Hut G-3
- 43 Playa Azul F-10
- 44 Public at the Brickyard F-10
- 45 PumpHouse D-10
- 46 Quiznos F-6
- 47 Rain Cafe and Lounge F-9
- 48 Rubens Mexican Grill G-2
- 49 River City Brewing Company E-10
- 50 Sabor Latin Bar & Grill D-10
- 51 Sakura Japanese Restaurant G-3
- 52 Siena Tuscan Steakhouse F-8
- 53 Sonic I-7
- 54 Spangles I-8
- 55 Subway G-2, I-7
- 56 Taco Rio G-2
- 57 Tahini Mediterranean Eatery G-3
- 58 Taste & See D-10
- 59 TJ's Burger House G-2
- 60 Todd Brian's Brick Street Cafe D-10
- 61 Tom's Lotus Garden J-8
- 62 TV's Diner E-2
- 63 Vagabond G-3
- 64 Wasabi F-11
- 65 Wendy's I-7
- 66 Yo-B D-10

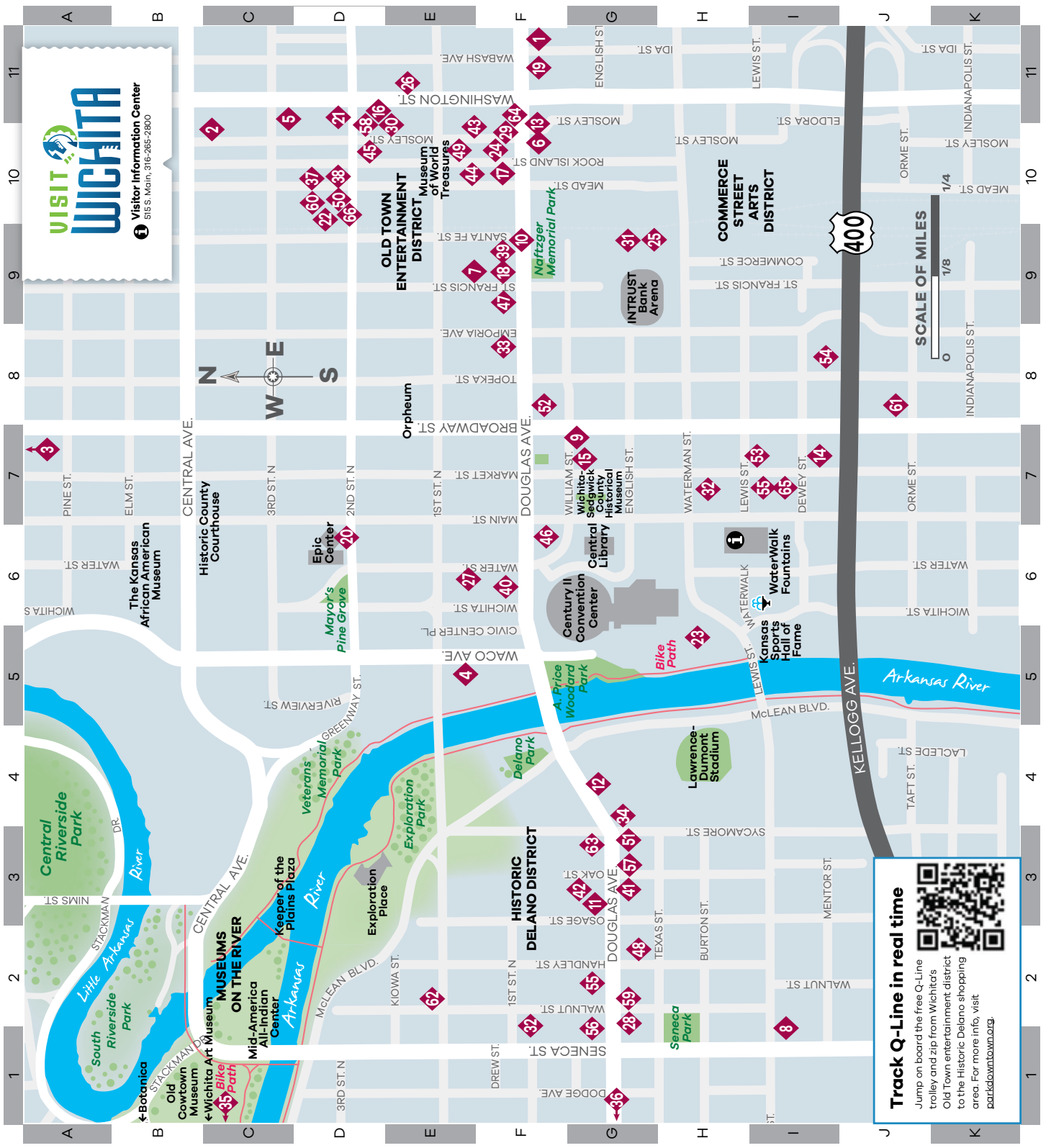

**Track Q-Line in real time**

Jump on board the free Q-Line trolley and zip from Wichita's Old Town entertainment district to the historic Delano shopping area. For more info, visit [parkdowntown.org](http://parkdowntown.org)



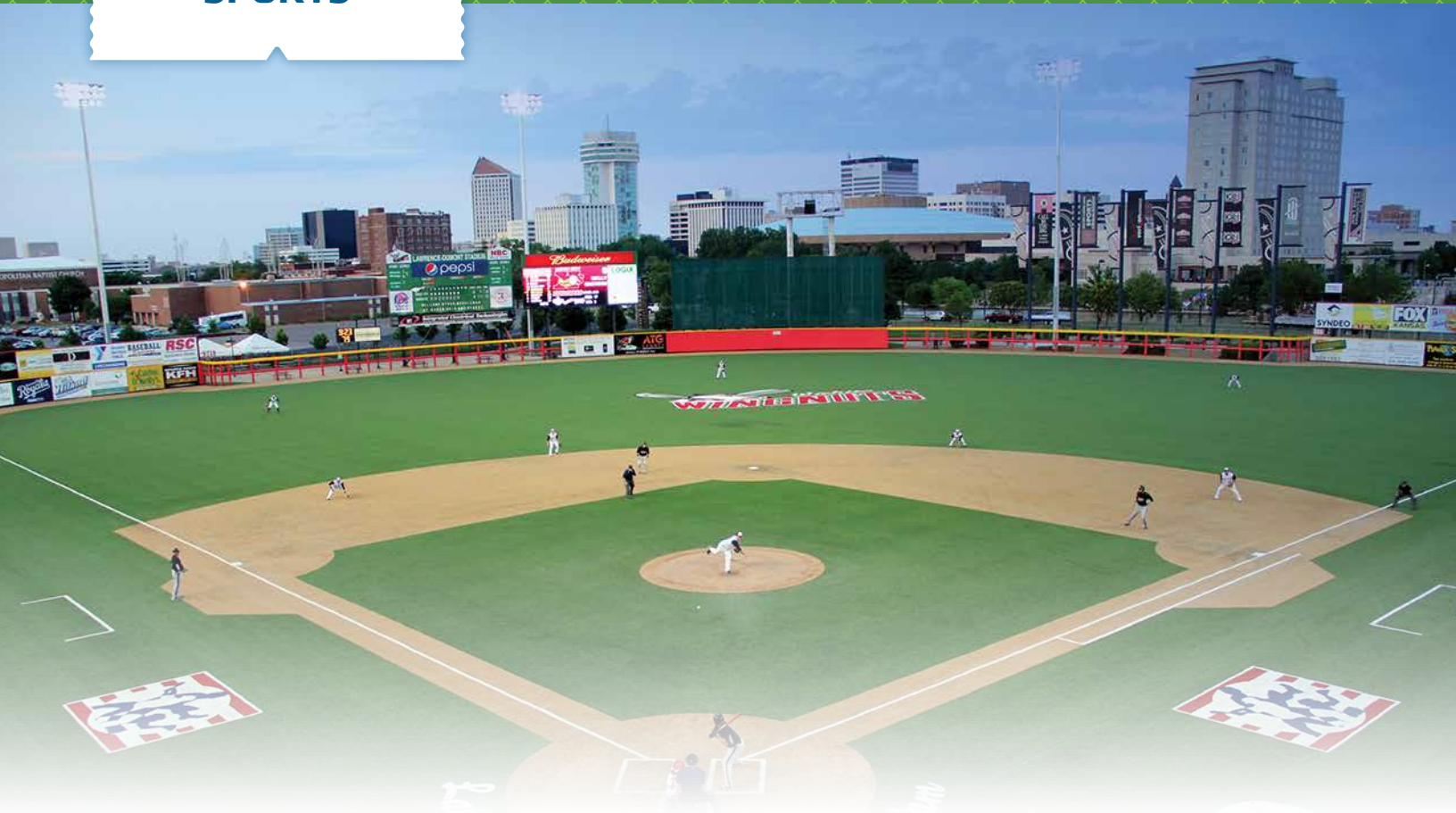

If you want to be in a community full of fans, Wichita is a top sports city. When you visit Wichita, you'll see a city energetically supporting its athletic events.

In 2013, ESPN called Wichita State's arena a "Top 10 home court advantage," and it helped propel them to a men's Final Four. Enjoy a baseball game at the NBC World Series – one of the longest running tournaments of its kind. Cheer on the hometown professional Thunder hockey team or Wichita Force indoor football team. When you visit Wichita, you won't find Cinderella. We're a Midwest powerhouse.

## A HOME COURT ADVANTAGE

### 81 Speedway

**7700 N. Broadway • Park City, KS 67219 • 316.755.1781 • 81speedway.org**

Dirt track racing on 3/8-mile oval track. Sprint, modified plus local divisions. *Fee*

### ICT Roller Girls

**(The Cotillion) 11120 W. Kellogg • Wichita, KS 67209 • ictrollergirls.com**

The ICT Roller Girls belong to the Women's Flat Track Derby Association and play multiple games throughout the Spring and Fall. All games are played at the Cotillion. *Fee*

### Wichita Force

**420 E. English, Ste. A • Wichita, KS 67202 • 316.425.3009**

The Wichita Force, members of Champions Indoor Football, is Wichita's premier sports experience. Get close to the action at INTRUST Bank Arena from February through June. Our game is hard hitting, high scoring and fast paced. Wichita Force football, it's real football real close! *Fee*

### Wichita Thunder Hockey

**300 S. Sycamore • Wichita, KS 67213 • 316.264.4625**

INTRUST Bank Arena is home of the Thunder. The Wichita hockey team belongs to the Central Hockey League. *Fee*

### Wichita Wingnuts

**300 S. Sycamore • Wichita, KS 67213 • 316.267.3372**

Wichita's amateur baseball team, "The Nuts," participate in the American Association of Independent Baseball and call historic Lawrence-Dumont Stadium home. Located on the west side of the Arkansas River, Lawrence-Dumont Stadium is one of the 15 oldest baseball stadiums still in use in professional baseball. *Fee*





## AVERAGE MONTHLY TEMPERATURES IN WICHITA

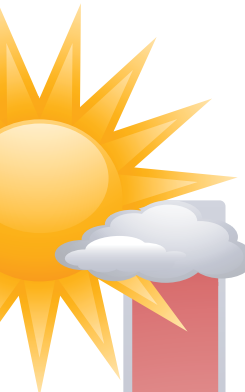

Average annual rainfall 28.61"  
Average annual snowfall 15"

Coollest Month:  
January  
Average High 39.8°  
Average Low 19.4°

Warmest Month: July  
Average High 92.9°  
Average Low 69.8°

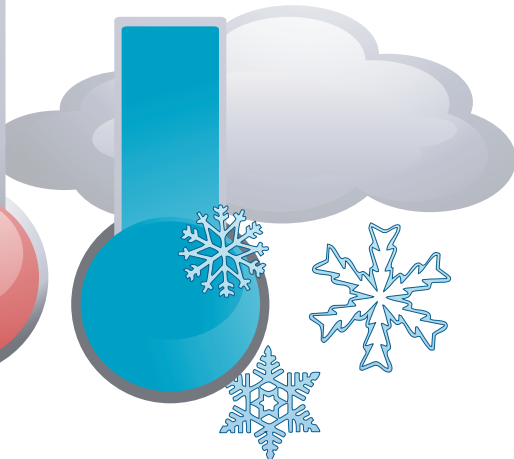

Source: Monthly weather averages, The Weather Channel





Jump on board the free Q-Line Trolley to connect to restaurants, bars, hotels, museums and entertainment venues throughout downtown. For hours and locations, visit [parkdowntown.org](http://parkdowntown.org).





# TRANSPORTATION

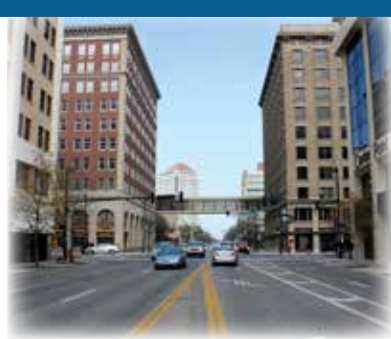





One of the best things about visiting Wichita is our central location... right in the middle of the Heartland.

Dwight D. Eisenhower National Airport is the largest airport in the State of Kansas and continues to grow and develop each year. This allows Wichita to stay competitively priced both regionally and nationally with lower airfare than neighboring cities.

## WICHITA DWIGHT D. EISENHOWER NATIONAL AIRPORT

2277 Airport Road • Wichita, KS 67209 • 316.946.4700 • [flywichita.org](http://flywichita.org)

### Great service

Wichita Dwight D. Eisenhower National Airport has non-stop air service from 10 U.S. cities with 36 to 40 daily flights and approximately 3,200 passenger seats arriving into the city daily. Arriving is easy. Wichita Dwight D. Eisenhower National Airport is located just 10 minutes from downtown Wichita.



### Its five major airlines include:

Allegiant Air • American Airlines • Delta Air Lines • Southwest Airlines • United Airlines

### Competitive pricing

Wichita Dwight D. Eisenhower National Airport has non-stop direct air service from 10 key hub-markets — Atlanta, Chicago, Dallas/Ft. Worth, Denver, Houston, Las Vegas, Los Angeles, Minneapolis, St. Louis and Phoenix/Mesa. Wichita's airfare in 2013 dropped 3.6% compared to 2012 and is down 32% overall from the year 2000. Great strides are being made each year to keep Wichita Dwight D. Eisenhower National Airport competitive with airline service and airfare.





## NEW AIR TERMINAL 2015

A new airport terminal opened June 3, 2015 and symbolizes Wichita's position as the "Air Capital of the World." The new two-story, 275,000 sq ft terminal, has a state-of-the-art modern architectural design expressing flight and Wichita's globally prominent position in the aviation industry

### The major elements of the project include:

- 12 boarding gates, each equipped with a passenger boarding bridge. Up to 16 boarding bridges in total.
- Passenger baggage handling systems with inline explosives detection security screening.
- Enhanced pre-security and post-security concessions and passenger services.
- Consolidated rental car facility counters, plus close-in parking and car return located in the covered garage.



### New terminal features

- Free WiFi throughout the terminal.
- Traveler lounge areas with Arconas Flyaway seating and 786 total outlets and USB ports - perfect for charging mobile devices on the go. There are 6 walls equipped with charging stations.
- 12 glass-walled jet bridges - the largest installation of glass jet bridges in the U.S.
- Travelers can choose from River City Brewing Co., Chick-fil-A, Dunkin' Donuts, the Air Capital Bar, Grab & Fly, or Aviators Cafe. Travelers can shop at the Air Capital Market, CNBC New Express and CNBC Smartshop.
- Larger public restrooms provide 59 stalls for women, 52 for men, and 5 family-friendly restrooms.
- Upper Mezzanine is a meet-and-greet area where travelers can receive and see off loved ones. It features modern art displays celebrating the history of aviation in Wichita. Sculpture work by artist Ed Carpenter features aluminum rods and dichroic glass that changes depending on the angle of view or light hitting it.
- The Great Hall features a street-facing glass facade comprised of 9 layers of tempered glass laminated together to allow natural light to pour into the hall, reducing the need for artificial light. Architecturally, parts of the Great Hall are designed to emulate airline manufacturing elements. The distance from ticketing to gates has been reduced up to 60 percent.





## FLIGHT INFORMATION

Airline & Ticket Counter Hours	Non-Stop Service	Daily Departures	Aircraft Equipment Operated
<b>Allegiant Air</b> • 702.505.8888 Open daily excluding Tuesday and Saturday 5 a.m. to 6:45 p.m.	Las Vegas Phoenix-Mesa Los Angeles (seasonal)	SU, Th M-F W-Sa	MD-80 MD-80
<b>American Airlines</b> • 800.433.7300 Open daily 4:30 a.m. to 7 p.m.	Dallas/Ft. Worth Chicago	4 2	MD-80 ERJ-145
<b>Delta Air Lines</b> • 800.221.1212 Open daily 4:30 a.m. to 7:30 p.m.	Atlanta Minneapolis	4 3	CRJ CRJ
<b>United Airlines</b> • 800.241.6522 Open daily 5 a.m. to 7 p.m.	Chicago Denver Houston	5 5 4	CRJ A 319 A 320
<b>Southwest Airlines</b> • 800.435.9792 Open daily 5 a.m. to 6 p.m.	Las Vegas Phoenix St. Louis	1 1 2	B737-700 B737-700 B737-300

## CHARTER TRANSPORTATION

### Midwest Corporate Aviation

3512 N. Webb Road • Wichita, KS 67226 • 316.636.9700 • [midwestaviation.com](http://midwestaviation.com)

Located at Col. James Jabara Airport, Midwest Corporate Aviation is a 24-hour full-service aviation facility. If you're looking to charter an executive jet, turboprop or piston twin craft, look no further. Whatever you need, they can arrange it. Services include: aircraft charter, fuel and line service, maintenance, repair and parts, flight instruction, sales and more.



<b>Charter Bus Transportation</b> Prices are subject to change without notice.	<b>Hours of Charter Operation</b>	<b>General Services</b>	<b>Number of Coaches</b>	<b>Associations</b>	
<b>Overland Charters</b> 3333 N. Hillside Wichita, KS 67219 316.652.9463	24/7	D, E/I, OP, LC, R, RC, RA	4	United Motor-coach Assoc.	Locally owned Overland Charters provides superior passenger transportation to 49 states, Canada and local service. Rental: 47-passenger \$330 for six hours, each additional hour \$55; 55-passenger \$360 for six hours, each additional hour \$60.
<b>First Student</b> 3610 W. 29th St. S Wichita, KS 67217 316.832.9231 firststudentinc.com	24/7		600 buses (41; 78 pass./ 14; 22 pass.)		First Student charter bus rental can save you money on group transportation. Big Bus rental: 48-passenger \$70 per hour with a three hour minimum. Mini Bus rental: 14-passenger \$70 per hour with a three hour minimum. Discount/bulk rates may apply.
<b>River City Trolley &amp; Charters</b> 8154 W. 16th Ct. Wichita, KS 67212 316.773.1931 rctrolley.com	24/7		3 trolleys		Serving the Wichita Metro Area with private charters, Christmas light tours, conventions, outings and shuttles. Specializing in elegant wedding packages in a totally enclosed trolley with etched glassed windows and climate control. Rental:\$300 for 2 hours, each additional hour \$80.
<b>Spot's Party Bus/ Corporate Transport</b> 7000 N. Seneca St. Wichita, KS 67204-1411 316.755.4826 spotspartybus.com	24/7	RA, RC	6 buses, 1 (22-pass.) coach		Wichita's original lime green party bus! Bus provides a unique, fun and safe environment for your transportation needs. There are a variety of transportation options including a new 22-passenger, air conditioned executive coach. Rental: 20-50 passenger buses: \$95-\$135 per hour with a two hour minimum.
<b>Village Tours &amp; Travel</b> 8620 W. 21st St. Wichita, KS 67205 316.721.4455 villagetours.net	24/7	D, E/I, F, LC, OP, R, RA, RC	68 buses	United Motor-coach Assoc.	Village Charters specialized in group travel all throughout North America with their headquarters and ownership right here in Wichita, Kansas. With a fleet of 70 motorcoaches, Village Charters is known as the company to call in the Midwest. Village Charters offers motorcoach as small as 27 passengers and as large as 56. Prices start as low as \$400 for a half day rental and are available 24 hours a day.
<b>Party Express Bus LLC</b> 5407 W. 63rd Wichita, KS 67215 316.943.4386	24/7		5 buses, 1 (10-pass.) van		Wichita's choice for transportation in the city. Affordable yet stylish. Air-conditioning, side-facing seats, TVs, DVD players and much more.
<b>E-Lite Tours</b> 6100 E. 21st St. N #210 Wichita, KS 67208 316.683.0000 e-litetours.com	24/7		4	American Bus Assoc.	E-lite Tours and Charter is Wichita's newest transportation company. Featuring four motorcoaches, ranging from a 32-passenger to a 57-passenger, E-lite provides local shuttle service as well as long-haul charter service. Rental: \$685 per 24-hour period; \$75 per hour with a four hour minimum.

**LEGEND:**

D=DUMPING FACILITIES • E/I=EXTERIOR/INTERIOR WASHING • F=FUEL • LC=LAVATORY CLEANING • OP=OVERNIGHT PARKING • R=REPAIR • RA=ROADSIDE ASSISTANCE • RC=REPLACEMENT COACHES • T=TOWING

## MILEAGE CHART

Time and mileage to Wichita from... (Driving time shown is approximate under normal conditions. Consideration has been given to topography, number of towns along route, congested urban areas and the speed limit imposed by each state.)

City	Miles	Hours
Albuquerque	702	11-1/5
Amarillo	417	7
Chicago	725	11-1/5
Colorado Springs	502	8
Dallas	369	6
Denver	520	8
Des Moines	401	6-1/2
Houston	602	10
Kansas City	199	3
Lincoln	274	5-1/2
Little Rock	448	7
Oklahoma City	162	2-1/2
Omaha	320	6
San Antonio	623	10-1/2
Santa Fe	584	12-1/2
Shreveport	548	9
Springfield	309	6
St. Louis	442	7
Topeka	147	2-1/2
Tulsa	176	3

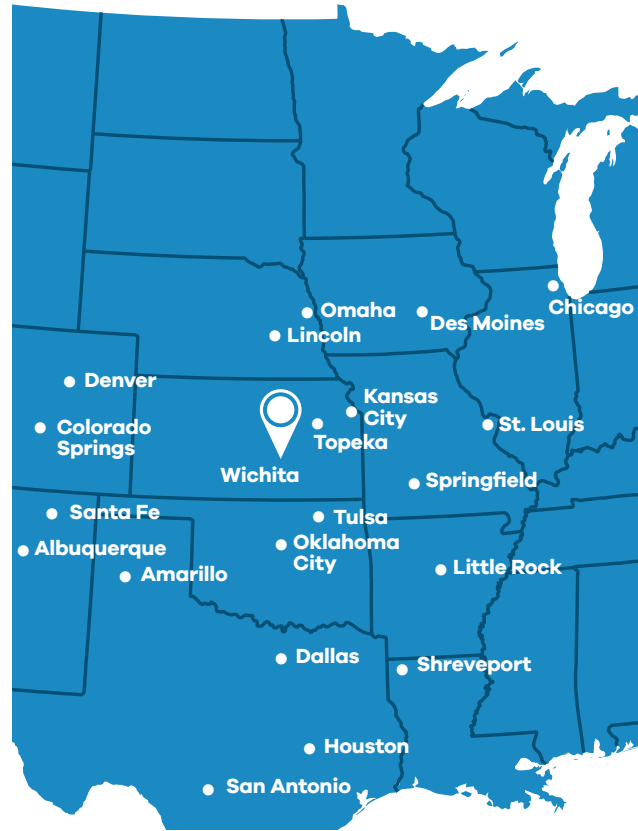

## Q-LINE

Wichita's quality of life features a transportation option that's hard to beat – the free Q-Line trolley. Jump on board and zip from hotels by the river, through Wichita's revitalized downtown and into the city's entertainment and restaurant district, Old Town.

### Hours of operation:

**Monday – Thursday** 6 p.m.-10 p.m.

**Friday** 6 p.m.-Midnight

**Saturday** Noon-Midnight

Let the Q-Line trolley be your free Wichita transportation option.





# Downtown Q-Line map and route

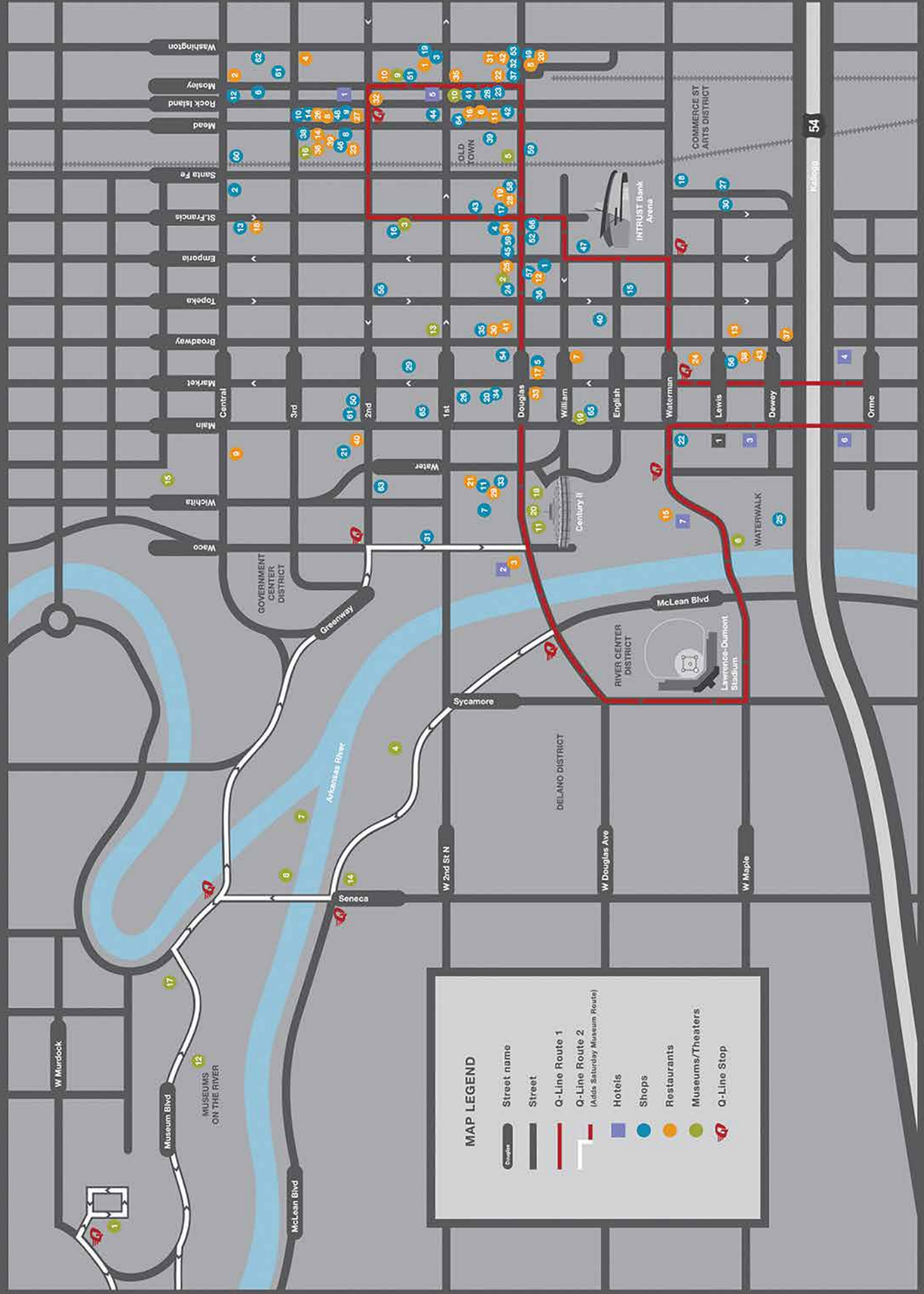

## GROUND TRANSPORTATION • COMMERCIAL AND PUBLIC

### Rental Cars

Car rental services are located in Wichita Dwight D. Eisenhower National Airport to baggage claim.

**Alamo Rent-A-Car** • 316.946.4841 • [alamo.com](http://alamo.com)

**Enterprise Rent-A-Car**  
316.946.1895 • [enterprise.com](http://enterprise.com)

**Avis Rent-A-Car** • 316.946.4882 • [avis.com](http://avis.com)

**Hertz** • 316.946.4860 • [hertz.com](http://hertz.com)

**Budget Car and Truck Rental**  
316.946.4433 • [budget.com](http://budget.com)

**National Car Rental**  
316.946.4851 • [nationalcar.com](http://nationalcar.com)

**Dollar Rent-A-Car Airport**  
316.943.2333 • [dollar.com](http://dollar.com)

**Thrifty Airport** • 877.283.0898 • [thrifty.com](http://thrifty.com)

**Payless Car Rental**  
316.941.9414 • [paylesscar.com](http://paylesscar.com)

### Public Transportation

The city bus arrives on the hour weekdays from 6 a.m. to 6 p.m. and Sat. from 7 a.m. to 5 p.m.

### Cab Services

Cab service stands are located across the driveway from Wichita Dwight D. Eisenhower National Airport's main entrance.

**ABC/American Cab Company**  
316.264.4222 or 316.262.7511

**Best Cabs** • 316.838.2233

### Van Shuttle Service

**Border to Border** • McPherson, KS  
620.241.5054 • 888.363.6500

**EMU Express** • 316.734.0100

**Tornado Transit** • 316.650.5080

### Limousine Services

**Artistic Limousine** • 316.688.5100

**S & S Limousine Service** • 316.641.5670







## HOTELS & FACILITIES





# CENTURY II PERFORMING ARTS & CONVENTION CENTER

225 W. Douglas Avenue • Wichita, KS 67202  
316.303.8000 • [www.century2.org](http://www.century2.org)



### Banquet and Meeting Rooms

Century II has fully equipped meeting rooms connected directly to the Hyatt Regency Wichita. The rooms range in size from 900 to 7,750 square feet to accommodate a variety of events. The Upper and Lower Galleries are exquisitely furnished and decorated with fine artwork to provide a relaxing retreat during meeting breaks.

### Concert Hall

The Concert Hall seats 2,195 people. It has state-of-the-art lighting and sound equipment to provide you with front row realism and a total sound performance whether it is being used for a performance, lecture or audiovisual presentation.

### Convention Hall

The Carl A. Bell, Jr. Convention Hall provides the flexibility of retractable tiered seating for both performances and exhibitions. The hall can seat 4,751 people for presentations or stage productions on a 60' x 33' stage. Remove the tiered seating for 32,000 gross square feet of exhibit space that can accommodate 110 8' x 10' booths. Open the 60' retractable wall to the adjacent Exhibition Hall, and you'll have a total of 94,500 square feet of exhibit space.

### Exhibition Hall

Exhibition Hall provides 45,000 gross square feet of exhibit, meeting or banquet space for your event. There is an additional 17,500 square feet on the mezzanine. This provides enough space for 160 8' x 10' booths on the main floor and 54 8' x 10' booths on the mezzanine or enough banquet space for 1,848 people. The hall's expansive windows offer a view of downtown Wichita.

### Expo Hall

Bob Brown Expo Hall offers 93,000 gross square feet of exhibit space and adjoins the 8,000 square foot Connecting Lobby. Expo Hall provides enough space for 450 10' x 10' booths. A 60' retractable wall creates freeflow access between Expo Hall, Convention Hall and Exhibition Hall, providing 195,500 square feet of total exhibit space. There is a seven-bay loading dock and two overhead doors, 40' x 20' and 12' x 14', respectively. Electrical outlets are located in the floor on 30 foot centers with additional utilities accessed from the catwalk system and other areas of the hall.

### Theater

The Mary Jane Teall Theater is an intimate theater that seats 652 people. This location is perfect for presentations, seminars and smaller-scale performances.







## Bob Brown Expo Hall

- 93,000 sq ft of main floor exhibit space
- 8,000 sq ft Connecting Lobby
- 450 10'x10' booths
- Opens to Convention & Exhibition Halls for a total of 195,500 sq ft
- 20,000 sq ft of meeting rooms on second level
- Access to the Hyatt on main floor

## Carl A. Bell Jr. Convention Hall

- Seating capacity for stage performance - 4,751
- Or 32,000 sq ft of main floor exhibit space
- 110 8'x10' booths
- Opens to Expo and Exhibition Halls
- ADA assisted listening system
- Stage: 33' deep, proscenium 60' wide x 29' high with forestage lift and 38 working line sets

## Exhibition Hall

- 45,000 sq ft of main floor exhibit space
- 17,500 sq ft of balcony floor exhibit space
- 160 8'x10' booths on main floor
- 54 8'x10' booths in balcony
- Opens to include Convention Hall for a total of 94,500 sq ft of exhibit space
- Stage: 28" high permanent stage for presentations

## Mary Jane Teall Theater

- Seating: 652 Continental style
- Professional stage lighting and sound system
- ADA assisted listening system
- Stage: 32' deep, proscenium 40' wide x 20' high with forestage lift
- Stage grid moves as a unit

## Concert Hall

- Seating: 2,195 Continental style, main floor 1,693 and balcony 502
- Professional stage lighting and sound systems
- ADA assisted listening system
- Stage: 49' deep, proscenium 60' wide x 29' high with forestage lift, and 38 working line sets

## Catering Service

- Hyatt Regency Wichita and Corporate Caterers of Wichita are the exclusive in-house caterers and concessionaire for Century II Performing Arts & Convention Center.  
Applies to any food & beverage served.
- Professional catering event planning
- Hyatt Regency Wichita | 316.613.6275
- Corporate Caterers of Wichita | 316.264.9167

## Ticketing Service

WichitaTIX is Century II's in-house ticketing agency.  
316.303.8100 • [www.WichitaTIX.com](http://www.WichitaTIX.com)



## CENTURY II PERFORMING ARTS & CONVENTION CENTER

- Open main floor space for more than 700 booths
- Seven-bay loading dock
- In-house electrical and telephone service
- Three professional stages
- On-site parking
- Connects to the Hyatt Regency Wichita, a 303-room hotel with conference center
- In-house catering provided by Hyatt Regency Wichita and Corporate Caterers of Wichita
- Concessions provided by Cappuccino Connections, Inc.
- Free wireless Internet throughout the facility



### Century II Performing Arts & Convention Center - Meeting Space Information

Room Name	Dimensions	Sq. Ft.	Theater	Classroom	Banquet	Conference	Exhibit Booths
MR 101 Pear A&B	60' x 30' x 12'	1,800	170	72	96	34	6
MR 102 Apple A&B	51' x 29' x 12'	1,500	130	54	64	28	6
MR 201 Peach A&B	60' x 30' x 12'	1,800	170	72	96	34	6
MR 202 Cherry A&B	49' x 37' x 12'	1,800	170	72	96	34	6
MR 203 Birch	32' x 61' x 11'	1,950	160	100	120	46	--
MR 204 Cedar	29' x 37' x 11'	1,070	84	54	60	28	--
MR 205 Maple	29' x 37' x 11'	1,070	84	54	60	28	--
MR 206 Oak	29' x 31' x 11'	900	72	45	50	22	--
MR 207 Osage	29' x 31' x 11'	900	72	45	50	22	--
MR 208 Walnut	31' x 37' x 11'	1,150	84	54	60	28	--
MR 209 A Cypress A	52' x 60' x 16'	3,120	380	200	220	--	16
MR 209 A Cypress B	52' x 30' x 16'	1,510	140	100	100	46	8
MR 209 A&B Cypress A&B	52' x 90' x 16'	4,630	520	300	320	--	26
MR 210 A Redbud A	52' x 30' x 16'	1,510	140	100	100	46	8
MR 210 B Redbud B	52' x 60' x 16'	3,120	380	200	220	--	16
MR 210 C Redbud C	52' x 60' x 16'	3,120	380	200	220	--	16
MR 210 A & B Redbud A & B	52' x 90' x 16'	4,630	520	300	320	--	26
MR 210 B & C Redbud B & C	52' x 120' x 16'	6,240	660	380	440	--	34
MR 210 A, B & C Redbud A, B & C	52' x 150' x 16'	7,750	800	500	500	--	42
Willow Room	21' x 18' x 10'	378	50	18	20	20	--
EX 201 R	25' x 35' x 12'	920	85	36	48	18	--

### Main Hall Information

Room	Sq. Ft.	Ceiling Height	Exhibit Booths	Theater	Banquet
Expo Hall	93,000	32'	450	5,000	3,000
Convention Hall	32,000	31' to 49'	110	4,751	1,120
Exhibition Hall	45,000	31' to 36'	160	3,000	1,848
Exhibition Hall Balcony	17,500	18'	54	600	480
Concert Hall	--	--	--	2,195	--
Theater	--	--	--	652	--



# CENTURY II PERFORMING ARTS & CONVENTION CENTER

225 W. Douglas Avenue • Wichita, KS 67202 • 316 .303.8000 • www.century2.org

### Promenade Level

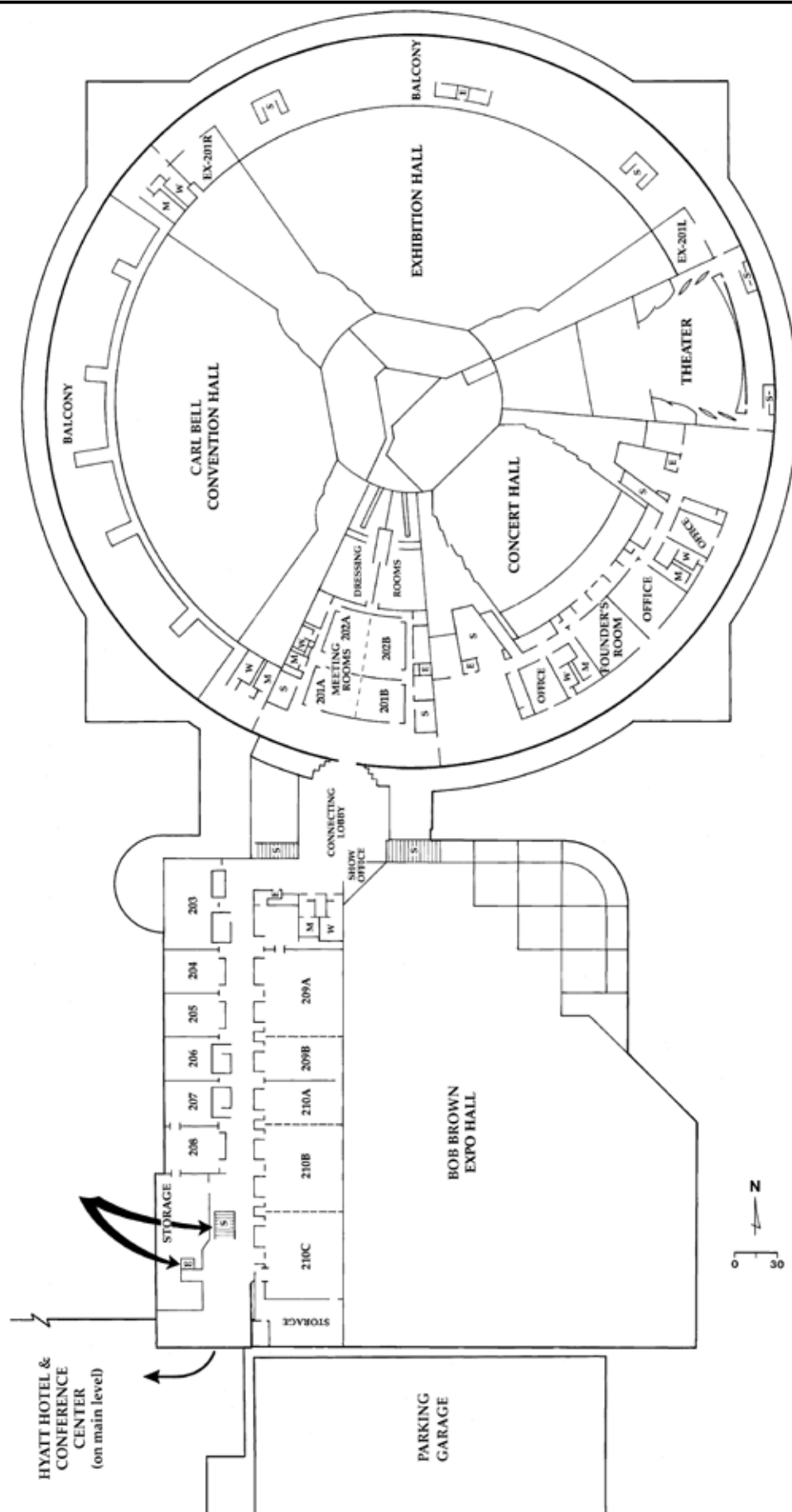

**LEGEND:** S - STAIRS • C - CONCESSION • E - ELEVATOR • M - MEN'S RESTROOM • W - WOMEN'S RESTROOM

**CENTURY II PERFORMING ARTS & CONVENTION CENTER**

225 W. Douglas Avenue • Wichita, KS 67202 • 316 .303.8000 • www.century2.org

**Ground Level**

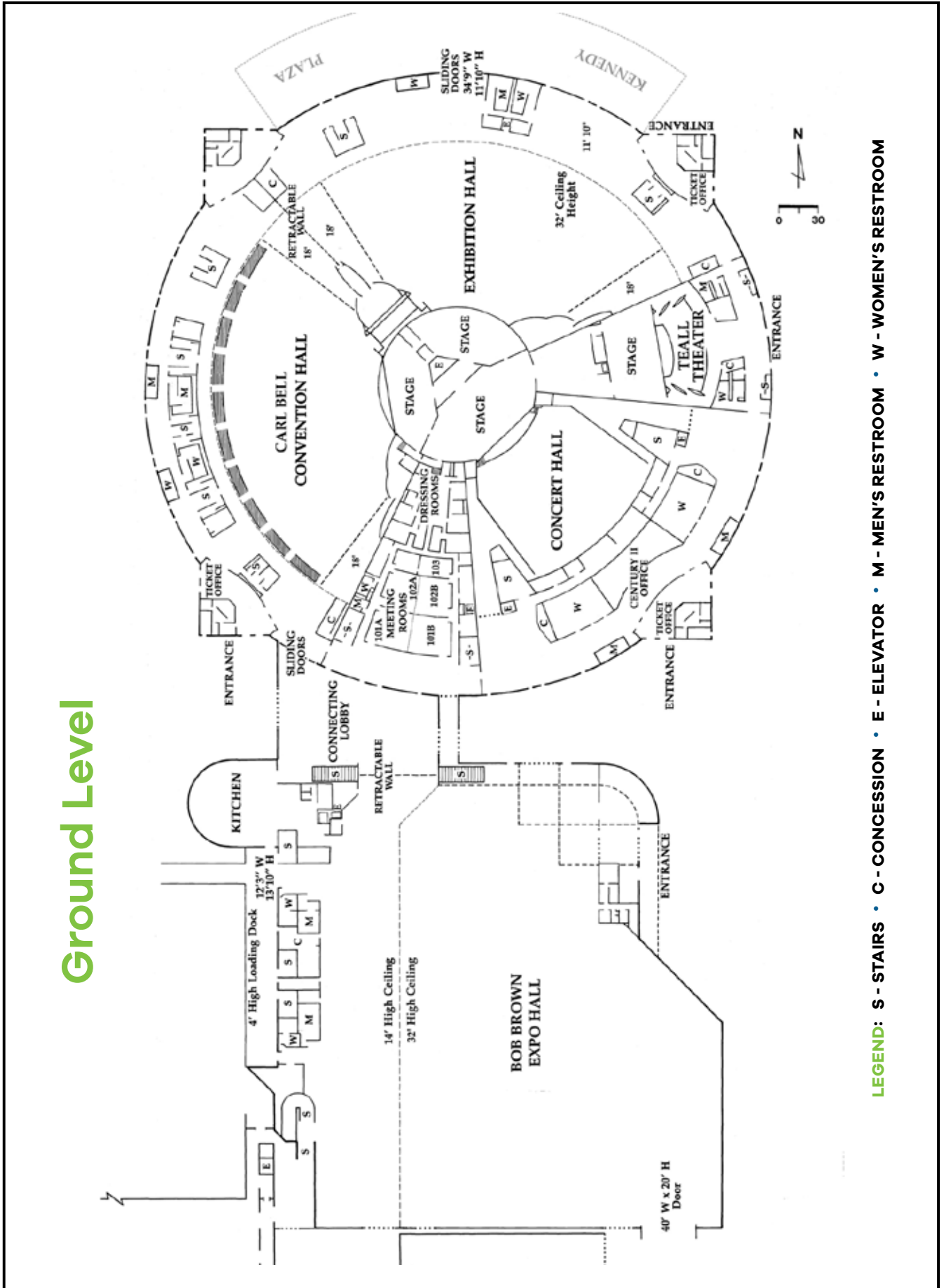

**LEGEND: S - STAIRS • C - CONCESSION • E - ELEVATOR • M - MEN'S RESTROOM • W - WOMEN'S RESTROOM**





## AMBASSADOR HOTEL

104 S. Broadway • Wichita, KS 67202  
316.239.7100  
www.ambassadorhotelcollection.com



Contemporary design meets classic style and bespoke service at the Ambassador Hotel Wichita. Located within the beautifully renovated Union National Bank Building, this Autograph Collection hotel offers luxury, comfort and signature Ambassador Hotel service. Located at Broadway and Douglas, the Ambassador is centrally located in the heart of downtown. Its convenient location offers effortless access to many area attractions.

### Meeting Room Layout

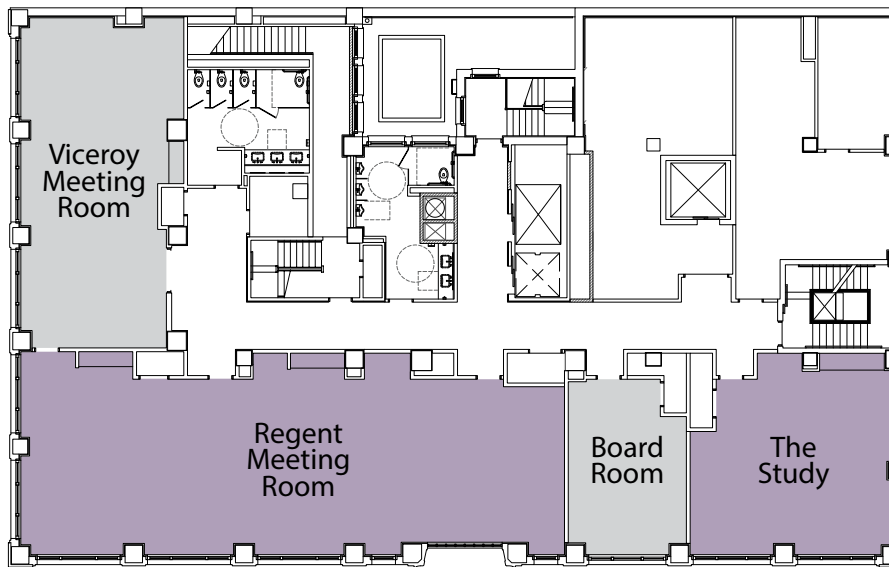

117 abundantly spacious guest rooms and suites with large windows are the perfect showcase to downtown. Delight in sophisticated ambiance and amenities with plush bedding, luxurious linens, custom furnishings, marble bathrooms and monogrammed bathrobes. Dine in the hotel's Tuscan Steakhouse, Siena, that offers inspired cuisine for breakfast, lunch and dinner.

Take advantage of the local luxury transportation, chilled bottled water and high speed Wi-Fi – always complimentary.

### Meeting Space Information

Room	Dimensions	Height	Sq Ft	Conference			Banquet		Classroom		
				Conference	Theater		Banquet		Classroom		
Viceroy	44' x 20'	9'6"	870	--	73	73	40	50	30	26	30
Regent	22' X 73'	9'6"	1,722	--	144	144	80	100	85	60	64
Board Room	15' X 23'	9'6"	346	12	--	--	--	--	--	--	--
The Study	23' X 28'	9'6"	645	--	40	40	32	40	27	16	24

## HOTELS WITH MEETING SPACE



### BEST WESTERN AIRPORT INN & CONFERENCE CENTER

6815 W. Kellogg • Wichita, KS 67209  
316.942.5600 • www.bestwestern.com



The Best Western Airport Inn & Conference Center, located a mile north of Wichita Mid-Continent Airport, offers you all the modern conveniences that you would expect from a luxury hotel with a relaxing yet elegant atmosphere. You can relax in the comfort of a deluxe guest room, enjoy the indoor pool or whirlpool, or interact with other guests in our spacious courtyard.

All rooms are extra large and constructed with solid concrete construction allowing for a quiet and peaceful night's rest. Everyone may enjoy their favorite shows on a 42" flat screen television in all our guest rooms. Best Western also has an indoor courtyard area with shuffleboard, billiards and a putting green.

#### Meeting Room Layout

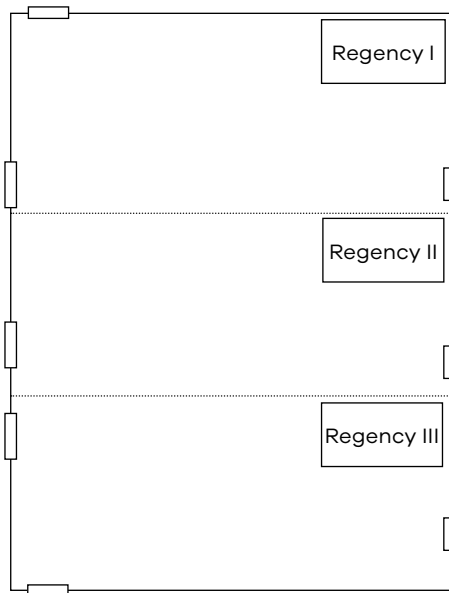

A hot breakfast is complimentary with each night's stay. Additional amenities include a microwave and refrigerator in every guest room, complimentary hi-speed wireless Internet and 24/7 airport shuttle service.



With close to 20,000 sq. ft. of banquet and meeting facilities, the Best Western Airport Inn & Conference Center can accommodate functions up to 500 people. Our goal is to exceed your expectations when planning your next business meeting, training class, convention or social event.

#### Meeting Space Information

Room	Dimensions	Height	Sq Ft	Theater	Classroom	Conference	Banquet	U-Shape
Regency I	52' x 20'	9'6"	1,560	150	85	20	100	30
Regency II	52' x 24'	9'6"	1,248	120	60	20	80	30
Regency III	52' x 32'	9'6"	1,664	230	95	20	120	30
All Regency	52' x 86'	9'6"	4,472	500	300	--	325	--
Knights	24' x 32'	9'6"	768	60	32	20	50	24
Courtyard	150' x 60'	20'	--	--	--	--	--	--





## BEST WESTERN WICHITA NORTH HOTEL & SUITES

915 E. 53rd St. N. • Wichita, KS 67219  
316.832.9387 • www.wichitabestwestern.com



A Wichita hotel with great meeting facilities and conveniently located three miles from the Kansas Pavilions. The hotel is less than 10 minutes from the downtown area. Rooms feature king or queen beds, free high-speed Internet access, cable satellite television, coffee and tea maker, iron and ironing board, and a hair dryer. Second-story rooms feature a balcony, and king suites feature a spa.

Hotel amenities include a complimentary hot breakfast buffet, an on-site restaurant and an indoor atrium with an indoor pool, hot tub, putting green, video games and ping-pong and pool tables.

BEST WESTERN Wichita North Hotel & Suites is ready to handle meetings, conventions and banquets with audiovisual equipment, catering and bar services to make your next event a success.

### Meeting Room Layout

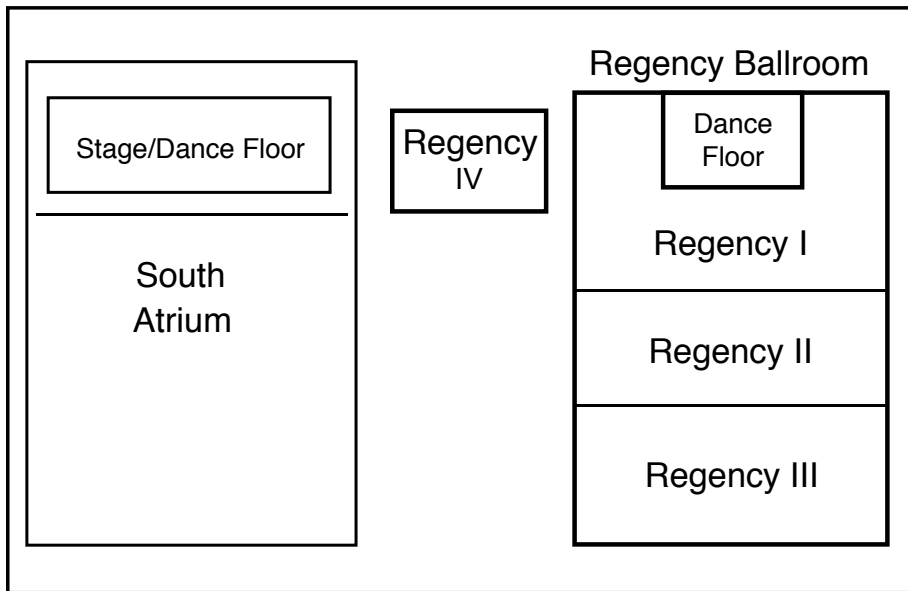

### Meeting Space Information

Room	Dimensions	Sq Ft	Ceiling Height	Theater	Banquet	Classroom
Regency I	30' x 54'	1,620	10'8"	175	125	100
Regency II	28' x 54'	1,512	10'8"	150	100	75
Regency III	40' x 54'	2,160	10'8"	225	150	125
Regency Ballroom	98' x 54'	5,292	10'8"	550	375	300
Regency IV	20' x 24'	480	8'8"	40	30	30
South Atrium <small>Main Floor</small>	80' x 105'	8,400	16'	700	500	500
South Atrium <small>Stage</small>	24' x 64'	1,536	16'	--	--	--

## HOTELS WITH MEETING SPACE



### CLARION INN & SUITES

5805 W. Kellogg • Wichita, KS 67209  
316.942.7911 • www.choicehotels.com



Clarion Inn & Suites offers business and leisure travelers the service and comfort that make them want to return. The hotel is conveniently located near Wichita Mid-Continent Airport and offers extensive meeting and event facilities.

Room amenities include coffee and tea maker, hair dryer, iron and ironing board, work desk, free Internet service, and in-room safe. Refrigerators and microwaves are available upon request. Hotel amenities include a business center, outdoor pool, fitness room, restaurant and lounge. Ask about our suites – we offer five different types.

### Meeting Room Layout

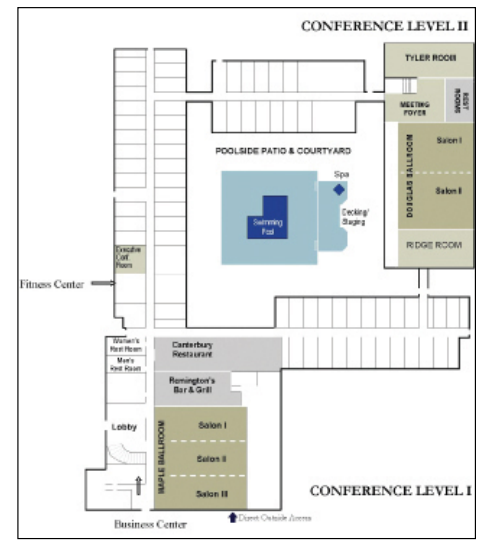

### Meeting Space Information

Room	Dimensions	Sq Ft	Theater	Classroom	Chevron	Conference	Lunch/Dinner	Reception/Dance	U-Shape
Maple Ballroom	60' x 59'	3,540	350	200	200	--	300	250	80
Salon I	18' x 59'	1,062	100	50	50	40	80	60	40
Salon II	20' x 59'	1,180	100	60	60	40	80	60	40
Salon III	21' x 59'	1,239	100	70	70	40	100	60	40
Exec. Conf. Room	25' x 24'	600	18	--	--	14	14	--	--
Poolside Patio	66' x 115'	7,590	150	--	--	--	400	400	--
Courtyard Deck	28' x 58'	1,624	50	--	--	--	100	100	--
Douglas Ballroom	62' x 46'	2,852	300	150	150	40	220	190	70
Salon I	31' x 46'	1,426	150	70	70	32	100	80	50
Salon II	31' x 46'	1,426	150	70	70	32	100	80	50
Ridge Room	31' x 46'	1,426	150	70	70	32	100	80	50
Meeting Foyer	28' x 32'	896	N/A	--	--	--	35	35	--
Tyler Room	24' x 55'	1,320	100	50	50	32	80	60	40





## COURTYARD BY MARRIOTT WICHITA AT OLD TOWN

820 E. 2nd St. N. • Wichita, KS 67202  
316.264.5300 • www.marriott.com/ictdt



Nestled in historic Old Town, the hotel has a contemporary style, an awe-inspiring atrium and is located near some of the finest restaurants, entertainment, theaters and museums in Wichita. The hotel has six floors, 128 rooms, three suites and The Santa Fe Ballroom.

Room amenities include free high-speed Internet access, spacious work area, iron and ironing board, coffee maker, refrigerator and hair dryer.

Facilities and services include the Marriott Rewards loyalty program, on-site business services, mail and packaging service. It also features an on-site business center and print-from-room option. There is the Courtyard Café for breakfast, the Market, evening lounge, as well as a hot tub, exercise room and laundry room.

The meeting rooms have catering services available, extensive A/V services to choose from, speakerphone, video conferencing, presentation board and on-site meeting planner.



### Meeting Room Layout

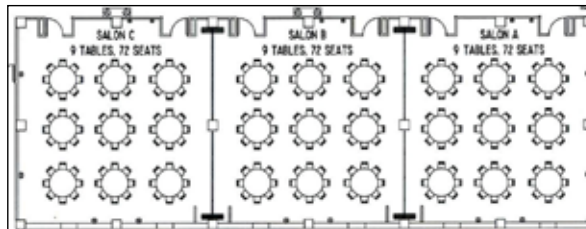

Banquet Rounds

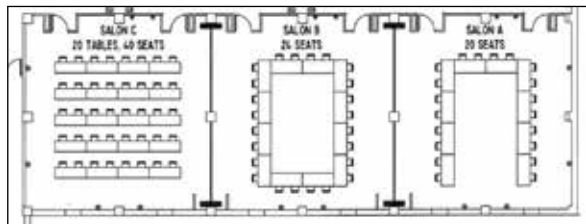

Classroom, Hollow Box, U-Shape



### Meeting Space Information

Room	Dimensions	Height	Sq Ft	Reception	Banquet	Theater	Classroom	Hollow-Box	U-Shape
Salon A	37' x 33'	10'	1,229	130	72	126	60	24	20
Salon B	37' x 34'	10'	1,232	130	72	126	60	24	20
Salon C	37' x 34'	10'	1,242	130	72	126	60	24	20
Santa Fe Ballroom	37' x 101'	10'	3,703	400	250	378	210	--	--

# HOTELS WITH MEETING SPACE



## DOUBLETREE BY HILTON WICHITA AIRPORT

2098 Airport Road • Wichita, KS 67209  
316.945.1970 • [www.wichitaairport.doubletree.com](http://www.wichitaairport.doubletree.com)

### Meeting Room Layout

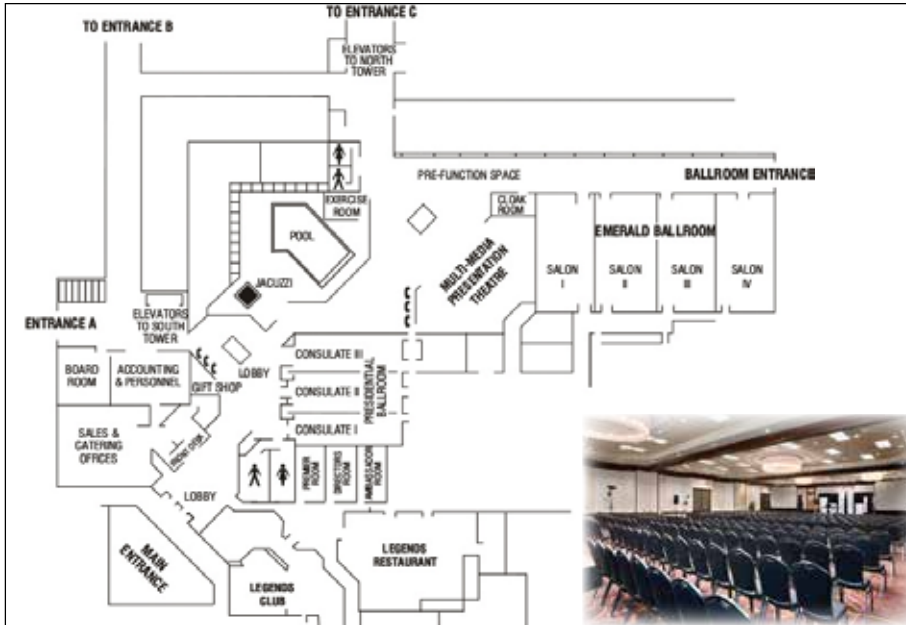

The award-winning DoubleTree by Hilton Wichita Airport is less than one-eighth mile from Wichita's Dwight D Eisenhower Airport. Visitors can enjoy a convenient West Wichita location for corporate travel, conventions or a weekend getaway in Wichita, you'll enjoy the warm hospitality of the staff and comfort of luxurious DoubleTree by Hilton hotel accommodations.

Features include complimentary wireless Internet, shuttle service within a 3-mile radius, indoor pool, fully equipped fitness center and complimentary parking. Flexible meeting space can accommodate groups of 5 to 500. Executive Level rooms include complimentary hot breakfast, evening hors d'oeuvres (Sun-Thurs) and nightly turn-down service. Legends Restaurant & Lounge, a local favorite is on site.



### Meeting Space Information

Room	Sq Ft	Dimensions	Height	Classroom	Theater	Banquet	Reception	Conference	U-Shape	H-Square
Ambassador Room	228	24' x 14'	10'	--	--	12	--	--	--	--
Board Room	727	29' x 25'	8'	--	--	--	--	--	16	--
Consulate I	1,042	53' x 19'	12'	50	80	60	125	26	20	26
Consulate II	1,042	53' x 19''	12'	50	80	60	125	26	20	26
Consulate III	1,042	53' x 19'	12'	50	80	60	125	26	20	26
Control Tower	727	--	10'	--	--	--	50	--	--	--
Director's Room	336	24' x 14'	10'	--	--	--	--	12	--	--
Emerald Ballroom	7,200	58' x 122'	14'	440	800	600	1,000	--	--	--
Multimedia Theatre	2,200	--	10'	115	--	--	--	--	--	--
Prefunction Space	5,000	--	14'	--	--	--	400	--	--	--
Premier Room	336	24' x 14'	10'	--	--	--	--	12	--	--
Presidential Ballroom	3,126	53' x 59'	12'	150	240	200	400	--	--	--
Salon I	1,800	58' x 30'	14'	110	200	120	250	40	30	40
Salon II	1,800	58' x 30'	14'	110	200	120	250	40	30	40
Salon III	1,800	58' x 30'	14'	110	200	120	250	40	30	40
Salon IV	1,800	58' x 30'	14'	110	200	120	250	40	30	40



# DRURY PLAZA HOTEL

## DRURY PLAZA HOTEL BROADVIEW

400 W. Douglas • Wichita, KS 67202  
316.262.5000 • 316.213.3216



### Meeting Room Layout

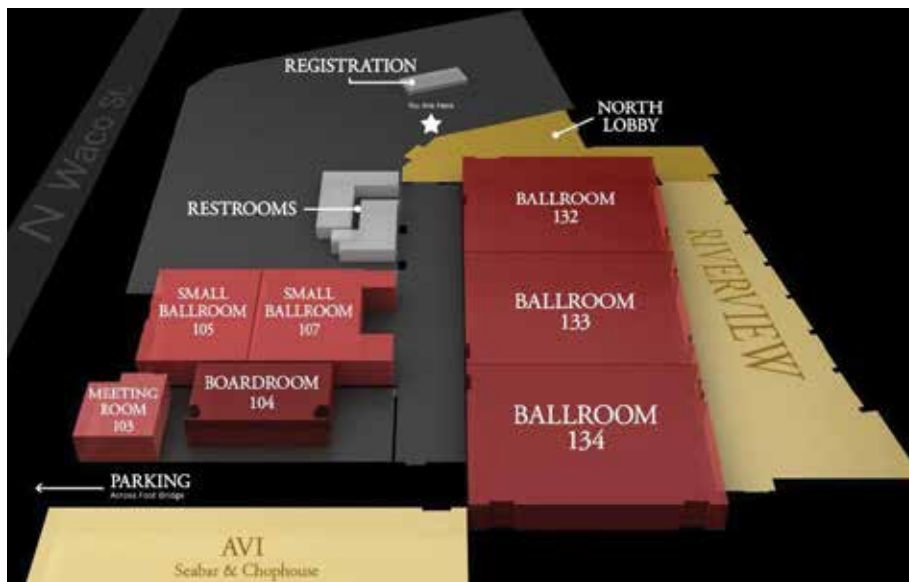

History of the Broadview Hotel... A Wichita tradition since 1922! The basement and rooftop of the hotel have seen their share of excitement over the years. During prohibition of the 1920s, the basement was Wichita's only "speakeasy." The speakeasy featured drinking, gambling and a restaurant large enough to seat 600 comfortably. The "Roof-Top-Garden" was the only roof garden in Kansas and hosted many events. The promenade offered an all around view of the city while dining and dancing into the late hours of the evening.

As a Drury Plaza Hotel, the Broadview Hotel will carry on the history and will remain a Wichita tradition, offering the convenience of the 21st century with an upscale environment, enhanced meeting space and on-site dining.

The Drury Inn & Suites brand has been recognized by J.D. Power and Associates with its ninth award for "Highest in Guest Satisfaction Among Mid-Scale Hotel Chains."

### Meeting Space Information

Room	Dimensions	Sq Ft	Theater	Classroom	Banquet	Conference	U-Shape
Large Ballroom	177' x 52'	9,204	1,000	240	500	--	--
Large #132	59' x 52'	3,068	325	120	--	200	70
Large #133	59' x 52'	3,068	325	120	--	200	70
Large #134	59' x 52'	3,068	325	120	--	200	70
Small Ballroom	58' x 38'	2,204	150	60	70	50	40
Small #105	29' x 38'	1,102	80	30	40	25	20
Small #107	29' x 38'	1,102	80	30	40	25	20
Small #103	33' x 21'	693	--	20	--	16	--
Board Room	22' x 19'	418	--	--	--	10	--

## HOTELS WITH MEETING SPACE



### FAIRFIELD INN & SUITES BY MARRIOTT WICHITA DOWNTOWN

525 S. Main • Wichita, KS 67202  
316.201.1400 • [www.marriott.com/ictfd](http://www.marriott.com/ictfd)



New Fairfield Inn & Suites by Marriott-Wichita Downtown offers 131 hotel rooms and suites. Four room types, including King and Double Queen Suites, make the perfect location for business or pleasure. Hotel suites include mini-fridge and microwave, along with two HD flat-screen televisions. The hotel features complimentary breakfast, complimentary HSIA, complimentary covered parking, complimentary airport shuttle service, indoor saltwater swimming pool with ADA compliant lift, spacious fitness center, full-service lobby lounge and outdoor courtyard with fire pit. Boardroom meeting space, with built-in projection system, will accommodate eight to ten people. Located within walking distance of Century II Performing Arts and Convention Center and INTRUST Bank Arena. Easy access to Mid-continent Airport, via US 54 Kellogg. Convenient to historic Old Town, Wichita's vibrant dining and entertainment district, Exploration Place, Lawrence Dumont Baseball Stadium, Old Cowtown Museum, Friends University, Newman University and Sedgwick County Zoo.



### Meeting Space Information

Room	Sq Ft	Conference
Board Room	304	10

Winner of the Marriott Opening Hotel of the Year Award, Fairfield Inn & Suites is located in the developing, downtown WaterWalk area. The WaterWalk hosts outdoor summer concerts and features Waltzing Waters, an outdoor water and light show. Receive Marriott Rewards points on your Fairfield Inn & Suites stay, to redeem at over 2,600 locations worldwide.





## HAMPTON INN & SUITES WICHITA NORTHEAST

2433 N. Greenwich Road • Wichita, KS 67226  
316.636.5594  
www.wichitanorthwastsuites.hamptoninn.com



The Hampton Inn & Suites Wichita-Northeast offers our guests the best value in Wichita. Our 100-percent smoke-free property, located by K-96 near the intersection of Greenwich and 21st Street in Regency Lakes, is specifically designed to cater to the needs of today's traveler. We are pleased to offer our clients the conveniences of both home and office – while on the road. Our meeting space is perfect for training, board meeting, or small gatherings. Various shopping and dining options are nearby for the corporate traveler, family vacation or weekend getaway.

The Wichita Northeast Hampton Inn & Suites offers our guests the following features:

- The Regency room is 600 sq ft with seating up to 36 classroom style and 40 banquet
- Open catering for breakfast, lunch and dinner
- Complimentary 24-hour business center
- Complimentary high-speed Internet access
- 102 spacious guest rooms, clean and fresh beds
- Indoor pool and 24-hour fitness center

The Hampton Inn & Suites would love to help make your next meeting a success.

### Meeting Room Layout

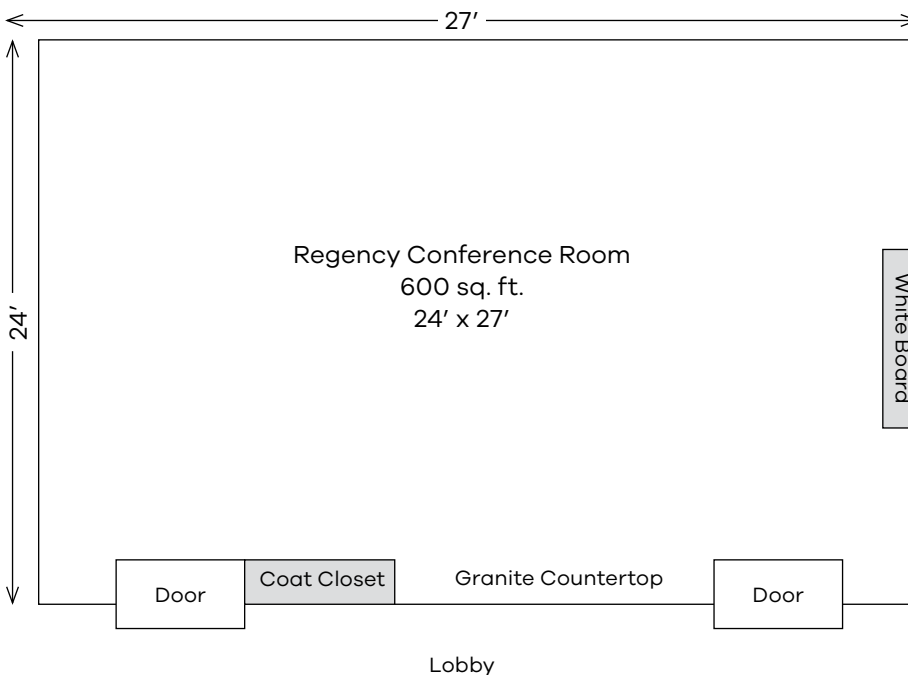

### Meeting Space Information

Room	Dimensions	Sq Ft	Theater	Classroom	Banquet	Conference	U-Shape	Reception
Regency Conference Room	24' x 27'	600	50	36	40	18	18	60

## HOTELS WITH MEETING SPACE



### HILTON GARDEN INN

2041 N. Bradley Fair Parkway  
Wichita, KS 67206 • 316.219.4444  
www.wichita.hgi.com



At the Hilton Garden Inn, our entire staff is continually striving to exceed expectations by providing exceptional customer service and individual client satisfaction. As we have chosen to focus on smaller to mid-sized groups, our patrons appreciate the one-on-one interaction they receive. Each of our beautiful conference rooms, which offer exterior windows overlooking a landscaped terrace and gorgeous lake view of Bradley Fair, are ideal for any business meeting, weekend retreat or social function.



### Meeting Room Layout

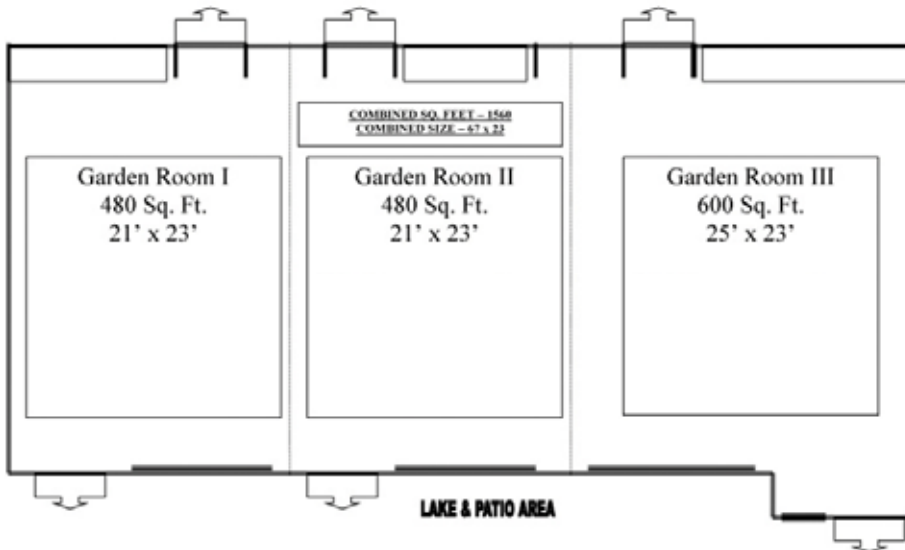

The Great American Grill, featuring indoor and seasonal outdoor seating, offers an outstanding breakfast buffet as well as lunch and dinner menus. Room service is available in the evenings. The Pavilion Pantry conveniently located near the front desk carries a variety of microwavable foods, beverages including soda, milk, beer, wine and sundries. Other hotel amenities include an indoor pool, whirlpool, exercise facility and an outdoor walking path around the lakeside landscaping at Bradley Fair. If you're using the meeting room spaces, the Hilton Garden Inn has food, beverage, bartending and decorating services available.

### Meeting Space Information

Room	Sq Ft	Dimensions	Classroom	Theater	Conference	Banquet	Reception	U-Shape	1/2 Rounds of 6
Garden	1,560	67' x 23'	78	90	--	104	156	--	78
Garden I	480	21' x 23'	24	40	16	32	48	15	24
Garden II	480	21' x 23'	24	40	16	32	48	15	24
Garden III	600	25' x 23'	30	50	18	40	60	18	30





## HOLIDAY INN WICHITA EAST I-35

549 S. Rock Road • Wichita, KS 67207  
316.686.7131 • [www.holidayinn.com/hiwichtaks](http://www.holidayinn.com/hiwichtaks)

**Holiday Inn**



### Meeting Room Layout

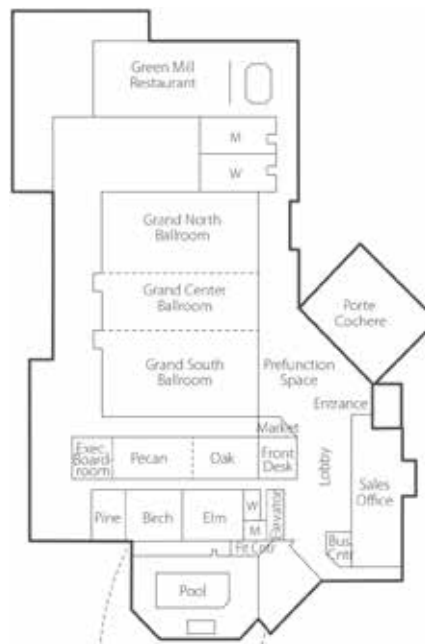

Experience a beautiful facility, superior amenities and outstanding service. The completely renovated Holiday Inn Wichita East I-35 offers you the very best accommodations and services. Each of the 198 sleeping rooms include all the comforts of home – voice mail, coffee maker, hair dryer, iron and ironing board and free wi-fi throughout the entire hotel. After a long day of meetings or travel, guests can enjoy in-room movies and a complimentary USA Today newspaper, or relax in the whirlpool, indoor pool or fitness center. The Green Mill Restaurant and Bar offers guests a great casual meal and a variety of adult beverages.

Whether you are planning a meeting for 10 or a convention for 1,000, the Holiday Inn Wichita East I-35 can accommodate your needs. There is more than 13,000 square feet of flexible conference space perfect for board meetings, large assemblies, banquets and more. To ensure that your meeting runs smoothly, the hotel offers a full line of audiovisual equipment, a business center, and high-speed Internet access. Catering services are available for events from informal breakfasts to elegant dinners.

### Meeting Space Information

Room	Dimensions	Sq Ft	Banquet	Classroom	Theater	U-Shape
Grand Ballroom	59' x 112'	6,608	500	400	750	--
South Ballroom	59' x 44'	2,596	200	130	250	62
Center Room	59' x 28'	1,652	100	80	130	42
North Ballroom	59' x 40'	2,360	200	130	250	62
Woods Rooms	26' x 68'	1,768	120	80	120	36
Oak Room	26' x 34'	884	60	40	60	28
Pecan Room	26' x 34'	884	60	40	60	28
Elm Room	25' x 25'	625	40	28	40	18
Executive Boardroom	25' x 16'	416	--	--	--	--
Birch Room	25' x 25'	625	40	28	40	18
Pine Room	25' x 12'	300	20	12	16	9
Courtyard Pre-Function	35' x 27'	762	30	--	--	--

## HOTELS WITH MEETING SPACE



### HOMWOOD SUITES BY HILTON AT THE WATERFRONT

1550 N. Waterfront Parkway  
 Wichita, KS 67206 • 316.620.8844  
[www.atthewaterfront.homewoodsuites.com](http://www.atthewaterfront.homewoodsuites.com)



Homewood Suites offers a selection of suites including luxury or executive king suites, one-bedroom, two-queen suites, two-bedroom suites and five designer-themed presidential suites. Each suite includes a fully-equipped kitchen with full-size refrigerator, a large workstation with complimentary high-speed Internet access and secured direct printing capabilities to the business center.

The hotel offers more than 2,000 square feet of meeting or banquet space and is the perfect location for a conference, staff retreat or training. Meeting rooms include state-of-the-art audiovisual equipment, flip charts, electric screen, Internet access and data ports.

Guests may start their day with the deluxe hot breakfast served daily and enjoy a complimentary hot meal or adult libations Monday through Thursday evenings. After a busy day, guests may exercise in the on-site fitness center or at a local health club with a complimentary pass.



### Meeting Room Layout

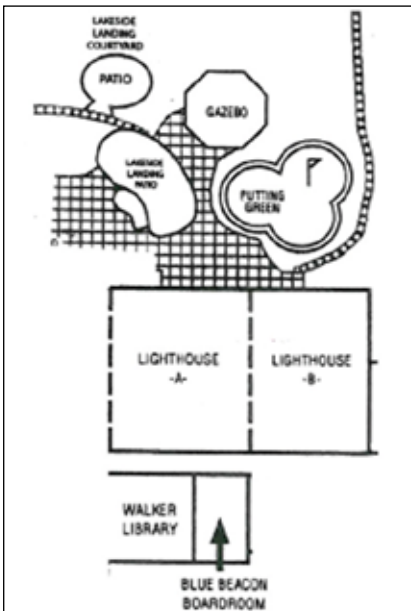

### Meeting Space Information

Room	Sq Ft	Dimensions	Height	Classroom	Theater	Banquet	Reception	Conference	U-Shape	H-Square
Blue Beacon Boardroom	252	21' x 12'	8'	--	--	--	--	--	--	--
Lighthouse A&B	1,990	32' x 53'	8'	80	200	130	200	45	55	50
Lighthouse A	964	32' x 26'	8'	40	100	50	100	20	20	25
Lighthouse B	1,026	37' x 27'	8'	40	100	50	100	20	20	25
The Walker Library	357	21' x 17'	8'	--	--	--	--	--	--	--





**HOTEL AT OLD TOWN**

830 E. First • Wichita, KS 67202  
316.267.4800 • www.hotelatoldtown.com



This boutique hotel is conveniently located in the heart of Old Town and just seven miles from Wichita’s Mid-Continent Airport. Hotel at Old Town is an urban oasis with a four-story atrium and piano bar basking in old world charm. It offers 103 guest rooms and 12 one-bedroom suites. Breakfast is served every morning in the atrium. All rooms have plush bedding, fully equipped kitchens, free wired and wireless Internet, voice mail, oversized desk, TV and CD player. Amenities include a business center, free parking garage, fitness center and laundry.

The Hotel at Old Town is housed in the century-old Keen Kutter Warehouse building, which was gutted and rebuilt in 1999 so you can enjoy its old world charm and all of the modern conveniences of today. The Old Town Conference Center offers 10,000 square feet of meeting space and full catering services. The Old Town location provides more than 40 restaurants, shops and museums, all within walking distance.

**Meeting Room Layout**

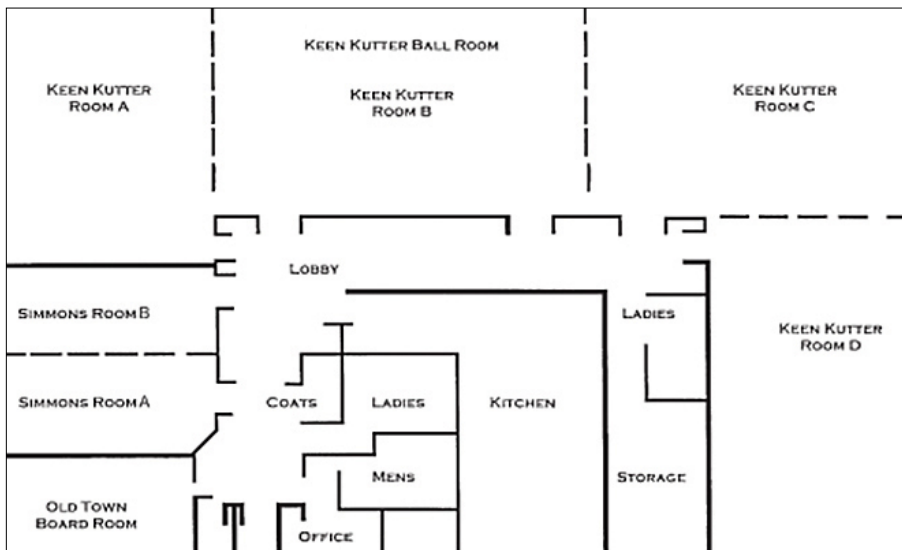

**Meeting Space Information**

Room	Sq Ft	Classroom	Theater	H-Square	Standup Reception	Banquet
Old Town Board Room	500	--	--	14	--	--
Simmons A & B	1,050	40	90	22	100	60
Keen Kutter A	1,700	60	190	32	175	120
Keen Kutter B	2,185	65	200	35	200	120
Keen Kutter C	2,175	65	200	35	200	120
Keen Kutter D	2,150	60	200	35	200	120

# HOTELS WITH MEETING SPACE



## HYATT REGENCY WICHITA

400 W. Waterman • Wichita, KS 67202  
316.293.1234 • www.hyattregencywichita.com

### Meeting Room Layout

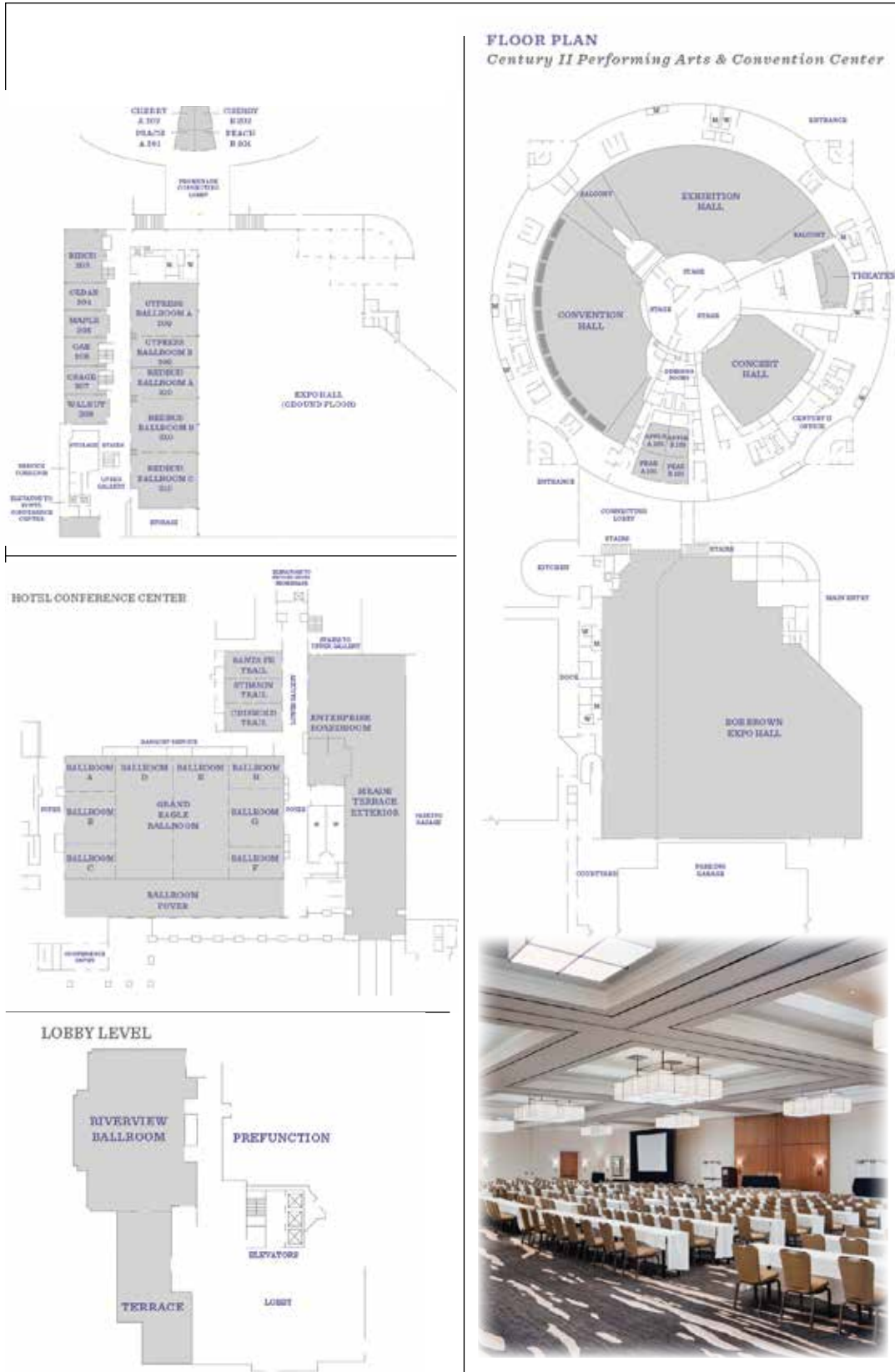

The Hyatt provides 303 rooms looking over the Arkansas River with luxurious amenities, complimentary wi-fi in the main lobby and sleeping rooms, complimentary roundtrip airport and downtown transportation. The hotel features an indoor swimming pool with two hot tubs along with a 24-hour fitness center. Harvest Kitchen & Bar concept of “farm fresh to the table” is located on site and serves local, seasonal cuisine for breakfast, lunch and dinner. Perks Coffee and More offers Starbucks coffee and breakfast items to grab and go. The Hyatt is adjacent to the Century II Performing Arts & Convention Center, minutes from INTRUST Bank Arena and Old Town.

The Hyatt can accommodate small or large meetings and provide catering to suit your group’s needs as well as superb audiovisual services to make the presentation first-class. There are 29 meeting rooms, including several separate ballrooms, plus exhibit space in the adjoining Century II Performing Arts & Convention Center. The Grand Eagle Ballroom is the city’s largest, state-of-the-art hotel ballroom.



## HOTELS WITH MEETING SPACE

### Hyatt Conference Center - Meeting Space Information

Room Name	Dimensions	Sq Ft	Banquet	Reception	Theater	Classroom	Boardroom	U-Shape	H-Square	Exhibit
Grand Eagle Ballroom	77' x 132' x 16'	10,164	720	1,100	1,200	740	--	--	--	98/62
Ballroom A, C, F, or H	22' x 33' x 16'	726	40	75	60	40	28	38	26	6/4
Ballroom B or G	33' x 33' x 16'	1,089	60	115	120	66	34	50	36	8/6
Ballroom D or E	77' x 33' x 16'	2,541	180	260	300	160	--	--	--	22/17
Ballroom A, B, C, D, & E	77' x 99' x 16'	7,623	540	975	900	540	--	--	--	74/47
Ballroom A & B or B & C	55' x 33' x 16'	1,815	120	190	180	120	--	66	50	16/11
Ballroom A, B, & C	77' x 33' x 16'	2,541	180	260	300	185	--	--	--	22/17
Ballroom A, B, C, & D	77' x 66' x 16'	5,082	360	625	600	370	--	--	--	49/31
Ballroom Foyer	23' x 162' x 16'	3,726	--	400	--	--	--	--	--	22
The Three Trail Rooms	48' x 33' x 13'	1,584	90	150	180	90	46	55	52	15/9
Chisholm & Stimson or Stimson & Santa Fe	32' x 33' x 13'	1,056	60	100	120	60	38	44	34	10/6
Chisholm, Stimson or Santa Fe	16' x 33' x 13'	528	30	50	60	30	30	32	28	5/4
Enterprise Boardroom	22' x 28' x 14'	602	--	--	--	--	--	16	--	--
Gallery Room	34' x 60' x 16'	2,040	--	180	--	--	--	--	--	--
Meade Terrace Area <small>(outdoor)</small>	98' x 30' x 14'	2,940	--	300	--	--	--	--	--	--
Water Wall Area <small>(outdoor)</small>	--	OPEN	--	5,000	--	--	--	--	--	--
Riverview Ballroom	75' x 55' x 13'	3,665	216	350	--	--	--	--	--	--
Lobby Terrace	12' x 116'	1,390	--	130	--	--	--	--	--	--

### Century II Performing Arts & Convention Center - Meeting Space Information

Room Name	Dimensions	Sq. Ft.	Theater	Classroom	Banquet	Conference	Exhibit Booths
MR 101 Pear A&B	60' x 30' x 12'	1,800	170	72	96	34	6
MR 102 Apple A&B	51' x 29' x 12'	1,500	130	54	64	28	6
MR 201 Peach A&B	60' x 30' x 12'	1,800	170	72	96	34	6
MR 202 Cherry A&B	49' x 37' x 12'	1,800	170	72	96	34	6
MR 203 Birch	32' x 61' x 11'	1,950	160	100	120	46	--
MR 204 Cedar	29' x 37' x 11'	1,070	84	54	60	28	--
MR 205 Maple	29' x 37' x 11'	1,070	84	54	60	28	--
MR 206 Oak	29' x 31' x 11'	900	72	45	50	22	--
MR 207 Osage	29' x 31' x 11'	900	72	45	50	22	--
MR 208 Walnut	31' x 37' x 11'	1,150	84	54	60	28	--
MR 209 A Cypress A	52' x 60' x 16'	3,120	380	200	220	--	16
MR 209 A Cypress B	52' x 30' x 16'	1,510	140	100	100	46	8
MR 209 A&B Cypress A&B	52' x 90' x 16'	4,630	520	300	320	--	26
MR 210 A Redbud A	52' x 30' x 16'	1,510	140	100	100	46	8
MR 210 B Redbud B	52' x 60' x 16'	3,120	380	200	220	--	16
MR 210 C Redbud C	52' x 60' x 16'	3,120	380	200	220	--	16
MR 210 A & B Redbud A & B	52' x 90' x 16'	4,630	520	300	320	--	26
MR 210 B & C Redbud B & C	52' x 120' x 16'	6,240	660	380	440	--	34
MR 210 A, B & C Redbud A, B & C	52' x 150' x 16'	7,750	800	500	500	--	42
Willow Room	21' x 18' x 10'	378	50	18	20	20	--
EX 201 R	25' x 35' x 12'	920	85	36	48	18	--

### Main Hall Information

Room	Sq Ft	Ceiling Height	Exhibit Booths	Theater	Banquet
Expo Hall	93,000	32'	450	5,000	3,000
Convention Hall	32,000	31' to 49'	110	4,751	1,120
Exhibition Hall	45,000	31' to 36'	160	3,000	1,848
Exhibition Hall Balcony	17,500	18'	54	600	480
Concert Hall	--	--	--	2,195	--
Theater	--	--	--	652	--

## HOTELS WITH MEETING SPACE



### LA QUINTA INN & SUITES AIRPORT

5500 W. Kellogg Drive • Wichita, KS 67209  
316.943.2181 • <http://6139.lq.com>



La Quinta Inn & Suites Wichita Airport is just two miles from Mid-Continent Airport and minutes from downtown, area attractions, shopping and dining.

The property has 140 well appointed guest rooms and suites suited to meet the needs of every traveler. It provides a 24-hour complimentary airport shuttle within a three-mile radius of the hotel. Stay connected in the business center, pump it up in the fully equipped fitness center, then go for a refreshing swim in the heated indoor pool, or mellow your senses in the bubbling jacuzzi. Each comfortable guest room features wi-fi wireless Internet, a refrigerator, microwave, recliner, coffee maker, hairdryer, iron with ironing board and other convenient amenities.

Enjoy a delicious, complimentary Bright Side Breakfast every morning. Open for evening dining and cocktails, unwind and relax at Flyers Restaurant and Bar located on the first floor near the lobby.

Perfect for your next event, La Quinta Inn & Suites Wichita Airport offers more than 3,000 square feet of flexible meeting space, in-house catering and top-of-the-line service to fulfill all your event needs.

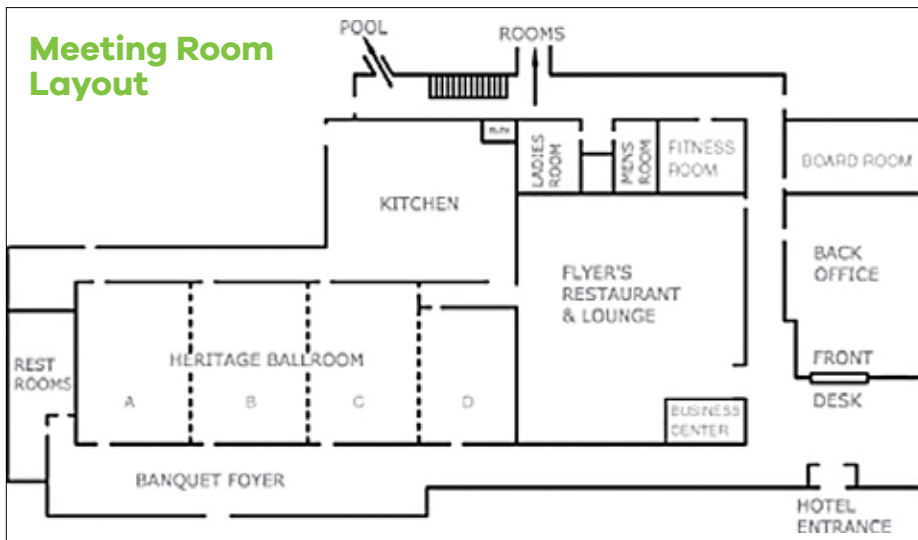

### Receptions & Social Events

Room	Dimensions	Height	Sq. Ft.	Classroom	U-Shape	Conference Square	Rounds	Theater
Board Room	26' x 14'	10'	364	24	12	20	24	30
Ballroom with dance floor in Heritage D, head table, cake table, etc. 24								

### Meeting Space Information

Room	Dimensions	Height	Sq Ft	Classroom	U-Shape	Conference Square	Rounds	Theater
Heritage A with Break/AV	24' x 32'	11'9"	768	33 27	24 24	30 24	50 40	84 50
Heritage B with Break/AV	24' x 32'	11'9"	768	33 27	24 24	30 24	50 40	84 50
Heritage C with Break/AV	24' x 32'	11'9"	768	33 27	24 24	30 24	50 40	84 50
Heritage D with Break/AV	25' x 24'	11'9"	600	27 21	9 9	30 24	40 30	40 30
Ballroom with Break/AV	32' x 72'	11'9"	2,904	175 150	-- --	-- --	190 160	350 275





**LA QUINTA INN & SUITES EAST**

7335 E. Kellogg Drive • Wichita, KS 67209  
316.685.1281 • <http://6308.lq.com>



**Meeting Room Layout**

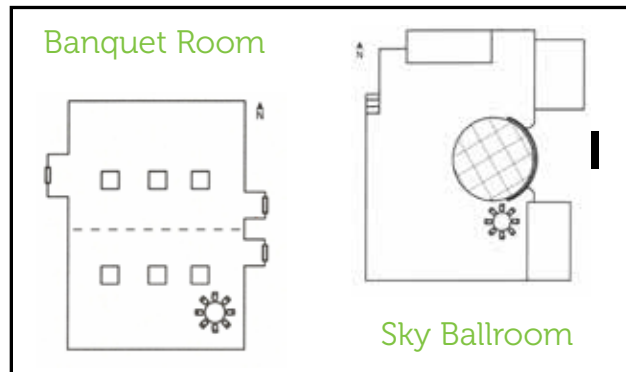

At the La Quinta Inn & Suites, we offer all the amenities and services you would expect for business or leisure guests. You can relax in the comfort of our new rooms with new pillow-top beds, wireless Internet, voicemail, fridge and microwave in every room, or enjoy the beautiful tropical garden indoor pool or whirlpool spa. Have a quick workout in our fitness center or get some work done in our business center. Wake up to our hot Bright Side Breakfast with make-your-own waffles, sausage biscuits, cereals, yogurt, fresh fruit, pastries, bagels, juice, milk and coffee. Later in the day, go shopping at Towne East Mall across the street with numerous restaurants nearby. Our hotel has an open-catering policy which offers you the flexibility of providing your own food and beverage by hiring the caterer of your choice. Our on-site sales coordinator can also introduce you to a selection of caterers who offer great food and excellent service at affordable rates.

Our Sky Ballroom provides a unique setting with hardwood floors and a dance floor surrounded by floor-to-ceiling windows and includes a stage for head table or entertainment, and an adjoining room for buffet setup. The ballroom, which can accommodate up to 150 people, is located on our seventh floor and offers a lovely view of the city. We also have a second meeting room that can accommodate 100 people and can be used as one large area or divided into two separate spaces.

“We Are Here For You!”

**Meeting Space Information**

Room	Dimensions	Height	Sq Ft	Classroom	U-Shape	Conference Square	Rounds	Theater
Banquet Room	44' x 37'	10'	1,628	68	47	39	100	120
Sky Ballroom	35' x 55'	10'	1,925	80	55	46	150	214

## HOTELS WITH MEETING SPACE



### RESIDENCE INN BY MARRIOTT EAST AT PLAZZIO

1212 N. Greenwich • Wichita, KS 67206  
316.682.7300 • [www.marriott.com/ictwk](http://www.marriott.com/ictwk)



The Residence Inn at Plazzio is a great place to balance work and personal time.

Room amenities include high-speed Internet access, a fully equipped kitchen with refrigerator, microwave and coffee maker, hair dryer, iron and ironing board.

Complimentary services include HomeTouch Hot Buffet Breakfast, evening reception with beer and wine and the newspaper in the lobby. Guest services include local restaurant dinner delivery and safe deposit boxes.

The Residence Inn is perfect for any small group needing extended-stay accommodations. The on-site meeting rooms are ideal for small groups of 50 to 60 people. Meeting rooms are equipped with complimentary high-speed Internet and advanced technology audiovisual equipment. Catering is available to fit all tastes and budgets, and the business center is available 24/7. The friendly and efficient staff can accommodate last minute changes.



### Meeting Room Layout

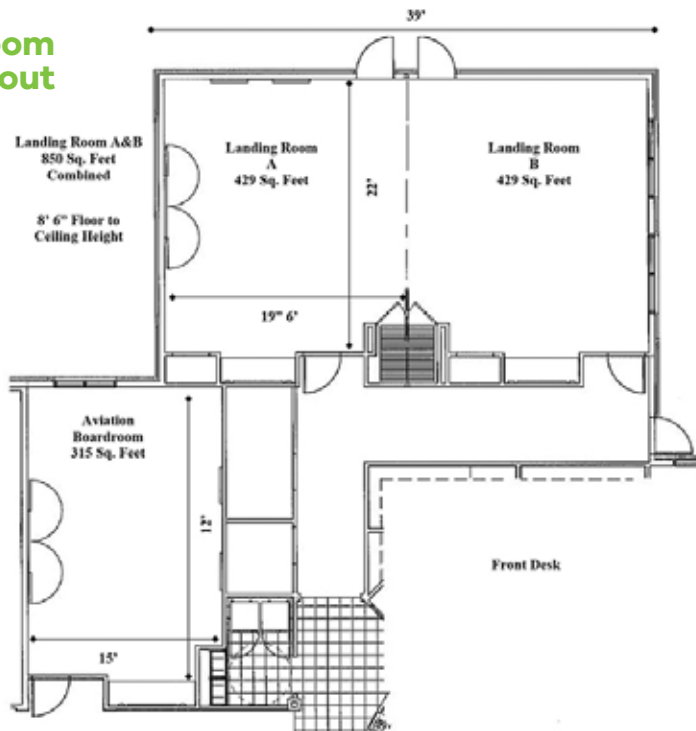

### Meeting Space Information

Room	Sq Ft	Dimensions	Classroom	Theater	Conference	U-Shape	Banquet	6 Round
Landing Room A	429	22' x 20'	20	30	15	15	24	24
Landing Room B	429	22' x 20'	20	30	15	15	24	24
Aviation Boardroom	315	15' x 12'	--	--	10	--	--	--

Landing Room A and B can be combined. Ceiling height is 8'





## SPRINGHILL SUITES WICHITA AIRPORT

6633 W. Kellogg Dr. • Wichita, KS 67209  
316.260.4404 • [www.marriott.com/ictwk](http://www.marriott.com/ictwk)



Whether planning a family reunion, anniversary party or reception, you can count on the SpringHill Suites Wichita Airport to make your event a success, with an ideal atmosphere of style and color, paired with outstanding service.

**Event Space:** SpringHill Suites offers the Sunflower Ballroom with over 2,300 square feet of space, holding a maximum of 155. We offer 60" round tables, as well as additional Cocktail and Banquet tables, with ivory linens for round and rectangle tables. Our Sunflower Ballroom services include your venue set up, tear down and clean up. We also propose pricing for the meeting space for only the Sunflower South or North.

Audio/visual equipment and a dance floor are also available.

**Catering Menus:** SpringHill Suites is thrilled to partner with our exclusive caterer, Larkspur Bistro & Bar. Known as a favorite in Old Town and features fantastic menu choices for your special event. Catering menus can be sent upon request.

**Rooms for Guests:** Take advantage of our easy, online reservation link tool for hotel group guests. Preferred room rates for overnight guests in conjunction with the Sunflower Ballroom. Ask how you can EARN special bonus Marriott Reward Points for booking an event!

### Meeting Room Layout

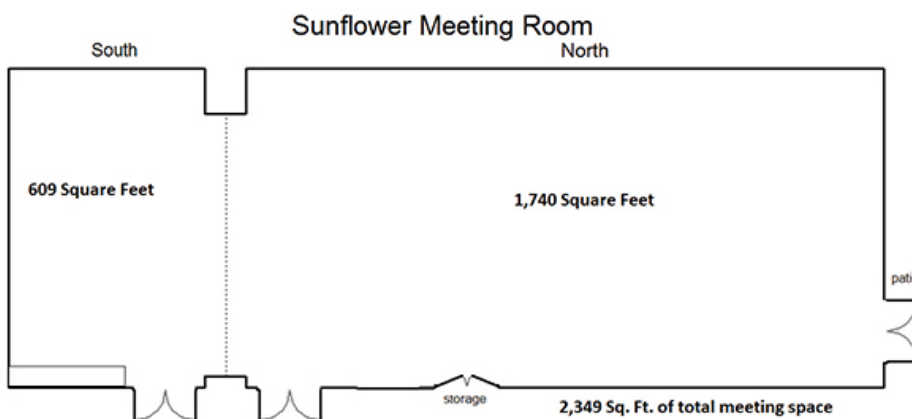

### Meeting Space Information

Room	Dimensions	Height	Sq Ft	Classroom	Conference/ U-Shape	Banquet	Theater/ Reception
Sunflower Ballroom	29' x 81'	10'	2,349	100	100	150	155
Sunflower South	29' x 21'	10'	609	30	24	30	40
Sunflower North	29' x 60'	10'	1,740	80	80	100	115

## HOTELS WITH MEETING SPACE



### WICHITA MARRIOTT

9100 Corporate Hills Drive  
Wichita, KS 67207  
316.651.0333 • [www.marriott.com/ictwe](http://www.marriott.com/ictwe)



The Wichita Marriott helps keep you connected to your life, your business and your goals. Enjoy the wonders of your surroundings – they are chosen to further your success and relaxation. Located adjacent to the Kansas Turnpike, the Marriott provides easy access to major aircraft manufacturers, large corporations and Wichita’s premier upscale shopping.

After a busy day, retreat to a luxurious guest room that surrounds you with the comforting touches of home. Our rooms offer stylish upgrades including flat screen TVs, Marriott’s Revive bedding and ergonomic chairs with sleek, modern desks designed to make business and leisure travel more comfortable and productive. Experience award-winning service and meticulous attention to detail that will exceed your expectations.

Welcome to the Wichita Marriott.

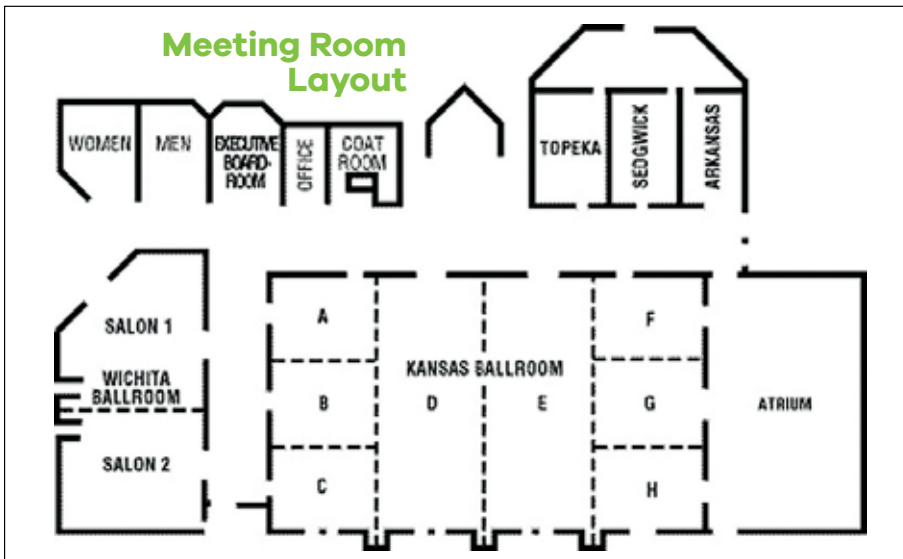

### Meeting Space Information

Room	Dimensions	Height	Sq Ft	Theater	Classroom	Conference	U-Shape	Reception	Banquet
Wichita Ballroom	63' x 36'	12'	2,268	225	110	--	--	200	160
Atrium	42' x 64'	10'	2,688	200	132	50	50	250	150
Executive Boardroom	15' x 28'	9'	420	--	--	12	--	--	--
KS Grand Ballroom	108' x 66'	14'	7,128	1,000	500	--	--	1,140	600
Pre-Assembly (Hallway)	113' x 18'	10'	2,034	--	--	--	--	--	--
Breezeway	64' x 12'	10'	768	--	--	--	--	--	--
Salon 1	33' x 36'	12'	1,188	100	60	30	30	120	80
Salon 2	30' x 36'	12'	1,080	125	60	30	30	120	80
Salon A	22' x 27'	14'	594	65	30	20	20	50	40
Salon B	22' x 27'	14'	594	65	30	20	20	50	40
Salon C	22' x 27'	14'	594	65	30	20	20	50	40
Salon D	27' x 66'	14'	1,728	200	100	50	50	185	120
Salon E	27' x 66'	14'	1,728	200	100	50	50	185	120
Salon F	27' x 66'	14'	1,728	200	100	50	50	185	120
Sedgwick	18' x 28'	10'	504	50	24	18	12	40	30
Topeka	18' x 28'	10'	504	50	24	18	12	40	30
Arkansas	18' x 28'	10'	504	50	24	18	12	40	30





## WYNDHAM GARDEN WICHITA DOWNTOWN

221 E. Kellogg • Wichita, KS 67202  
316.269.2090 • www.wyndham.com



The Wyndham Garden Wichita Downtown is a seven story, full service hotel located on the edge of downtown Wichita.

Room amenities include coffee maker, microwave, mini refrigerator, hair dryer, iron and ironing board, work desk, high-speed Internet access and wireless data connection. Hotel amenities include a business center, outdoor pool, whirlpool, sauna, fitness room, convenience store, restaurant and cocktail lounge.

There are meeting spaces available for up to 150 people.

### Meeting Room Layout



### Meeting Space Information

Room	Dimensions	Sq Ft	Height	Banquet	Boardroom	Cabaret	H-Square	Reception	Theater	U-Shape
Board Room	14' x 24'	366	10'	10	10	--	--	--	--	--
Conference Room 202	24' x 22'	528	8'	30	30	--	25	50	50	25
Conference Room 206	23' x 22'	506	8'	30	30	--	25	50	50	25
Meeting Center Ballroom	36' x 51'	1,836	14'	100	50	--	40	150	150	40

# HOTELS OVERVIEW

		RATES	NUMBER OF ROOMS	NUMBER OF SUITES	AIRPORT TRANSPORTATION	BUSINESS CENTER	HIGH-SPEED WIRELESS	FREE BREAKFAST	EXERCISE ROOM	PETS ALLOWED	INDOOR POOL	OUTDOOR POOL	WHIRLPOOL/SAUNA	EXTENDED STAY
<b>HOTELS &amp; MOTELS</b>														
<b>DOWNTOWN</b>														
<b>Ambassador Hotel Autograph Collection</b> 104 S. Broadway	316-239-7100 ambassadorhotelcollection.com/wichita	\$149–\$1,500	117	12	•	•	•	•	•	•				
<b>Drury Plaza Hotel Broadview</b> 400 W. Douglas	316-262-5000 druryhotels.com	\$100–\$330	200	31	•	•	•	•	•	•	•		•	
<b>Fairfield Inn &amp; Suites by Marriott Wichita Downtown</b> 525 S. Main	316-201-1400 marriott.com/ictfd	\$99–\$189	131	23	•	•	•	•	•		•			
<b>Hotel at WaterWalk</b> 711 S. Main	316-263-1061 hotelatwaterwalk.com	\$99–\$199	88	88	•	•	•	•	•	•		•		•
<b>Hyatt Regency Wichita</b> 400 W. Waterman	316-293-1234 wichita.hyatt.com	\$89–\$199	303	5	•	•	•		•		•		•	
<b>Quality Inn Downtown</b> 1011 N. Topeka Ave.	316-269-9999 qualityinn.com/hotel-wichita-kansas-ks179	\$59–\$89	52	4		•	•		•	•				•
<b>Wyndham Garden Wichita Downtown</b> 221 E. Kellogg	316-269-2090 wyndham.com	\$89–\$150	150	23	•	•	•		•	•		•	•	•
<b>OLD TOWN</b>														
<b>Courtyard by Marriott Wichita at Old Town</b> 820 E. 2nd St. N.	316-264-5300 marriott.com/ictdt	\$109–\$259	128	3	•	•	•		•				•	•
<b>Hotel at Old Town</b> 830 E. 1st St. N.	316-267-4800 hotelatoldtown.com	\$109–\$399	115	12	•	•	•		•					
<b>AIRPORT</b>														
<b>Best Western Airport Inn &amp; Conference Center</b> 6815 W. Kellogg	316-942-5600 bestwestern.com	\$90–\$150	130	4	•	•	•		•	•	•		•	
<b>Candlewood Suites Wichita Airport</b> 570 S. Julia	316-942-0400 candlewoodsuites.com	\$59–\$139	81	81			•		•	•				•
<b>Comfort Suites Wichita Airport</b> 7515 W. Taft	316-773-1700 comfordsuites.com/hotel/ks118	\$99–\$200	78	78	•	•	•	•	•	•	•		•	•
<b>DoubleTree by Hilton Wichita Airport</b> 2098 Airport Rd.	316-945-5272 wichitaairport.doubletree.com	\$99–\$195	302	11	•	•	•		•	•	•		•	
<b>Holiday Inn Express &amp; Suites Airport</b> 1236 S. Dugan	316-522-0008 hiexpress.com/wichitaairport	\$109–\$159	84	22	•	•	•		•		•		•	
<b>La Quinta Inn &amp; Suites Airport</b> 5500 W. Kellogg Dr.	316-943-2181 6139.lq.com	\$89–\$149	140	14	•	•	•	•	•	•	•		•	
<b>Motel 6–Airport</b> 5736 W. Kellogg	316-945-8440		139											
<b>SpringHill Suites by Marriott Wichita Airport</b> 6633 W. Kellogg	316-260-4404 marriott.com/ictww	\$99–\$189	121	121	•	•	•		•		•			
<b>Wichita Inn Airport</b> 6335 W. Kellogg	316-943-2373 wichitainnwest.com	\$69+	80	0	•				•					•
<b>EAST</b>														
<b>Best Western PLUS Eastgate Inn &amp; Suites</b> 8300 E. Kellogg Dr.	316-682-3000 bestwesternwichita.com	\$79–\$159	65	13		•	•	•	•		•		•	•
<b>Comfort Inn East</b> 9525 E. Corporate Hills Dr.	316-686-2844 choicehotels.com	\$79–\$89	58	8		•	•	•		•	•		•	•
<b>Country Inn &amp; Suites by Carlson Wichita Northeast</b> 7824 E. 32nd St. N.	316-634-3900 countryinns.com/wichitaks	\$89–\$179	69	8		•	•		•	•	•		•	•
<b>Courtyard by Marriott Wichita East</b> 2975 N. Webb Rd.	316-636-4600 marriott.com/ictcy	\$94–\$149	90	3		•	•		•		•		•	•
<b>CrestHill Suites</b> 12111 E. Central	316-689-8000 cresthillsuites.com/our-hotels/cresthill-suites-wichita	\$89–\$159	62	62	•	•	•		•	•		•		•
<b>Days Inn &amp; Suites Wichita East</b> 7321 E. Kellogg Dr.	316-691-5000 daysinn.com/hotel/41051	\$45–\$85	79	36	•	•	•		•	•				•



# HOTELS OVERVIEW

		RATES	NUMBER OF ROOMS	NUMBER OF SUITES	AIRPORT TRANSPORTATION	BUSINESS CENTER	HIGH-SPEED WIRELESS	FREE BREAKFAST	EXERCISE ROOM	PETS ALLOWED	INDOOR POOL	OUTDOOR POOL	WHIRLPOOL/SAUNA	EXTENDED STAY
<b>English Village Inn</b> 6727 E. Kellogg	316-683-5613													
<b>Extended Stay America</b> 9450 Corporate Hills Dr.	316-652-8844 extendedstayamerica.com		73											•
<b>Fairfield Inn &amp; Suites by Marriott Wichita East</b> 333 S. Webb Rd.	316-685-3777 marriott.com/ictfi	\$99-\$139	89	10	•	•	•	•				•	•	
<b>Hampton Inn East</b> 9449 E. Corporate Hills Dr.	316-686-3576 wichitaeast.hamptoninn.com	\$119-\$139	81	0		•	•		•	•			•	
<b>Hawthorn Suites by Wyndham Wichita East</b> 411 S. Webb Rd.	316-686-7331 hawthorn.com/hotels/kansas/wichita/hawthorn-suites-by-wyndham-wichita-east/hotel-overview	\$79-\$149	64	64		•	•		•			•		•
<b>Hilton Garden Inn</b> 2041 N. Bradley Fair Pkwy.	316-219-4444 wichita.hgi.com	\$99-\$179	103	0		•	•	•		•			•	•
<b>Holiday Inn Wichita East I-35</b> 549 S. Rock Rd.	316-686-7131 holidayinn.com/hiwichtaks	\$129	199	13	•	•	•	•			•		•	
<b>Homewood Suites by Hilton @ The Waterfront</b> 1550 N. Waterfront Pkwy.	316-260-8844 atthewaterfront.homewoodsuites.com	\$129-\$169	104	104		•	•	•	•	•			•	•
<b>The Inn at Tallgrass</b> 2280 N. Tara Circle	316-684-3466 theinnattallgrass.com	\$89-\$189	88	88		•	•		•	•			•	•
<b>La Quinta Inn &amp; Suites Wichita East</b> 7335 E. Kellogg	316-685-1281 6308.lq.com	\$69-\$119	97	9		•	•		•	•	•		•	•
<b>Motel 6-East</b> 8302 E. Kellogg Dr.	316-612-4646 motel6.com/ms/check-availability.do?property=4858	\$50-\$89	42	0			•		•					•
<b>Northrock Suites</b> 7856 E. 36th St. N.	316-634-2303 northrocksuiteshotel.com	\$79-\$139	101	14		•	•	•			•	•	•	•
<b>Residence Inn by Marriott East at Plazzio</b> 1212 N. Greenwich Rd.	316-682-7300 marriott.com/ictwk	\$114-\$199	93	93		•	•		•	•			•	•
<b>SpringHill Suites by Marriott East at Plazzio</b> 1220 N. Greenwich	316-681-1800 marriott.com/ictsh	\$99-\$139	102	102		•	•	•	•		•			
<b>Staybridge Suites Wichita</b> 2250 N. Greenwich Rd.	316-927-3888 staybridge.com/wichitaks	\$89-\$259	88	88		•	•		•	•			•	•
<b>Super 8</b> 8220 E. Kellogg	316-685-8291	\$54-\$78	90	0		•	•							•
<b>Wesley Inn</b> 3343 E. Central	316-858-3343 wichitawesleyinn.com	\$64.95-\$90.95	74	0		•	•			•				
<b>Wichita Marriott Hotel</b> 9100 Corporate Hills Dr.	316-651-0333 marriott.com/ictwe	\$99-\$186	294	4	•	•	•		•		•	•	•	
<b>Wichita Suites Hotel</b> 5211 E. Kellogg Dr.	316-685-2233 wichitasuiteshotel.com	\$82+	88	88		•	•	•				•		•
<b>NORTH</b>														
<b>Auto Motel</b> 1230 N. Broadway	316-265-9581													
<b>Best Western Wichita North Hotel &amp; Suites</b> 915 E. 53rd St. N.	316-832-9387 bestwestern.com	\$79-\$190	149	10	•	•	•		•	•	•		•	•
<b>NORTHEAST</b>														
<b>Candlewood Suites Wichita Northeast</b> 3141 N. Webb Rd.	316-634-6070 candlewoodsuites.com	\$60-\$109	108	108			•		•	•				•
<b>Hampton Inn &amp; Suites Wichita Northeast</b> 2433 N. Greenwich Rd.	316-636-5594 wichitanortheastsuites.hamptoninn.com	\$89-\$149	102	32		•	•	•	•		•			•
<b>Holiday Inn Express Hotel &amp; Suites Wichita Northeast</b> 2340 N. Greenwich Rd.	316-927-3850 hiexpress.com	\$99-\$229	97	25		•	•		•		•		•	
<b>TownePlace Suites by Marriott</b> 9444 E. 29th St. N.	316-631-3773 marriott.com/ictte	\$79-\$129	82	82		•	•		•	•				•

# HOTELS OVERVIEW

			RATES	NUMBER OF ROOMS	NUMBER OF SUITES	AIRPORT TRANSPORTATION	BUSINESS CENTER	HIGH-SPEED WIRELESS	FREE BREAKFAST	EXERCISE ROOM	PETS ALLOWED	INDOOR POOL	OUTDOOR POOL	WHIRLPOOL/SAUNA	EXTENDED STAY
<b>Value Place Wichita North</b> 3401 N. Great Plains Dr.	316-858-3500 valueplace.com		\$239.99/ week	104	104			•							•
<b>Wichita Inn North</b> 3741 N. Rock Rd.	316-636-2022 hotelinwichita.com		\$54-\$84	97	0	•	•	•	•	•					•
<b>WEST</b>															
<b>Clarion Inn &amp; Suites</b> 5805 W. Kellogg	316-942-7911 choicehotels.com		\$80- \$140	188	26	•	•	•		•	•		•		•
<b>Days Inn West</b> 550 S. Florence	316-942-1717 daysinn.com/wichitaks		\$65-\$125	41	0	•	•	•							
<b>Hampton Inn Wichita West/Airport Area</b> 3800 W. Kellogg	316-945-4100 wichitawest.hamptoninn.com		\$99- \$200	120	1	•	•	•		•			•		•
<b>Hawthorn Suites West at Reflection Ridge</b> 2405 N. Ridge Rd.	316-729-5700 hawthorn.com		\$90- \$140	52	52	•	•	•		•	•		•		•
<b>Quality Suites Airport</b> 658 Westdale Dr.	316-945-2600 choicehotels.com/hotel/ks041		\$80- \$109	50	50	•	•	•	•	•	•		•		
<b>Regency Inn</b> 6125 W. Kellogg Dr.	316-942-1341		\$37-\$54	80	1			•							•
<b>Scotsman Inn West, LLC</b> 5922 W. Kellogg	316-943-3800 scotsmaninnwichita.com		\$43-\$50	70	1			•							•
<b>Value Place Wichita West</b> 7525 W. Taft	316-721-3313 valueplace.com		\$55-\$80	119	119	•		•							•
<b>WaterWalk Hotel Apartments</b> 411 W. Maple	316-201-1899 waterwalk.com														•
<b>SOUTH</b>															
<b>Days Inn &amp; Suites South</b> 4875 S. Laura	316-524-4400 daysinn.com		\$49- \$200	43	5			•			•		•	•	
<b>Holiday Inn Express Wichita South</b> 4860 S. Laura St.	316-558-8001		\$99-\$139	90	28	•	•	•		•		•			
<b>Quality Inn South</b> 4849 S. Laura St.	316-522-1800 qualityinn.com/hotel/wichita/ kansas/ks401		\$65-\$80	112	3		•	•			•		•	•	
<b>Super 8 Wichita South</b> 4848 S. Laura St.	316-529-4848 super8.com		\$65-\$75	50				•			•	•		•	
<b>Value Place Wichita South</b> 4665 S. Broadway	316-350-1300 valueplace.com		\$219.99/ week	104	104			•							•
<b>BED &amp; BREAKFAST</b>															
<b>EAST</b>															
<b>Inn at Glenstrae</b> 3342 Country Club Pl.	316-631-2883 theinnatglenstrae.com		\$149- \$325	2	1			•							
<b>RV PARKS &amp; CAMPGROUNDS</b>															
<b>EAST</b>															
<b>Air Capital RV Park</b> 609 E. 47th St. S.	316-201-1250 aircapital-rvpark.com		\$44-\$54					•			•				
<b>K and R RV Park</b> 3200 S. Southeast Blvd.	316-684-1531 kandrwpark.com		\$25-\$30	90	0			•			•				•
<b>NEARBY</b>															
<b>All Seasons RV Park</b> 15520 W. Maple St., Goddard, KS	316-722-1154 allseasonsvrcampground.com		\$30-\$33	48	0		•	•			•				•
<b>Spring Lake RV Resort</b> 1308 S. Spring Lake Rd., Halstead, KS	316-835-3443 springlakervresort.com		\$26-\$28												
<b>USI RV Park</b> 2920 E. 33rd St. N.	316-838-8699 usirvpark.com		\$34-\$45	75	0			•			•				•





Wichita festivals and annual events celebrate Wichita's diverse community and highlight the best the city has to offer.



# INTRUST BANK ARENA

500 E. Waterman St. • Wichita, KS 67202 • 316.440.9000  
www.intrustbankarena.com • Operated by SMG Wichita  
Office hours: Monday through Friday, 9 a.m. to 5 p.m.

Welcome to Wichita's award-winning INTRUST Bank Arena. The downtown arena is not only the new home to Wichita Thunder hockey but also offers a variety of events including professional and collegiate sports, concerts, religious assemblies, family shows, corporate functions and trade shows.

## Food and Beverage

SMG offers full-service catering and concessions for every event through its in-house caterer, SAVOR. SAVOR provides breakfast, lunch, dinner or snacks, and can accommodate any group size. Show catering is available for any event and can be provided in any room on Level 1 (service/event level). SAVOR's staff can work with you to develop a custom menu to cater to your request.

## Concessions

SMG provides a wide variety of food and beverage items for guests at each concession stand located on Level 2 and Level 3 of the arena. There are 22 permanent and portable stands throughout the public concourses. In addition, there are two full-service

SMG maintains a professional, well-uniformed and friendly staff. Our in-house guest service staff includes ushers, ticket takers, in-house security, police, medical services and guest service representatives.

## Disabled Facilities and Services

INTRUST Bank Arena meets or exceeds all requirements for the American Disabilities Act (ADA).

## Ticketing Services

- In-house ticketing is located on the south side of the arena.
- Local ticket outlets include 19 Dillons locations in Wichita, Andover, Derby, Newton, El Dorado and Hutchinson.

## Special Features

- Scoreboard, LED ribbonboard and indoor marquee
- Scoreboard: LED high resolution – 10 MM RGB video, 480 w x 288 h pixels
- LED Ribbonboard: 12,560 w x 36 h pixels
- Atrium LED Marquee: 30' h x 30' w





## INTRUST BANK ARENA

500 E. Waterman St. • Wichita, KS 67202 • 316.440.9000 • www.intrustbankarena.com

### Capacity / Technical

- Center Stage: 15,750-16,000
- Basketball: 15,000
- Lower Bowl: 6,300
- Upper Bowl: 7,700
- Theatre Style: 7,000
- Gross square footage: 329,850
- Arena Ceiling Height
  - Floor to high steel: 97 ft.
  - Floor to low steel: 69 ft.
- Arena Floor: Floor inserts for circus tie-downs, basketball, arena football and hockey dashers

### Premium Seating

- 20 Suites
- 2 Party Suites
- 40 Loge Boxes
- 192 Club Seats

### Loading/Service Area

- 1 bay door 15' w x 16' h drive-thru door
- 4 dock doors 8' w x 10' h
- Parking for eight trucks and five buses (Additional parking is available outside the compound)
- Three water connections available

### Center Stage Seating



Center Stage  
15,750 seats



# HARTMAN ARENA

8151 N. Hartman Arena Drive • Park City, KS 67147  
316.744.8880 • [www.hartmanarena.com](http://www.hartmanarena.com)  
[info@hartmanarena.com](mailto:info@hartmanarena.com)



Hartman Arena is a 6,500 seat, multi-purpose facility with 15 acres of parking built with the environment in mind. The building is subterranean (the seating bowl is located underground). The arena is located in Park City, a suburb of Wichita, 15 minutes from downtown and home of the Wichita B-52s Indoor Soccer Team.

## Pipe and Drape

- Uprights and crossbars for up to 50 10'x10' Booths (8' high)
- Drape panels are royal blue in color

## Tables

- 50 2'x8' expo tables available for use in booth spaces

## Catering Service

- Negotiable
- Limited catering services available

## Ticketing Services

Venue features computerized ticketing network including call centers, outlets (Leeker's, Checker's, two Sports Time locations), arena box office and Internet. Network is hosted by tickets.com.

## Parking

- 1,612 blacktop spaces on site
- 1,200 gravel spaces adjacent to blacktop
- Parking fee \$5 per car
- Carpool (4 or more in car) or hybrid vehicles free

## Load-In Door

- 20' high x 14' wide located upstage center
- 16' high x 14' wide located upstage center

## Curtain System

- Half-house curtain: 192' wide x 45' high
- Rigged from aluminum truss with chain hoists to raise and lower
- Reduces seating capacity to 3,300 seats

## Other Technical

- Building is a wi-fi zone with wireless Internet.

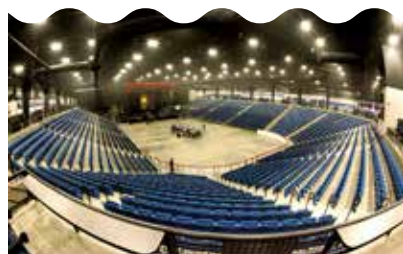



## HARTMAN ARENA

8151 N. Hartman Arena Drive • Park City, KS 67147 • 316.744.8880 • www.hartmanarena.com

■ Standard Seating    
 ■ Handicap Seating    
 ■ Premium Seating

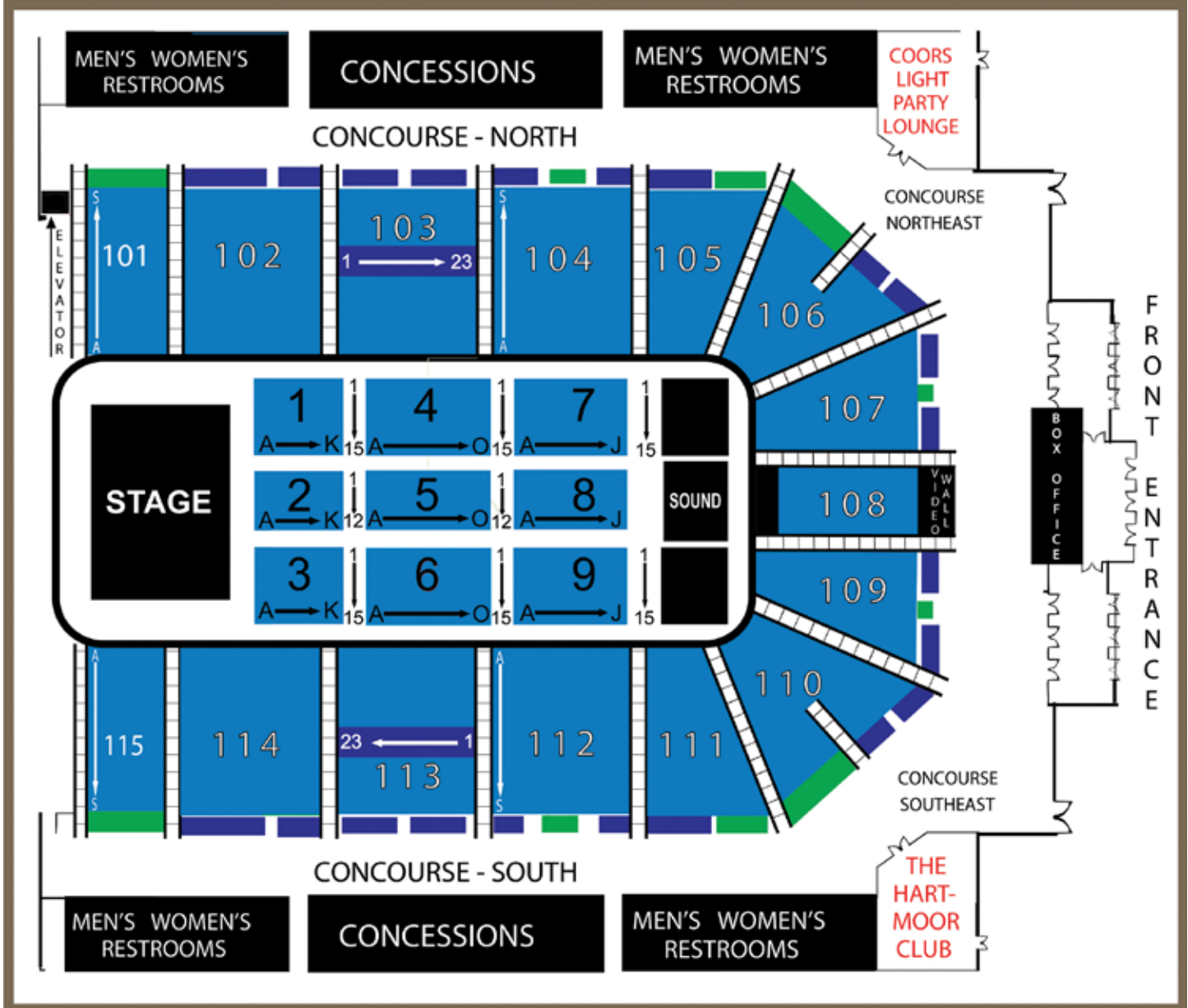

### Meeting Space Information

Floor Dimensions	Exhibit Area	Ceiling Height	Seating
Trade Show Configuration	200' X 125' 26,000 sq ft	65' at center peak	18,250 sq. ft. in concourse
Sports Configuration	200' X 85' 17,000 sq ft	65' at center peak	5,000 permanent
Stage	60' X 48'	adjustable from 48' to 80'	1,750 additional floor seating; 6,750 total

# KANSAS PAVILIONS

1279 E. 85th St. N. • Park City, KS 67147  
 316.440.0888 • [www.kansaspavilions.com](http://www.kansaspavilions.com)  
 General Manager: [david@kansaspavilions.com](mailto:david@kansaspavilions.com)



The Kansas Pavilions is located on I-135 at Exit 17, 12 miles north of downtown Wichita.

## Parking

Access to all areas: 3,600 paved spaces; 500 gravel spaces; 20 acres of grass area

## The Kansas Pavilions Camping Wiedemann Park

- 55-acre camper and trailer facility
- 32 camp sites, 62 trailer sites
- First come, first serve basis. Contact administrative office at 316.440.0888

### Special Features

- 20-amp electrical hookups
- Central water hydrant
- Sanitary dumping station
- Restrooms and showers
- Two lakes

## East Camper Park (South of Pavilion I)

- 20 full-service hookups
- By reservation only. Contact administrative office at 316.440.0888

### Special Features

- 30 and 20-amp breakers at each sight. Must have a ground fault indicator on trailer or camper to work properly.
- Showerhouse and restrooms
- Service turned on following payment
- Moline rock parking pads conveniently located near Pavilion I

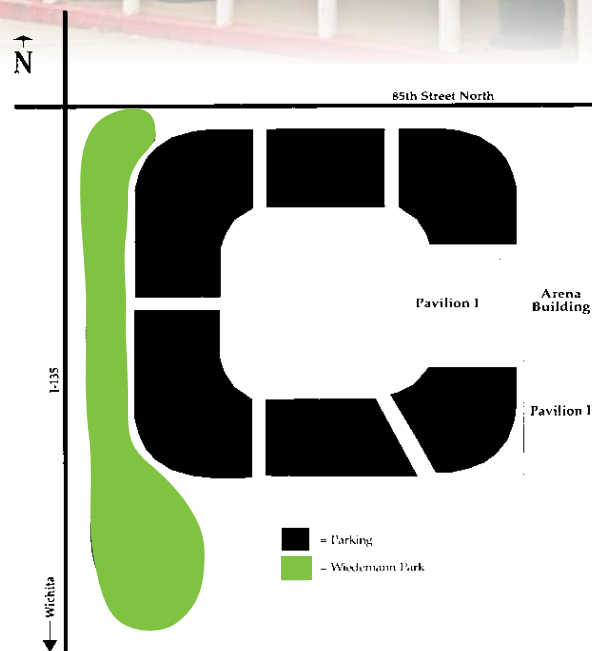

Area	Exhibit Area	Ceiling Height	Seating	10' x 10'
Pavilion I	135,000	14' side 16'6" center	1,080*	550
Arena Building	45,000	16'6" side 18' center	1,000	160
Pavilion II	90,000	12' side 15' center	2,500*	434 livestock stalls

All facilities feature floor load capacities of 300 lbs. per square inch.

\* Bleacher Seating





## KANSAS PAVILIONS

1279 E. 85th St. N. • Park City, KS 67147 • 316.440.0888 • www.kansaspavilions.com

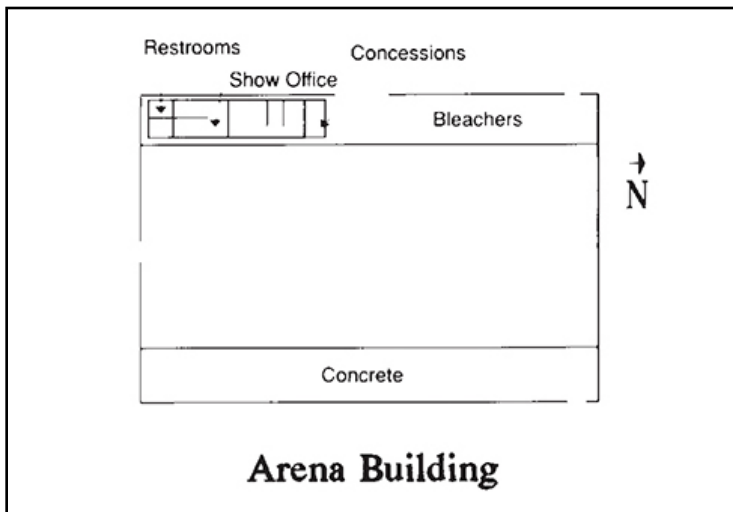

### Arena Building

**45,000 total sq ft**

**Exhibit Area: 36,000 sq ft**

**Special Features:**

- Portable seating for 2,500
- Concession stand
- Show management office space
- Restroom facilities
- Three large door entrances (largest 24' x 16')
- Complete public address and paging systems
- Fluorescent lighting

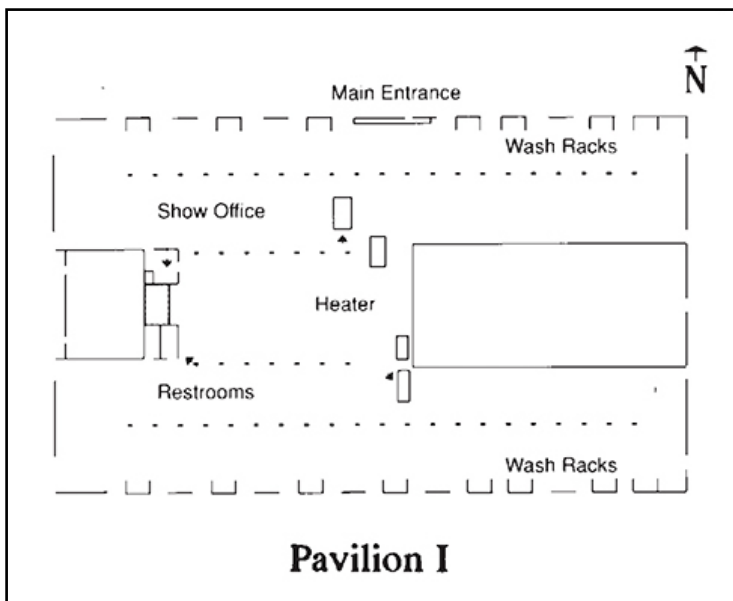

### Pavilion I

**135,000 total sq ft**

**Exhibit Area: 126,900 sq ft**

**Special Features:**

- Wi-fi accessible
- Multi-purpose for tradeshow, auctions, etc.
- Fully heated, well ventilated
- Portable seating for 1,080
- Two concession stands
- Show management office space
- Convenient electrical and water outlets
- Complete public address and paging systems
- 32 large door entrances (largest 24' x 16')
- 15 wash racks
- Truck and trailer parking
- Fluorescent lighting

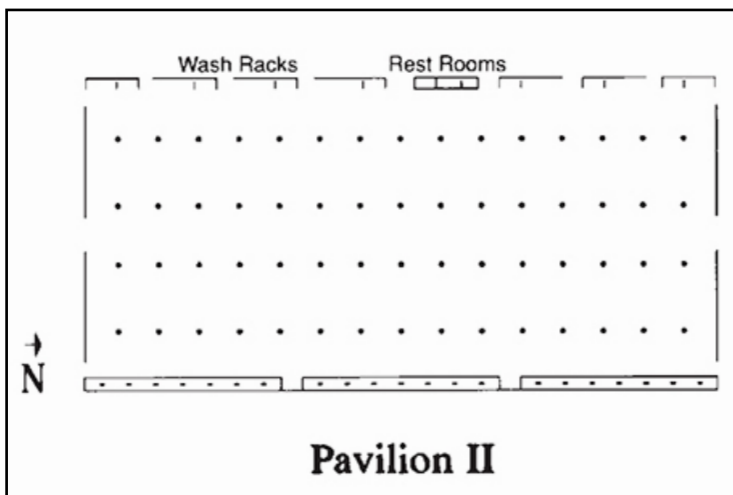

### Pavilion II

**90,000 sq ft of livestock housing area**

**Arena: (200' x 450')**

**Special Features:**

- Portable seating for 2,500
- Seven wash racks
- Convenient water and electrical outlets
- 14 large entrance doors (largest 24' x 16')
- Complete paging system
- Fluorescent lighting
- Truck and trailer parking

## UNIQUE MEETING SPACES



Looking for that perfectly unique spot to hold your meeting or event? You'll find inspiring and functional spaces for your next event. Information is subject to change. Please check with each location for details.

### Abode Venue

1330 E. Douglas • Wichita, KS 67214  
316.267.1330 • [abodevenue.com](http://abodevenue.com)

ABODE Venue offers more than 9,500 sq feet of event space. The exceptional setting features contemporary architectural design details that further enhance the style and ambiance. Divided into three separate and innovate meeting areas, the venue offers flexibility ideal for all event needs.

Number of meeting rooms	3
Capacity of largest meeting room	500
Capacity of largest banquet room	300
Open catering	

### The Alley Indoor Entertainment

11413 E. 13th St. • Wichita, KS 67206  
316.618.1000 • [thealleyonline.com](http://thealleyonline.com)

Your complete indoor entertainment facility! Let The Alley handle your next event. All of our room rentals come with free wi-fi, screen usage, projector usage, speaker phone and competitive rates. Come early to your meeting, stay later after your meeting to eat and play!

Number of meeting rooms	2
Capacity of largest meeting room	70
Capacity of largest banquet room	50

### Auburn Hills Golf Course

443 S. 135th St. W. • Wichita, KS 67235  
316.219.9700 • [golfwichita.com](http://golfwichita.com)

Auburn Hills Golf Course delivers an all-inclusive event setting featuring a gorgeous clubhouse with stunning golf course views, gourmet menu and superior service.

Number of meeting rooms	1
Capacity of largest meeting room	150
Capacity of largest banquet room	150

### Beech Activity Center Treat America Dining

9710 E. Central • Wichita, KS 67206  
316.676.8130 • [treatamerica.com](http://treatamerica.com)

The Beech Activity Center is the ideal ballroom for your next event, including at 48' x 10' stage that is great for group presentations. From comfort food with a twist to the most elegant of dishes, let Premier Catering's skilled culinary team prepare your favorite meal.

Number of meeting rooms	4
Capacity of largest meeting room	1,200
Capacity of largest banquet room	900

### Botanica, The Wichita Gardens

701 Amidon • Wichita, KS 67203  
316.264.0448 • [botanica.org](http://botanica.org)

For small or large gatherings, Botanica is the perfect place to mix business with beauty. The 24 themed gardens provide a beautiful backdrop for your next business meeting, party or event.

Number of meeting rooms	3
Capacity of largest meeting room	400
Capacity of largest banquet room	300







**CANDELA at the LUX**

120 E. First St. • Wichita, KS 67202  
316.260.4496 • [candelalux.com](http://candelalux.com)

Built in 1954, The Lux has unique features and mid-century modern architecture. The original granite-lined hallway invites you into CANDELA where they can accommodate meetings, luncheons, or parties.

- Number of meeting rooms **2**
- Capacity of largest meeting room **200**
- Capacity of largest banquet room **280**

**CityArts**

334 N. Mead • Wichita, KS 67202  
316.350.3245 • [cityarts.org](http://cityarts.org)

Perfect for business meetings, family gatherings, receptions and showers, birthday and retirement parties and so much more. Centrally located in the Old Town District, CityArts is the focal point for all cultural arts in our community.

- Number of meeting rooms **5**
- Capacity of largest meeting room **125**
- Capacity of largest banquet room **90**
- Open catering

**Cotillion Ballroom**

1120 W. Kellogg • Wichita, KS 67209  
316.722.4201 • [thecotillion.com](http://thecotillion.com)

The Cotillion has 28,500 square feet to host up to 2,000 guests for your next event.

- Number of meeting rooms **1**
- Capacity of largest meeting room **2,000**
- Capacity of largest banquet room **2,000**
- Open catering

**Crown Uptown Theatre**

3207 E. Douglas • Wichita, KS 67218  
316.612.7696 • [crownuptown.com](http://crownuptown.com)

We are a large non-traditional theater-style venue with open seating at tables and booths both available. We rent our space or can accommodate large groups for dinner and a show. Event coordinator is available to help with all specific needs.

- Number of meeting rooms **1**
- Capacity of largest meeting room **500**
- Capacity of largest banquet room **500**

**Eberly Farm**

13111 W. 21st St. N. • Wichita, KS 67235  
316.722.3580 • [eberlyfarm.com](http://eberlyfarm.com)

Eberly Farm is surrounded by acres of majestic trees and landscaped grounds. In addition to the climate-controlled banquet hall, Eberly Farm offers an outdoor setting, a beautiful venue for outdoor ceremonies. Eberly Farm is conveniently located on Wichita's west edge.

- Number of meeting rooms **1**
- Capacity of largest meeting room **400**
- Capacity of largest banquet room **250**



## UNIQUE MEETING SPACES



### Exploration Place

300 N. McLean Blvd. • Wichita, KS 67203  
316.660.0642 • [explorationplace.org](http://explorationplace.org)

This science center's stunning architecture and views are just the beginning. Indoor venues include the WaterWay Hall for mid-sized meetings, Grand Hall for larger events, auditorium-seating presentation theater, formal board room, and two smaller meeting rooms.

Number of meeting rooms **6**  
Capacity of largest meeting room **250**  
Capacity of largest banquet room **250**  
Open catering

### Fulton Valley Farms

5079 SW Fulton Road • Towanda, KS 67144  
316.775.1894 • [fultonvalleyfarms.com](http://fultonvalleyfarms.com)

At Fulton Valley Farms, we have facilities that can address any kind of event that you or your group is planning. Our largest barn, the "Boot Scootin' Barn," can accommodate more than 300 people.

Number of meeting rooms **4**  
Capacity of largest meeting room **80**  
Capacity of largest banquet room **300**  
Open catering

### Garvey Center

250 W. Douglas, Ste. 100 • Wichita, KS 67202  
316.261.5325 • [garveycenter.com](http://garveycenter.com)

Located in downtown Wichita, the Garvey Center is the spot for your next event with spectacular downtown view.

Number of meeting rooms **2**  
Capacity of largest meeting room **300**  
Capacity of largest banquet room **200**  
Open catering

### Grace Hill Winery

6310 S. Grace Hill Rd. • Whitewater, KS 67154  
316.799.2511 • [gracehillwinery.com](http://gracehillwinery.com)

Located at the foot of the 8 acre vineyard, the Grace Hill Winery Event Center is the Wichita area's most scenic venue! The center includes a full kitchen and patio and observation deck to bring the party outdoors!

Number of meeting rooms **1**  
Capacity of largest meeting room **120**  
Capacity of largest banquet room **120**  
Open catering

### The Kansas African American Museum

601 N. Water • Wichita, KS 67203  
316.262.7651 • [tkaamuseum.org](http://tkaamuseum.org)

The building housed in the historic Calvary Baptist church will be a wonderful setting for any event. Corporate members receive 10 percent off on facility rental.

Number of meeting rooms **1**  
Capacity of largest meeting room **125**  
Capacity of largest banquet room **100**

### Kansas Aviation Museum

3350 George Washington Blvd. • Wichita, KS 67210  
316.683.9242 • [kansasaviationmuseum.org](http://kansasaviationmuseum.org)

Host your event in a National Historic Register building that has been graced by actors, presidents and dignitaries. Our venue offers flexibility and a unique atmosphere. From our technology smart conference room to using the entire building, we can help you.

Number of meeting rooms **4**  
Capacity of largest meeting room **100**  
Capacity of largest banquet room **300**  
Open catering







**Louise C. Murdock Theatre**

536 N. Broadway • Wichita, KS 67214  
316.263.1665 • [murdocktheatre.com](http://murdocktheatre.com)

Rent our facility for your next event. Our beautiful, historic facility can accommodate a variety of events. The Theatre, Victorian Parlor, Grand Banquet Hall and second-floor conference rooms are all available for rent.

- Number of meeting rooms **4**
- Capacity of largest meeting room **400**
- Capacity of largest banquet room **250**
- Open catering

**Mid-America All Indian Center**

650 S. Seneca St. • Wichita, KS 67203  
316.350.3340 • [theindiancenter.org](http://theindiancenter.org)

We offer a unique facility, overlooking the Arkansas River. The spacious Gallery of Nations level has a spectacular view of the Keeper of the Plains and the surrounding downtown area.

- Number of meeting rooms **1**
- Capacity of largest meeting room **700**
- Capacity of largest banquet room **350**
- Open catering

**Museum of World Treasures**

835 E. 1st St. N. • Wichita, KS 67202  
316.263.1311 • [worldtreasures.org](http://worldtreasures.org)

The Museum of World Treasures, with more than 4,000 certified finds on three floors, offers a one-of-a-kind banquet room perfect for weddings, birthdays, meetings and more. Discover your inner explorer!

- Number of meeting rooms **2**
- Capacity of largest meeting room **250**
- Capacity of largest banquet room **175**
- Open catering

**Newman University**

3100 McCormick Ave. • Wichita, KS 67213  
316.942.4291 • [newmanu.edu](http://newmanu.edu)

Newman University is a coeducational Catholic liberal arts institution.

- Number of meeting rooms **3**
- Capacity of largest meeting room **390**
- Capacity of largest banquet room **320**
- Open catering

**Noah's Event Center**

1550 N. Lindberg Circle • Wichita, KS 67206  
316.708.7688 • [noahseventvenue.com](http://noahseventvenue.com)

NOAH'S is an event venue for all of life's events including weddings, corporate events and special occasions. NOAH'S provides event essentials for no extra charge including tables, chairs, tablecloths, audiovisual, setup and cleanup.

- Number of meeting rooms **4**
- Capacity of largest meeting room **325**
- Capacity of largest banquet room **300**
- Open catering

**Old Cowtown Museum**

1865 Museum Blvd. • Wichita, KS 67203  
316.219.1871 • [oldcowtown.org](http://oldcowtown.org)

Travel back to the Old West for your next event.

- Number of meeting rooms **3**
- Capacity of largest meeting room **140**
- Capacity of largest banquet room **115**
- Open catering



## UNIQUE MEETING SPACES



### Orpheum Theatre

200 N. Broadway • Wichita, KS 67202  
316.263.0884 • [wichitaorpheum.com](http://wichitaorpheum.com)

Located in downtown Wichita, this picturesque and historical theater is a great place for concerts, movies, lectures, corporate events and much more.

Number of meeting rooms **1**  
Capacity of largest meeting room **1,281**  
Capacity of largest banquet room **110**  
Open catering

### Petroleum Club

100 N. Broadway, 9th Floor • Wichita, KS 67202  
316.262.6471 • [petroleumclubwichita.com](http://petroleumclubwichita.com)

The Petroleum Club has one of the best views of Wichita.

Number of meeting rooms **7**  
Capacity of largest banquet room **224**

### Prairie Pines

4055 N. Tyler Road • Maize, KS 67101  
316.721.7666 • [prairiepines.com](http://prairiepines.com)

Prairie Pines is the perfect location for weddings, anniversaries, receptions, seminars and quiet retreats.

Number of meeting rooms **3**  
Capacity of largest meeting room **200**  
Capacity of largest banquet room **200**  
Open catering

### Prairie Rose Chuckwagon Supper

15231 S.W. Parallel Road • Benton, KS 67017  
316.778.2121 • [prairierosechuckwagon.com](http://prairierosechuckwagon.com)

Experience the American West of yesterday and today without blowing your entertainment budget. The Prairie Rose is a great place to celebrate birthdays, anniversaries, and other special events. And it's the perfect place to bring your out-of-town guests.

Number of meeting rooms **3**  
Capacity of largest meeting room **300**  
Capacity of largest banquet room **200**  
Open catering

### Roadhouse Event Center

3813 N. Broadway Street • Wichita, KS 67219  
316.461.5364 • [roadhousevenue.com](http://roadhousevenue.com)

Built in 1935, this historic landmark is a one-of-a-kind venue perfect for class reunions, wedding receptions, office parties or meeting and much more.

Number of meeting rooms **3**  
Capacity of largest meeting room **290**  
Capacity of largest banquet room **290**  
Open catering

### Sedgwick County Zoo

5555 Zoo Blvd. • Wichita, KS 67212  
316.660.9453 • [scz.org](http://scz.org)

Have your next event among Wichita's wildest animals. Tours are available.

Number of meeting rooms **8**  
Capacity of largest meeting room **350**  
Capacity of largest banquet room **150**  
Open catering







**Skyline Venue**

**209 E. Williams Street • Wichita, KS 67202**  
**316.204.8939 • skylinevenueict.com**

Skyline Venue is a high-rise venue that offers a spacious layout and breathtaking views of Wichita’s skyline.

- Number of meeting rooms **1**
- Capacity of largest meeting room **300**
- Capacity of largest banquet room **300**
- Open catering

**Tallgrass Country Club**

**2400 N. Tallgrass • Wichita, KS 67226**  
**316.684.4110 • tallgrass.com**

This option is perfect for next event the room seats approximately 300 people for larger gatherings. The banquet room divides into smaller sections for breakout groups. We offer packages for groups of 10 to 300.

- Number of meeting rooms **4**
- Capacity of largest meeting room **300**
- Capacity of largest banquet room **300**

**Tanganyika Wildlife Park**

**1000 S. Hawkins Lane • Goddard, KS 67052**  
**316.794.8954 • twpark.com**

Tanganyika Wildlife Park is an exotic destination located just 15 minutes west of downtown Wichita. You will truly have a wildly different experience at Tanganyika with beautiful landscapes and some of the world’s most rare and endangered animals.

- Number of meeting rooms **3**
- Capacity of largest meeting room **350**
- Capacity of largest banquet room **350**
- Open catering

**Terradyne Country Club**

**1400 Terradyne Rd • Andover, KS 67002**  
**316.733.282 • terradynecountryclub.com**

Surround yourself with some of the best wine Wichita has to offer. Wyldewood Cellars is a great place to host your next corporate or private event.

- Number of meeting rooms **4**
- Capacity of largest meeting room **65**
- Capacity of largest banquet room **300**

**Warren Old Town Theatre Grille**

**353 N. Mead • Wichita, KS 67202**  
**316.262.7123 • warrentheatres.com**

Our state-of-the-art theaters are completely conference and simulcast ready for any presentation or gathering.

- Number of meeting rooms **6**
- Capacity of largest meeting room **200**
- Capacity of largest banquet room **200**

**Warren Theatres East**

**11611 E. 13th St. • Wichita, KS 67206**  
**316.612.1672 • warrentheatres.com**

World-class luxury theater with rental space for meetings, seminars, conferences or private events, full catering, state-of-the-art AV capabilities.

- Number of meeting rooms **19**
- Capacity of largest meeting room **550**
- Capacity of largest banquet room **550**





## UNIQUE MEETING SPACES



### Warren Theatres West + IMAX

9150 W. 21st St. • Wichita, KS 67205 • 316.722.7967  
warrentheatres.com

Tired of uncomfortable banquet chairs and not being able to see or hear the speaker? The Warren Theatre offers the most comfortable seating in town. Our auditoriums vary in capacity from 70 to 600 and state-of-the-art technology to enhance any presentation.

Number of meeting rooms **19**  
Capacity of largest meeting room **600**  
Capacity of largest banquet room **550** (theater style)

### Wichita Area Association of Realtors

170 W. Dewey • Wichita, KS 67202  
316.263.3167 • wchitarealtors.com

Facility rentals are available for WAAR members, NAR affiliated organizations and general public for business and professional use. Enjoy dinners, receptions and other functions at WAAR conveniently located moments away from downtown Wichita and Old Town.

Number of meeting rooms **2**  
Capacity of largest meeting room **122**  
Capacity of largest banquet room **80**  
Open catering

### Wichita Art Museum

1400 W. Museum Blvd. • Wichita, KS 67203  
316.268.4919 • wichitaartmuseum.org

Enjoy an elegant area ideal for a corporate event or evening reception.

Number of meeting rooms **4**  
Capacity of largest meeting room **200**  
Capacity of largest banquet room **200**

### Wichita Boathouse/ Kansas Sports Hall of Fame

515 S. Wichita • Wichita, KS 67202  
316.262.2038 • boathouse.org

Whether you want to find out about the history of sports in Kansas or looking for a unique venue for your next event - the Wichita Boathouse is the place for you.

Number of meeting rooms **1**  
Capacity of largest meeting room **250**  
Capacity of largest banquet room **200**







**Wichita State University Eugene M. Hughes Metropolitan Complex**

**5015 E. 29th St. N. • Wichita, KS 67220 • 316.978.3258**

The Eugene M. Hughes Metropolitan Complex conference and meeting facilities are available for use by the university or by the community. The facility provides a wide array of conveniences for your next event, including at-door parking, on-site catering and audiovisual equipment rental.

- Number of meeting rooms **7**
- Capacity of largest meeting room **1,700**
- Capacity of largest banquet room **240**

**Wichita State University Marcus Welcome Center**

**1845 N. Fairmount • Wichita, KS 67260  
316.978.3475 (corner of 21st & Mike Oatman Drive)**

The Marcus Welcome Center is the front door to the university and has several rooms for a luncheon or meeting.

- Number of meeting rooms **4**
- Capacity of largest meeting room **450**
- Capacity of largest banquet room **180**

**Wichita State University Rhatigan Student Center**

**1845 N. Fairmount • Wichita, KS 67260 • 316.978.3475  
(corner of 21st & Mike Oatman Drive) • Wichita.edu/rsc**

The Rhatigan Student Center is the perfect place to host your next company meeting! All of the building's conference rooms were a part of the 30 million dollar building renovation. We have a wide variety of rooms and set ups to fit your needs.

- Number of meeting rooms **22**
- Capacity of largest meeting room **483**
- Capacity of largest banquet room **376**

**Wyldeewood Cellars Winery & Gift Shop**

**Exit 33 on the Kansas Turnpike • Mulvane, KS 67110  
316.554.9463 • wyldeewoodcellars.com**

Surround yourself with some of the best wine Wichita has to offer. Wyldeewood Cellars is a great place to host your next corporate or private event.

- Number of meeting rooms **2**
- Capacity of largest meeting room **200**
- Capacity of largest banquet room **200**
- Open catering

**Venue 3130**

**3130 W. Central • Wichita, KS 67203  
316.942.3130 • venue3130.com**

Venue 3130 is an event space minutes west of downtown Wichita. With two unique rooms up to 450 guests may be accommodated for meetings and parties. Facility includes a kitchen and a bridal suite.

- Number of meeting rooms **2**
- Capacity of largest meeting room **300**
- Capacity of largest banquet room **450**
- Open catering

**Venue 332 at the Wichita Scottish Rite Center**

**332 E. First • Wichita, KS 67202  
316.263.4218 • wichitascottishrite.org**

Venue 332 at the Wichita Scottish Rite Center is one of six historical landmarks in Wichita and is a memorable place to have your next meeting or event.

- Number of meeting rooms **4**
- Capacity of largest meeting room **700**
- Capacity of largest banquet room **450**





**One of the most iconic images in Wichita, the Keeper of the Plains stands at the confluence of the Arkansas and Little Arkansas Rivers. The 44', five-ton stylized sculpture of an Indian Chief was designed by Native American artist Blackbear Bosin.**







**VISIT WICHITA SERVICES**





### Visit Wichita is prepared to assist organizations with all aspects of planning a successful event.

#### Marketing & Attendance Building

- Artwork for promotional materials, including photos, logos and videos
- Customized attendance builder e-blasts and brochure
- Welcome letters from the Mayor of Wichita and other community leaders
- Local media contact list
- News releases can be sent to media contacts
- Event posted to Visit Wichita's calendar of events
- Social media announcements

#### Concierge Services

- Assistance in planning sightseeing tours, spouse/family activities and off-site social events tailored to your group
- Digital airport welcome for attendees as they arrive to the city
- Welcome booth to provide information about attractions, dining and events
- The Mayor or other community leaders to give a personal welcome to attendees
- Assistance from Visit Wichita staff with registration
- Name badge production
- Housing bureau with online centralized reservation services

#### Collateral to Welcome Your Attendees

- Visitor guides with map, attraction brochures and event calendars
- Dining discounts provided to meeting planner to distribute to attendees
- Q-line map to help guide attendees with downtown transportation
- This Week in Wichita lists the weeks' events happening in the city
- Convention "alerts" sent to restaurants, attractions and other local businesses



## VISIT WICHITA DESTINATION SALES TEAM



**Anita Harris**

Destination Sales Manager  
aharris@visitwichita.com

**Markets:** Fraternal, Greek Letter Societies, Hobby & Avocational, Religious, Military Reunions



**Maureen Hofrenning**

Vice President  
mhofrenning@visitwichita.com



**Drew Hays**

Destination Sales Sports Manager  
dhays@visitwichita.com

**Markets:** Sports Events & Sports Meetings



**Jessica Buettgenbach**

Destination Sales Coordinator  
jbuettgenbach@visitwichita.com



**Amy Schmidt**

Destination Sales Manager  
aschmidt@visitwichita.com

**Markets:** Agriculture, Environmental, Education, Trade/Business (other than listed)



**Susan Cohrs**

Destination Services Manager  
scohrs@visitwichita.com



**Keith Talbert, CMP**

Destination Sales Manager  
ktalbert@visitwichita.com

**Markets:** Aviation, Cultural, Energy, Government, Healthcare, Military, Scientific & Engineering, Social Welfare



**Jan Hiebert**

Partnership Services Manager  
jhiebert@visitwichita.com



Call us to plan your meeting in Wichita. Our professional staff have the expertise and knowledge of our city, our convention center and our local service partners to make your event a success!



Wichita is Kansas' largest city filled with significant aviation and western heritage, arts and culture, entrepreneurs, festivals, and places to dine, shop, and play.





## TESTIMONIALS







515 S. Main, Suite 115  
Wichita, KS 67202

visitwichita.com  
316.265.2800  
800.288.9424

"I went into the 2014 U.S. Custom Harvester's Convention completely clueless. The job of organizing the event had been started prior to my involvement and I was unsure of what I was doing and how to do it (I'd never organized an event as large as this ever before). **I was fortunate enough to have Visit Wichita personnel help me with all details** - large and small. If it hadn't been for them, I'm just not sure how well the convention would have turned out. As it was... it was one of the better ones we've ever had. Thank you, Visit Wichita!"

**Tracy Zeorian, Executive Director • U.S. Custom Harvesters, Inc.**

"We decided to host our 2014 Leadership Conference in Wichita due to **affordability.**"

**Wes Guidry, CMP • Vietnam Veterans of America**

"**Wow, you guys really did help us,** we had the best turn out that we have had in years. We had over 600 attend! We were just pleased as could be and when any asked how we turned this around I told them it was mostly because of you guys. THANK YOU!"

**Cindy Phillips, Event Organizer • Kansas Numismatic Association**

"On behalf of KansasKatz I would like to thank the good folks at Wichita Convention & Visitors Bureau for a banner year. Our third annual cat show went well. We had a **good turn out** because of the good exposure and support we had from the media. We grew and prospered only because we found some great friends like you who gave us **loyal support** along the way. It's a wonderful occasion for us as we look forward to next year. The future looks bright, and we want to acknowledge your contribution to this rosy outlook and say, "We Appreciate it!"

**Richard L. Hummel • KansasKatz**

"I just wanted to let you know how much I appreciate Visit Wichita helping out with The Wichita Industrial Trade Show. The two volunteers you provided, Lee Kohls and Nancy Wilson, did a **fantastic job** and were such a pleasure to work with. I hope they will be available in two years when we do this all again. Thanks,"

**Dana Giggy • WITS Board  
Wichita Industrial Trade Show**

"I've been doing this for a long time and they are the **best CVB I've ever worked with.**"

**Pam Wright, Meeting Planner • National training seminar**

"It was surprisingly **easy and affordable** to fly to Wichita."

**Marie Zenner • Assistant Director, State and Local Government Affairs • National Association of Home Builders**

"We just wanted to thank you for your help in the initial development of our national convention. **From the very beginning, you went beyond our expectations** and strived to keep everyone informed and updated. We are truly grateful for all that Visit Wichita has done for our organization! Thank you again for your generous hospitality. We look forward to working with you in the future!"

**Sarah Hartung and Abby Dechant • Kansas Agri-Women Convention Co-Chair**

"Thank you for all of your help with our meeting - our **most successful fall event ever!** Thank you also for the gift bags. They are great memories of Wichita."

**Gregg Balko • Executive Director Society for the Advancement of Material and Process Engineering**

"Our group loved it. They commented that they had no idea that **Wichita was so nice** with so much to see. Thank you so much for all your help. I couldn't have done it without the CVB!"

**Julie A. Pope • Office Manager/History Researcher • Kansas State Historical Society, Historic Sites Division**

"The Conference was deemed a huge success by those who attended and members were **impressed with the atmosphere** Kansas provided them. The Monday Social event at the Cheney Yacht and Sailing Club was rated by the party as one of the best from the conference held to date."

**Dan Heskett • Kansas Wildlife and Parks Boating Law Administrator • NASBLA**





“Visit Wichita was very instrumental in our selection of Wichita for our annual conference. From the time we began exploring Wichita, they were extremely helpful in setting up contacts and gathering information for us. Wichita offers a central location, great accommodations and a variety of activities for our participants.”

**VICKY GEGAN**  
Executive Director  
Kansas Interscholastic  
Athletic Administrators  
Association

## GROUPS WHO HAVE CHOSEN WICHITA

2019	United States Bowling Congress Women’s Championships
2018	NCAA Division I Men’s Basketball First & Second Rounds
2016	Signature EquipoVision Summer Convention
2016	South Central Jurisdiction of the United Methodist Church General Conference
2015/17	Kansas Hospital Association Annual Convention & Trade Show
2015	National Assn of State Boating Law Administrators (NASBLA) Convention
2015	National Farmers Union Convention
2015	Southwestern Psychological Association Convention
2015	Great Plains Annual Conference of the United Methodist Church
2015	Delta Kappa Gamma Society International SW Regional Conference
2015	YMCA National Gymnastics Championships
2015/16	United States Bowling Congress Intercollegiate Team Championship
2014	American Bonanza Society Annual Conference and Exhibition
2014	US Custom Harvesters Annual Convention
2014	Pontiac–Oakland Club International Annual Convention
2014	Ladies Oriental Shrine 100th Grand Council Session
2014	Vietnam Veterans of America National Leadership Conference
2013	Society for the Advancement of Material and Process Engineering (SAMPE) Fall Technical Conference
2013	United Soybean Board Summer Conference
2013–14	International Machine Quilters Association Machine Quilters Showcase
2012	Midwest Fish & Wildlife Conference Annual Meeting
2012	American Rabbit Breeders Association National Convention
2011	North American Securities Administrators Association Annual Meeting
2011	USA Track & Field National Junior Olympic Track & Field Championships
2011	NCAA Division I Women’s Basketball Championship
2010–12	Society of Decorative Painters International Conference & Expo
2010	Grain Elevator and Processing Society Annual Exchange
2010	National Association of State Aviation Officials Annual Convention & Tradeshow



VISIT  
WICHITA



## EXPERIENCE WICHITA







# TRANSPORTATION

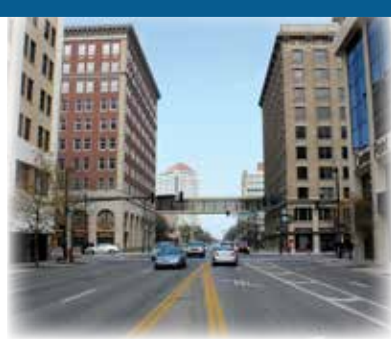





## HOTELS & FACILITIES







# VISIT WICHITA SERVICES







# TESTIMONIALS







# MEETING PLANNER GUIDE

515 S. Main, Suite 115  
Wichita, KS 67202  
800.288.9424  
[www.visitwichita.com](http://www.visitwichita.com)





# SPORTS PLANNER GUIDE

515 S. Main, Suite 115  
Wichita, KS 67202  
800.288.9424  
[www.visitwichita.com](http://www.visitwichita.com)





**515 S. Main, Suite 115  
Wichita, KS 67202  
800.288.9424  
VisitWichita.com**



515 S. Main, Suite 115  
Wichita, KS 67202  
800.288.9424

[VisitWichita.com](http://VisitWichita.com) • [WichitaSports.com](http://WichitaSports.com)