

Las Vegas

VEGASMEANSBUSINESS.COM

L A S V E G A S  
Convention  
Center





## THE PEOPLE WHO MAKE IT ALL WORK.

At every facility, resort and venue, you'll find seasoned professionals who will see to it that your meeting or convention receives rave reviews. Registration services will make the hassles of planning a meeting disappear.

## ACCESSIBILITY IS KEY.

Las Vegas' mild weather with 320 days of sunshine and modern transportation facilities make it one of the world's most accessible convention and meeting destinations. McCarran International Airport boasts high-efficiency ratings for on-time arrivals and departures. The airport is just minutes from all hotels, motels and convention facilities via taxi, bus, rental car, or ride share vehicles.



500 09/18 #50172



Las Vegas Convention and Visitors Authority  
3150 Paradise Rd., Las Vegas, NV 89109-9096 | T: 702-892-0711 | F: 702-892-2824 | [VegasMeansBusiness.com](http://VegasMeansBusiness.com)

# Las Vegas Convention Center

## LEVEL 1 AND 2 FLOOR PLANS

PLATINUM LOT

RED LOT

WHITE LOT



BLOCKHOUSE LOCATIONS:

BEN & JERRY'S  
KRISPY KRUNCHY CHICKEN  
AUSTIN BLUE BBQ  
QUIZNOS

BLUE LOTS  
1 AND 2

ORANGE LOTS  
1 AND 2

CENTRAL AND  
NORTH HALL  
LEVEL ONE

SOUTH HALL  
LEVEL ONE

SOUTH HALL  
LEVEL TWO

BRONZE LOTS 1-3

NORTH HALL  
LEVEL TWO  
MEETING ROOMS

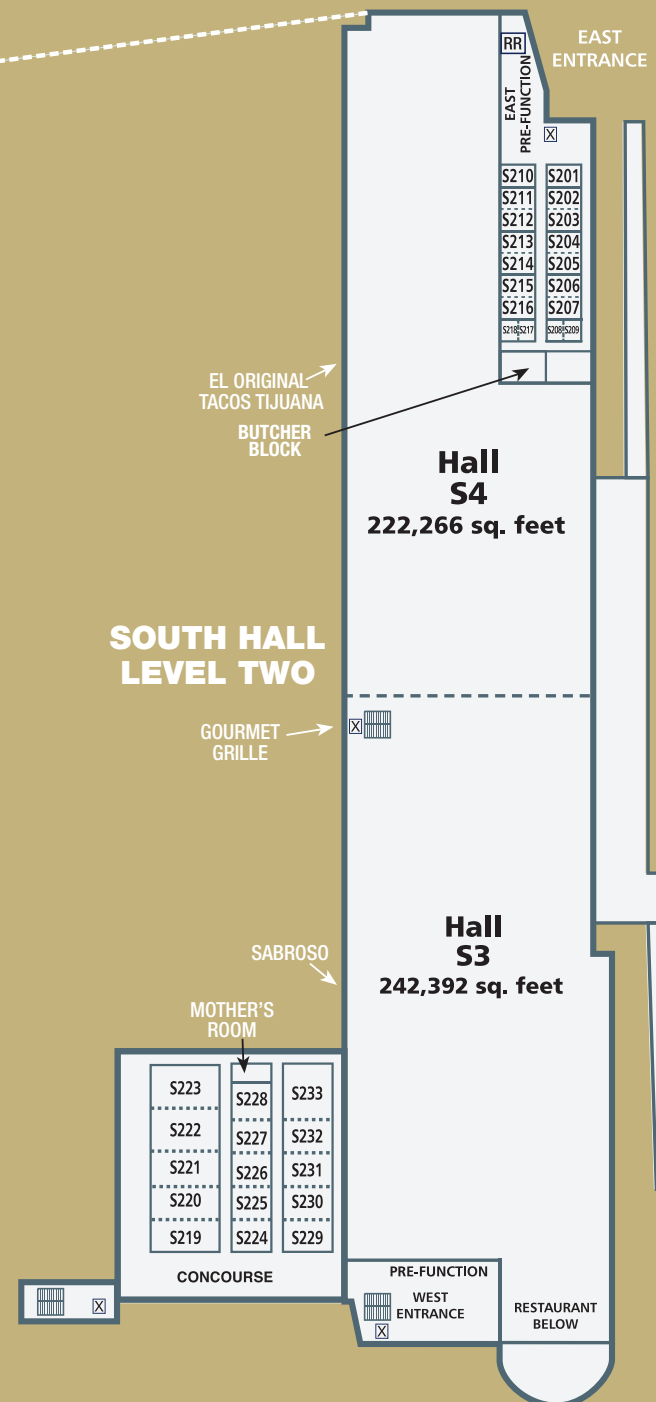
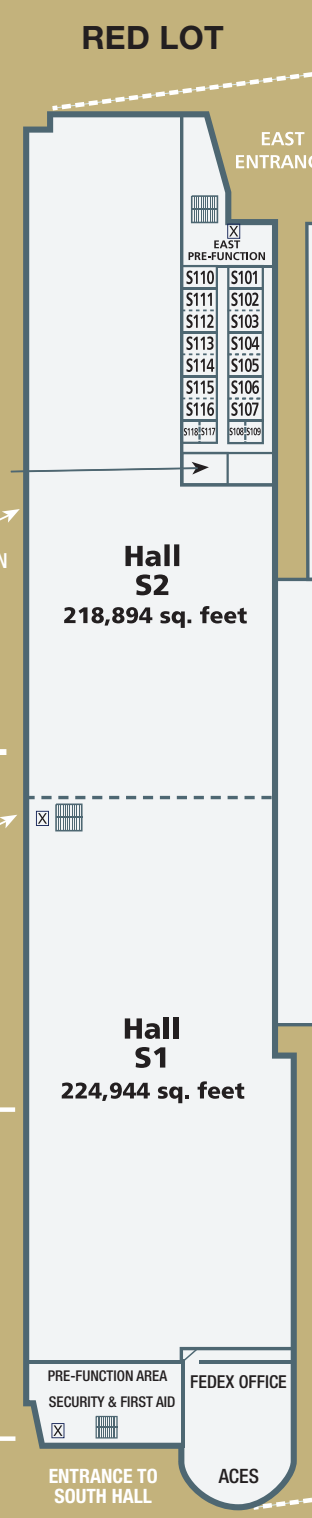
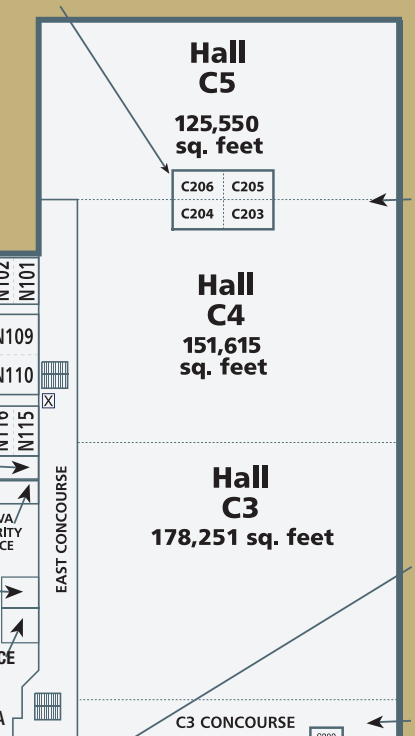
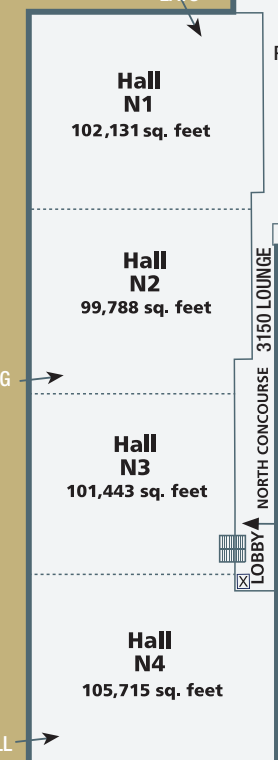
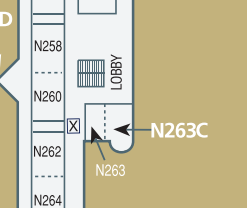
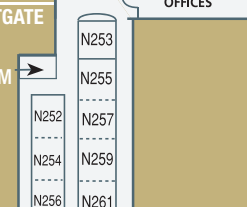
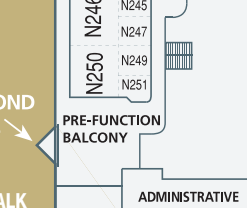
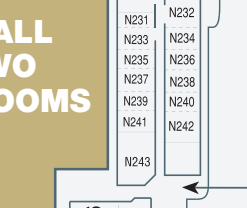
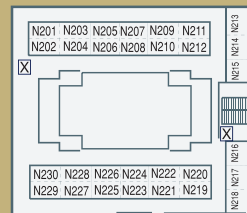

SILVER LOTS 1 AND 2

SILVER LOT 3

⊠ = ELEVATOR  
 = ESCALATOR

PARADISE ROAD

McCARRAN AIRPORT 3.5 MILES →

MAP IS NOT TO SCALE





## We've Considered All Your Options.

The Las Vegas Convention and Visitors Authority presents the Las Vegas Convention Center, a facility designed to maximize your event's convenience, efficiency and impact. The Las Vegas Convention Center can accommodate almost any size meeting or convention.



## OUTSTANDING FACILITIES AND MEETING ROOMS.

- Exhibit halls – all contiguous space
- 3.2 million square feet of total meeting and exhibit space
- 1,940,631 square feet of exhibit space for 10,072 10'x10' booths
- 241,536 square feet of meeting space
- 145 meeting rooms
- 225,000-square-foot lobby/registration space
- Banquet facilities for 12,000
- Two 15,000-square-foot restaurants: Luckys Restaurant seats 600 and Aces offers a combined total of nearly 1,000 seats.
- Parking for more than 7,000 cars
- Life support and safety systems throughout
- The capabilities for allowing simultaneous setup and breakdown of multiple shows. The 11 halls on ground level allow for unlimited floor-load capacity and the two halls on the second floor have 300 lbs. per square foot load capacity. Convenient access to all exhibit halls
- Meeting rooms are all accessible with their own entrances.
- Full compliance with the American Disabilities Act

## EXHIBIT HALL INFORMATION

| EXHIBIT HALL    | SQUARE FEET | DAILY RATE \$ | CEILING HEIGHT | 10X10 BOOTH CAPACITY |
|-----------------|-------------|---------------|----------------|----------------------|
| N1              | 102,131     | 17,850        | 35'            | 510                  |
| N2              | 99,788      | 17,450        | 35'            | 514                  |
| N3              | 101,443     | 17,750        | 33'            | 505                  |
| N4              | 105,715     | 18,500        | 33'            | 540                  |
| TOTAL N1-N4     | 409,077     | \$71,550      |                |                      |
| C1              | 91,605      | 16,050        | 25'            | 501                  |
| C2              | 76,037      | 13,300        | 25'            | 427                  |
| C3              | 178,251     | 31,200        | 31' & 35'      | 1,006                |
| C4              | 151,615     | 26,550        | 35'            | 852                  |
| C5              | 125,550     | 21,950        | 35'            | 667                  |
| TOTAL C1-C5     | 623,058     | \$109,050     |                |                      |
| S1              | 224,944     | 35,450        | 25'            | 1,082                |
| S2              | 218,894     | 34,500        | 30'            | 1,043                |
| S3              | 242,392     | 38,200        | 25'            | 1,219                |
| S4              | 222,266     | 35,000        | 25'            | 1,078                |
| TOTAL S1-S4     | 908,496     | \$143,150     |                |                      |
| TOTAL ALL HALLS | 1,940,631   | \$323,750     |                |                      |

Notes:

1. Ceiling height in the C3 Concourse is 31'.
2. N2, N3 and N4 Halls have lower ceiling heights under the Skywalk and at the entrances.
3. The floor load limit on the C3 Concourse and Halls S3-S4 is 300 pounds per square foot and 100 pounds per square foot for the S3 lobby and bridge rooms.

## MEETING ROOMS

| MEETING ROOM | ROOM DIMENSION | SQUARE FEET | CEILING HEIGHT | DAILY RATE \$ | THEATER CAPACITY | CLASSROOM CAPACITY | BANQUET CAPACITY |
|--------------|----------------|-------------|----------------|---------------|------------------|--------------------|------------------|
| C102         | 51' X 42'      | 2,177       | 10'6"          |               | 147              | 96                 | 120              |
| C201         | 54' X 30'      | 1,598       | 9'8"           |               | 125              | 48                 | 80               |
| C202         | 28' X 29'      | 781         | 7'9"           |               | 48               | 20                 | 30               |
| C203         | 33' X 26'      | 870         | 8'6"           |               | 55               | 32                 | 40               |
| C204         | 33' X 26'      | 869         | 8'6"           |               | 55               | 32                 | 40               |
| C205         | 28' X 35'      | 775         | 8'6"           |               | 38               | 24                 | 40               |
| C206         | 24' X 36'      | 835         | 8'6"           |               | 54               | 32                 | 50               |
|              |                |             |                |               |                  |                    |                  |
| N101         | 50' X 40'      | 2,020       | 12'            | 700           | 158              | 80                 | 120              |
| N102         | 50' X 39'      | 2,038       | 12'            | 700           | 158              | 80                 | 120              |
| N103         | 50' X 39'      | 2,026       | 12'            | 700           | 159              | 80                 | 120              |
| N104         | 23' X 19'      | 463         | 12'            | 150           | 28               | 12                 | 20               |
| N105         | 23' X 20'      | 479         | 12'6"          | 150           | 21               | 16                 | 20               |
| N106         | 23' X 20'      | 475         | 12'6"          | 150           | 21               | 16                 | 20               |
| N107         | 50' X 40'      | 2,029       | 12'6"          | 700           | 144              | 72                 | 110              |
| N108         | 50' X 39'      | 2,030       | 12'6"          | 700           | 144              | 72                 | 110              |
|              |                |             |                |               |                  |                    |                  |
| N109         | 59' X 46'      | 2,809       | 20'            | 1,000         | 240              | 128                | 180              |
| N110         | 59' X 46'      | 2,814       | 20'            | 1,000         | 240              | 128                | 180              |
| N111         | 59' X 46'      | 2,802       | 20'            | 1,000         | 240              | 128                | 180              |
| N112         | 59' X 46'      | 2,805       | 20'            | 1,000         | 240              | 128                | 180              |
| N113         | 59' X 46'      | 2,812       | 20'            | 1,000         | 240              | 128                | 180              |
| N114         | 59' X 46'      | 2,813       | 20'            | 1,000         | 240              | 128                | 180              |
|              |                |             |                |               |                  |                    |                  |
| N115         | 50' X 40'      | 2,032       | 12'6"          | 700           | 144              | 72                 | 110              |
| N116         | 50' X 39'      | 2,044       | 12'6"          | 700           | 144              | 72                 | 110              |
| N117         | 50' X 39'      | 2,027       | 12'6"          | 700           | 144              | 72                 | 110              |
| N118         | 31' X 23'      | 727         | 12'6"          | 250           | 44               | 24                 | 30               |
| N119         | 50' X 39'      | 2,025       | 12'            | 700           | 144              | 72                 | 110              |
| N120         | 50' X 39'      | 2,032       | 12'            | 700           | 144              | 72                 | 110              |
|              |                |             |                |               |                  |                    |                  |
| N201         | 42' X 27'      | 1,065       | 12'            | 350           | 80               | 40                 | 50               |
| N202         | 42' X 28'      | 1,069       | 12'            | 350           | 80               | 40                 | 50               |
| N203         | 42' X 27'      | 1,060       | 12'            | 350           | 80               | 40                 | 50               |
| N204         | 42' X 28'      | 1,065       | 12'            | 350           | 80               | 40                 | 50               |
|              |                |             |                |               |                  |                    |                  |
| N205         | 38' X 27'      | 954         | 12'            | 350           | 70               | 32                 | 50               |
| N206         | 38' X 27'      | 954         | 12'            | 350           | 70               | 32                 | 50               |
| N207         | 38' X 27'      | 969         | 12'            | 350           | 70               | 32                 | 50               |
| N208         | 38' X 27'      | 969         | 12'            | 350           | 70               | 32                 | 50               |
|              |                |             |                |               |                  |                    |                  |
| N209         | 43' X 28'      | 1,088       | 12'            | 400           | 80               | 40                 | 60               |
| N210         | 43' X 27'      | 1,079       | 12'            | 400           | 80               | 40                 | 60               |
| N211         | 43' X 28'      | 1,090       | 12'            | 400           | 80               | 40                 | 60               |
| N212         | 43' X 27'      | 1,082       | 12'            | 400           | 80               | 40                 | 60               |

# MEETING ROOMS

| MEETING ROOM | ROOM DIMENSION | SQUARE FEET | CEILING HEIGHT | DAILY RATE \$ | HOLLOW SQUARE CAPACITY | U-SHAPED CAPACITY | CONFERENCE CAPACITY |
|--------------|----------------|-------------|----------------|---------------|------------------------|-------------------|---------------------|
| C102         | 51' X 42'      | 2,177       | 10'6"          |               | 52                     | 44                | 32                  |
| C201         | 54' X 30'      | 1,598       | 9'8"           |               | 52                     | 40                | 32                  |
| C202         | 28' X 29'      | 781         | 7'9"           |               | 24                     | 16                | 24                  |
| C203         | 33' X 26'      | 870         | 8'6"           |               | 32                     | 24                | 24                  |
| C204         | 33' X 26'      | 869         | 8'6"           |               | 32                     | 24                | 24                  |
| C205         | 28' X 35'      | 775         | 8'6"           |               | 24                     | 24                | 24                  |
| C206         | 24' X 36'      | 835         | 8'6"           |               | 32                     | 32                | 24                  |
|              |                |             |                |               |                        |                   |                     |
| N101         | 50' X 40'      | 2,020       | 12'            | 700           | 52                     | 44                | 32                  |
| N102         | 50' X 39'      | 2,038       | 12'            | 700           | 52                     | 44                | 32                  |
| N103         | 50' X 39'      | 2,026       | 12'            | 700           | 52                     | 44                | 32                  |
| N104         | 23' X 19'      | 463         | 12'            | 150           | 16                     | 12                | 16                  |
| N105         | 23' X 20'      | 479         | 12'6"          | 150           | 16                     | 12                | 16                  |
| N106         | 23' X 20'      | 475         | 12'6"          | 150           | 16                     | 12                | 16                  |
| N107         | 50' X 40'      | 2,029       | 12'6"          | 700           | 52                     | 44                | 32                  |
| N108         | 50' X 39'      | 2,030       | 12'6"          | 700           | 52                     | 44                | 32                  |
|              |                |             |                |               |                        |                   |                     |
| N109         | 59' X 46'      | 2,809       | 20'            | 1,000         | 68                     | 48                | 32                  |
| N110         | 59' X 46'      | 2,814       | 20'            | 1,000         | 68                     | 48                | 32                  |
| N111         | 59' X 46'      | 2,802       | 20'            | 1,000         | 68                     | 48                | 32                  |
| N112         | 59' X 46'      | 2,805       | 20'            | 1,000         | 68                     | 48                | 32                  |
| N113         | 59' X 46'      | 2,812       | 20'            | 1,000         | 68                     | 48                | 32                  |
| N114         | 59' X 46'      | 2,813       | 20'            | 1,000         | 68                     | 48                | 32                  |
|              |                |             |                |               |                        |                   |                     |
| N115         | 50' X 40'      | 2,032       | 12'6"          | 700           | 52                     | 44                | 32                  |
| N116         | 50' X 39'      | 2,044       | 12'6"          | 700           | 52                     | 44                | 32                  |
| N117         | 50' X 39'      | 2,027       | 12'6"          | 700           | 52                     | 44                | 32                  |
| N118         | 31' X 23'      | 727         | 12'6"          | 250           | 24                     | 24                | 16                  |
| N119         | 50' X 39'      | 2,025       | 12'            | 700           | 52                     | 44                | 32                  |
| N120         | 50' X 39'      | 2,032       | 12'            | 700           | 52                     | 44                | 32                  |
|              |                |             |                |               |                        |                   |                     |
| N201         | 42' X 27'      | 1,065       | 12'            | 350           | 40                     | 32                | 36                  |
| N202         | 42' X 28'      | 1,069       | 12'            | 350           | 40                     | 32                | 36                  |
| N203         | 42' X 27'      | 1,060       | 12'            | 350           | 40                     | 32                | 36                  |
| N204         | 42' X 28'      | 1,065       | 12'            | 350           | 40                     | 32                | 36                  |
|              |                |             |                |               |                        |                   |                     |
| N205         | 38' X 27'      | 954         | 12'            | 350           | 40                     | 32                | 36                  |
| N206         | 38' X 27'      | 954         | 12'            | 350           | 40                     | 32                | 36                  |
| N207         | 38' X 27'      | 969         | 12'            | 350           | 40                     | 32                | 36                  |
| N208         | 38' X 27'      | 969         | 12'            | 350           | 40                     | 32                | 36                  |
|              |                |             |                |               |                        |                   |                     |
| N209         | 43' X 28'      | 1,088       | 12'            | 400           | 40                     | 32                | 36                  |
| N210         | 43' X 27'      | 1,079       | 12'            | 400           | 40                     | 32                | 36                  |
| N211         | 43' X 28'      | 1,090       | 12'            | 400           | 40                     | 32                | 36                  |
| N212         | 43' X 27'      | 1,082       | 12'            | 400           | 40                     | 32                | 36                  |

## MEETING ROOMS

| MEETING ROOM | ROOM DIMENSION | SQUARE FEET | CEILING HEIGHT | DAILY RATE \$ | THEATER CAPACITY | CLASSROOM CAPACITY | BANQUET CAPACITY |
|--------------|----------------|-------------|----------------|---------------|------------------|--------------------|------------------|
| N213         | 41' X 31'      | 1,068       | 12'            | 350           | 84               | 36                 | 50               |
| N214         | 30' X 31'      | 872         | 12'            | 300           | 44               | 24                 | 40               |
| N215         | 26' X 28'      | 755         | 12'            | 250           | 44               | 24                 | 40               |
| N216         | 26' X 20'      | 565         | 12'            | 200           | 28               | 16                 | 30               |
| N217         | 30' X 31'      | 857         | 12'            | 300           | 52               | 24                 | 50               |
| N218         | 40' X 31'      | 1,055       | 12'            | 350           | 72               | 32                 | 50               |
| N219         | 43' X 27'      | 1,086       | 12'            | 400           | 80               | 40                 | 50               |
| N220         | 43' X 27'      | 1,086       | 12'            | 400           | 80               | 40                 | 50               |
| N221         | 43' X 27'      | 1,076       | 12'            | 400           | 80               | 40                 | 50               |
| N222         | 43' X 27'      | 1,075       | 12'            | 400           | 80               | 40                 | 50               |
| N223         | 38' X 27'      | 956         | 12'            | 350           | 70               | 32                 | 50               |
| N224         | 38' X 27'      | 963         | 12'            | 350           | 70               | 32                 | 50               |
| N225         | 38' X 27'      | 955         | 12'            | 350           | 70               | 32                 | 50               |
| N226         | 38' X 27'      | 964         | 12'            | 350           | 70               | 32                 | 50               |
| N227         | 42' X 27'      | 1,061       | 12'            | 350           | 80               | 40                 | 50               |
| N228         | 42' X 27'      | 1,052       | 12'            | 350           | 80               | 40                 | 50               |
| N229         | 42' X 27'      | 1,067       | 12'            | 350           | 80               | 40                 | 50               |
| N230         | 42' X 27'      | 1,059       | 12'            | 350           | 80               | 40                 | 50               |
| N231         | 47' X 25'      | 1,155       | 13'            | 400           | 84               | 48                 | 60               |
| N232         | 45' X 43'      | 1,876       | 13'            | 650           | 160              | 80                 | 120              |
| N233         | 47' X 30'      | 1,379       | 13'            | 500           | 111              | 48                 | 70               |
| N234         | 43' X 30'      | 1,217       | 13'            | 450           | 91               | 40                 | 70               |
| N235         | 47' X 30'      | 1,379       | 13'            | 500           | 111              | 48                 | 70               |
| N236         | 43' X 30'      | 1,212       | 13'            | 400           | 85               | 40                 | 70               |
| N237         | 47' X 30'      | 1,381       | 13'            | 500           | 111              | 40                 | 70               |
| N238         | 43' X 29'      | 1,206       | 13'            | 400           | 85               | 32                 | 60               |
| N239         | 47' X 30'      | 1,379       | 13'            | 500           | 111              | 60                 | 60               |
| N240         | 43' X 30'      | 1,219       | 13'            | 450           | 78               | 60                 | 50               |
| N241         | 47' X 31'      | 1,380       | 13'            | 500           | 106              | 60                 | 70               |
| N242         | 43' X 43'      | 1,829       | 13'            | 650           | 139              | 80                 | 100              |
| N243         | 50' X 48'      | 2,298       | 12'6"          | 800           | 187              | 92                 | 120              |
| N245         | 45' X 37'      | 1,647       | 19'            | 600           | 105              | 64                 | 80               |
| N246         | 77' X 67'      | 5,206       | 19'            | 1,800         | 493              | 284                | 330              |
| N247         | 45' X 40'      | 1,718       | 19'            | 600           | 119              | 80                 | 90               |
| N249         | 45' X 44'      | 1,903       | 19'            | 650           | 135              | 80                 | 90               |
| N250         | 77' X 67'      | 5,197       | 19'            | 1,800         | 493              | 264                | 320              |
| N251         | 45' X 39'      | 1,640       | 19'            | 550           | 92               | 76                 | 80               |



## MEETING ROOMS

| MEETING ROOM | ROOM DIMENSION | SQUARE FEET | CEILING HEIGHT | DAILY RATE \$ | HOLLOW SQUARE CAPACITY | U-SHAPED CAPACITY | CONFERENCE CAPACITY |
|--------------|----------------|-------------|----------------|---------------|------------------------|-------------------|---------------------|
| N213         | 41' X 31'      | 1,068       | 12'            | 350           | 40                     | 32                | 36                  |
| N214         | 30' X 31'      | 872         | 12'            | 300           | 32                     | 24                | 24                  |
| N215         | 26' X 28'      | 755         | 12'            | 250           | 32                     | 24                | 20                  |
| N216         | 26' X 20'      | 565         | 12'            | 200           | 24                     | 20                | 20                  |
| N217         | 30' X 31'      | 857         | 12'            | 300           | 24                     | 24                | 20                  |
| N218         | 40' X 31'      | 1,055       | 12'            | 350           | 40                     | 28                | 36                  |
| N219         | 43' X 27'      | 1,086       | 12'            | 400           | 48                     | 32                | 36                  |
| N220         | 43' X 27'      | 1,086       | 12'            | 400           | 48                     | 32                | 36                  |
| N221         | 43' X 27'      | 1,076       | 12'            | 400           | 48                     | 32                | 36                  |
| N222         | 43' X 27'      | 1,075       | 12'            | 400           | 48                     | 32                | 36                  |
| N223         | 38' X 27'      | 956         | 12'            | 350           | 40                     | 32                | 36                  |
| N224         | 38' X 27'      | 963         | 12'            | 350           | 40                     | 32                | 36                  |
| N225         | 38' X 27'      | 955         | 12'            | 350           | 40                     | 32                | 36                  |
| N226         | 38' X 27'      | 964         | 12'            | 350           | 40                     | 32                | 36                  |
| N227         | 42' X 27'      | 1,061       | 12'            | 350           | 40                     | 32                | 36                  |
| N228         | 42' X 27'      | 1,052       | 12'            | 350           | 40                     | 32                | 36                  |
| N229         | 42' X 27'      | 1,067       | 12'            | 350           | 40                     | 32                | 36                  |
| N230         | 42' X 27'      | 1,059       | 12'            | 350           | 40                     | 32                | 36                  |
| N231         | 47' X 25'      | 1,155       | 13'            | 400           | 40                     | 32                | 36                  |
| N232         | 45' X 43'      | 1,876       | 13'            | 650           | 48                     | 36                | 36                  |
| N233         | 47' X 30'      | 1,379       | 13'            | 500           | 40                     | 32                | 36                  |
| N234         | 43' X 30'      | 1,217       | 13'            | 450           | 40                     | 32                | 36                  |
| N235         | 47' X 30'      | 1,379       | 13'            | 500           | 40                     | 32                | 36                  |
| N236         | 43' X 30'      | 1,212       | 13'            | 400           | 40                     | 32                | 36                  |
| N237         | 47' X 30'      | 1,381       | 13'            | 500           | 40                     | 32                | 36                  |
| N238         | 43' X 29'      | 1,206       | 13'            | 400           | 40                     | 32                | 36                  |
| N239         | 47' X 30'      | 1,379       | 13'            | 500           | 40                     | 32                | 36                  |
| N240         | 43' X 30'      | 1,219       | 13'            | 450           | 40                     | 32                | 36                  |
| N241         | 47' X 31'      | 1,380       | 13'            | 500           | 40                     | 32                | 36                  |
| N242         | 43' X 43'      | 1,829       | 13'            | 650           | 48                     | 36                | 36                  |
| N243         | 50' X 48'      | 2,298       | 12'6"          | 800           | 48                     | 36                | 36                  |
| N245         | 45' X 37'      | 1,647       | 19'            | 600           | 32                     | 32                | 28                  |
| N246         | 77' X 67'      | 5,206       | 19'            | 1,800         | 96                     | 76                | 52                  |
| N247         | 45' X 40'      | 1,718       | 19'            | 600           | 44                     | 36                | 28                  |
| N249         | 45' X 44'      | 1,903       | 19'            | 650           | 40                     | 36                | 36                  |
| N250         | 77' X 67'      | 5,197       | 19'            | 1,800         | 96                     | 76                | 52                  |
| N251         | 45' X 39'      | 1,640       | 19'            | 550           | 32                     | 32                | 28                  |

## MEETING ROOMS

| MEETING ROOM | ROOM DIMENSION | SQUARE FEET | CEILING HEIGHT | DAILY RATE \$ | THEATER CAPACITY | CLASSROOM CAPACITY | BANQUET CAPACITY |
|--------------|----------------|-------------|----------------|---------------|------------------|--------------------|------------------|
| N252         | 58' X 47'      | 2,618       | 17'            | 900           | 232              | 128                | 130              |
| N253         | 60'9" X 55'    | 3,218       | 17'            | 1,150         | 282              | 180                | 180              |
| N254         | 59' X 47'      | 2,675       | 17'            | 950           | 234              | 136                | 130              |
| N255         | 55' X 55'      | 2,934       | 17'            | 1,050         | 256              | 132                | 160              |
| N256         | 62' X 47'      | 2,805       | 17'            | 1,000         | 253              | 144                | 170              |
| N257         | 59' X 55'      | 3,180       | 17'            | 1,100         | 284              | 160                | 180              |
| N258         | 63' X 47'      | 2,769       | 17'            | 950           | 254              | 136                | 150              |
| N259         | 59' X 55'      | 3,152       | 17'            | 1,100         | 273              | 148                | 170              |
| N260         | 65' X 47'      | 2,893       | 17'            | 1,000         | 245              | 128                | 170              |
| N261         | 56' X 55'      | 2,976       | 17'            | 1,050         | 255              | 132                | 180              |
| N262         | 61' X 47'      | 2,757       | 17'            | 950           | 256              | 128                | 170              |
| N263         | 45' X 43'      | 1,945       | 14'            | 700           | 144              | 96                 | 110              |
| N263C        | 29' X 59'      | 1,605       | 14'            | 550           | 138              | 72                 | 80               |
| N264         | 53' X 47'      | 2,396       | 17'            | 850           | 214              | 104                | 130              |
|              |                |             |                |               |                  |                    |                  |
| DIAMOND 1    | 41' X 26'      | 598         | 9'             | 200           | 20               | N/A                | 20               |
| DIAMOND 2    | 27' X 26'      | 408         | 9'             | 150           | 20               | N/A                | 20               |
| DIAMOND 3    | 27' X 30'      | 443         | 10'            | 150           | 20               | N/A                | 20               |
| DIAMOND 4    | 27' X 30'      | 444         | 10'            | 150           | 20               | N/A                | 20               |
|              |                |             |                |               |                  |                    |                  |
| S101         | 29' X 21'      | 608         | 13'            | 200           | 38               | 24                 | 30               |
| S102         | 29' X 44'      | 1,227       | 15'            | 450           | 78               | 40                 | 60               |
| S103         | 29' X 44'      | 1,227       | 15'            | 450           | 78               | 40                 | 60               |
| S104         | 29' X 44'      | 1,227       | 15'            | 450           | 78               | 40                 | 60               |
| S105         | 29' X 44'      | 1,229       | 15'            | 450           | 78               | 40                 | 60               |
| S106         | 29' X 44'      | 1,227       | 15'            | 450           | 78               | 40                 | 60               |
| S107         | 29' X 44'      | 1,227       | 15'            | 450           | 78               | 40                 | 60               |
| S108         | 31' X 21'      | 633         | 13'            | 200           | 35               | 24                 | 40               |
| S109         | 31' X 22'      | 618         | 13'            | 200           | 33               | 24                 | 30               |
| S110         | 29' X 44'      | 1,237       | 13'            | 450           | 78               | 40                 | 60               |
| S111         | 29' X 44'      | 1,225       | 15'            | 450           | 78               | 40                 | 60               |
| S112         | 29' X 44'      | 1,227       | 15'            | 450           | 78               | 40                 | 60               |
| S113         | 29' X 44'      | 1,224       | 15'            | 450           | 78               | 40                 | 60               |
| S114         | 29' X 44'      | 1,229       | 15'            | 450           | 78               | 40                 | 60               |
| S115         | 29' X 44'      | 1,226       | 15'            | 450           | 78               | 40                 | 60               |
| S116         | 29' X 44'      | 1,228       | 15'            | 450           | 78               | 40                 | 60               |
| S117         | 31' X 22'      | 636         | 13'            | 200           | 32               | 24                 | 30               |
| S118         | 31' X 21'      | 611         | 13'            | 200           | 30               | 16                 | 30               |

# MEETING ROOMS

| MEETING ROOM | ROOM DIMENSION | SQUARE FEET | CEILING HEIGHT | DAILY RATE \$ | HOLLOW SQUARE CAPACITY | U-SHAPED CAPACITY | CONFERENCE CAPACITY |
|--------------|----------------|-------------|----------------|---------------|------------------------|-------------------|---------------------|
| N252         | 58' X 47'      | 2,618       | 17'            | 900           | 64                     | 48                | 52                  |
| N253         | 60'9" X 55'    | 3,218       | 17'            | 1,150         | 64                     | 52                | 52                  |
| N254         | 59' X 47'      | 2,675       | 17'            | 950           | 56                     | 52                | 52                  |
| N255         | 55' X 55'      | 2,934       | 17'            | 1,050         | 64                     | 52                | 44                  |
| N256         | 62' X 47'      | 2,805       | 17'            | 1,000         | 72                     | 56                | 52                  |
| N257         | 59' X 55'      | 3,180       | 17'            | 1,100         | 64                     | 56                | 52                  |
| N258         | 63' X 47'      | 2,769       | 17'            | 950           | 64                     | 56                | 52                  |
| N259         | 59' X 55'      | 3,152       | 17'            | 1,100         | 64                     | 52                | 52                  |
| N260         | 65' X 47'      | 2,893       | 17'            | 1,000         | 72                     | 60                | 52                  |
| N261         | 56' X 55'      | 2,976       | 17'            | 1,050         | 64                     | 56                | 44                  |
| N262         | 61' X 47'      | 2,757       | 17'            | 950           | 64                     | 56                | 52                  |
| N263         | 45' X 43'      | 1,945       | 14'            | 700           | 52                     | 46                | 36                  |
| N263C        | 29' X 59'      | 1,605       | 14'            | 550           | 44                     | 50                | 80                  |
| N264         | 53' X 47'      | 2,396       | 17'            | 850           | 56                     | 48                | 44                  |
|              |                |             |                |               |                        |                   |                     |
| DIAMOND 1    | 41' X 26'      | 598         | 9'             | 200           | 16                     | 12                | 12                  |
| DIAMOND 2    | 27' X 26'      | 408         | 9'             | 150           | 16                     | 12                | 12                  |
| DIAMOND 3    | 27' X 30'      | 443         | 10'            | 150           | 16                     | 12                | 12                  |
| DIAMOND 4    | 27' X 30'      | 444         | 10'            | 150           | 16                     | 12                | 12                  |
|              |                |             |                |               |                        |                   |                     |
| S101         | 29' X 21'      | 608         | 13'            | 200           | 24                     | 20                | 20                  |
| S102         | 29' X 44'      | 1,227       | 15'            | 450           | 32                     | 28                | 36                  |
| S103         | 29' X 44'      | 1,227       | 15'            | 450           | 32                     | 28                | 36                  |
| S104         | 29' X 44'      | 1,227       | 15'            | 450           | 32                     | 28                | 36                  |
| S105         | 29' X 44'      | 1,229       | 15'            | 450           | 32                     | 28                | 36                  |
| S106         | 29' X 44'      | 1,227       | 15'            | 450           | 32                     | 28                | 32                  |
| S107         | 29' X 44'      | 1,227       | 15'            | 450           | 32                     | 28                | 32                  |
| S108         | 31' X 21'      | 633         | 13'            | 200           | 24                     | 20                | 20                  |
| S109         | 31' X 22'      | 618         | 13'            | 200           | 24                     | 20                | 20                  |
| S110         | 29' X 44'      | 1,237       | 13'            | 450           | 32                     | 28                | 32                  |
| S111         | 29' X 44'      | 1,225       | 15'            | 450           | 32                     | 28                | 32                  |
| S112         | 29' X 44'      | 1,227       | 15'            | 450           | 32                     | 28                | 32                  |
| S113         | 29' X 44'      | 1,224       | 15'            | 450           | 32                     | 28                | 32                  |
| S114         | 29' X 44'      | 1,229       | 15'            | 450           | 40                     | 32                | 28                  |
| S115         | 29' X 44'      | 1,226       | 15'            | 450           | 24                     | 36                | 32                  |
| S116         | 29' X 44'      | 1,228       | 15'            | 450           | 24                     | 36                | 32                  |
| S117         | 31' X 22'      | 636         | 13'            | 200           | 24                     | 24                | 16                  |
| S118         | 31' X 21'      | 611         | 13'            | 200           | 24                     | 24                | 16                  |



## MEETING ROOMS

| MEETING ROOM | ROOM DIMENSION | SQUARE FEET | CEILING HEIGHT | DAILY RATE \$ | THEATER CAPACITY | CLASSROOM CAPACITY | BANQUET CAPACITY |
|--------------|----------------|-------------|----------------|---------------|------------------|--------------------|------------------|
| S201         | 34' X 21'      | 709         | 13'            | 250           | 45               | 28                 | 40               |
| S202         | 29' X 44'      | 1,223       | 15'            | 450           | 78               | 36                 | 60               |
| S203         | 29' X 44'      | 1,215       | 15'            | 450           | 78               | 36                 | 60               |
| S204         | 29' X 43'      | 1,221       | 15'            | 450           | 78               | 36                 | 60               |
| S205         | 29' X 43'      | 1,216       | 15'            | 450           | 78               | 36                 | 60               |
| S206         | 29' X 44'      | 1,221       | 15'            | 450           | 78               | 36                 | 60               |
| S207         | 29' X 44'      | 1,220       | 15'            | 450           | 78               | 36                 | 60               |
| S208         | 31' X 21'      | 637         | 13'            | 200           | 35               | 24                 | 30               |
| S209         | 31' X 22'      | 617         | 13'            | 200           | 37               | 16                 | 20               |
| S210         | 34' X 44'      | 1,354       | 13'            | 450           | 89               | 48                 | 80               |
| S211         | 29' X 44'      | 1,229       | 15'            | 450           | 78               | 36                 | 60               |
| S212         | 29' X 44'      | 1,230       | 15'            | 450           | 78               | 36                 | 60               |
| S213         | 29' X 44'      | 1,182       | 15'            | 400           | 78               | 32                 | 60               |
| S214         | 29' X 44'      | 1,181       | 15'            | 400           | 78               | 32                 | 60               |
| S215         | 29' X 44'      | 1,230       | 15'            | 450           | 78               | 36                 | 60               |
| S216         | 29' X 44'      | 1,233       | 15'            | 450           | 78               | 36                 | 60               |
| S217         | 31' X 21'      | 639         | 13'            | 200           | 35               | 16                 | 30               |
| S218         | 31' X 22'      | 622         | 13'            | 200           | 35               | 16                 | 30               |
| S219         | 45' X 95'      | 4,228       | 18'            | 1,500         | 380              | 224                | 220              |
| S220         | 45' X 97'      | 4,194       | 18'            | 1,450         | 414              | 224                | 220              |
| S221         | 44' X 97'      | 4,216       | 18'            | 1,500         | 353              | 208                | 220              |
| S222         | 60' X 97'      | 5,599       | 18'            | 1,950         | 475              | 256                | 270              |
| S223         | 61' X 97'      | 5,680       | 18'            | 2,000         | 520              | 336                | 280              |
| S224         | 45' X 52'      | 2,296       | 18'            | 800           | 160              | 116                | 120              |
| S225         | 45' X 52'      | 2,245       | 18'            | 800           | 160              | 112                | 110              |
| S226         | 44' X 52'      | 2,240       | 18'            | 800           | 160              | 116                | 110              |
| S227         | 45' X 52'      | 2,245       | 18'            | 800           | 160              | 116                | 110              |
| S228         | 56' X 52'      | 2,781       | 18'            | 950           | 200              | 144                | 140              |
| S229         | 45' X 66'      | 2,937       | 18'            | 1,050         | 260              | 144                | 170              |
| S230         | 44' X 66'      | 2,868       | 18'            | 1,000         | 234              | 144                | 150              |
| S231         | 45' X 66'      | 2,876       | 18'            | 1,000         | 234              | 144                | 150              |
| S232         | 45' X 66'      | 2,882       | 18'            | 1,000         | 252              | 144                | 150              |
| S233         | 76' X 66'      | 4,921       | 18'            | 1,700         | 468              | 240                | 290              |

## MEETING ROOMS

| MEETING ROOM | ROOM DIMENSION | SQUARE FEET | CEILING HEIGHT | DAILY RATE \$ | HOLLOW SQUARE CAPACITY | U-SHAPED CAPACITY | CONFERENCE CAPACITY |
|--------------|----------------|-------------|----------------|---------------|------------------------|-------------------|---------------------|
| S201         | 34' X 21'      | 709         | 13'            | 250           | 32                     | 24                | 24                  |
| S202         | 29' X 44'      | 1,223       | 15'            | 450           | 32                     | 24                | 24                  |
| S203         | 29' X 44'      | 1,215       | 15'            | 450           | 40                     | 32                | 24                  |
| S204         | 29' X 43'      | 1,221       | 15'            | 450           | 40                     | 32                | 24                  |
| S205         | 29' X 43'      | 1,216       | 15'            | 450           | 40                     | 32                | 24                  |
| S206         | 29' X 44'      | 1,221       | 15'            | 450           | 40                     | 32                | 24                  |
| S207         | 29' X 44'      | 1,220       | 15'            | 450           | 40                     | 32                | 24                  |
| S208         | 31' X 21'      | 637         | 13'            | 200           | 32                     | 24                | 16                  |
| S209         | 31' X 22'      | 617         | 13'            | 200           | 24                     | 24                | 16                  |
| S210         | 34' X 44'      | 1,354       | 13'            | 450           | 36                     | 24                | 24                  |
| S211         | 29' X 44'      | 1,229       | 15'            | 450           | 36                     | 32                | 24                  |
| S212         | 29' X 44'      | 1,230       | 15'            | 450           | 36                     | 32                | 24                  |
| S213         | 29' X 44'      | 1,182       | 15'            | 400           | 36                     | 32                | 24                  |
| S214         | 29' X 44'      | 1,181       | 15'            | 400           | 36                     | 32                | 24                  |
| S215         | 29' X 44'      | 1,230       | 15'            | 450           | 36                     | 32                | 24                  |
| S216         | 29' X 44'      | 1,233       | 15'            | 450           | 36                     | 32                | 24                  |
| S217         | 31' X 21'      | 639         | 13'            | 200           | 36                     | 20                | 16                  |
| S218         | 31' X 22'      | 622         | 13'            | 200           | 24                     | 20                | 16                  |
| S219         | 45' X 95'      | 4,228       | 18'            | 1,500         | 100                    | 80                | 72                  |
| S220         | 45' X 97'      | 4,194       | 18'            | 1,450         | 92                     | 76                | 72                  |
| S221         | 44' X 97'      | 4,216       | 18'            | 1,500         | 92                     | 76                | 72                  |
| S222         | 60' X 97'      | 5,599       | 18'            | 1,950         | 108                    | 84                | 72                  |
| S223         | 61' X 97'      | 5,680       | 18'            | 2,000         | 108                    | 84                | 72                  |
| S224         | 45' X 52'      | 2,296       | 18'            | 800           | 56                     | 36                | 40                  |
| S225         | 45' X 52'      | 2,245       | 18'            | 800           | 56                     | 36                | 40                  |
| S226         | 44' X 52'      | 2,240       | 18'            | 800           | 56                     | 36                | 40                  |
| S227         | 45' X 52'      | 2,245       | 18'            | 800           | 56                     | 36                | 40                  |
| S228         | 56' X 52'      | 2,781       | 18'            | 950           | 68                     | 56                | 40                  |
| S229         | 45' X 66'      | 2,937       | 18'            | 1,050         | 68                     | 52                | 48                  |
| S230         | 44' X 66'      | 2,868       | 18'            | 1,000         | 68                     | 52                | 48                  |
| S231         | 45' X 66'      | 2,876       | 18'            | 1,000         | 68                     | 52                | 48                  |
| S232         | 45' X 66'      | 2,882       | 18'            | 1,000         | 68                     | 52                | 48                  |
| S233         | 76' X 66'      | 4,921       | 18'            | 1,700         | 100                    | 80                | 64                  |

## SERVICES AND POLICIES

The Las Vegas Convention and Visitors Authority can help you plan the perfect gathering, from obtaining room blocks to facility recommendations. The following services are available to corporate meeting planners, association executives and convention executives:

- Site inspection arrangements
- Facility and contact information
- Local supplier information
- Promotion assistance
- Press releases/press kits
- Black-and-white photographs
- Color slides/transparencies
- Slides of city attractions
- City promotional video
- Visitor brochures, guides
- Maps
- Calendar of events
- Calendar of shows and entertainment
- Special events assistance
- Pre- and post-convention tours information
- Convention/trade show coordination
- Registration assistance
- Off-site banquet planning assistance
- Office space for meeting planners

For additional information about lodging, transportation, attractions, shows and events, or to view Las Vegas maps, visit [www.VisitLasVegas.com](http://www.VisitLasVegas.com).

### EXHIBIT HALLS

Minimum rate versus \$.35 per net square foot, whichever is greater, per individual hall, per show day when used for commercial exhibits. Total number of move in/move out days is equal to one times the number of show days at no charge. Additional move in/out days are priced at 50 percent of the charged rental rate of hall. One-half normal illumination will be allowed for move in and move out days. Additional lighting, heating and air conditioning requested by the Lessee will be assessed a charge based on actual usage during move in/move out.

### LOBBIES AND CONCOURSE

Lobbies and foyer areas are public domain areas and are to be used for ingress/egress. Leased commercial booths or manned publication booths are not allowed.

### MEETING ROOMS

If available, meeting-room charges are based on 10 complimentary meeting rooms per 100,000 square feet of exhibit space used for halls N1–N4 and C1–C5. Meeting rooms for exhibit halls S1–S4 are assigned. When meeting rooms are used for exhibits or subleased, additional charges will apply. One-time setup per day includes custodial (except when used for offices or exhibit space), lights, heat, air and sound service. Changeovers and revised room setups will be charged a daily room rate. Refer to Exhibit A of lease for all other charges.

### CENTERPLATE 702-943-6779

As the exclusive hospitality partner to the Las Vegas Convention Center, Centerplate is proud to offer full-service catering, pop-up and fixed retail dining, themed lounges, cafes and restaurants to meet the needs of our planners, exhibitors and guests.

Our dedicated event professionals are committed to making the time you spend with us more enjoyable and more valuable. Please contact us about your next event.

### EXHIBITOR HOSPITALITY

Centerplate can help you do more on the floor!

Make your brand a destination with our exhibitor services designed to perk up your meetings or drive traffic to your booth.

- Need an in-booth café and espresso setup to capture attention and keep your clients fueled?
- How about catering or boxed meals to make sure that your event team isn't going hungry?

From engaging after-hours receptions to easy ordering of delicious meals for clients and staff, the Centerplate team is dedicated to Making It Better To Be There®. Contact our exhibitor sales team at [exhibitorcateringlvcc@centerplate.com](mailto:exhibitorcateringlvcc@centerplate.com) or order online: [lvcvexpresscatering.ezplanit.com](http://lvcvexpresscatering.ezplanit.com).

### RECEPTIONS, BANQUETS & BEYOND

Share your good taste with the world! This is your moment to make an impression, and our world-class culinary team and service

professionals are here to help you shine. Craft a memorable event, with delicious, fun and inviting service and menus. Our catering and event managers specialize in getting it just right. Since it's Las Vegas, that means a wealth of possibilities: showstopping buffets, elegant banquets, fun cocktail receptions – for breakfast, lunch, dinner or anything in between. Contact us today for a portfolio of events and options.

### SPONSORSHIP AND BRAND ACTIVATION

Want to go beyond the expected? How about a branded restaurant, right on the show floor? Or a sponsored program to add impressions and maximize exposure? We help you become part of the experience with marketing and sponsorship opportunities that extend beyond the booth to engage guests for a lasting connection. Give our event sales team a call today to explore the possibilities.

### RESTAURANTS, CAFES AND RETAIL DINING

Conveniently located throughout the center in the exhibit halls, as well as two designated eat-in markets, Centerplate's dining options are casual and accessible with a tantalizing array of local and global flavors.

### HIGHLIGHTS INCLUDE:

HoneySalt – Fresh and innovative farm-to-table inspired from the award-winning local restaurant by restaurateur Elizabeth Blau and Chef Kim Canteenwalla.

Walla Pao – Asian-inspired kitchen featuring cucumber wakame salad, Asian slaw, hand-rolled sushi rolls and authentic specialties.

Starbucks – Favorite stop for coffee, espresso, tea and bakery goods.

Lucky's Restaurant (Level 1, located off the Grand Lobby) and Aces Restaurant (Level 1, located in the South Hall Lobby) each feature Bachi Burger, Lindo Michoacan, Atomic Pizza, salads, sandwiches, beverages, and a variety of grab-and-go snacks.

Additional options include Kosher foods, fresh salads, Mexican, pizza, barbecue, and more.





## SERVICES AND POLICIES



### **COX BUSINESS - ADVANCED CONVENTION SERVICES** **855-519-2624** **FAX 702-920-8255** **EMAIL LVCC.ORDERS@COX.COM** **WWW.TRADESHOWS.COXHN.NET**

Cox Business is the exclusive full-service provider for all data, voice and cable TV services at the Las Vegas Convention Center (LVCC).

### **DATA SERVICES**

Cox Business has a full array of internet services available. We can customize a solution that fits all your specific needs for the show. From shared and dedicated high-speed internet access (up to 10 Gbps) to special circuit needs, Cox Business will deliver a seamless network solution. Our services include best-of-class switches, hubs and cabling.

### **VOICE SERVICES**

Stay connected throughout the show with the full suite of voice solutions from Cox Business. Process your orders directly on the spot with our single line service or leverage our Polycom conference phones to work hands free.

### **VIDEO SERVICES**

Complement your event with dynamic cable television service that includes a full HD lineup. Cox Business offers a variety of channels, from local broadcast, news, sports, weather and specialized programming, to keep your guests entertained.

### **COX BUSINESS - DIGITAL ADVERTISING**

Reach convention attendees through advertising on the 14-location, digital-display network throughout the LVCC. These strategically placed monitors range in size from a 55" monitor to our two 40 foot seamless LED screens in the grand lobby.

### **FEDEX OFFICE** **702-733-2898**

FedEx Office is the leader in document management, production and fulfillment services to the Convention and Hospitality industry. With the broadest range of digital document production services and solution centers, FedEx Office has applied this expertise and understanding of this unique market at multiple convention properties around the world. Their experience and superior levels of quality customer service continues to set the pace.

### **SERVICES OFFERED BY FEDEX OFFICE AT THE LAS VEGAS CONVENTION CENTER:**

- Black-and-white and color full-service printing and copying
- Office supplies
- Coat and bag check
- Scooter and wheelchair rental
- Computer work station rental with internet access and printing capabilities
- Laptop stations with internet access and printing capabilities
- Fax service - inbound and outbound
- Office equipment rental
- Packing services and supplies
- Shipping with FedEx Express and FedEx Ground (up to 150 pounds)
- Desktop publishing and document creation services
- Finishing services such as binding options and lamination
- CD and DVD duplication
- Oversize printing
- U.S. Postage

Customized fliers for exhibitor kits and sales kits can be provided by FedEx Office. For assistance with this, please contact them at 702-733-2898.



### **AMERICAN EXPRESS BUSINESS LOUNGE**

Each day, American Express makes it easier, safer and more rewarding for consumers and businesses to purchase the things they need and for merchants to sell their goods and services. An engine of commerce, American Express provides innovative payment, travel and expense management solutions for individuals and businesses of all sizes.

The American Express Business Lounge provides American Express customers with a productive retreat while attending events at the Las Vegas Convention Center. Whether you need somewhere quiet to meet, a break from the trade show floor, Wi-Fi, or coffee and snacks, American Express is there to support you. You can find the American Express Business Lounge after you walk through the Central Hall main entrance.

For more information, please visit [www.americanexpress.com/business](http://www.americanexpress.com/business).

# FREIGHT AND ROLL-UP DOORS

YELLOW NUMBERS SHOW  
FREIGHT DOORS

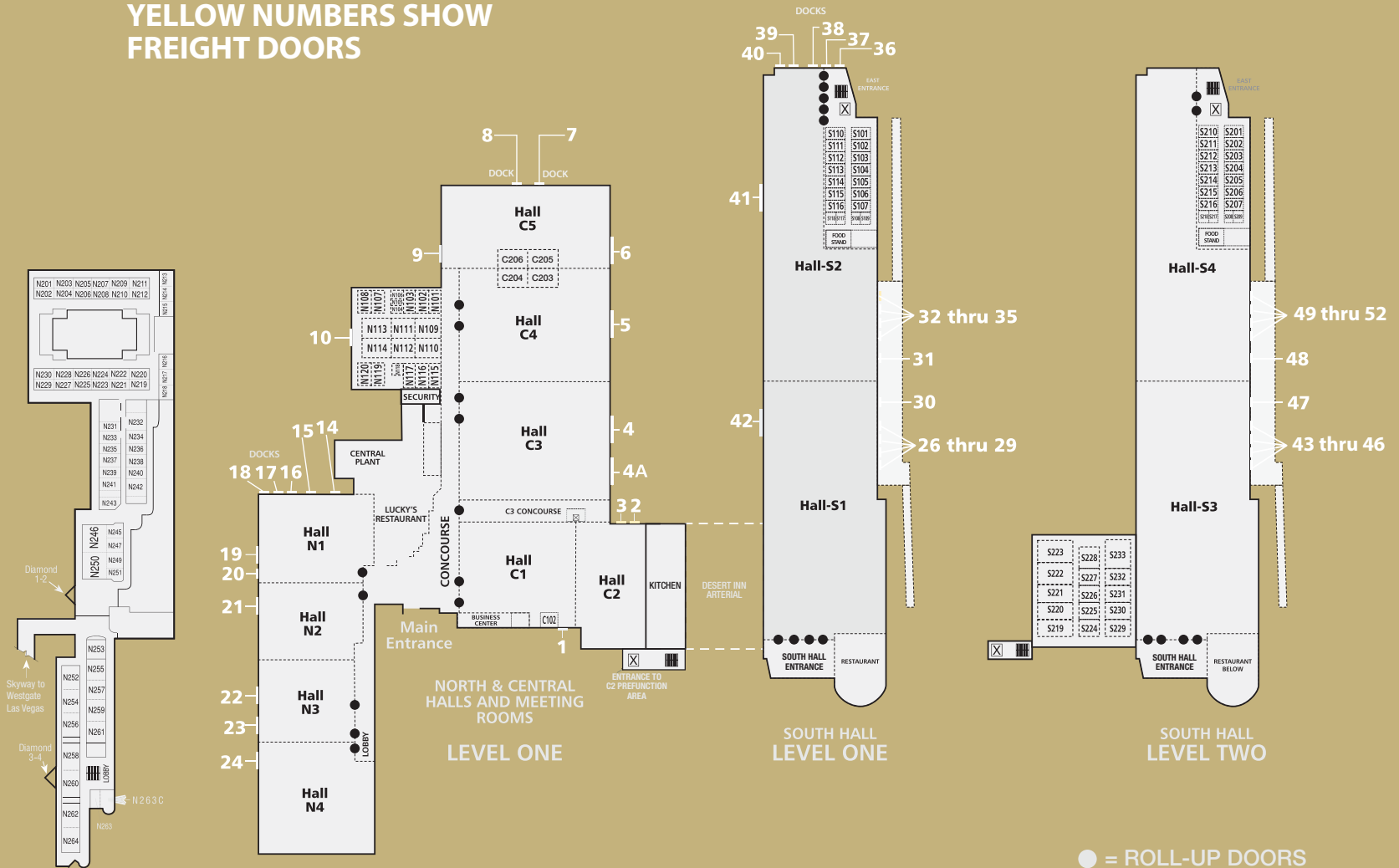

NORTH MEETING ROOMS  
LEVEL TWO

- = ROLL-UP DOORS
- X = ELEVATOR
- ▨ = ESCALATOR

# OVERVIEW OF THE LAS VEGAS CONVENTION CENTER

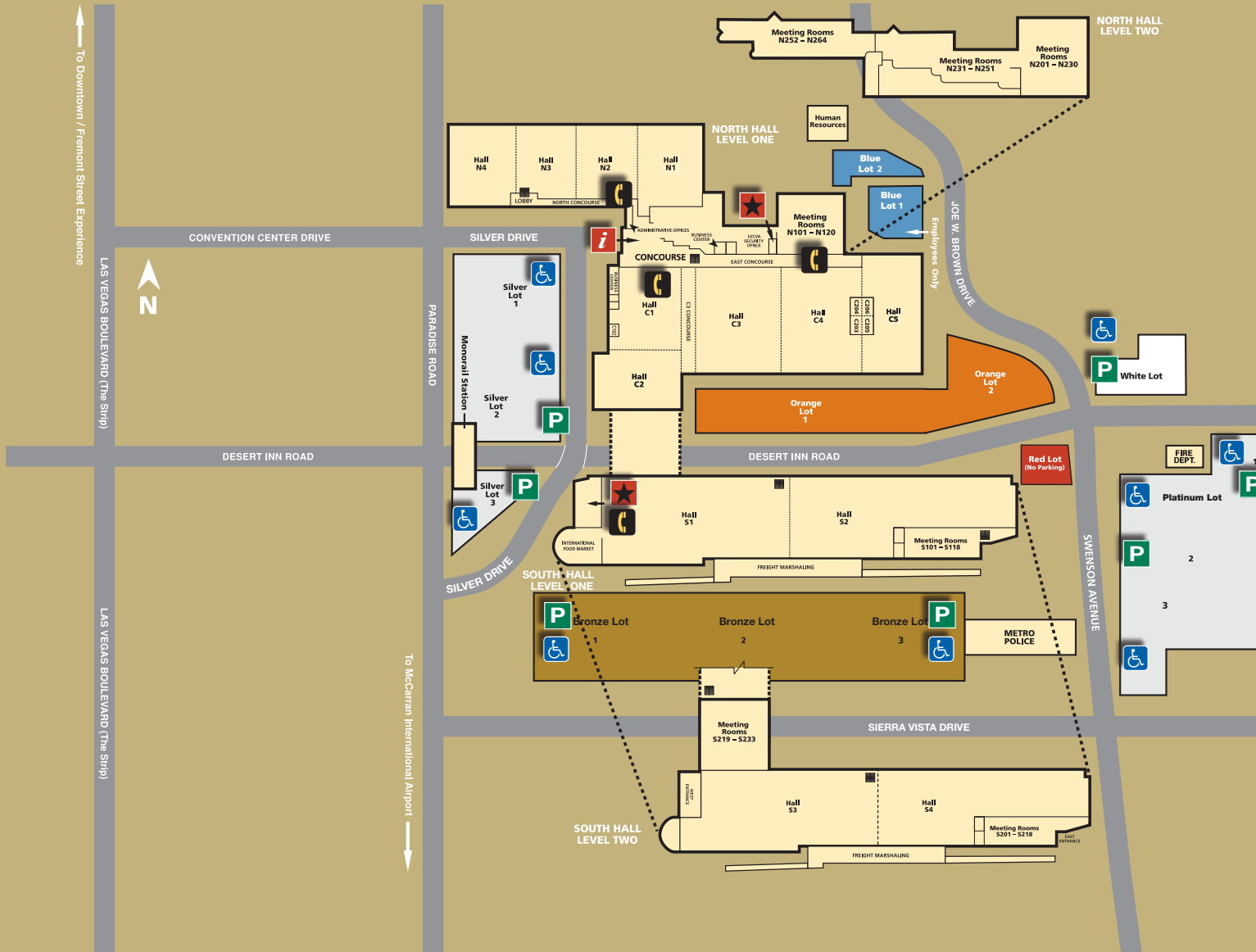

## LEGEND

-  Information Center
-  Accessible Parking
-  Visitor Parking Entrance
-  House Phone
-  Security
-  Exhibit Hall/Meeting Space
-  Silver Lot
-  Orange Lot
-  Blue Lot
-  White Lot
-  Platinum Lot
-  Red Lot
-  Bronze Lot



## LVCC PARKING LOT INFORMATION/ RATES FOR LEASABLE SPACE

| PARKING LOT        | PARKING LOT<br>SQ. FOOTAGE | PARKING LOT ACREAGE<br>(LEASABLE SPACE) | PRICE PER LOT |
|--------------------|----------------------------|---|---------------|
| SILVER LOT 1A      | 104,332                    | 2.4                                     | \$2,750       |
| SILVER LOT 1B      | 75,203                     | 1.73                                    | \$2,210       |
| SUBTOTAL           | 179,535                    | 4.13                                    | \$4,960       |
| SILVER LOT 2A      | 80,511                     | 1.85                                    | \$2,040       |
| SILVER LOT 2B      | 44,041                     | 1.01                                    | \$1,370       |
| SUBTOTAL           | 124,552                    | 2.86                                    | \$3,410       |
| *SILVER 1-2 TOTAL  | 304,087                    | 6.99                                    | \$8,370       |
| SILVER LOT 3       | 91,361                     | 2.1                                     | \$1,830       |
| BRONZE LOT 1A      | 108,404                    | 2.49                                    | \$2,530       |
| BRONZE LOT 1B      | 113,997                    | 2.62                                    | \$2,930       |
| SUBTOTAL           | 222,401                    | 5.11                                    | \$5,460       |
| BRONZE LOT 2A      | 110,107                    | 2.53                                    | \$2,830       |
| BRONZE LOT 2B      | 67,183                     | 1.54                                    | \$1,300       |
| SUBTOTAL           | 177,290                    | 4.07                                    | \$4,130       |
| BRONZE LOT 3       | 129,820                    | 2.98                                    | \$3,520       |
| *BRONZE 1-3 TOTAL  | 529,511                    | 12.16                                   | \$13,110      |
| PLATINUM LOT 1A    | 95,045                     | 2.18                                    | \$2,950       |
| PLATINUM LOT 1B    | 96,068                     | 2.21                                    | \$2,050       |
| SUBTOTAL           | 191,113                    | 4.39                                    | \$5,000       |
| PLATINUM LOT 2A    | 142,351                    | 3.27                                    | \$3,330       |
| PLATINUM LOT 2B    | 58,880                     | 1.35                                    | \$1,320       |
| SUBTOTAL           | 201,231                    | 4.62                                    | \$4,650       |
| PLATINUM LOT 3A    | 163,487                    | 3.75                                    | \$4,790       |
| PLATINUM LOT 3B    | 193,699                    | 4.45                                    | \$3,880       |
| SUBTOTAL           | 357,186                    | 8.2                                     | \$8,670       |
| PLATINUM 1-3 TOTAL | 749,530                    | 17.21                                   | \$18,320      |
| BLUE LOT 1         | 67,478                     | 1.55                                    | \$1,740       |
| BLUE LOT 2         | 44,535                     | 1.02                                    | \$1,100       |
| BLUE 1-2 TOTAL     | 112,013                    | 2.57                                    | \$2,840       |
| ORANGE LOT 1       | 221,603                    | 5.09                                    | \$3,320       |
| ORANGE LOT 2       | 137,409                    | 3.15                                    | \$2,500       |
| ORANGE 1-2 TOTAL   | 226,297                    | 8.24                                    | \$5,820       |
| RED LOT            | 4,664                      | 0.11                                    |               |
| WHITE LOT          | 87,940                     | 2.02                                    | \$1,170       |

\*When lot is leased in its entirety, additional space (shown in red area on maps) is available.

\*Silver Lot - additional space: 19,396 sq. feet, 7 parking spaces

\*Bronze Lot - additional space: 55,917 sq. feet

# PARKING LOT SECTOR BOUNDARY/PRICING – SILVER LOT

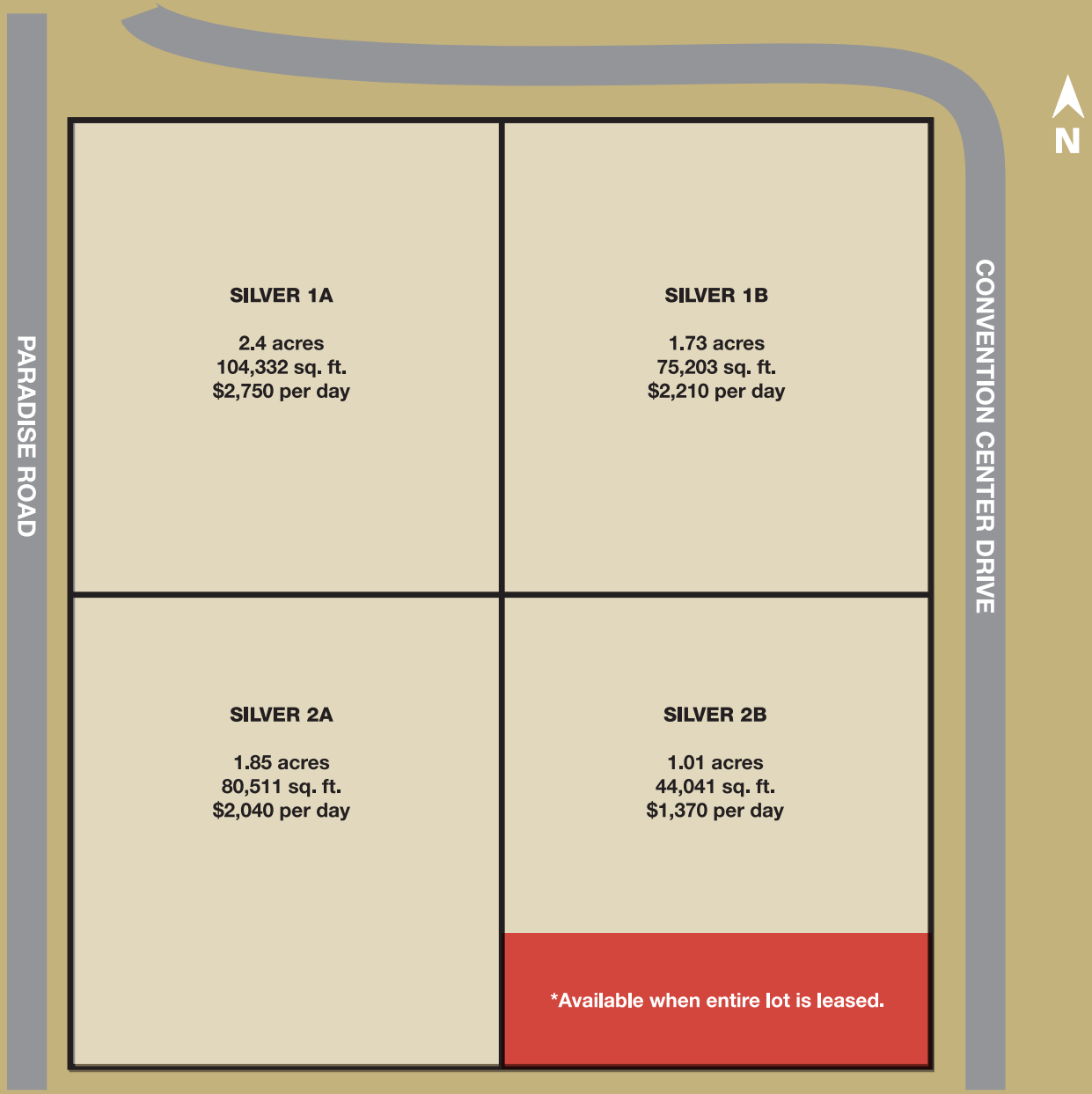

# PARKING LOT SECTOR BOUNDARY/PRICING – BRONZE LOT



CONVENTION CENTER DRIVE

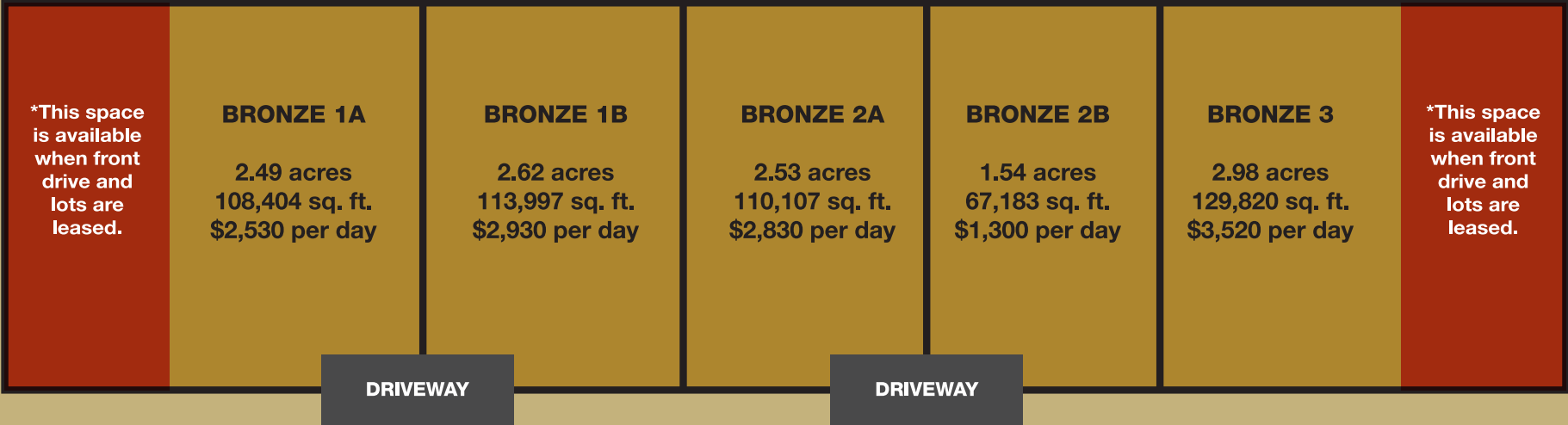

SIERRA VISTA DRIVE



# PARKING LOT SECTOR BOUNDARY/PRICING – PLATINUM LOT

