

Beam Clamps, Jack Chain, S Hooks

Type BC

Beam Clamps

Use:

Clamp on to structure member to provide mounting means for the attachment of conduit hangers-either directly or by means of threaded rod.

Material/Finish:

Stamped Steel/Zinc Plated

Note:

$\frac{1}{4}$ -20 threaded holes.
Jaw opening $\frac{5}{8}$ ".

Trade Size (inches)	Catalog Number	Dimensions in Inches		
		A	B	C
1 $\frac{1}{4}$ x $\frac{5}{16}$ -18	BC-250	0.901	0.44	1.68

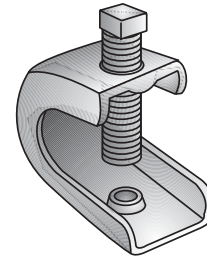
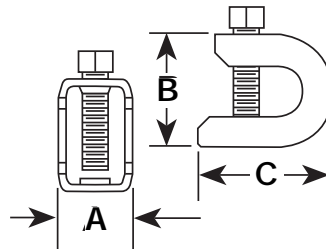

Type BC-250

Type JC

Steel Jack Chain

Use:

For suspending lighting fixtures, etc. standard weight maximum working load: 29#

Material/Finish:

Galvanized Steel

Trade Size (inches)	Catalog Number	
No.12	JC-12-S	100 ft. Spool*

*Order in 100 ft. increments.

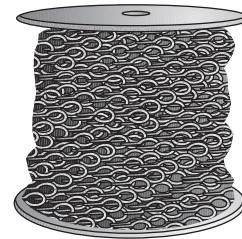

Type JC-12-S

Type SH

Standard and Heavy S Hooks

Use:

For terminating end of jack chain, used to suspend lighting fixtures, etc.

Material/Finish:

Steel/Zinc Plated

Trade Size (inches)	Catalog Number	Dimensions in Inches	
		A	B
.1009 dia	SH-100-D	1.22	0.66
.1429 dia	SH-142	1.52	1.00

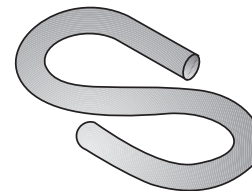
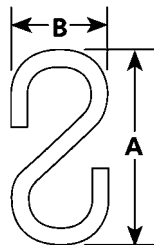

Type SH-100-D