

Milbank Meter Main

U5890–U5895 Series 320 Amp Meter/Breaker Combinations



U5891



U5890

Features

- 320 Amp continuous
- Twin 200A breaker factory installed
- 12 or 24 circuit distribution available
- 4 Terminal with 5th Terminal option
- Patent pending bus assembly
- Rated 22K AIC standard
- Overhead or underground service entrance
- Separate lockable breaker/distribution cover
- Barrel lock provision (optional)
- Wall mount bracket for ease of installation

MILBANK®





U5890

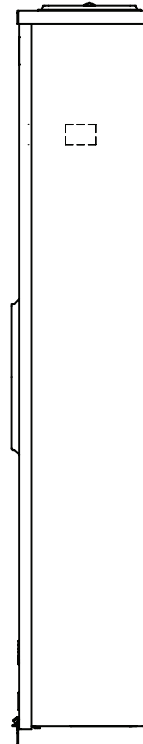
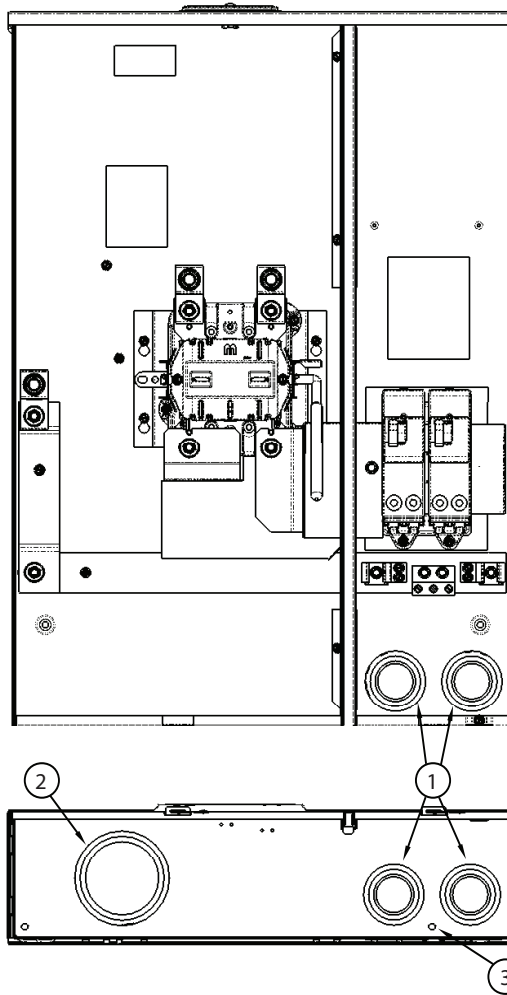

KO CONFIGURATIONS	
1	1,250, 1,500, 2,000, 2,500 CONC.
2	3,000, 3,500, 4,000 CONC.
3	.312 SOLID K.O.

SPECIFICATIONS

- Listed under UL 67 as “suitable only for use as service equipment” – file number E32628 Series 1800 MS.
- 320 amp continuous duty ringless meter socket. Overall ampere rating limited to main circuit breaker rating.
- For use on 120/240 volt single phase applications.
- Short circuit withstand rating 22K AIC as standard. See wiring diagrams on back page for series rating compatibility.
- Type 3R enclosure constructed with G90 galvanized steel.
- Light gray polyester powder coat finish.
- Service entrance overhead or underground. OH has up to 4” hub opening and UG has up to 4” knockout.
- Wire terminations accept copper or aluminum conductors:
Line & Neutral: #6-350 kcmil Ground: #12-1/0
- Plug-on main circuit breaker: 200 Amp type **QN** large frame.
- Lockable breaker/distribution cover.
- 12 or 24 circuit distribution optional.

<u>Catalog Number</u>	<u>Amp</u>	<u>Main</u>	<u>Term</u>	<u>Branch Circuits</u>	<u>Service</u>	<u>Wt (#)</u>
◆ U5890-X-2/150	320	2 - 150	4	N/A	OH/UG	88
◆ U5890-X-2/200	320	2 - 200	4	N/A	OH/UG	88
U5891-X-2/150	320	2 - 150	4	12	OH/UG	103
◆ U5891-X-2/200	320	2 - 200	4	12	OH/UG	103
U5892-X-2/150	320	2 - 150	4	24	OH/UG	107
◆ U5892-X-2/200	320	2 - 200	4	24	OH/UG	107
◆ U5893-X-2/150	320	2 - 150	4	N/A	OH/UG	90
◆ U5893-X-2/200	320	2 - 200	4	N/A	OH/UG	90
U5894-X-2/150	320	2 - 150	4	12	OH/UG	105
◆ U5894-X-2/200	320	2 - 200	4	12	OH/UG	105
U5895-X-2/150	320	2 - 150	4	24	OH/UG	108
◆ U5895-X-2/200	320	2 - 200	4	24	OH/UG	108

AIC RATING: All models are rated 22K AIC.

HUB: OH/UG units supplied with one (1) closing plate packed inside. Order hubs separately from chart below.

FIFTH TERMINAL: For field installable 208Y/120 network service order **K3865**. Installs in the 9 o'clock position.

◆ Stock models

HUB CHART

Conduit size	3"	3 1/2"	4"
Catalog no.	A8110	A8111	A8112



MAIN CIRCUIT BREAKER CHART

Amperage	150	200
10KAIC Breaker Model	QN2150	QN2200
22KAIC Breaker Model	QN2150H	QN2200H

BRANCH CIRCUIT BREAKER CHART

Manufacturer	10K Models	22K Models
Siemens	QP, QPH	QP, QPH, QPHF, QNH
Cutler-Hammer	BR, BRH, HQP, QPHW, QPGF, QPHGF	—
Square D Homeline	Homeline	—
G.E. (50 Amp Max)	THQL, THHQL, THQL-GF, THHQL-GF	—

Utility requirements for this equipment may vary. Always consult the serving utility for their requirements before ordering or installing equipment in this catalog.



K3865
Fifth terminal



1133564 (Main Only)
1133980 (12 Circuit)
1133669 (24 Circuit)
Dead Fronts



OH/UG-1133558
Meter Front



OH/UG-1133561 (Main Only)
OH/UG-1133673 (w/ Distribution)
Front Cover



QN2200H



Q2100H

Circuit breakers

SERIES ECMM
TYPE 3R ENCLOSURE
400 AMP 1Ø 3 WIRE 120/240 VAC
SEE CIRCUIT BREAKER HANDLE FOR MAIN BREAKER RATING.
METER SOCKET RATED 320 AMP CONTINUOUS
SUITABLE ONLY FOR USE AS SERVICE EQUIPMENT
LINE & LINE NEUTRAL TERMINALS ARE STUDS
USE CONNECTORS, FIELD OR FACTORY INSTALLED

MFG.	CAT. #	WIRE RANGE	TORQUE, LB-IN	MILBANK KIT #
CMC	2AB350-3R	TWIN 350 kcmil - 6	275	K1350L (3 CONN. KIT)
	LA-630-R	600 kcmil - 4, (2) 250 kcmil - 1/0	550	K1540L (3 CONN. KIT)

LOAD NEUTRAL TERMINALS: # 6 AWG - 300 kcmil TORQUE TO 250 LB-IN
EQUIPMENT GROUNDING TERMINAL: # 12 AWG - 1/0 AWG CU7AL
TORQUE TO 50 LB-IN
CIRCUIT BREAKER TERMINALS: # 1 AWG - 300 kcmil CU7AL TORQUE TO 250 LB-IN
NOTE: TORQUE STUDS TO 250 LB-IN MAX.
SHIPPING MAY LOOSEN ELECTRICAL CONNECTIONS,
CHECK TIGHTNESS BEFORE ENERGIZING.

--CIRCUIT BREAKERS--
SIEMENS QN (10K RATED) OR QNH (22K RATED)
200A MAX

SHORT CIRCUIT CURRENT RATING OF THIS UNIT IS 22,000 RMS SYMMETRICAL AMPERES AT 120/240 VAC. HOWEVER, THIS RATING IS LIMITED TO THE LOWEST INTERRUPTING CAPACITY OF ANY CIRCUIT BREAKER INSTALLED HEREIN.
WATTHOUR METER NOT INCLUDED IN SHORT CIRCUIT CURRENT RATING.

--WARNING--

FOR SAFETY PURPOSES THE FOLLOWING ACTIONS SHOULD BE TAKEN:

1. INSTALL AND MAINTAIN THIS DEVICE IN ACCORDANCE WITH ESTABLISHED SAFETY PRECAUTIONS AND BUILDING CODE REQUIREMENTS.
2. CONTACT QUALIFIED ELECTRICIAN FOR CHANGES AND/OR MAINTENANCE. DEVICE MUST BE DE-ENERGIZED BEFORE PERFORMING THESE TASKS.
3. TO AVOID DAMAGE AND LOSS OF PROTECTION, DO NOT REPLACE CIRCUIT BREAKERS WITH HIGHER RATED ONES.
4. SEAL DEVICE AND UNUSED OPENINGS TO PREVENT UNAUTHORIZED ACCESS.



MILBANK MFG. CO.
GENERAL OFFICES, K.C. MO

1133782
REV.

MFG.	CAT. #	WIRE RANGE	TORQUE, LB-IN	MILBANK KIT #
CMC	2AB350-3R	TWIN 350 kcmil - 6	275	K1350L (3 CONN. KIT)
	LA-630-R	600 kcmil - 4, (2) 250 kcmil - 1/0	550	K1540L (3 CONN. KIT)

LOAD NEUTRAL TERMINALS: # 6 AWG - 300 kcmil TORQUE TO 250 LB-IN
EQUIPMENT GROUNDING TERMINAL: # 12 AWG - 1/0 AWG CU7AL
TORQUE TO 50 LB-IN
CIRCUIT BREAKER TERMINALS: # 1 AWG - 300 kcmil CU7AL TORQUE TO 250 LB-IN
NOTE: TORQUE STUDS TO 250 LB-IN MAX.

GROUND CONNECTOR		
TERMINAL	WIRE RANGE CU7AL	TORQUE LB.IN.
GROUND (LARGE HOLE)	14-10	35
	8	40
	6-4 3-1/0	45 50
GROUND (SMALL HOLE)	14-10	20
	8	25
	6	35

SHIPPING MAY LOOSEN ELECTRICAL CONNECTIONS,
CHECK TIGHTNESS BEFORE ENERGIZING.

THE LEFT SIDE OF THE DISTRIBUTION PANEL IS LIMITED TO A MAXIMUM
WIRE SIZE OF # 6 AWG FOR FIELD INSTALLED CONDUCTORS.

AIC RATING	LEFT MAIN	RIGHT MAIN	CIRCUIT BREAKERS
10K	SIEMENS QN	SIEMENS QNH	SIEMENS QP, QPH, CUTLER HAMMER BR, BRH, HOP, QPHW, QPGF, QPHGF, SQUARE D HOMELINE, GE (50 AMP. MAX) THQL, THQLH, THQL-GF, THQLH-GF.
22K	SIEMENS QNH	SIEMENS QNRH	SIEMENS TYPE QP, QPH, QPHF, QNH

SHORT CIRCUIT CURRENT RATING OF THIS UNIT IS 22,000 RMS SYMMETRICAL AMPS
AT 240 VOLTS A.C. MAXIMUM IN ACCORDANCE WITH THE TABLE ABOVE.
REPLACEMENT CIRCUIT BREAKERS MUST BE OF THE SAME TYPE AND RATING.
WATTHOUR METER NOT INCLUDED IN SHORT CIRCUIT CURRENT RATING.

--WARNING--

FOR SAFETY PURPOSES THE FOLLOWING ACTIONS SHOULD BE TAKEN:

1. INSTALL AND MAINTAIN THIS DEVICE IN ACCORDANCE WITH ESTABLISHED SAFETY PRECAUTIONS AND BUILDING CODE REQUIREMENTS.
2. CONTACT QUALIFIED ELECTRICIAN FOR CHANGES AND/OR MAINTENANCE. DEVICE MUST BE DE-ENERGIZED BEFORE PERFORMING THESE TASKS.
3. TO AVOID DAMAGE AND LOSS OF PROTECTION, DO NOT REPLACE CIRCUIT BREAKERS WITH HIGHER RATED ONES.
4. SEAL DEVICE AND UNUSED OPENINGS TO PREVENT UNAUTHORIZED ACCESS.



MILBANK MFG. CO.
GENERAL OFFICES, K.C. MO

1133805
REV. A

