

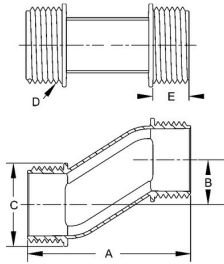

**NIPPLES**

Offset Nipples Die Cast Zinc  
N/A

**B90**



Catalog #: 1458

**APPLICATIONS**

For use when connecting two boxes or panels when the knockouts are not in line.  
N/A

**PRODUCT FEATURES**

Creates a 3/4 inch offset connection.  
Rugged metallic construction provides mechanical protection for the conductors.

**UL LISTED**

Standard 514B, File E195969

**CSA**

C22.2 No. 18

**GENERAL PRODUCT INFORMATION**

Trade Size: 2 in.

**DRAWING DIMENSIONS**

Dimension A: 3-5/32 in.  
Dimension B: 3/4 in.  
Dimension C: 2-9/16 in.  
Dimension D: 2 in. - 11-1/2 NPSM  
Dimension E: 3/4 in.

**PACKAGING**

Package Type: Carton  
Ship Carton Qty.: 6  
Product UPC-A Labeled: No  
Weight (Lbs. Per/C): 56.30  
Ship Carton Length (in.): 7.45  
Ship Carton Width (in.): 5.37  
Ship Carton Height (in.): 5.45  
Ctn Weight (Lbs.): 3.38  
UPC Number: 050169014585  
I2of5: 50050169014580