

## INSTALLATION GUIDE FOR THE CONNECTION OF LIQUIDTIGHT FLEXIBLE METALLIC CONDUIT

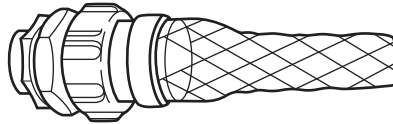

This guide shows the proper installing method of T&B liquidtight connectors with grips. Proper connector and raceway selection plus correct installation techniques will provide the high performance and reliability demanded by specifying engineers. Following are the characteristics and specifications recommended for the selection of high quality connectors.

### EXCLUSIVE FEATURES

- SAFE-EDGE® steel grounding cones with smooth edges protect cable insulation.
- Blue nylon insulated throats protect wires from fraying.
- Wire mesh cable grip provides minimum bending of conduit and additional mechanical protection in high abuse installations.
- Double bevel nylon sealing rings means easier installation.
- Buna-N one piece sealing ring provides longlasting liquidtight protection.

TYPES	STRAIGHT	45°	90°	ADAPTOR	CHASE® CONNECTOR	90° CHASE® CONNECTOR
CATALOG NUMBER	5331 Series 3/8" thru 4"	5341 Series 3/8" thru 4"	5351 Series 3/8" thru 4"	5271 Series 3/8" thru 4"	5361 Series 3/8" thru 4"	5371 Series 3/8" thru 1"

### SPECIFICATIONS T&B LIQUIDTIGHT CONNECTORS

- UL listed as grounding means per 2008 N.E.C. article 350.
- C.S.A. certified, dust tight and watertight.
- Meets J.I.C. requirements
- Suitable for use in hazardous locations:  
Class I-Div. 2; Class II-Div. 1 & 2; Class III-Div. 1 & 2.  
Per N.E.C. article 500.
- Taper threads per H28/7A, federal standards
- Meets federal specification WF 406B.
- T&B laboratory tested to exceed all required specifications. Also exceeds T&B quality control test specs (oscillation, drop, heat, vibration, pressure, and corrosion tests)

**WARRANTY:** Thomas & Betts sells this product with the understanding that the user will perform all necessary tests to determine the suitability of this product for the user's intended application. Thomas & Betts warrants that this product will be free from defects in materials and workmanship for a period of two (2) years following the date of purchase. Upon prompt notification of any warranted defect, Thomas & Betts will, at its option, repair or replace the defective product or refund the purchase price. Proof of purchase is required. Misuse or unauthorized modification of the product voids all warranties.

**Limitations and Exclusions:** THE ABOVE WARRANTY IS THE SOLE WARRANTY CONCERNING THIS PRODUCT, AND IS IN LIEU OF ALL OTHER WARRANTIES EXPRESS OR IMPLIED, INCLUDING BUT NOT LIMITED TO ANY IMPLIED WARRANTY OF MERCHANTABILITY OR FITNESS FOR A PARTICULAR PURPOSE, WHICH ARE SPECIFICALLY DISCLAIMED. LIABILITY FOR BREACH OF THE ABOVE WARRANTY IS LIMITED TO COST OF REPAIR OR REPLACEMENT OF THE PRODUCT, AND UNDER NO CIRCUMSTANCES WILL THOMAS & BETTS BE LIABLE FOR ANY INDIRECT, SPECIAL, INCIDENTAL OR CONSEQUENTIAL DAMAGES.

# INSTALLATION INSTRUCTIONS

1. Cut the flexible conduit with a clean, square end cut.

## NOTES:

- Use metal liquid tight conduit (available from conduit manufacturers).
- Use 32 Tooth/In set, sharp hacksaw
- For high production use 24-32 Tooth/In. wavy set, power band saw, not more than 400/sfpm (surface feet per minute).

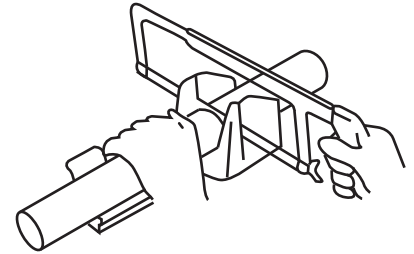

**CAUTION**  
**DO NOT USE ABRASIVE WHEEL**

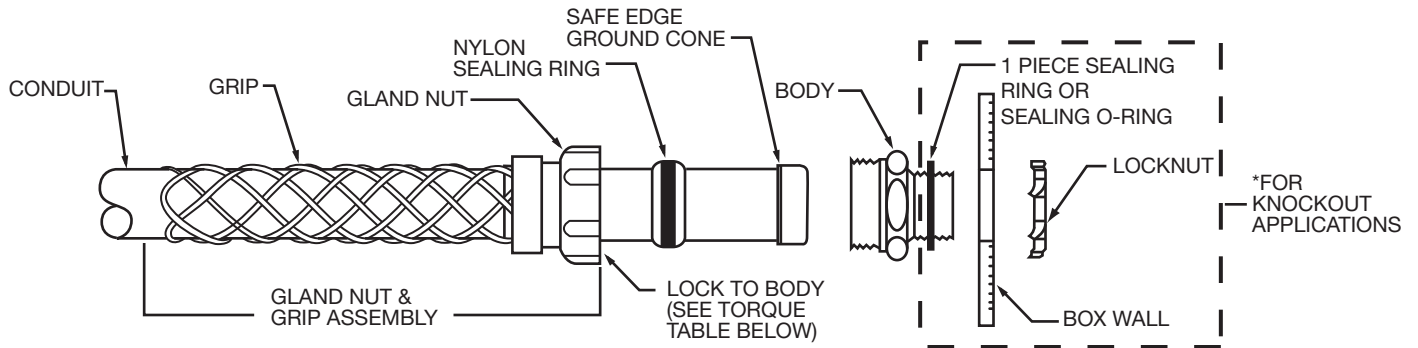

\* For knockout applications use T&B 140 Series locknuts and 5262 Series sealing o-rings (Purchase sealing ring separately)

- Slide grip with gland-nut onto conduit.\*\*
- Slide sealing ring onto conduit.
- Screw ground cone into conduit tightly.
- Push sealing ring towards ground cone and seat into ground cone flange.
- Insert ground cone into body.
- Push end of grip along conduit toward body and screw gland nut onto body (see torque table). After tightening gland nut to torque, check if grip is laying flat and fully extended out along conduit.

## "SPACE SAVER" CHASE® CONNECTOR ASSEMBLIES

OUTSIDE OF KNOCKOUT 3 STYLE CHASE® CONNECTOR BODIES

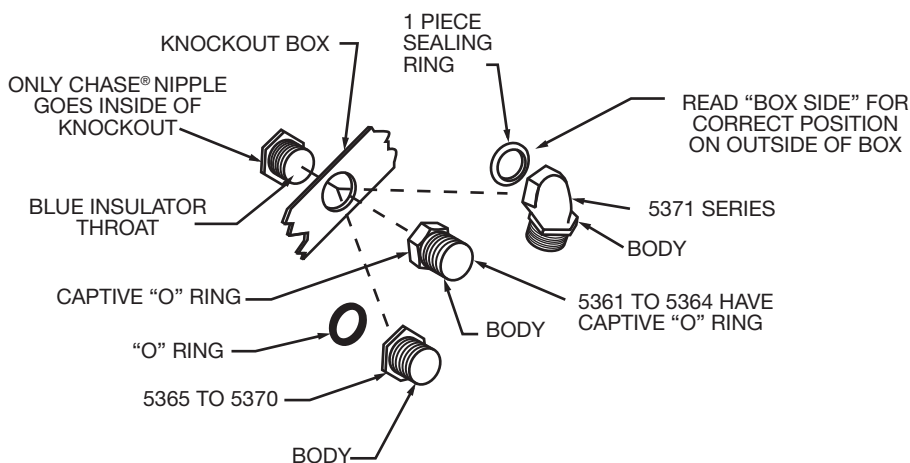

Lock-up Can Be Made By Tightening Chase® Nipple To Body Or By Turning Body Onto Chase® Nipple

TRADE SIZE OF FITTING	TIGHTENING TORQUE IN POUND-INCHES
3/8"	200
1/2"	300
3/4"	500
1"	700
1-1/4"	1000
1-1/2"	1200
2"	1600
2-1/2"	1600
3"	1600
3-1/2"	1600
4"	1600

PER UL - 514B

\*\*INSTALLATION at maximum CORD DIAMETER may be facilitated by slightly preforming endless weave mesh.

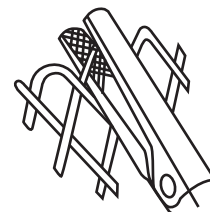

Using flat nose pliers carefully form loop round. Repeat for all loops.

Thomas & Betts Corporation  
Memphis, Tennessee  
www.tnb.com