

Marine Products

PADS: WITH EAR WELDMENT ONLY

(Designed for Pin to Pivot 180 Degrees)

Size	Pad Size	P/N
3/4"	3" Diameter 3 Hole	PEW75
1"	3-1/2" Diameter 4 Hole	PEW1
1-1/4"	4" Diameter 4 Hole	PEW2
1-1/2"	4" Diameter 4 Hole	PEW2



Size	Washers	P/N
3/4"	Yes	PEWA75W
1"	No	PEWA1
1"	Yes	PEWA1W
1-1/4"	No	PEWA125
1-1/4"	Yes	PEWA125W
1-1/2"	No	PEWA150
1-1/2"	Yes	PEWA150W

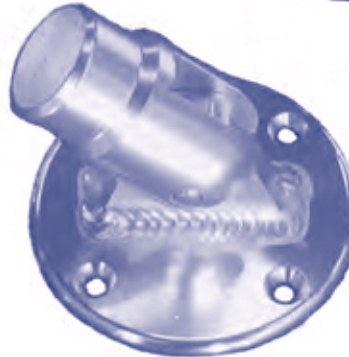

Assembly includes pad with ear, female pin, screw & nylon.

EAR: MOUNTING

Size	Ref	P/N
3/4"	(1)	EM75
1"	(2)	EM1
1-1/4"	(3)	EM2
1-1/2"	(3)	EM2

When mounting, ear is used with T&C's standard female pin. The pin can pivot approximately 180° from side to side.

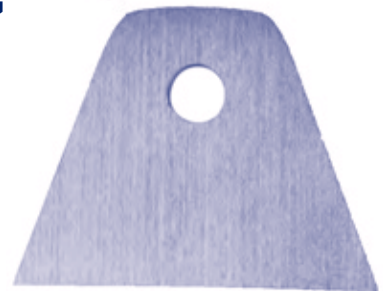

- (1) Ear size 3/4", 2"W x 1-1/2"H x 1/4" Thick; 1/4" hole.
- (2) Ear size 1", 2-1/4"W x 1-3/4"H x 3/8" Thick; 5/16" hole.
- (3) Ear Size 1-1/4", 1-1/2", 2-1/2"W x 2"H x 1/2" Thick; 3/8" hole.

Please check with your local T&C Metals Branch for updates, as specifications, materials availability, prices and terms of purchase may change without notice.

www.tc-alum.com

T&C Metals
Wholesale Metal Products
A Division of ABC Supply Co., Inc.

Marine Products

HINGE BLOCK ASSEMBLY WITH WASHERS

- The hinge block assembly is the ideal way to attach a retractable foot rest bar to the perfect leaning post.
- Design allows bolting to the down legs.
- Bolted arrangement allows your customer to remove the leg rest or change the location.
- Can be used on opposite side of the leaning post allowing for easy fish cooler removal
- Hinge block assembly fits 1-1/4" and 1-1/2" NOM pipe
- Standard usage requires (1) LH and (1) RH.
- Assembly includes: Hinge block, (2) nylon washers, male pin (1 nom) and socket hardware screw.



Pipe Mount Style

PIPE MOUNT STYLES

Location	P/N
Right Side	HBA125RH
Left Side	HBA125LH



Flat Surface Mount Style

FLAT SURFACE MOUNT STYLES

Location	P/N
Right Side	HBAFL125RH
Left Side	HBAFL125LH

- Typical usage is when a flat surface exists.

FOOT REST ASSEMBLY

Typical usage: Foot rest on leaning post and ice cooler restraints; fits 1" Nom pipe.

P/N
FPH102
TT400FRA10

- (1) Includes two nylon washers, which eliminates aluminum to aluminum galling.
- (2) Can be used where the leaning post legs are more vertical or leaning aft. 10° incline with washers to prevent galling.

Assembly includes: Female pin (1 nom), pivot mount, SST screw and 2 nylon washers.

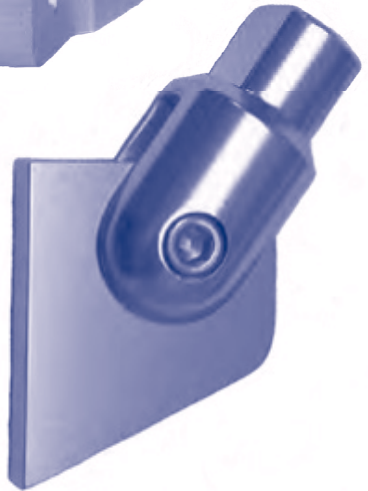
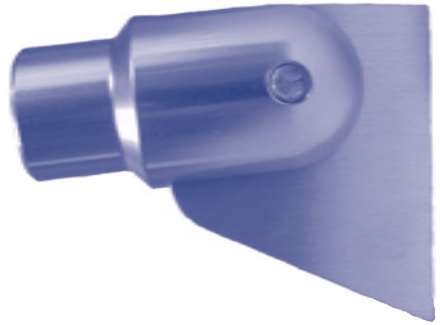

ANGLE MOUNTS

P/N
FRA100RH
FRA100LH

- Includes washers.
- Can easily be welded in place by a simple modification to the angle bracket.

Typical usage: Leaning posts, consoles & rear seating bracket.

Usage requires: 1 LH and 1 RH.

OVAL MOUNTS

Description	P/N
Fits ovals 1-1/2" - 1-7/8"	FPH102OVAL

- Includes washers.

Please check with your local T&C Metals Branch for updates, as specifications, materials availability, prices and terms of purchase may change without notice.

www.tc-alum.com