

Aluminum

Square Tube/Mill Finish

6063-T52, QQ-A-200/9

Part#	Description			Length	Approx. Wt./Ft.
	A"	x	B"		
6629024	5/8"	x	.062"	24'	.131#
6620024	1/2"	x	.063"	24'	.131#
6625024	3/4"	x	.050"	24'	.161#
6628024	3/4"	x	.063"	24'	.206#
6631924	3/4"	x	.090"	24'	.293#
6632024	3/4"	x	.125"	24'	.374#
6638024	1"	x	.062"	24'	.278#
6642024	1"	x	.090"	24'	.405#
6644024	1"	x	.125"	24'	.524#
6648024	1-1/4"	x	.062"	24'	.353#
6650024	1-1/4"	x	.093"	24'	.516#
6654024	1-1/4"	x	.125"	24'	.675#
6656024	1-1/2"	x	.062"	24'	.430#
6658024	1-1/2"	x	.093"	24'	.632#
6660024	1-1/2"	x	.125"	24'	.824#
6664024	1-3/4"	x	.125"	24'	.975#
6666024	2"	x	.065"	24'	.605#
6672024	2"	x	.093"	24'	.851#
6672026	2"	x	.093"	26'	.851#
6674024	2"	x	.125"	24'	1.126#
6676024	2"	x	.190"	24'	1.627#
6678024	2"	x	.250"	24'	2.100#
6682024	2-1/2"	x	.125"	24'	1.425#
6684024	3"	x	.093"	24'	1.298#
6686024	3"	x	.125"	24'	1.760#
6690024	4"	x	.125"	24'	2.324#
6694024	5"	x	.125"	24'	2.925#
6696024	6"	x	.125"	24'	3.525#
6698024	8"	x	.190"	24'	7.050#

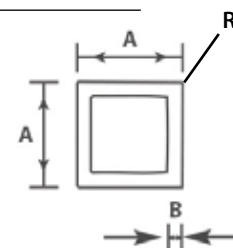

Square Tube

6061-T6, QQ-A-200/9

Part#	Description			Length	R	Approx. Wt./Ft.
	A"	x	B"			
6569024	1"	x	.125"	24'		.524#
6570024	1-1/2"	x	.125"	24'		.824#
6668024	1-1/2"	x	.188"	24'		
6572024	2"	x	.093"	24'		.851#
6572026	2"	x	.093"	26'		.851#
6576024	2"	x	.125"	24'		1.126#
6578024	2"	x	.188"	24'		1.627#
6576022	2"	x	.125"	22' 6"		
6580024	2"	x	.250"	24'		2.100#
LI85767	2"	x	.250"	24'	.250	2.052#
6586024	3"	x	.250"	24'		3.300#
6584018	3"	x	.250"	18'	.313	3.204#
LI85756	3"	x	.375"	20'		4.725#
6588024	4"	x	.250"	24'		4.500#
6589024	4"	x	.125"	24'		
6592024	6"	x	.250"	24'		6.900#

Radius Square Tube – Mill Finish

6063-T52, QQ-A-200/9

Part#	Description			R	Length	Approx. Wt./Ft.
	A"	x	B"			
LI86879 (special order)	3/4"	x	.040"	.093	24'	.145#
6624024	3/4"	x	.045"	.093	24'	.150#
6630024	3/4"	x	.062"	.125	24'	.206#
6631024	3/4"	x	.093"	.090	24'	.293#
6636024	1"	x	.040"	.093	24'	.182#
6640024	1"	x	.062"	.062	24'	.278#
6641024	1"	x	.062"	.125	24'	.278#
6643024	1"	x	.090"	.125	24'	.392#
6646024	1"	x	.125"	.125	24'	.526#
6652024	1-1/4"	x	.093"	.157	24'	.516#
LI85697	1-1/4"	x	.100"	.250	24'	.511#
LI85782	1-1/2"	x	.063"	.093	24'	.430#
6657024	1-1/2"	x	.093"	.187	24'	.582#
LI85720	1-1/2"	x	.125"	.125	24'	.809#
LI85778	2"	x	.063"	.140	24'	.604#
LI85794	2"	x	.093"	.250	24'	.851#
6675124	2"	x	.125"	.125	24'	1.126#
6674124	2"	x	.125"	.250	24'	1.109#
LI85779	2"	x	.188"	.400	24'	1.700#
6710025	3"	x	.188"	.188	25'	2.502#

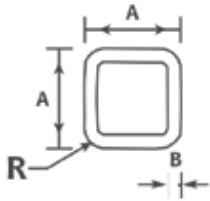

Radius Square Tube–Mill Finish

6061-T6, QQ-A-200/9

Part#	Description			R	Length	Approx. Wt./Ft.
	A"	x	B"			
LI85767	2"	x	.250"	.250"	24'	2.100#
LI86993	2-1/2"	x	.250"	.031"	24'	2.680#
6583020	3"	x	.188"	.188"	20'	2.487#
6584018	3"	x	.250"	.313"	18'	3.204#
6689025	3"	x	.250"	.313"	25'	3.204#

Aluminum

Rectangular Tube – Mill Finish

6063-T52, QQ-A-200/9 — 24' in Length

Part#	Description				Approx. c	Length	Wt./Ft.
	A"	x	B"	x			
6730024	1/2"	x	1"	x	.093"	24'	.293#
6732024	3/4"	x	1-1/2"	x	.125"	24'	.600#
6736024	1"	x	1-1/2"	x	.125"	24'	.676#
LI85856	1"	x	2"	x	.062"(.140R)	24'	.437#
6738024	1"	x	2"	x	.062"	24'	.428#
6740024	1"	x	2"	x	.093"	24'	.628#
6739024	1"	x	2"	x	.093"(.125R)	24'	.613#
LI85861	1"	x	2"	x	.100"(.062R)	24'	.672#
6742024	1"	x	2"	x	.125"	24'	.824#
6742030	1"	x	2"	x	.125"	30'	.824#
6751024	1"	x	6"	x	.125"	24'	2.100#
LI85867	1"	x	2"	x	.125"(.125R)	24'	.817#
6746024	1"	x	3"	x	.125"	24'	1.125#
6748024	1"	x	4"	x	.125"	24'	1.425#
6750024	1-1/4"	x	2-1/2"	x	.125"	24'	1.050#
6752024	1-1/2"	x	2"	x	.125"	24'	.976#
LI85876	1-1/2"	x	2"	x	.125"(.125R)	24'	.976#
6754024	1-1/2"	x	3"	x	.125"	24'	1.272#
6760024	1-3/4"	x	3"	x	.125"	24'	1.350#
6768024	2"	x	3"	x	.125"	24'	1.426#
6772024	2"	x	4"	x	.125"	24'	1.724#
LI85921	2"	x	4"	x	.250"	24'	3.300#
6778024	2"	x	5"	x	.125"	24'	2.025#
6780024	2"	x	6"	x	.125"	24'	2.327#
6782024	2"	x	8"	x	.125"	24'	2.962#
6781024	2"	x	10"	x	.190"	24'	5.244#
6783024	3"	x	4"	x	.125"	24'	2.074#
6796025	6"	x	8"	x	.190"(.125R)	25'	6.196#
6796030	6"	x	8"	x	.190"(.125R)	30'	6.196#

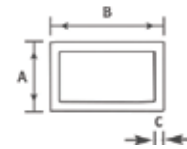

Rectangular Tube – Mill Finish

6061-T6

Part#	Description				Approx. c	Length	Wt./Ft.
	A"	x	B"	x			
LI85864	1"	x	2"	x	.125 (.125R)	25'	.817#
6770024	2"	x	3"	x	.250	24'	2.700#
6770124	2"	x	3"	x	.250 (.250R)	24'	2.700#
6774024	2"	x	4"	x	.250	24'	3.300#
6774124	2"	x	4"	x	.250 (.375R)	24'	3.300#
6785724	2"	x	10"	x	.125	24'	3.530#
6773024	2"	x	4"	x	.125	24'	1.724#
LI85931	2"	x	5"	x	.250	24'	3.900#
6781124	2"	x	6"	x	.250	24'	4.500#
6777030	3"	x	6"	x	.125	30'	2.626#
6775024	3"	x	4"	x	.250	24'	3.900#
6795028	4"	x	6"	x	.188	28'	5.700#
6788028	4"	x	6"	x	.250	28'	5.700#
6790028	4"	x	8"	x	.250	28'	6.900#
6792024	4"	x	10"	x	.250	24'	8.100#
6751024	1"	x	6"	x	.125	24'	2.03#

Many custom lengths available

Round Tube – Mill Finish

6063-T52, Round Tube

Part#	Description			I.D.	Length	Approx. Wt./Ft.
	A"	x	B"			
6800024	3/4"	x	.065"	.620	24'	.172#
LI85328	1"	x	.062"	.876	20'	.229#
6804024	1"	x	.062"	.876	24'	.229#
6806020	1"	x	.125"	.750	20'	.404#
6806024	1"	x	.125"	.750	24'	.404#
6813024	1-1/4"	x	.062"	1.126	24'	.278#
6810016	1-1/8"	x	.049"	1.152	16'	.195#
LI85333	1-1/4"	x	.090"	1.070	24'	.385#
LI85507	1-1/4"	x	.125"	1.000	20'	.520#
6812024	1-1/2"	x	.065"	1.370	24'	.351#
6814024	1-1/2"	x	.093"	1.320	24'	.493#
LI85345	1-1/2"	x	.125"	1.250	20'	.635#
6815024	1-1/2"	x	.125"	1.250	24'	.635#
6818024	2"	x	.125"	1.750	24'	.866#
6816224	2"	x	.065"	1.870	24'	.474#
LI85365	2"	x	.125"	1.750	20'	.866#
6819024	3"	x	.083"	2.834	24'	.895#
6820024	3"	x	.125"	2.750	24'	1.355#
6821024	4"	x	.125"	3.750	24'	1.790#

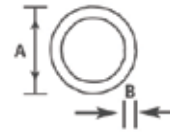

Round Tube – Mill Finish

6061-T6, QQ-A-200/9

Part#	Description			I.D.	Length	Approx. Wt./Ft.
	A"	x	B"			
6827024	1-1/2"	x	.125"	1.250	24'	.635#
LI85356	1-3/4"	x	.125"		24'	
6829012	2"	x	.125"	1.750	12'	.866#
6829024	2"	x	.125"	1.750	24'	.866#
6830013	2-1/2"	x	.125"	2.250	12' 6"	1.097#
6830015	2-1/2"	x	.125"	2.250	15'	1.097#
6831014	3"	x	.125"	2.750	13' 6"	1.355#
6831015	3"	x	.125"	2.750	15'	1.355#
6831024	3"	x	.125"	2.750	24'	1.355#
6841034	3"	x	.250"	2.50	24'	2.54#
6840015	3-1/2"	x	.187"	3.126	15'	2.300#
6840020	3-1/2"	x	.187"	3.126	20'	2.300#
6833024	4"	x	.125"	3.750	24'	1.790#
6844020	4"	x	.188"	3.624	20'	2.647#
6845020	4"	x	.250"	3.500	20'	3.464#
6846020	4-1/2"	x	.250"	4.000	20'	3.925#
6823024	5"	x	.125"	4.750	24'	
6848020	6"	x	.250"	5.500	20'	5.311#
6848024	6"	x	.250"	5.550	24'	5.311#