



ACCURATE

LOCK & HARDWARE

AMERICAN CRAFTED SINCE 1972

1912 Urban Deadbolt

INTERIOR DECORATIVE RIM LOCK



1912 URBAN DEADBOLT

AN AESTHETIC ALTERNATIVE

This decorative, high security auxiliary deadbolt is available in all standard finishes and easily customizable. An easy retrofit for traditional interior rim locks, it provides a modern upgrade for metropolitan doors requiring an additional layer of security.

INTERIOR DECORATIVE RIM LOCK

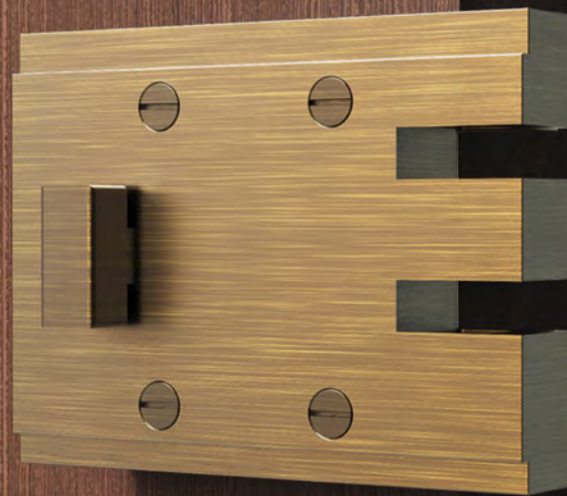

1912 URBAN DEADBOLT

EASY RETROFIT

- Four screws needed to simply replace a traditional rim lock (e.g. Segal lock)

STATEMENT ACCESSORY

- This design improves upon the aesthetics of traditional rim locks to make it a decorative accessory
- Available in a variety of finishes
- Customizable upon request

ADDITIONAL SECURITY

- Popular in metropolitan environments, this auxiliary deadbolt provides an additional layer of security

1912 Urban Deadbolt Dimensions

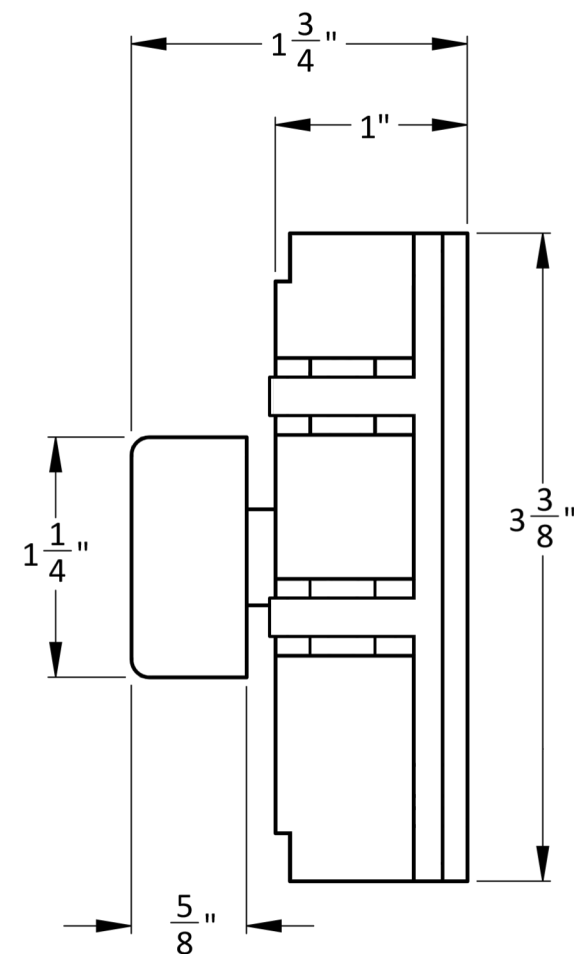
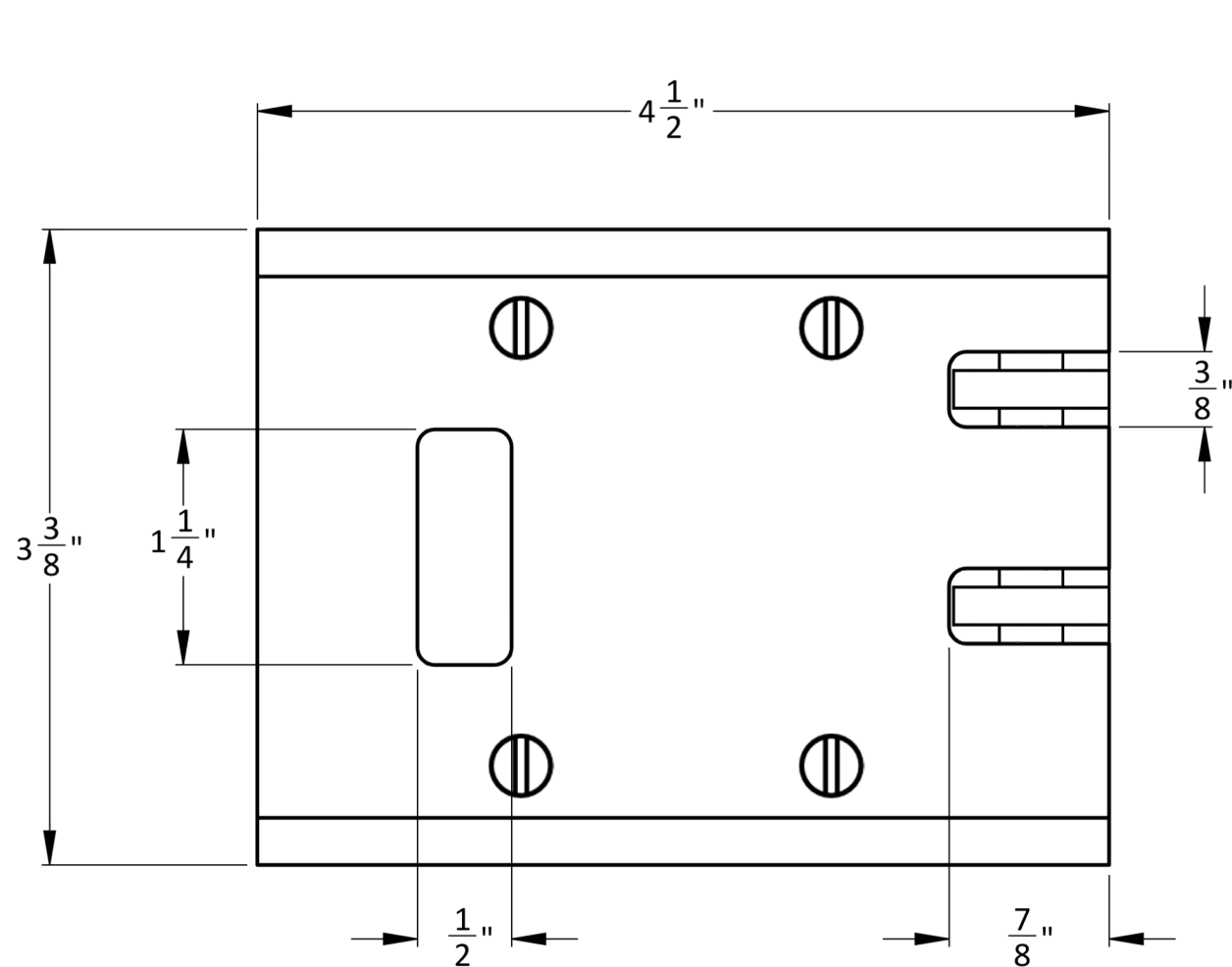

1912 URBAN DEADBOLT

1912 Urban Deadbolt Components

Mounting Screws



Deadbolt



Strike

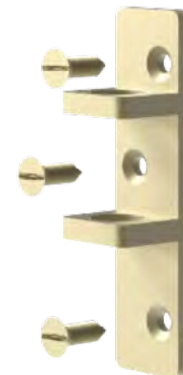

Mounting Plate



*Collar



*Rim Cylinder



*Collar and Rim Cylinder supplied by Accurate when ordered.

1912 Urban Deadbolt Door Handing

LH INSIDE



LH DOOR SWING:

From inside, lock installed on **left** side of the door per illustration.

Use **LH** template plate to mark for holes on door and frame.

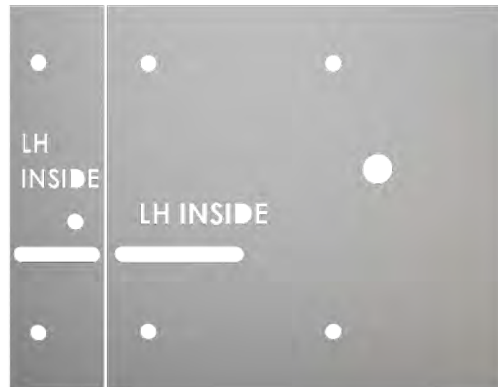

RH INSIDE



RH DOOR SWING:

From inside, lock installed on **right** side of the door per illustration.

Use **RH** template plate to mark for holes on door and frame.



HOW TO SPECIFY

1912.**FINISH**.HAND.DOORTHICKNESS

EXAMPLES

Urban Deadbolt | Satin Chrome

E.g.: 1912.**US26D**.RH.134

Urban Deadbolt | Burnished Brass

E.g.: 1912.**BB**.LH.134

Urban Deadbolt | Duronotic

E.g.: 1912.**DURO**.LH.134

FINISHES

GROUP 1: US4, US4NL, US26D

GROUP 2: US3, US3NL, US26, US10B, US14, US15, US19

GROUP 3: BN, BB, TN, TB, DURO, ESN, US15A, US5

*Other finishes may be available as a special order, please call for assistance.

To view example of finishes visit: [Accurate Finishes](#).

Rim cylinder required, not included.
Please specify separately.

ACCURATE LOCK & HARDWARE MANUFACTURERS OF LOCKS AND CUSTOM ARCHITECTURAL HARDWARE

1 Annie Place | Stamford, CT 06902

P: 203.348.8865

F: 203.348.5234

E: sales@accuratelockandhardware.com

www.accuratelockandhardware.com



AMERICAN CRAFT
— SINCE 1972 —