



ACCURATE LOCK & HARDWARE

AMERICAN CRAFTED SINCE 1972

7200SEC High Security Deadlock

FOR AN ADDITIONAL LAYER OF SECURITY

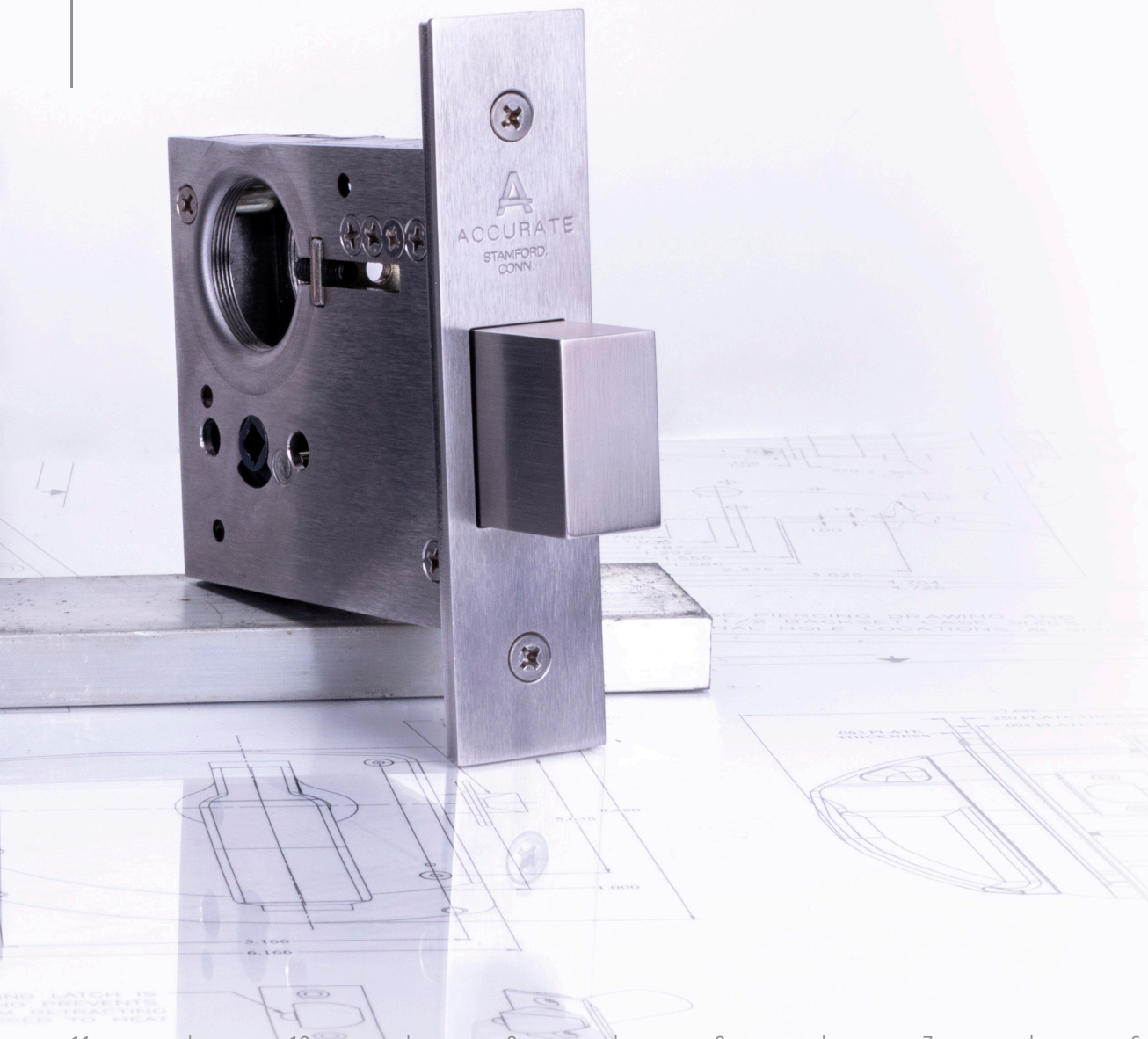

7200SEC High Security Deadlock

ADDITIONAL PROTECTION

This auxiliary deadbolt features the same heavy-duty bolt with absorption technology as the High Security Mortise Lock. It is commonly used above a standard latch or entry lock wherever security and durability is paramount. The 7200SEC is an ideal solution for commercial and residential applications, as well as behavioral environments that may require an extra layer of security.

7200SEC DEADLOCK

7200SEC Technical Details

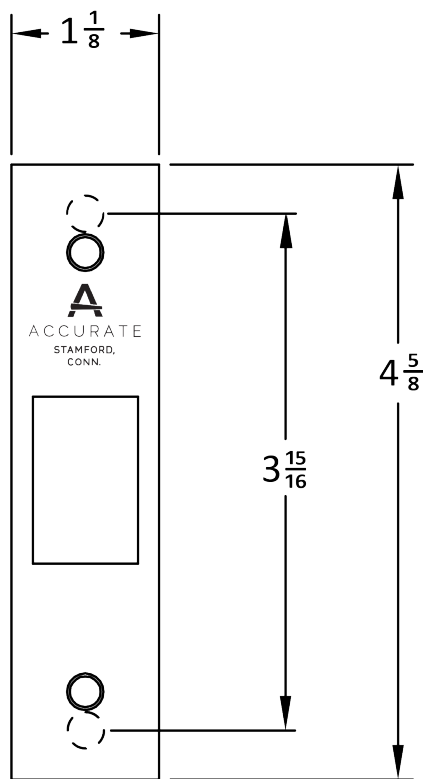
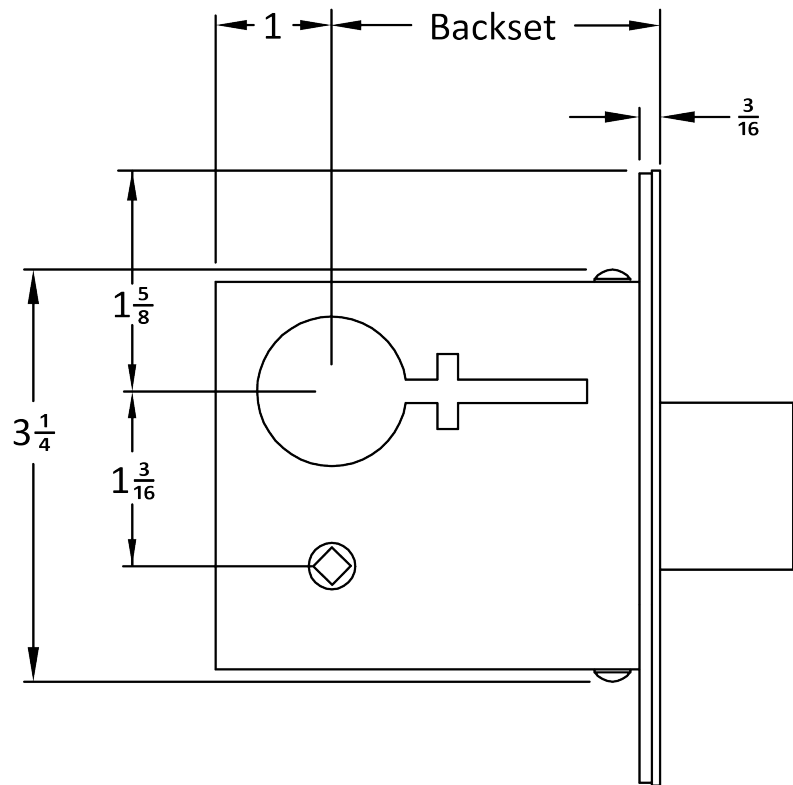

UL Listed 3 Hour (Mechanics R13846/R27504)

Withstands 300x more abuse than the Grade 1 Requirement.

BACKSETS: $2\frac{1}{2}$ " or $2\frac{3}{4}$ " For door stiles $3\frac{7}{8}$ " and up.

CASE: Heavy gauge steel

DEADBOLT: 1" throw

THUMB TURN HUB: $\frac{3}{16}$ " (5mm) on the diamond

ARMOR FRONT: Brass, bronze, or stainless steel

STRIKE: $3\frac{1}{2}$ " or $1\frac{1}{8}$ "

DUST BOX: Brass, stainless steel or US10B

7200SEC Functions

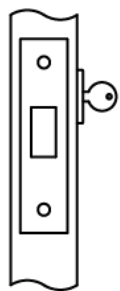

7201SEC

Cylinder outside only.

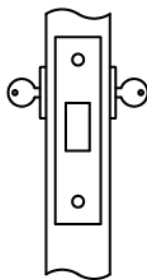

7202SEC

Double Cylinder.

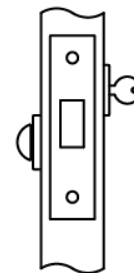

7203SEC

Cylinder outside, thumb turn inside.

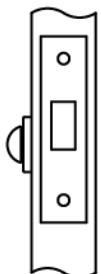

7204SEC

Inside thumb turn only.

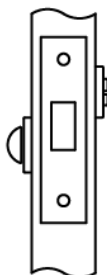

7205SEC

Thumb turn inside, emergency key outside.

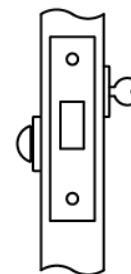

7203ST-SEC CLASSROOM DEADLOCK

Key outside will project/retract deadbolt.

Thumb turn inside can retract but not throw deadbolt.

HOW TO SPECIFY

FUNCTION.BACKSET.FINISH

EXAMPLES

7200SEC | Single Cylinder | Oil Rubbed Bronze

E.g.: 7201SEC.212.US10B

7200SEC | Double Cylinder | Burnished Nickel

E.g.: 7202SEC.212.US10B

7200SEC | Classroom Deadlock | Satin Chrome

E.g.: 7203ST-SEC.243.US26D

Cylinder not included.

FINISHES

GROUP 1: US4, US4NL, US26D

GROUP 2: US3, US3NL, US26, US10B, US14, US15, US19

GROUP 3: BN, BB, TN, TB, DURO, ESN, US15A, US5

*Other finishes may be available as a special order, please call for assistance.

To view example of finishes visit: [Accurate Finishes](#).

**ACCURATE LOCK & HARDWARE
MANUFACTURERS OF LOCKS AND
CUSTOM ARCHITECTURAL HARDWARE**

1 Annie Place | Stamford, CT 06902

P: 203.348.8865

F: 203.348.5234

E: sales@accuratelockandhardware.com

www.accuratelockandhardware.com



AMERICAN CRAFTSMAN
— SINCE 1972 —