

8700FR | 8800FR SERIES

Field Reversible Latch

STEPS TO REVERSE LATCH

PART A:

- Remove decorative face plate.
- Using a slotted screwdriver, get access to pin and push left* to project latch.

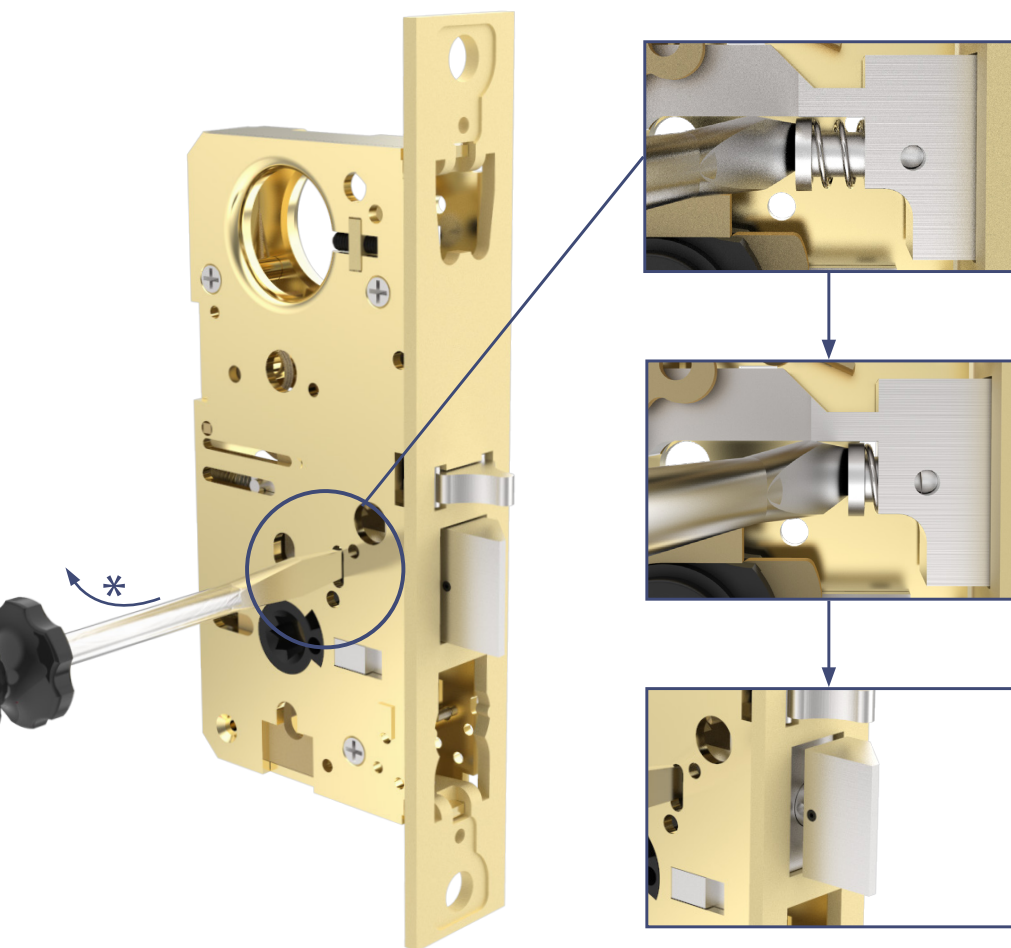

PART B:

- While holding the projection with one hand, rotate latch with free hand.
- Make sure the latch clicks* into place.
- Adjust face plate bevel as required.

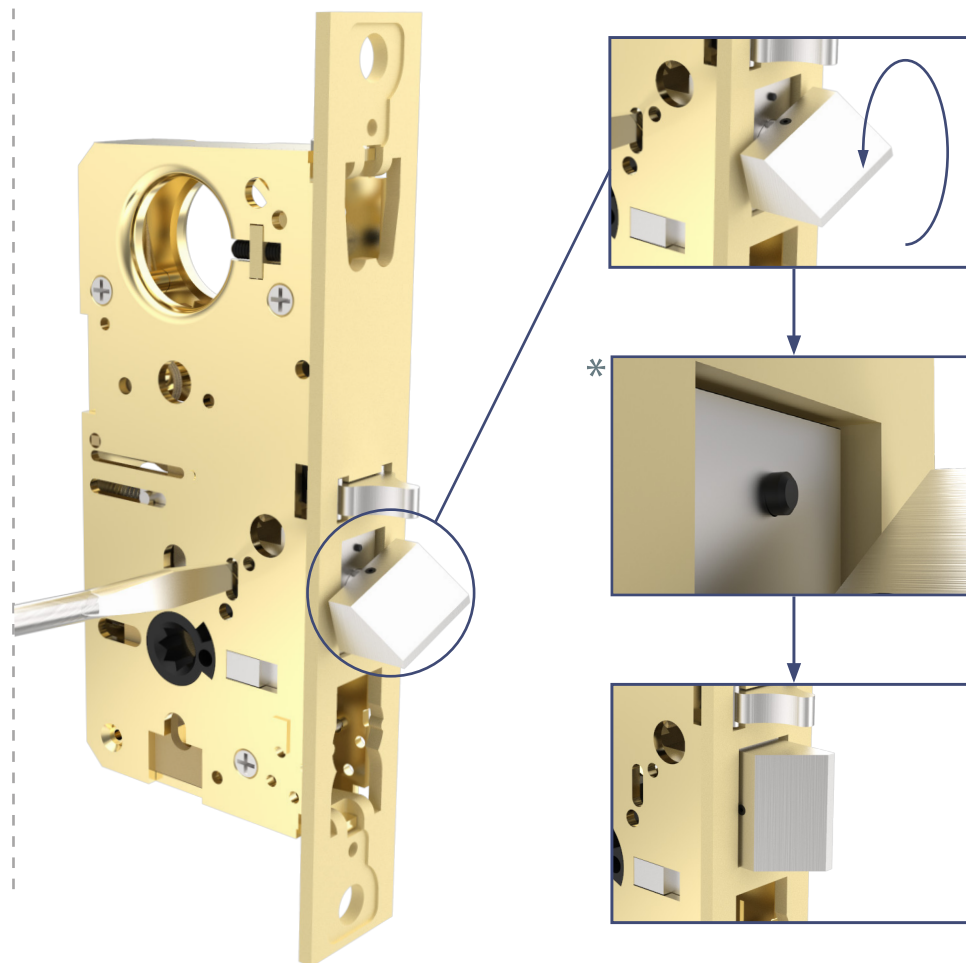

8700FR | 8800FR SERIES

Field Reversible Latch

STEPS TO CHANGE THE LOCKING HUB

STEP 1:

- Use a 3/32" Allen Wrench to unscrew the black panhead screw attached to the hub.



STEP 2:

- Insert black panhead screw into the opposite hub's screw hole.

