



# ACCURATE

## LOCK & HARDWARE

AMERICAN CRAFTED SINCE 1972

---

### 8500 / 8600 Mortise Locks

FOR NARROW STILE DOORS

# DESIGNED WITH STILE IN MIND

## 8500 / 8600 NARROW BACKSET MORTISE LOCKS

- Narrow backsets including  $1\frac{1}{4}"$ ,  $1\frac{1}{2}"$ ,  $1\frac{3}{4}"$ ,  $2"$ , and  $2\frac{1}{4}"$  - ideal for narrow stile doors (minimum  $2\frac{3}{8}"$  stile recommended)
- For lever x lever applications (knob x knob functionality available with some applications)
- For use with Accurate's Levers or custom fitted for most manufacturers' sectional (rose) trim\*
- Compatible with [SilentPac™ Lever Dampening Disc](#)
- Available for upside down, European-style installation (not all functions)
- Can be customized for use on rabbeted doors (with standard or traditional style rabbeted kits)



**8524 ENTRY LOCK**

*\* Please call for assistance when using escutcheons*

# 8500/8600 Series: Technical Details

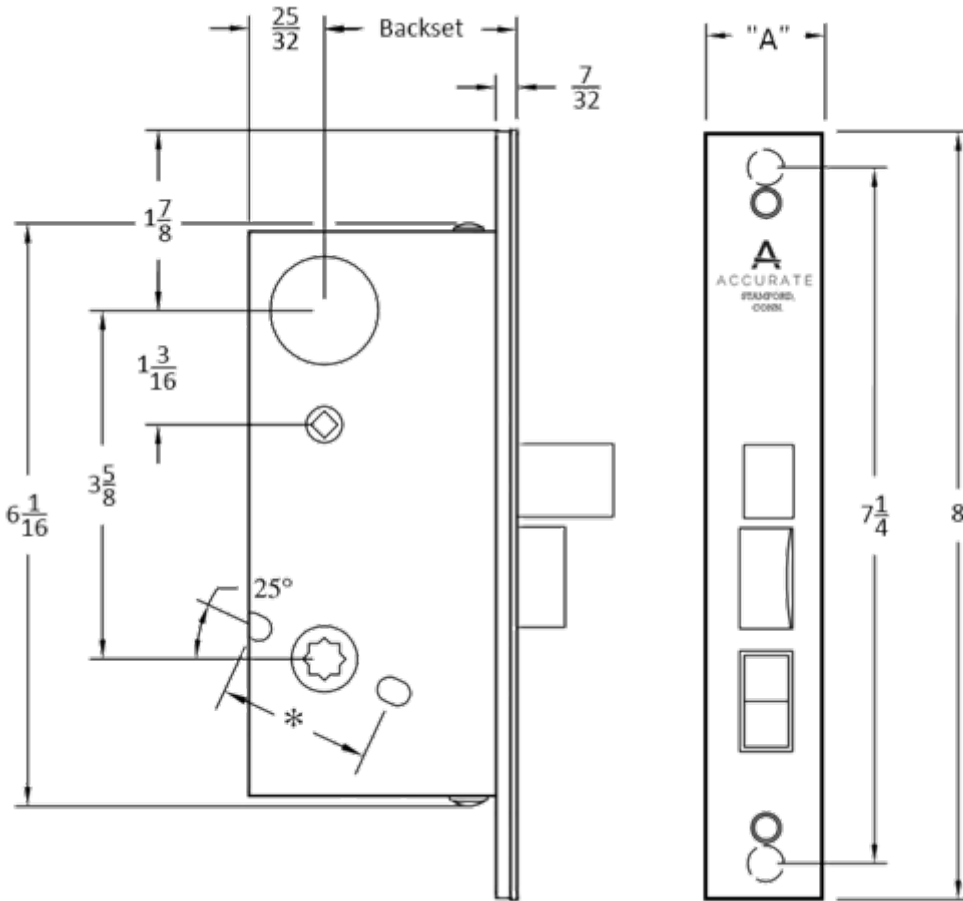

\* To accommodate thru bolting  $1\frac{1}{2}$ " to  $1\frac{11}{16}$ " center to center

A:  $1\frac{1}{4}$ " (8500 locks, for  $1\frac{3}{4}$ " thick doors) or 1" (8600 locks, for  $1\frac{3}{8}$ " thick doors)

**BACKSET:**  $1\frac{1}{4}$ ",  $1\frac{1}{2}$ ",  $1\frac{3}{4}$ ", 2",  $2\frac{1}{4}$ "

**CASE:** Heavy gauge, plated steel ( $2\frac{7}{32}$ " thick)

**ARMOR FRONT:** Adjustable bevel brass, bronze, or stainless steel, finished as required (see all finish options pg. 9)

**LATCH BOLT:** Brass, solid type  $\frac{1}{2}$ " throw

**DEADBOLT:** Brass, 1" throw. (Other throw sizes available as a custom order. Please call for assistance.)

**STRIKE:**  $4\frac{7}{8}$ " ASA

**HUBS:** Available in different sizes to be compatible with various trims

**THUMB TURN HUB:**  $\frac{3}{16}$ " (5mm) on the diamond

**DUST BOX:** Brass, stainless steel or US10B

# 8500/8600 Series: Functions

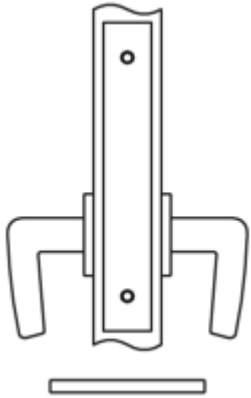

**8500ADL/8600ADL  
ACTIVE DUMMY LOCK**

Active handles inside and out.

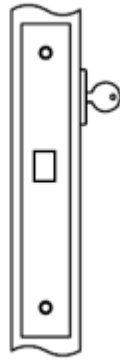

**8501/8601  
DEADLOCK  
(ANSI SERIES 1000-F18)**

Deadbolt by key outside.

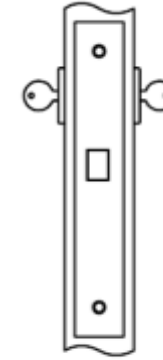

**8502/8602  
DEADLOCK  
(ANSI SERIES 1000-F16)**

Deadbolt by key either side.

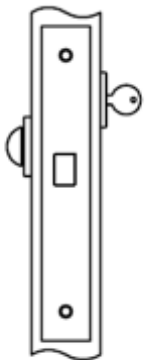

**8503/8603  
DEADLOCK  
(ANSI SERIES 1000-F17)**

Deadbolt by key outside and  
turn piece inside.

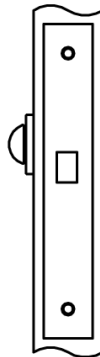

**8504/8604  
DEADLOCK**

Deadbolt by turn piece inside.  
No outside operation.

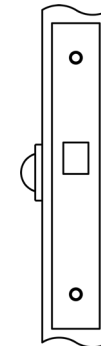

**8505/8605  
DEADLOCK**

Deadbolt by turn piece inside and  
emergency key outside.

# 8500/8600 Series: Functions

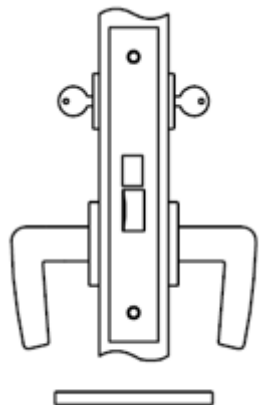

**8522/8622**  
**STORE DORE LOCK**  
**(ANSI SERIES 1000-F14)**

Latch bolt by lever either side.

Deadbolt by key either side.

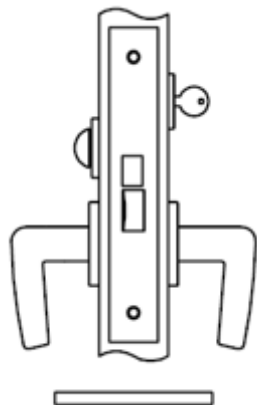

**8524/8624**  
**DORMITORY**  
**(ANSI SERIES 1000-F21)**

Latch bolt by lever either side.

Deadbolt by key outside and turn piece inside.

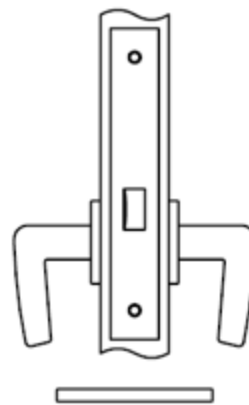

**8525/8625**  
**PASSAGE AND CLOSET LATCH**  
**(ANSI SERIES 1000-F01)**

Latch bolt by lever either side.

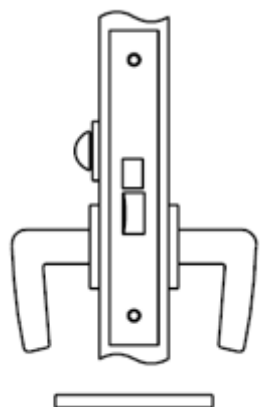

**8539/8639**  
**PRIVACY BEDROOM OR BATHROOM**

Latch bolt by lever either side.

Deadbolt by turn piece inside and optional emergency key outside.

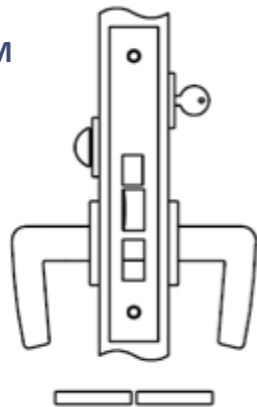

**8548/8648**  
**ENTRANCE OR APARTMENT**  
**(ANSI SERIES 1000-F12)**

Latch bolt by key outside and handle either side unless outside handle is locked by toggle-action stop.

Deadbolt by key outside and turn piece inside.

# 8500/8600 Series: Functions + Special Options

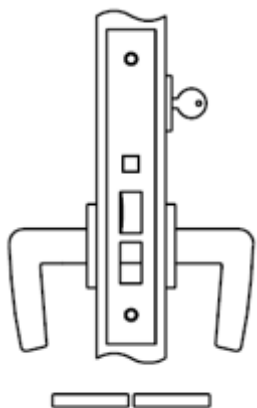

## 8556/8656

### ENTRANCE OR OFFICE (ANSI SERIES 1000-F04)

Latch bolt by key outside and handle either side unless outside handle is locked by toggle-action stop.

Auxiliary latch deadlocks latch bolt.

## 8500/8600 SPECIAL OPTIONS

The 8500 / 8600 locks are “lever locks”.

They can be configured for use with knobs (rotation both ways) on most functions with the exception of 8559/8659 and 8556/8656 functions (knob will rotate one way only).

## UPSIDE DOWN LOCKS

The 8500 / 8600 locks are available for upside down configuration (lever or knob high) with the exception of the 8548/8648, 8556/8656, and 8559/8659 functions.

*Please note that on upside down locks that accept cylinders, the cylinder core will be upside down as well—we recommend specifying cylinders without face markings.*

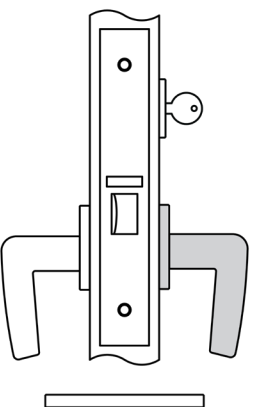

## 8559/8659

### STOREROOM OR CLOSET

Latch by handle inside and key outside.

Outside handle always **rigid**.

Auxiliary latch deadlocks latch bolt.

# Accurate Lever Trim

## 18L LEVER

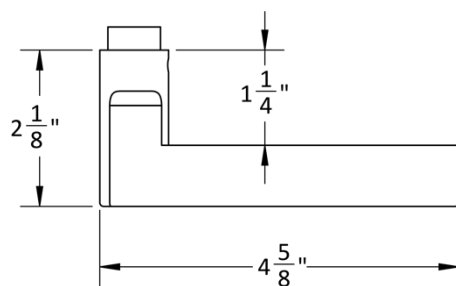

## 19L LEVER

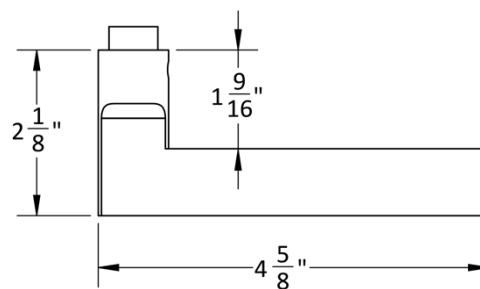

## 20L LEVER

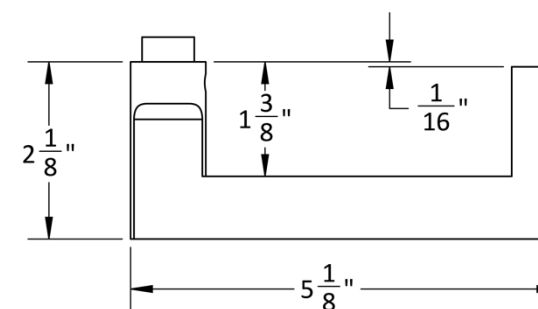
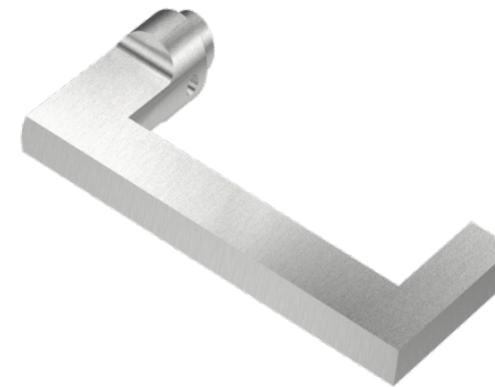

# Accurate Lever Trim

21L LEVER

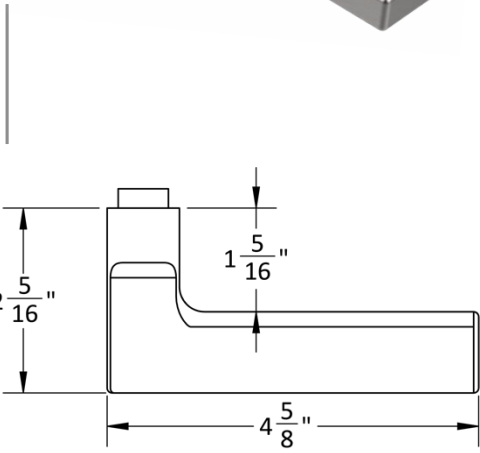

29L LEVER

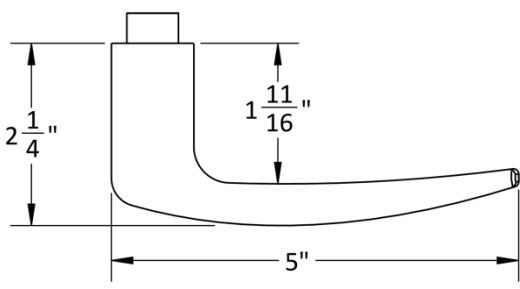

39L LEVER

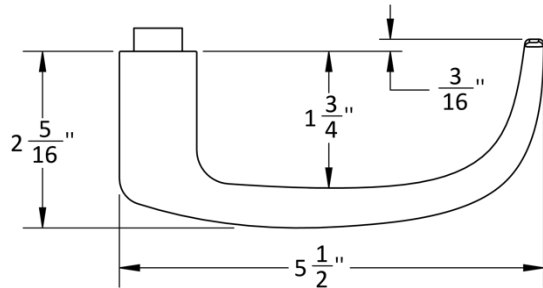

72L LEVER

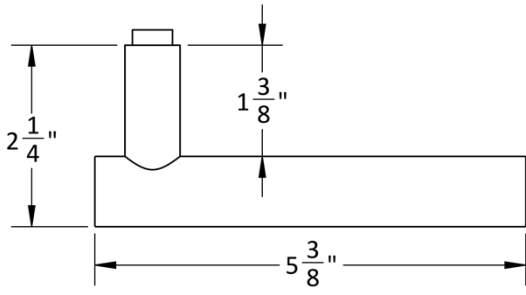



# Accurate Rose Options

COMPATIBLE WITH ALL ACCURATE LEVERS

1R ROSE

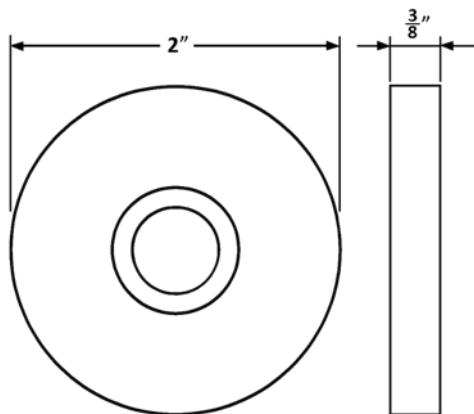
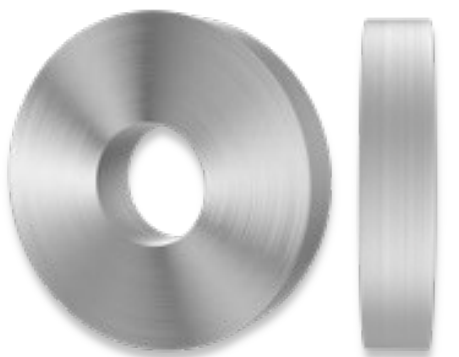

SILENTPAC™ LEVER DAMPENING DISC CAN BE SPECIFIED WITH THE 1R ROSE  
VISIT [SILENTPACSOLUTIONS.COM](https://www.silentpacsolutions.com)

2R ROSE

Side

Inside

Outside

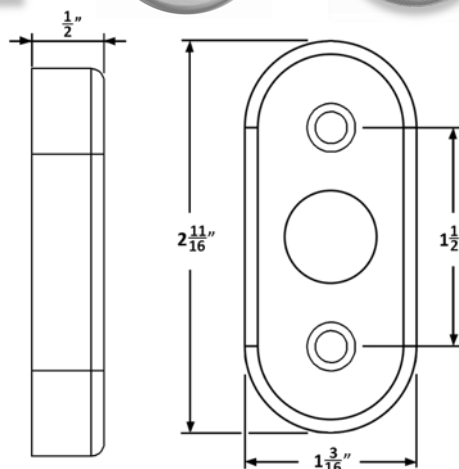

4R ROSE

Side

Inside

Outside

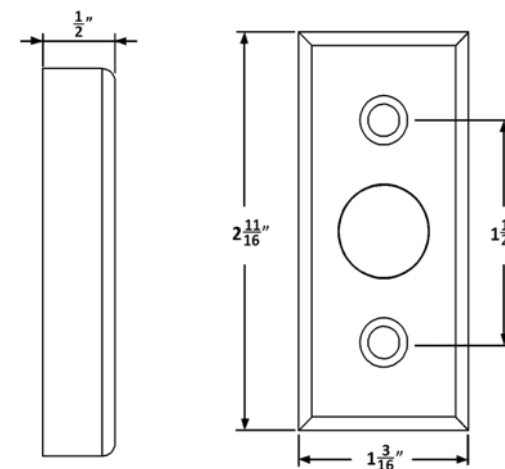

2R AND 4R ROSES TO BE SURFACE MOUNTED ONLY  
(due to thru bolting hole locations on the lock body)

# Accessories

GF1106

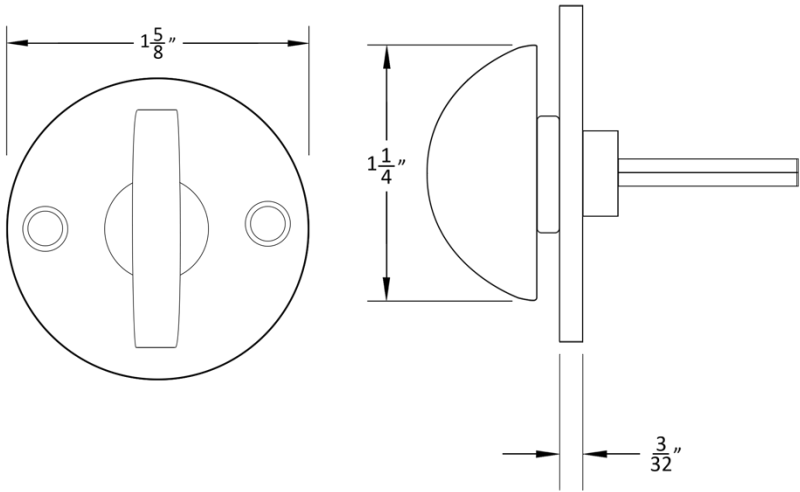

7200ER

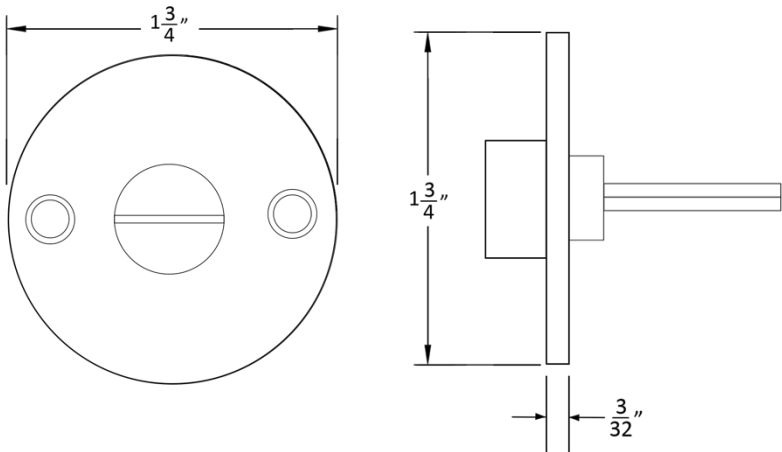

# Accurate Escutcheons: 1E

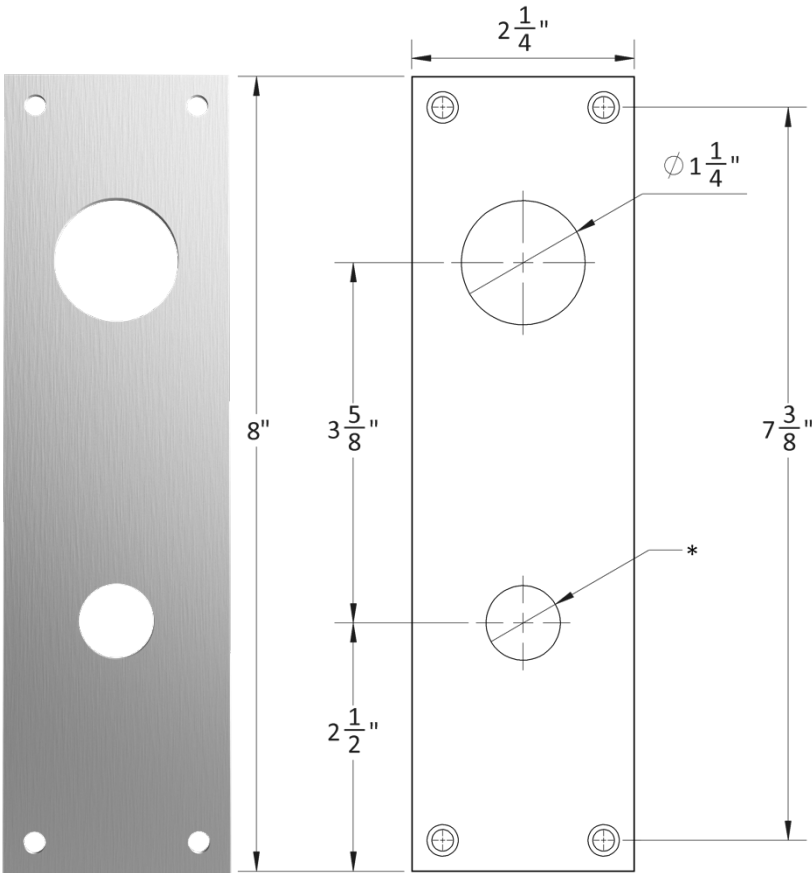

**1E-C**  
Cylinder  
Cutout

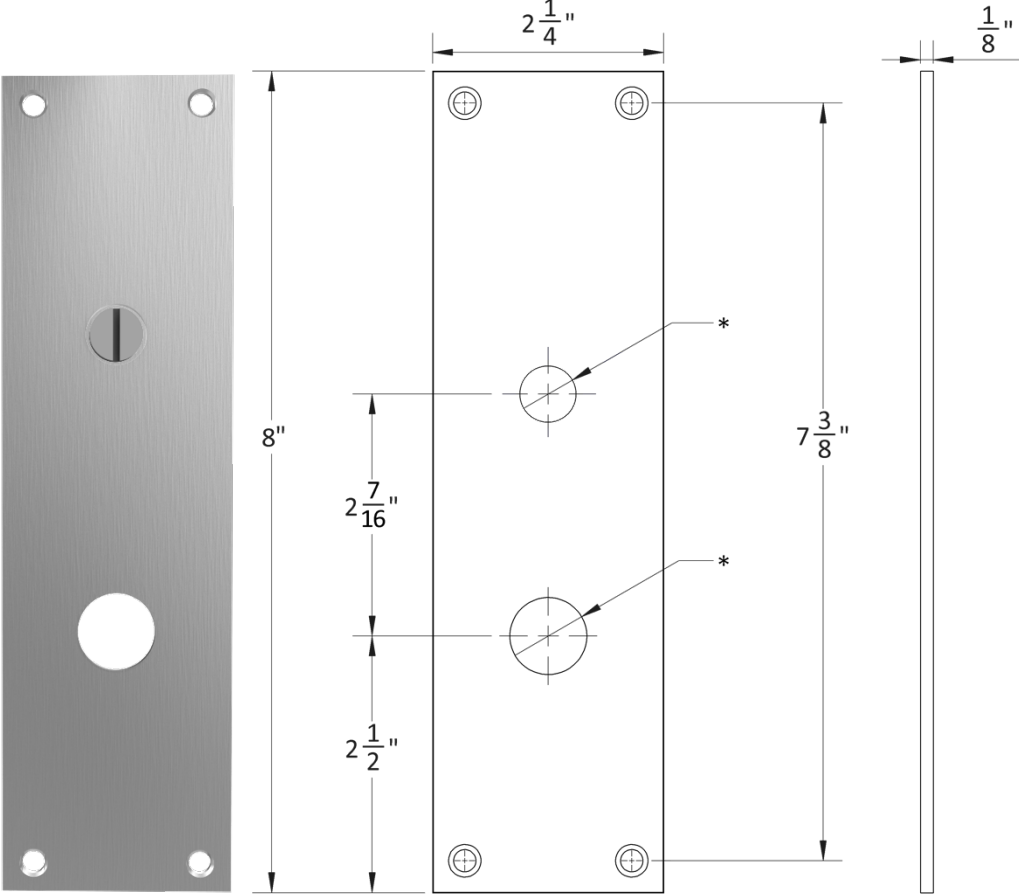

**1E-E**  
Coin emergency  
release

# Accurate Escutcheons: 1E

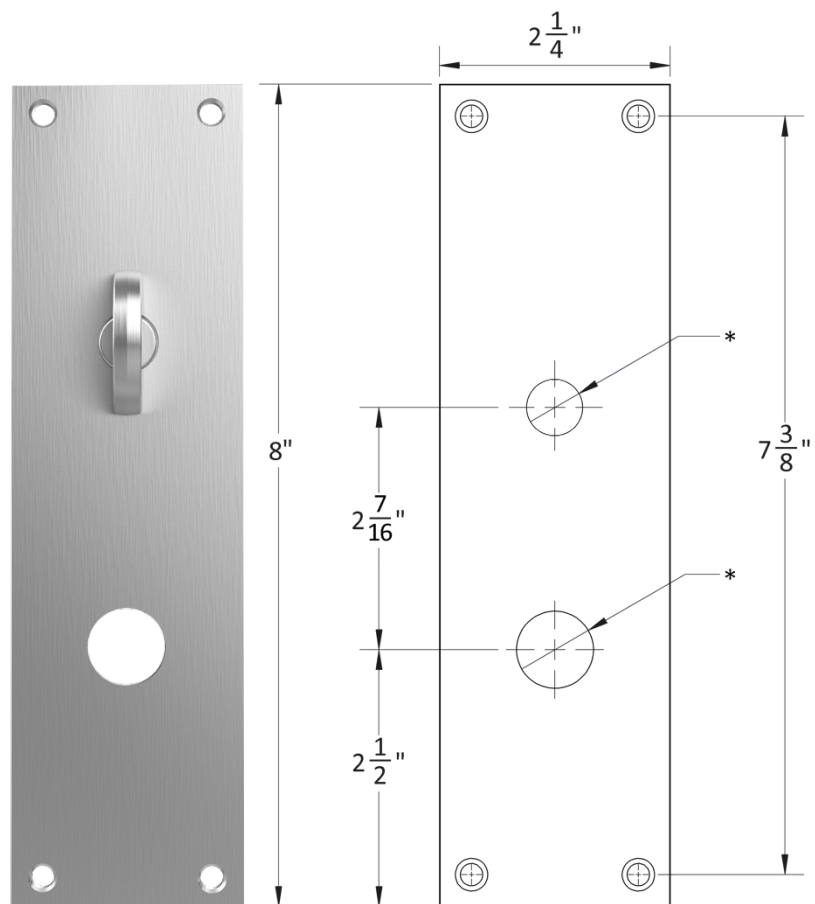

\* Dimensions may vary depending on trim

**1E-T**  
Thumb Turn

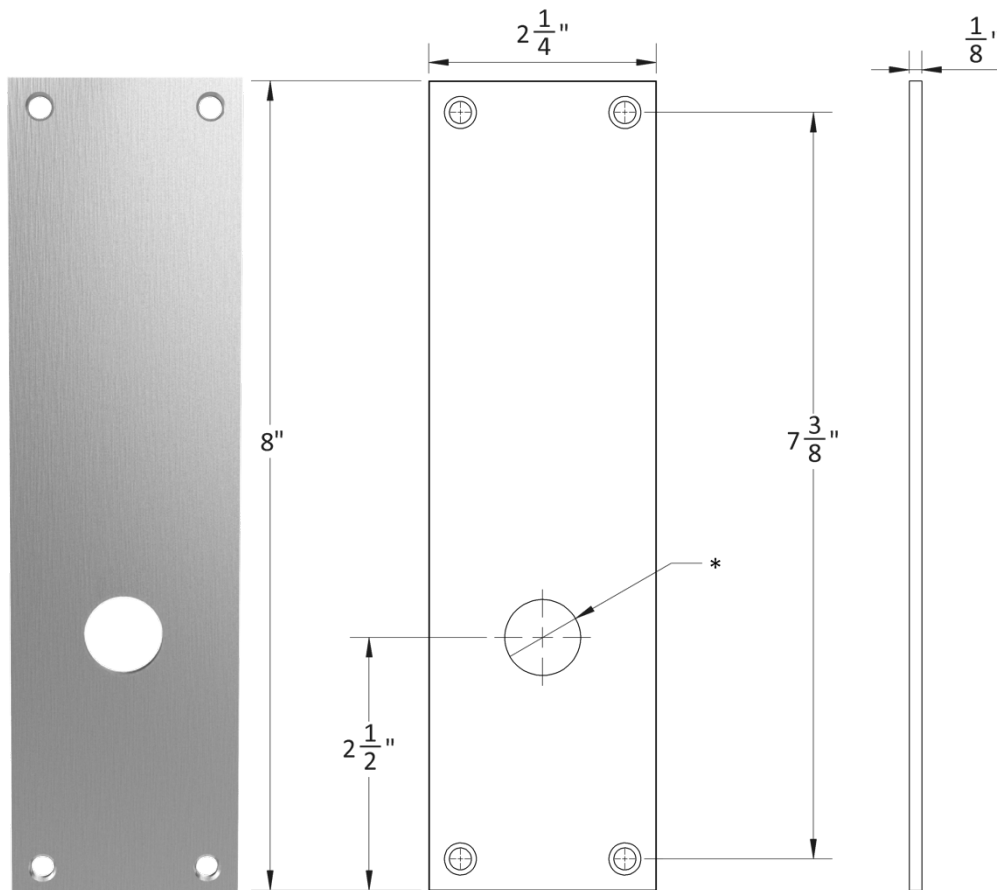

\* Dimensions may vary depending on trim

**1E-B**  
Blank

# HOW TO SPECIFY

## HANDING

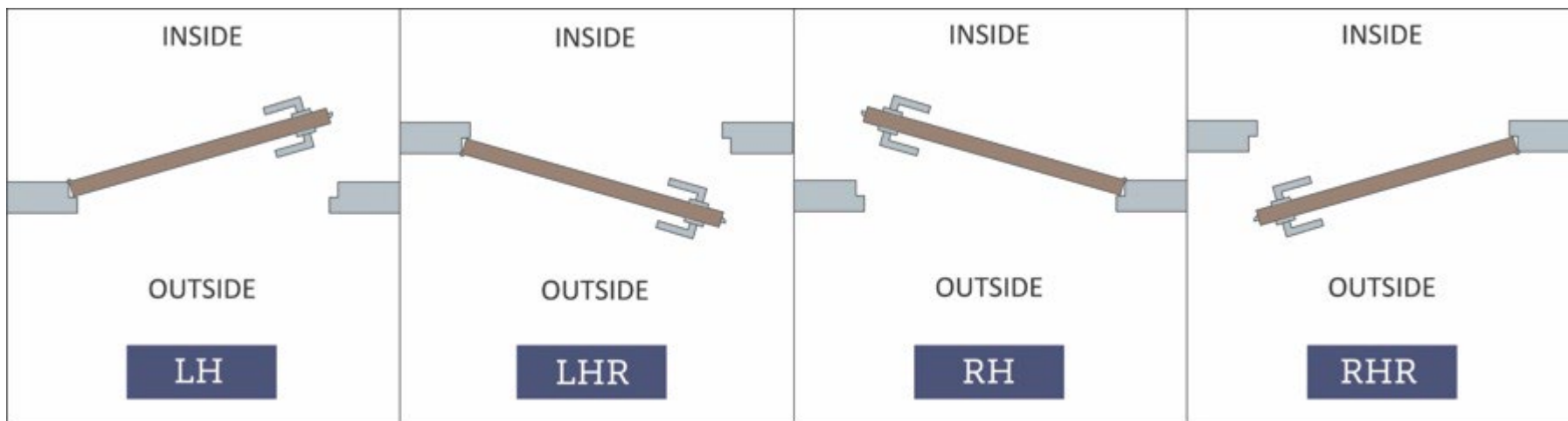

## FINISHES

**GROUP 1:** US4, US4NL, US32D, US26D

**GROUP 2:** US3, US3NL, US26, US32, US9, US10, US10B, US14, US15, US19

**GROUP 3:** BN, BB, TN, TB, DURO, ESN, US15A, US5

To view example of finishes visit: [Accurate Finishes](#)

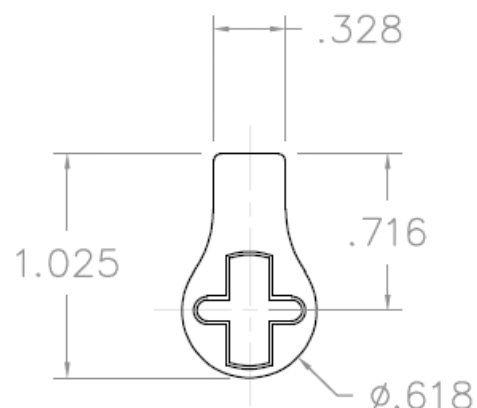

## CYLINDERS & KEYING

8500/8600 series locks accept any standard American mortise cylinder. For details on required cams and compatibility with other manufacturers' cylinders, please visit:

[Accurate Support](#)

# HOW TO SPECIFY

FUNCTION.BACKSET.TRIM.FINISH.HAND.DOORTHICKNESS

## Functions

See available functions (pg. 4-6)

## Backset

1 ¼", 1 ½", 1 ¾", 2", 2 ¼"

## Trim

Accurate Trim (pg. 7-12)

Other Manufacturers' Sectional (rose) Trim (specify hub size or brand)\*

Configurations:

- LxL, KxK

## Finishes

See available finishes (pg.13)

## EXAMPLES

Storeroom Lock | Other Manufacturers' Trim

E.g.: 8559.2.LxL.8mm.US26D.RH.214

Entry Lock | Other Manufacturers' Sectional Knobs

E.g.: 8524.214.KxK-7.2mm.US3. RH.134

Office Lock | Accurate Trim

E.g.: 8556.114.18L/2R.US26D.LH.134

Privacy Lock, Upside Down (Lever Above Thumb Turn) | Accurate Trim

E.g.: 8639USD.134.LxL.18L/1R.US4.LHR.138

Passage Lock, Upside Down (Knob High) | Other Manufacturers' Trim

E.g.: 8525USD.112.KxK-7mm.US3NL.RH.134

\*Note: For compatibility please verify vertical spacing as well as thru bolting locations or call for assistance.

**ACCURATE LOCK & HARDWARE**  
**MANUFACTURERS OF LOCKS AND**  
**CUSTOM ARCHITECTURAL HARDWARE**

1 Annie Place | Stamford, CT 06902

**P:** 203.348.8865

**F:** 203.348.5234

**E:** sales@accuratelockandhardware.com

**www.accuratelockandhardware.com**

**AMERICAN CRAFTED**  
**— SINCE 1972 —**