



# ACCURATE

## LOCK & HARDWARE

AMERICAN CRAFTED SINCE 1972

---

### 9500MRL MAGNETIC ROLLER LATCH

FOR DISCREET INTERIOR OPENINGS

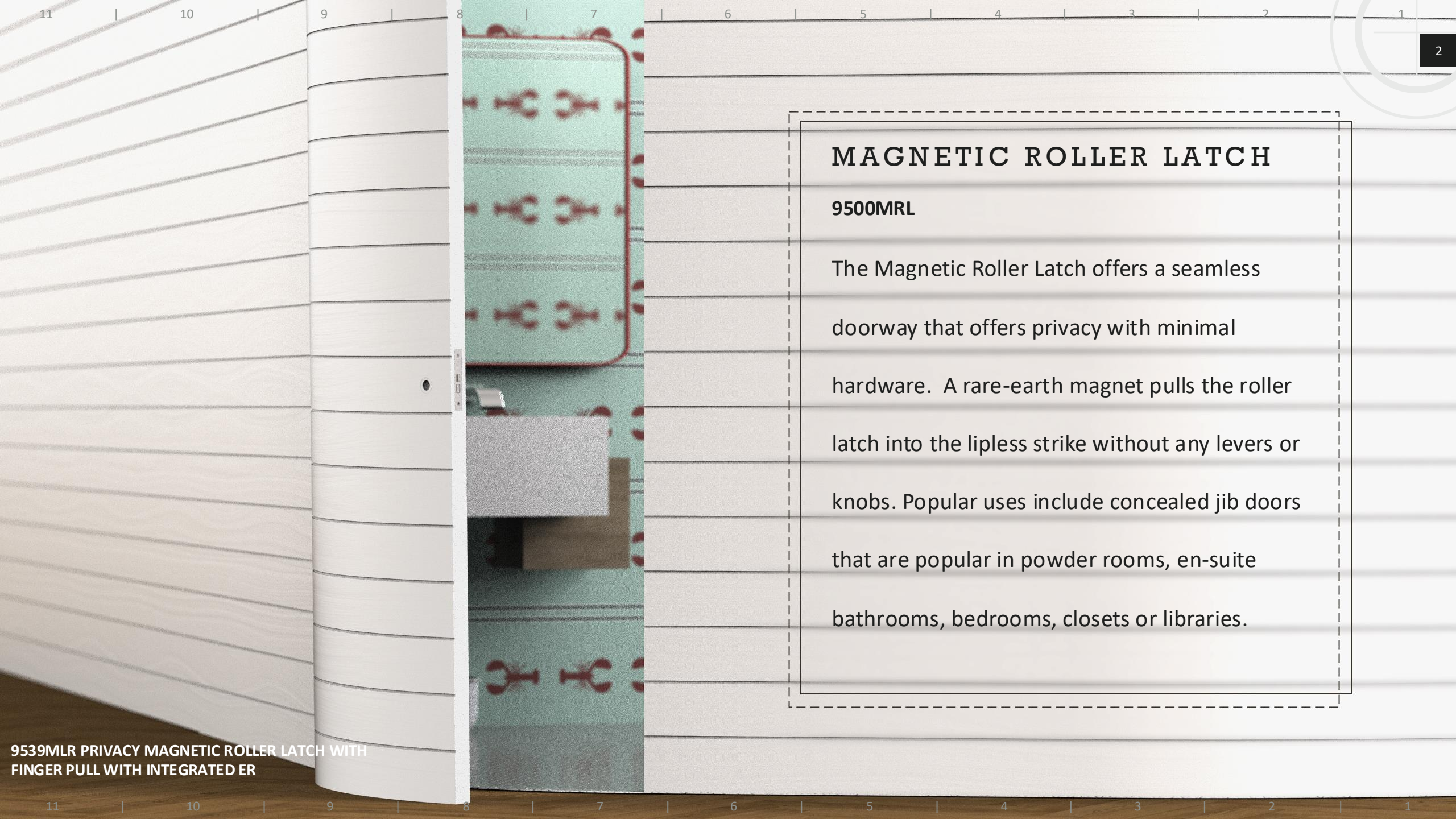

## MAGNETIC ROLLER LATCH

### 9500MRL

The Magnetic Roller Latch offers a seamless doorway that offers privacy with minimal hardware. A rare-earth magnet pulls the roller latch into the lipless strike without any levers or knobs. Popular uses include concealed jib doors that are popular in powder rooms, en-suite bathrooms, bedrooms, closets or libraries.

9539MLR PRIVACY MAGNETIC ROLLER LATCH WITH  
FINGER PULL WITH INTEGRATED ER

# 9500MRL Magnetic Latch

DOOR CLOSED



Rare-earth magnet pulls roller latch into strike to create a completely seamless hidden doorway

DOOR CLOSED

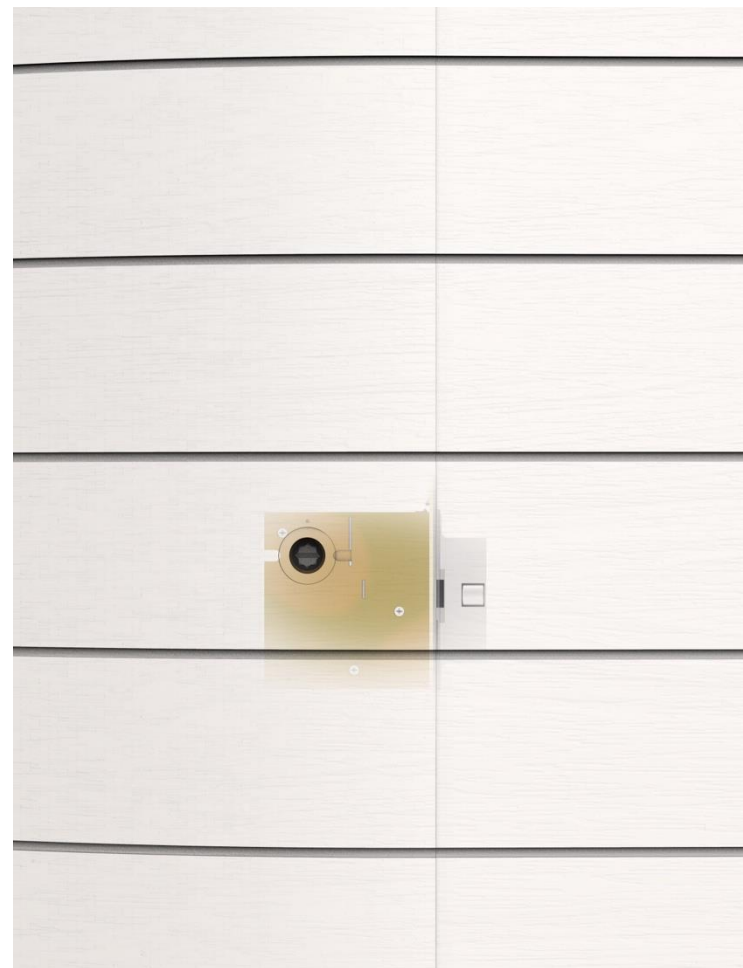

In this view, you can see how the lock and magnet sit in the door.

# 9500MRL Magnetic Latch



Close up in open position.

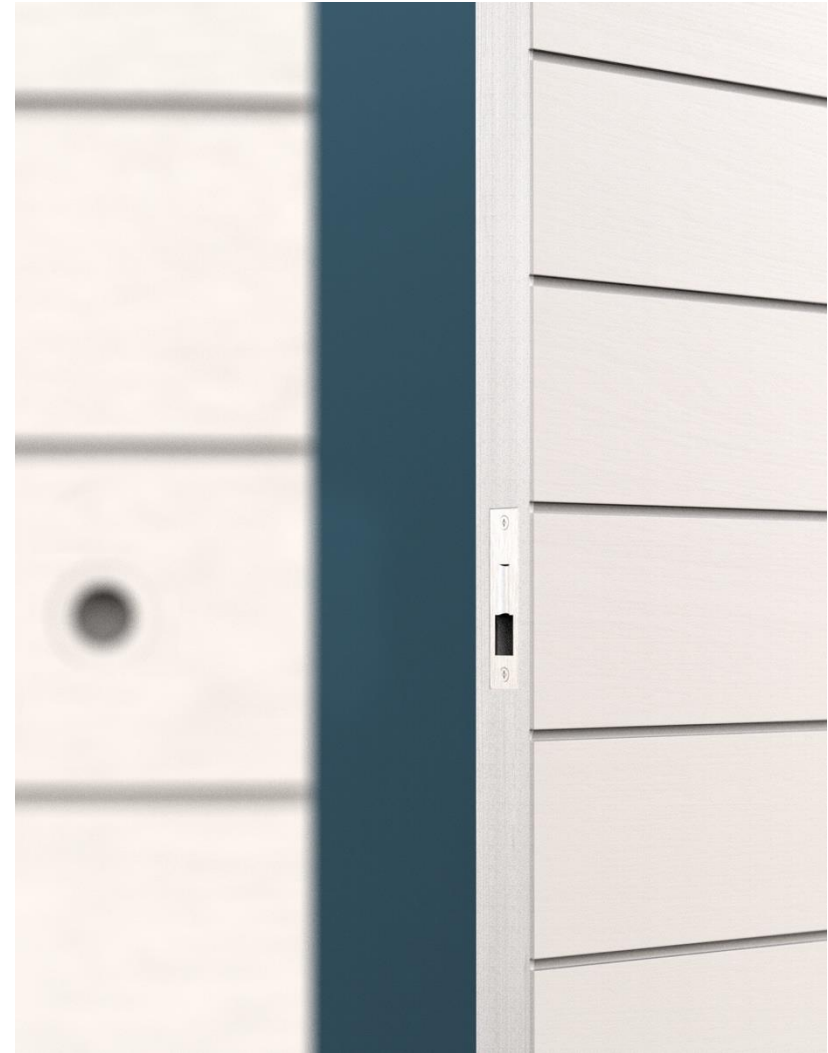

Strike View.

# 9500MRL Magnetic Latch



**RESTING MAGNETIC  
ROLLER LATCH**



**ACTIVATED MAGNETIC  
ROLLER LATCH**

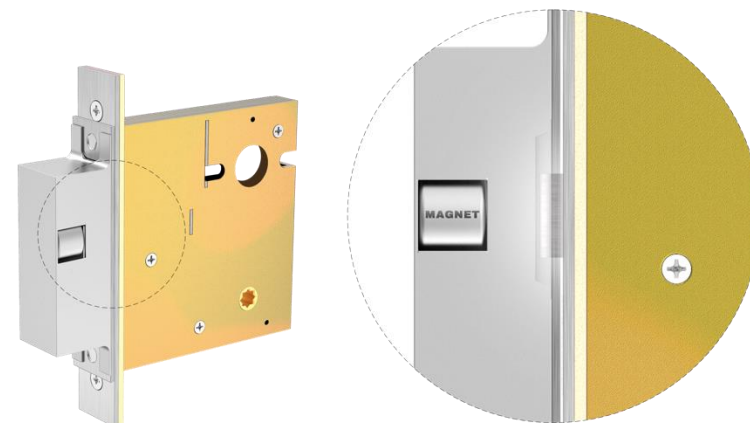

# 9500MRL Technical Details

**BACKSETS:**  $2\frac{1}{2}$ " ,  $2\frac{3}{4}$ " backset for door stiles starting at  $3\frac{3}{4}$ "

**CASE:** Heavy Gauge Steel ( $\frac{3}{4}$ " thick)

**ARMOR FRONT:** Adjustable bevel. Made from brass, bronze or stainless steel and finished as required.

**LATCH BOLT:**  $\frac{7}{16}$ " throw. Magnetic stainless steel.

**DEADBOLT:** Brass or stainless steel.  $\frac{1}{2}$ " throw.



9539MRL PRIVACY MAGNETIC ROLLER LATCH



# 9525MRL Dimensions

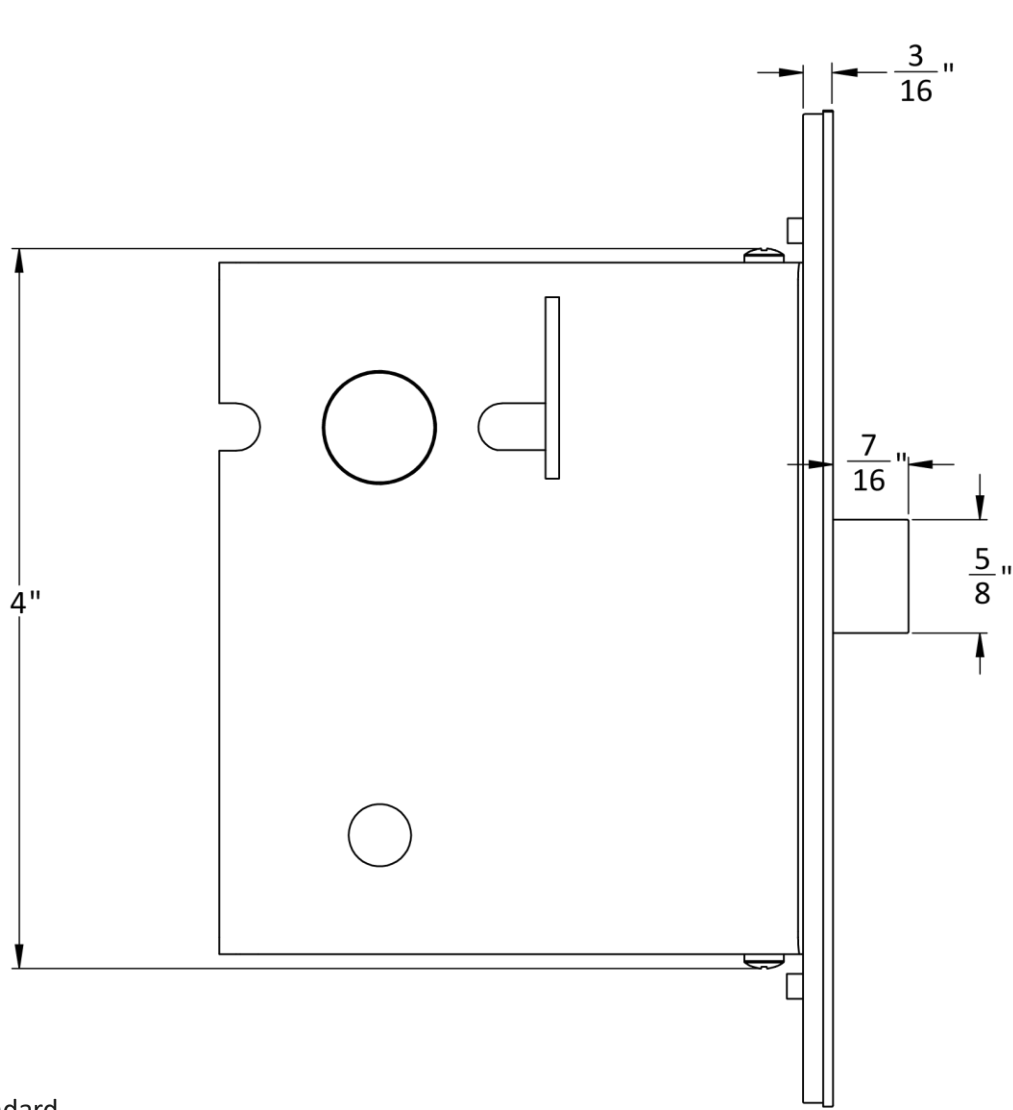

Backset 2 1/2" backset standard  
Custom backsets are available upon request.

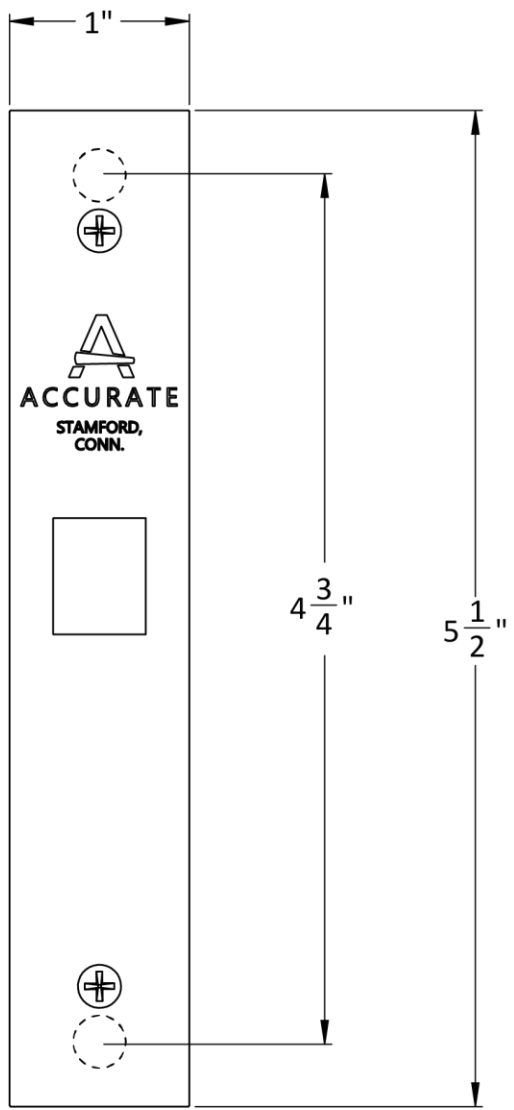

9525MRL PASSAGE MAGNETIC LATCH

# 9539MRL Dimensions

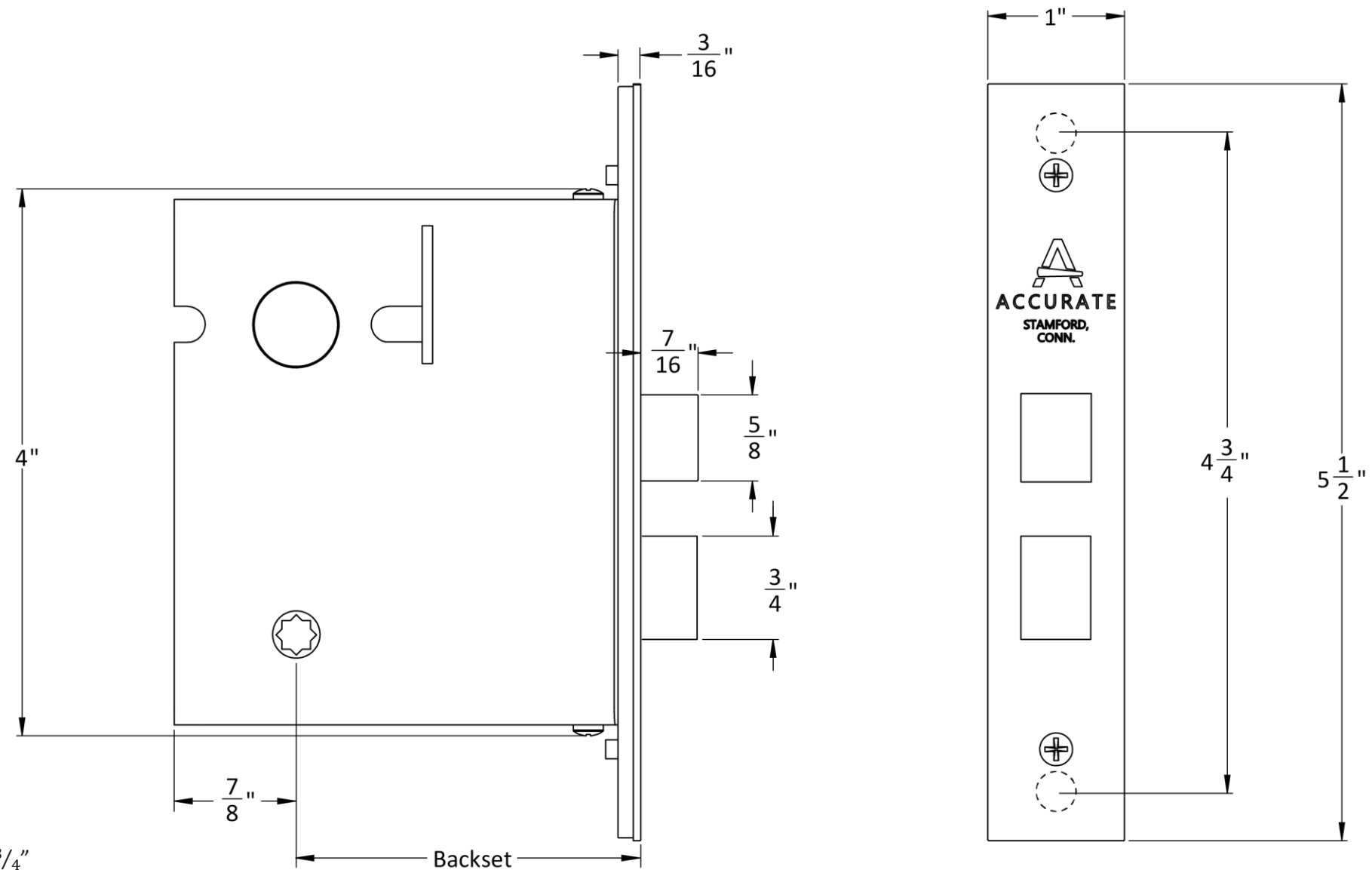

Backset  $2\frac{1}{2}$ ", or  $2\frac{3}{4}$ "  
Custom backsets are available upon request.

9539MRL PRIVACY MAGNETIC LATCH

# 9500MRL Functions

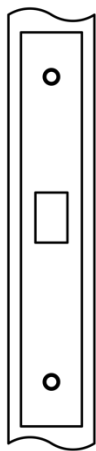

## **9525MRL** **PASSAGE MAGNETIC ROLLER LATCH**

Latch bolt by lever either side

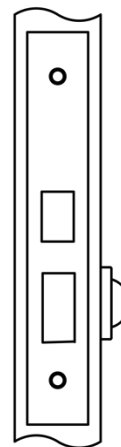

## **9539ML** **PRIVACY MAGNETIC ROLLER LATCH**

Latch bolt by knob or lever either side.  
Deadbolt by turn piece inside and optional  
emergency key outside.

# HOW TO SPECIFY

FUNCTION.**BACKSET**.**TRIM**.**FINISH**.DOORTHICKNESS

## FUNCTIONS

See available functions (pg. 9)

## BACKSET

2<sup>1</sup>/<sub>2</sub>", 2<sup>3</sup>/<sub>4</sub>"  
Other backsets  
available upon  
request

## TRIM

[Accurate trim](#)  
or specify other trim  
manufacturers or spindle size

## FINISHES

See available  
finishes (below)

## EXAMPLES

Interior Magnetic Roller Latch | Privacy | Accurate Trim

E.g.: 9539MRL.212.21L/1R/GF1106.US26D.134

Interior Magnetic Roller Latch | Passage

E.g.: 9525MRL.212.US4.134

Interior Magnetic Latch | Passage | No Trim

E.g.: 9525MRL.212.US19.134

*\*Note: For compatibility with other manufacturers' trim please call for assistance.*

## ACCURATE TRIM

Specify Accurate Finger Pull or other trim.

[Click or scan to see trim options.](#)



SCAN HERE

## FINISHES

**GROUP 1:** US4, US4NL, US32D\*, US26D

**GROUP 2:** US3, US3NL, US26, US32\*, US9\*, US10\*,  
US10B, US14, US15, US19

**GROUP 3:** BN, BB, TN, TB, DURO, ESN, US15A,  
US5,US19LL

\* Trim options (including Accurate Levers) may not be  
available in US32D, US32, US9, or US10 finish. Please  
call for assistance.

To view example of finishes visit: [Accurate Finishes.](#)

**ACCURATE LOCK & HARDWARE**  
**MANUFACTURERS OF LOCKS AND**  
**CUSTOM ARCHITECTURAL HARDWARE**

1 Annie Place | Stamford, CT 06902

**P:** 203.348.8865

**F:** 203.348.5234

**E:** sales@accuratelockandhardware.com

**www.accuratelockandhardware.com**

