



# ACCURATE

## LOCK & HARDWARE

AMERICAN CRAFTED SINCE 1972

---

### 9500VR Vertical Rod Lock

AN ALTERNATIVE LOCKING SOLUTION FOR BARN DOORS

# INVISIBLE DETAILS

## 9500VR VERTICAL ROD LOCK

- Designed for sliding door applications
- Allows the door to be locked onto the floor (VRB) or up into track or header in the ceiling (VRT)
- For use with flush pulls or accessible hardware
- For single door openings (or double door openings if independent locking is desired)
- Features locking capability without a protruding strike (strike options available)
- Ideal for use in both residential and commercial settings
- Pair with different trim options to best fit the design intent and specific project requirements.
  - Flush pulls
  - ADA pulls



**9500VRB VERTICAL ROD BOLT WITH FLUSH PULL TRIM**

# VERTICAL ROD LOCK: BEHIND THE SCENES

9500VRB Bottom Lock Shown\*

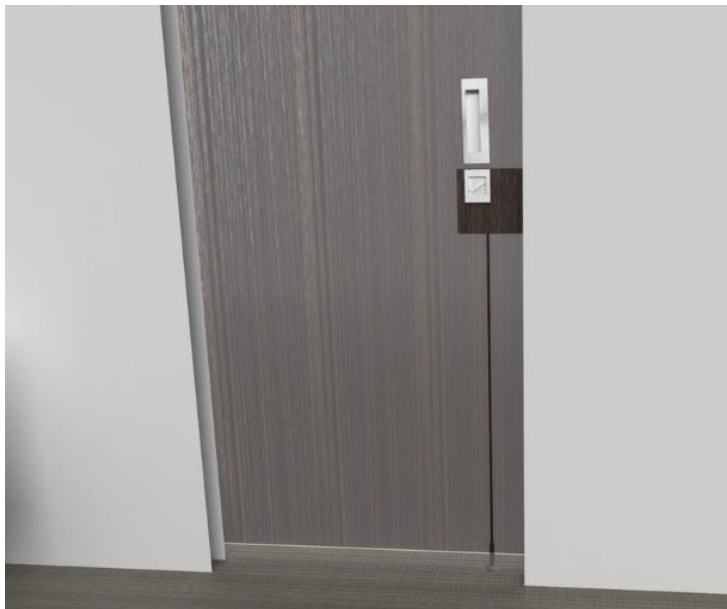

## FULL DOOR VIEW

9500VRB lock component and details are shown here as the interior side of a right handed door (translucent to show detail).



## UNLOCKED | DOOR VIEW

9500VRB is paired with flush trim.  
Unlocking the thumb turn will release the rod from the floor to slide door open.  
(Other trim options available.)

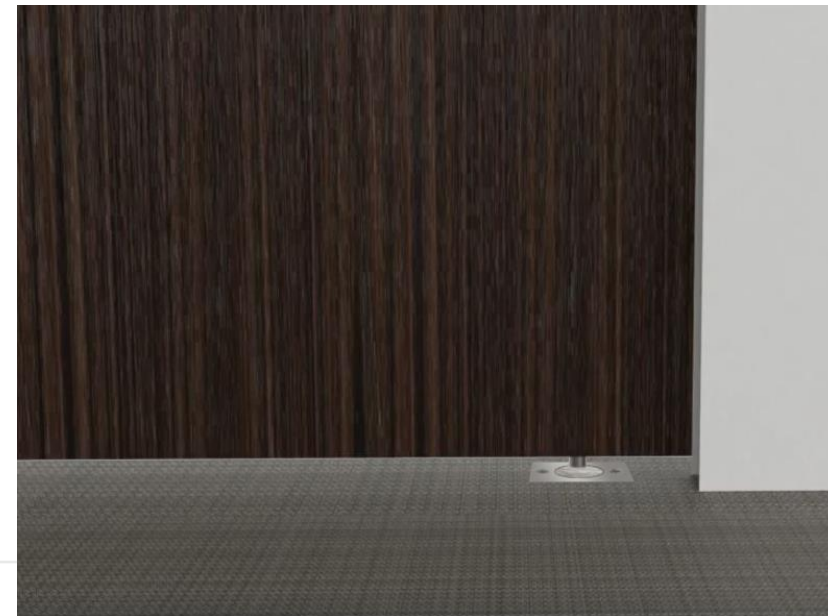

## UNLOCKED | FLOOR VIEW

Close up view of the rod lock releasing from the floor when unlocked.

\*9500VRT Top Lock also available to lock on ceiling

**WATCH THE VIDEO**

<http://bit.ly/9500VRB>

# 9500VR LOCK BODY + TRIM OPTIONS



## LOCK BODY

- Vertical rod lock available to lock into floor (VRB) or ceiling (VRT)
- Variable backsets available: on applications with cylinders, there will be two backsets (one to the thumb turn and one to the cylinder)

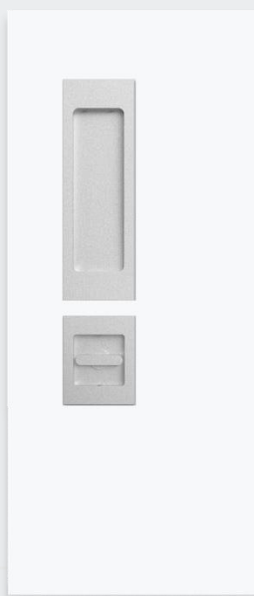

## FLUSH PULL TRIM

- Minimalistic recessed look
- A variety of flush pull options available with exposed or concealed fasteners (for all options [click here](#))

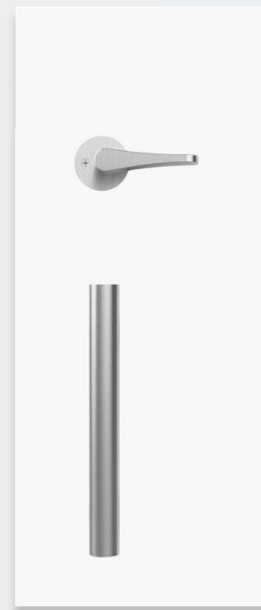

## ADA BACK TO BACK PULLS

- Sleek, easy-to-grab 7200P pull handles that meet accessibility requirements
- Customizable to be made in various lengths
- Pair with 7200ADA thumb turn for full ADA set



# 9500VR FUNCTIONS

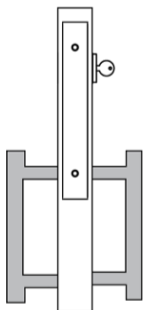

## 9500VRB-1 | 9500VRT-1 SINGLE CYLINDER

Deadbolt by key outside.

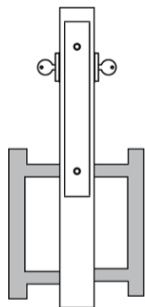

## 9500VRB-2 | 9500VRT-2 DOUBLE CYLINDER

Deadbolt by key either side.

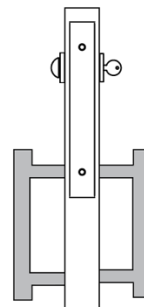

## 9500VRB-3 | 9500VRT-3 ENTRY

Deadbolt by key outside or  
turn piece inside.

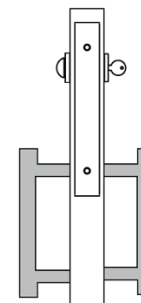

## 9500VRB-3ST | 9500VRT-3ST CLASSROOM DEADLOCK

Turn piece inside will only  
retract deadbolt.

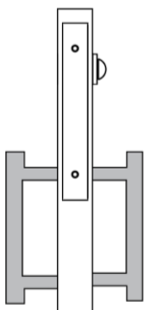

## 9500VRB-4 | 9500VRT-4 PRIVACY

Deadbolt by turn piece  
inside.

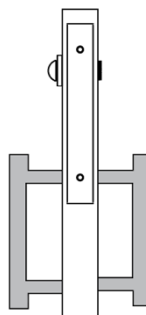

## 9500VRB-5 | 9500VRT-5 PRIVACY

Deadbolt by emergency release  
outside, turn piece inside.

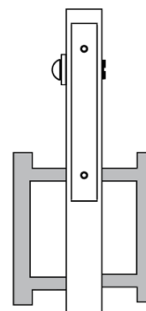

## 9500VRB-5i | 9500VRT-5i PRIVACY WITH INDICATOR

Deadbolt by emergency release with  
indicator outside, turn piece inside.

**Note:** Shown here with back to back pulls.  
Other trim options available in these functions.

# HOW TO SPECIFY

## HANDING

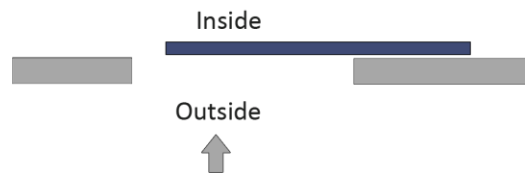

### RH-Inside

1. Standing outside
2. Door on inside
3. Opens to right

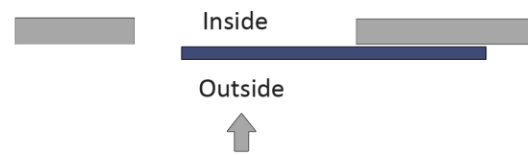

### RH-Outside

1. Standing outside
2. Door is outside
3. Opens to right

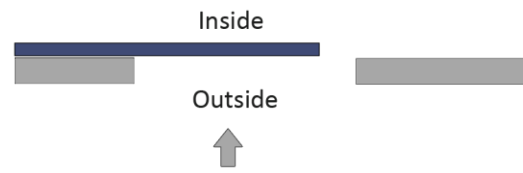

### LH-Inside

1. Standing outside
2. Door on inside
3. Opens to left

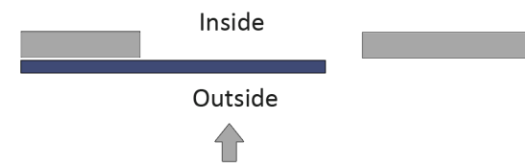

### LH-Outside

1. Standing outside
2. Door is outside
3. Opens to left

## FINISHES

**GROUP 1:** US4, US4NL, US32D\*, US26D

**GROUP 2:** US3, US3NL, US26, US32\*, US9\*, US10\*, US10B, US14, US15, US19

**GROUP 3:** BN, BB, TN, TB, DURO, ESN, US15A, US5

\* Trim options may not be available in US32D, US32, US9, or US10 finish. Please call for assistance.

To view example of finishes visit: [Accurate Finishes](#).

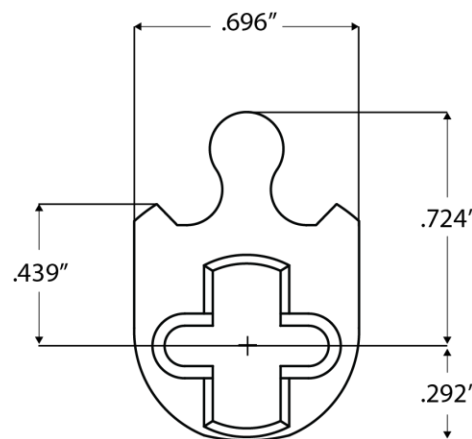

## CYLINDERS & KEYING

9500VR locks accept any standard American mortise cylinder. For details on required cams and compatibility with other manufacturers' cylinders, please visit:

[Accurate Support](#).

# HOW TO SPECIFY

## TRIM.FUNCTION.BACKSET.FINISH.HAND.DOORTHICKNESS.VERTICAL DIMENSION

### Trim Options

Please specify:

#### Flush Pulls:

- S, A, N, O
- CS, CA, CN, CO
- 24R, 24S
- FC2348, FE2348

#### ADA

- Includes 7200P and 7200ADA (where applicable)

See all available trim options.

### Functions

See available functions (pg. 7)

### Backset

For all functions except 9500VR-1 and 9500VR-2, specify backset to thumb turn and then cylinder will be located 1-3/16" away  
(E.g. Thumb turn backset: 5",  
Cylinder backset: 3 <sup>13</sup>/<sub>16</sub>" )

For 9500VR-1 and 9500VR -2, specify backset to the cylinder.

**ADA:** Minimum 5" backset to thumb turn on barn door applications.

**Flush Trim:** Min. 2 1/2" backset to thumb turn.

Other backsets available.

### Finishes

See available finishes (pg.8)

### Door Thickness

Standard 1 3/4" Doors

### Vertical Dimension

From centerline of cylinder or thumb turn to top or bottom of door

## EXAMPLES

Vertical Rod Lock Bottom | Privacy | Flush Pull Trim

E.g. **S.9500VRB-5.212.US3NL.RH.134.39**

Vertical Rod Lock Top | Entry | ADA Trim

E.g. **ADA.9500VRT-3.6.US10B.LH.134.39**

Vertical Rod Lock Bottom | Classroom Deadlock | ADA Trim

E.g. **ADA.9500VRB-3ST.5.US4.RH.134.39**

Suggested floor strike models are Ives DP1 and Ives DP2, provided by other suppliers.

Also available for swinging door applications, please call for assistance.

**ACCURATE LOCK & HARDWARE**  
**MANUFACTURERS OF LOCKS AND**  
**CUSTOM ARCHITECTURAL HARDWARE**

1 Annie Place | Stamford, CT 06902

**P:** 203.348.8865

**F:** 203.348.5234

**E:** [sales@accuratelockandhardware.com](mailto:sales@accuratelockandhardware.com)

**[www.accuratelockandhardware.com](http://www.accuratelockandhardware.com)**

**AMERICAN CRAFTED**  
**— SINCE 1972 —**