



ACCURATE

LOCK & HARDWARE

AMERICAN CRAFTED SINCE 1972

9500MRL MAGNETIC ROLLER LATCH

FOR DISCREET INTERIOR OPENINGS

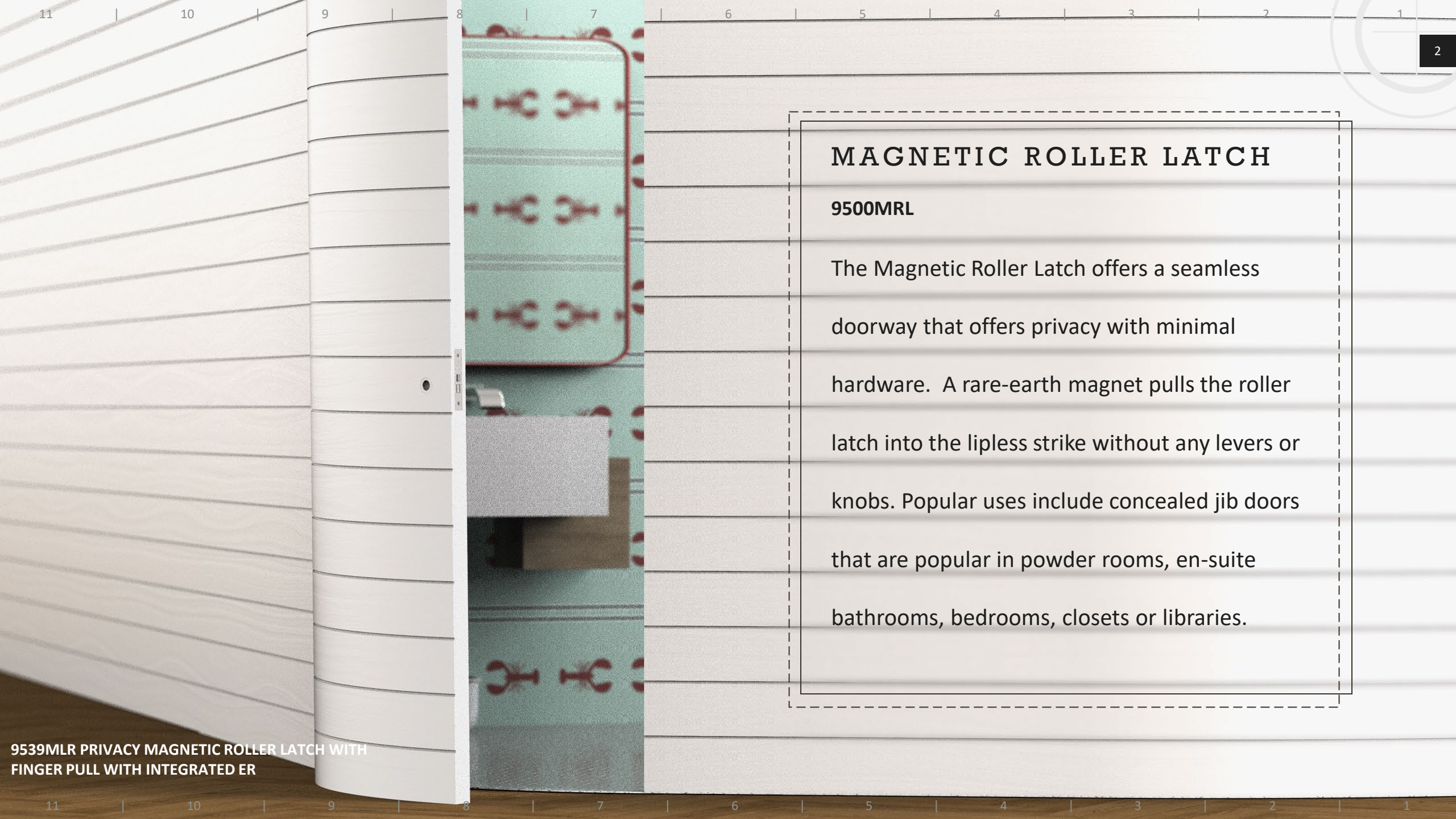

MAGNETIC ROLLER LATCH

9500MRL

The Magnetic Roller Latch offers a seamless doorway that offers privacy with minimal hardware. A rare-earth magnet pulls the roller latch into the lipless strike without any levers or knobs. Popular uses include concealed jib doors that are popular in powder rooms, en-suite bathrooms, bedrooms, closets or libraries.

9539MLR PRIVACY MAGNETIC ROLLER LATCH WITH
FINGER PULL WITH INTEGRATED ER

9500MRL Magnetic Latch

DOOR CLOSED



Rare-earth magnet pulls roller latch into strike to create a completely seamless hidden doorway

DOOR CLOSED

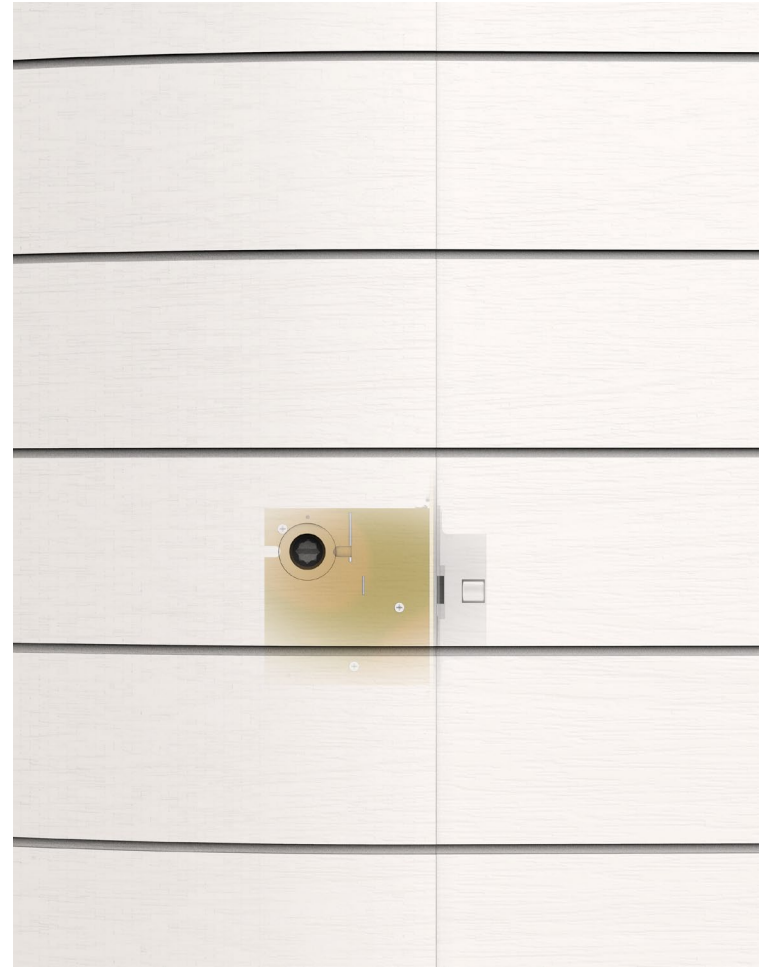

In this view, you can see how the lock and magnet sit in the door.



9500MRL Magnetic Latch



Close up in open position.



Strike View.

9500MRL Magnetic Latch



**RESTING MAGNETIC
ROLLER LATCH**



**ACTIVATED MAGNETIC
ROLLER LATCH**



9500MRL Technical Details

BACKSETS: $2\frac{1}{2}$ " , $2\frac{3}{4}$ " backset for door stiles starting at $3\frac{3}{4}$ "

CASE: Heavy Gauge Steel ($\frac{3}{4}$ " thick)

ARMOR FRONT: Adjustable bevel. Made from brass, bronze or stainless steel and finished as required.

LATCH BOLT: $\frac{7}{16}$ " throw. Magnetic stainless steel.

DEADBOLT: Brass or stainless steel. $\frac{1}{2}$ " throw.



9539MRL PRIVACY MAGNETIC ROLLER LATCH

9525MRL Dimensions

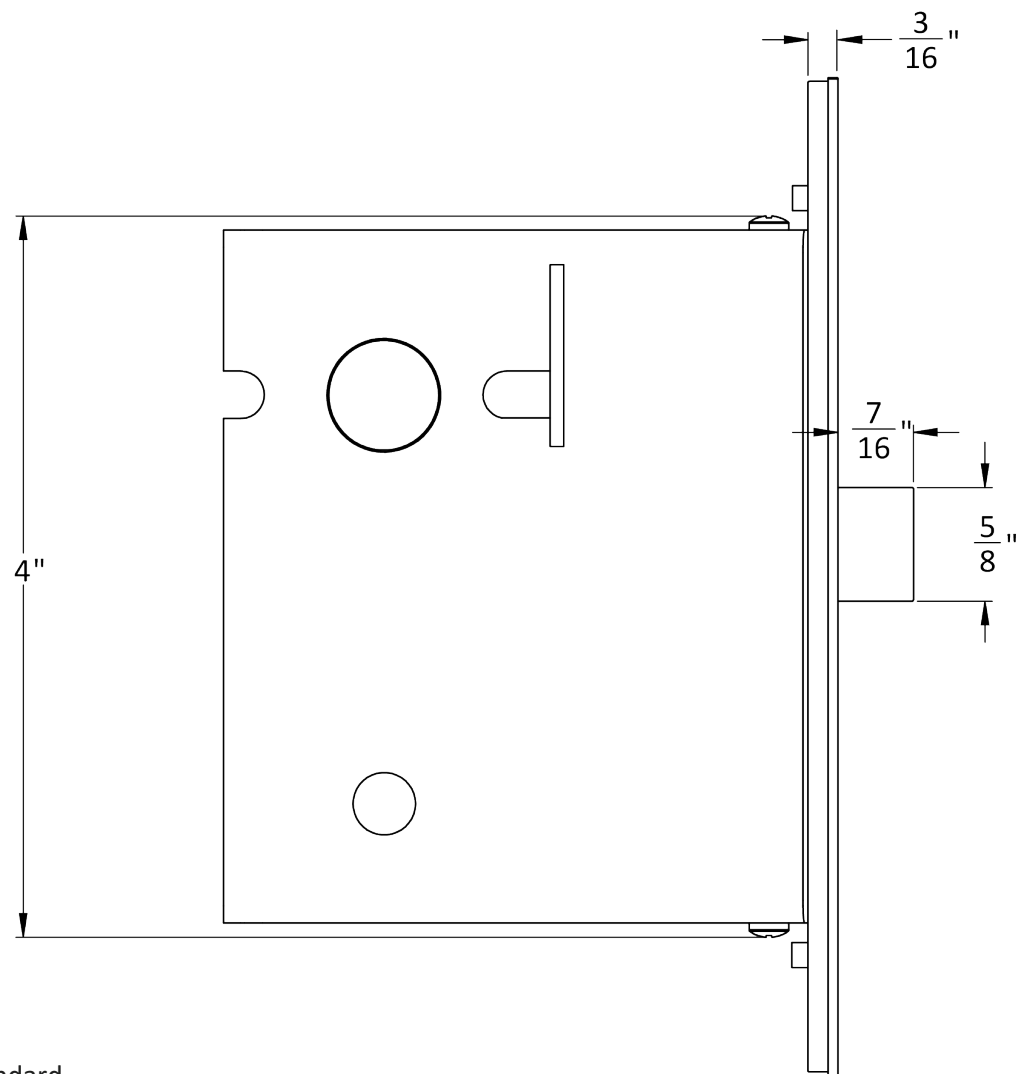

Backset $2\frac{1}{2}"$ backset standard
Custom backsets are available upon request.

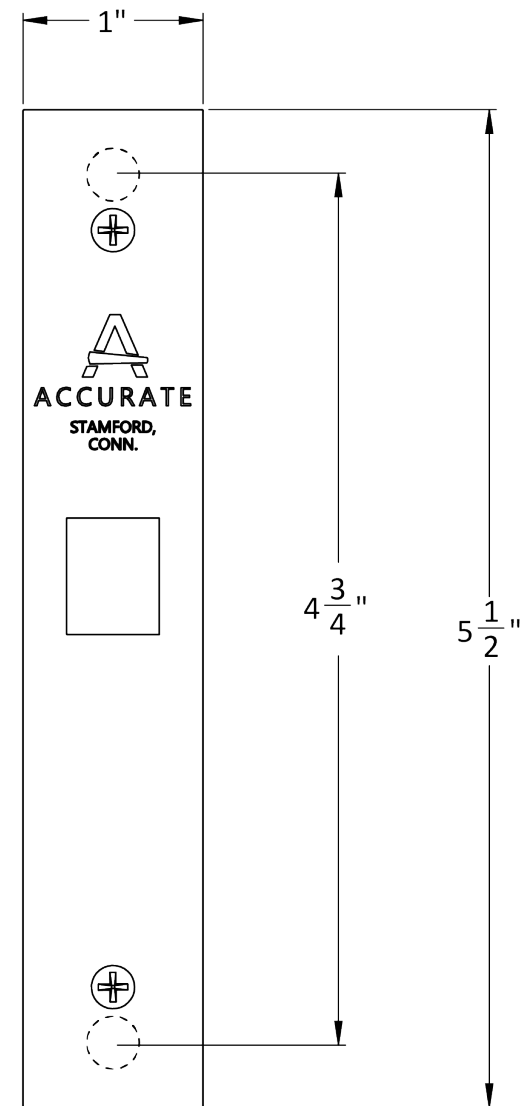

9525MRL PASSAGE MAGNETIC LATCH

9539MRL Dimensions

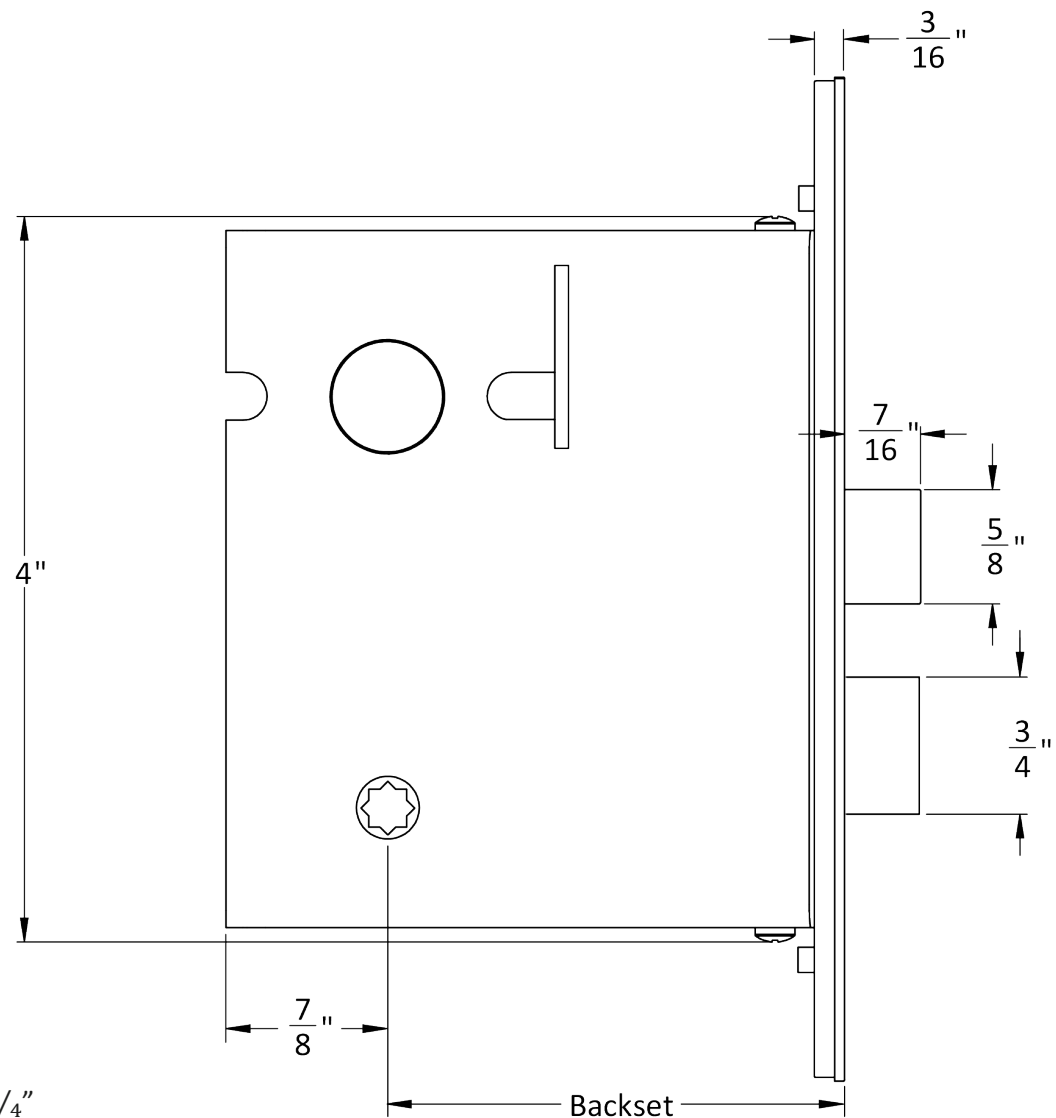

Backset $2\frac{1}{2}$ ", or $2\frac{3}{4}$ "
Custom backsets are available upon request.

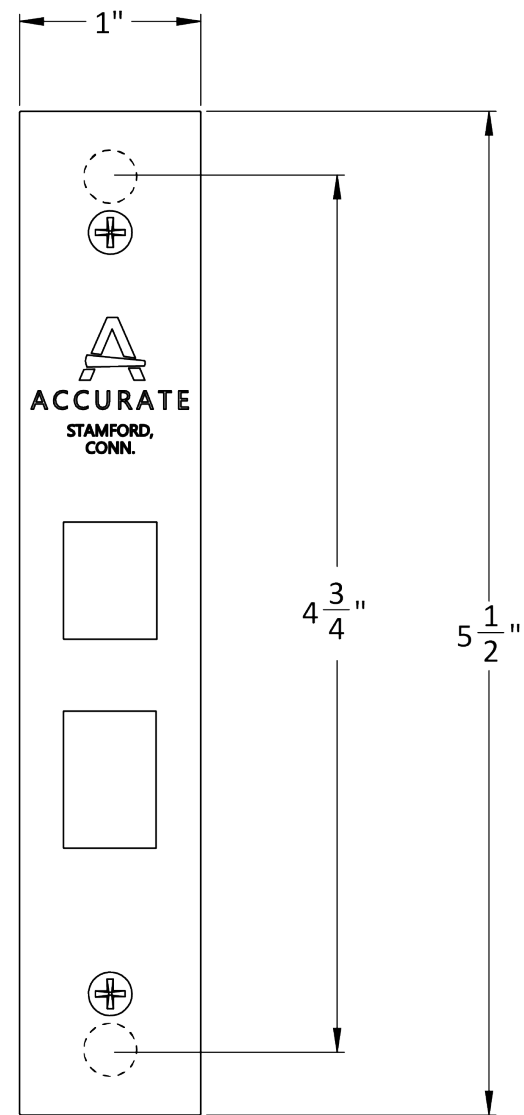

9539MRL PRIVACY MAGNETIC LATCH

9500MRL Functions

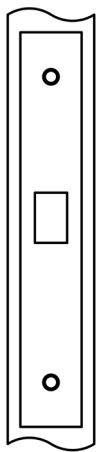

9525MRL **PASSAGE MAGNETIC ROLLER LATCH**

For push/pull passage applications.

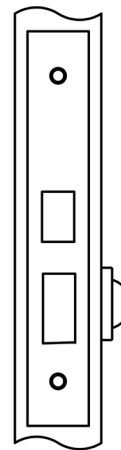

9539ML **PRIVACY MAGNETIC ROLLER LATCH**

For push/pull privacy applications.
Deadbolt by thumb turn inside and optional
emergency key outside.

Finger Pull Option

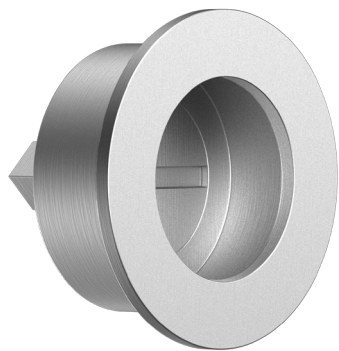

R-FP-E
ROUND FINGER PULL

Small Round Finger Pull with Integrated
Emergency Release

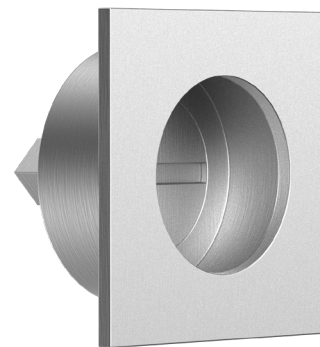

S-FP-E
SQUARE FINGER PULL

Small Square Finger Pull with Integrated
Emergency Release

HOW TO SPECIFY

FUNCTION.BACKSET.TRIM.FINISH.DOORTHICKNESS

FUNCTIONS

See available functions (pg. 9)

BACKSET

2¹/₂" , 2³/₄"
Other backsets
available upon
request

TRIM

Accurate trim
or specify other trim
manufacturers or spindle size

FINISHES

See available
finishes (below)

EXAMPLES

Interior Magnetic Roller Latch | Privacy | Accurate Trim
E.g.: 9539MRL.212.FP-E/21L/1R/GF1106.US26D.134

Interior Magnetic Roller Latch | Passage | Accurate Trim
E.g.: 9525MRL.212.FP-B.US4.134

Interior Magnetic Latch | Passage | No Trim
E.g.: 9525MRL.212.US19.134

ACCURATE TRIM

Specify Accurate Finger Pull or other trim.

[Click or scan to see trim options.](#)



SCAN HERE

FINISHES

GROUP 1: US4, US4NL, US32D*, US26D

GROUP 2: US3, US3NL, US26, US32*, US9*, US10*,
US10B, US14, US15, US19

GROUP 3: BN, BB, TN, TB, DURO, ESN, US15A,
US5,US19LL

* Trim options (including Accurate Levers) may not be
available in US32D, US32, US9, or US10 finish. Please
call for assistance.

To view example of finishes visit: [Accurate Finishes.](#)

**Note: For compatibility with other manufacturers' trim please call for assistance.*

ACCURATE LOCK & HARDWARE
MANUFACTURERS OF LOCKS AND
CUSTOM ARCHITECTURAL HARDWARE

1 Annie Place | Stamford, CT 06902

P: 203.348.8865

F: 203.348.5234

E: sales@accuratelockandhardware.com

www.accuratelockandhardware.com

AMERICAN CRAFTED
— SINCE 1972 —