



ACCURATE

LOCK & HARDWARE

AMERICAN CRAFTED SINCE 1972

M8800E

MOTOR DRIVE ELECTRIFIED NARROW BACKSET MORTISE LOCK



**M8859E MOTOR DRIVE NARROW
BACKSET ELECTRIC MORTISE LOCK
SHOWN WITH 19L LEVER + 2R ROSE**



M8800E MOTOR DRIVE NARROW BACKSET ELECTRIFIED MORTISE LOCK

Accurate's narrow backset motorized mortise lock allows for access control with enhanced aesthetic possibilities. Compatible with most manufacturers' trim, the M8800E has all the advantages of the latest industry standards and can be used with narrow door stiles. Furnished standard with anti-friction latch bolt, also available with manual deadbolt.

M8800E Product Benefits

IMPROVED FLEXIBILITY

- Narrow backset options including 1 ½", 1 ¾", 2", 2 ¼" for use on narrow stile doors
- UL Listed 3-hour Version available (M8800E-UL)
- Universal output voltage (accepts between 11V – 30V, versus solenoid version that is 24VDC specific)
- Can easily be changed from FAIL SECURE to FAIL SAFE to adapt to design variations

FUNCTIONALITY

- AE (Authorized Egress/Request to Exit) monitor available for all functions, including the new M8824E.

LONGER LIFE

- Adaptable to new technology

SAVE POWER, SAVE MONEY

- A motor drive lock costs significantly less per year to operate at \$0.25, compared to a solenoid lock that costs \$8.33*

STAY COOL

- Low current draw produces minimal heat eliminated "hot levers"

BE GREEN

- Low power requirement is ideal for environmentally friendly access control systems

IN GOOD COMPANY

- The same motor functionality is used by other trusted manufacturers including: Schlage, Sargent, Corbin Russwin, Hager, etc.



ANTI-FRICTION LATCH

For smoother operation and improved performance.

M8800E Technical Details



M8824E

BACKSETS: 1 ½", 1 ¾", 2", 2 ¼"

CASE: Heavy gauge, plated steel (15/16" thick)

ARMOR FRONT: Adjustable bevel brass, bronze, or stainless steel, finished as required (see all finish options pg. 9)

LATCH BOLT: Brass, anti-friction type ½" throw (solid latch bolt available as a special order).**

DEADBOLT: Brass, 1" throw. (Other throw sizes available as custom order.) For M8824E function only.

STRIKE: 4⁷/₈" ASA

HUBS: Available in different sizes to be compatible with various trims

DUST BOX: Brass, stainless steel or oil rubbed bronze

OPERATION: Key Cylinder (by others) will override electronics to retract latch bolt

ELECTRONIC SPECIFICATIONS:

12-24V AC/DC (11V-30V Operating Range)

250mA MAX Inrush

10mA MAX Holding

Non-polarized Leads

** ¾" Latch bolt throw when ordered for fire-rated applications, Specify: M8800E-UL

M8824E Dimensions

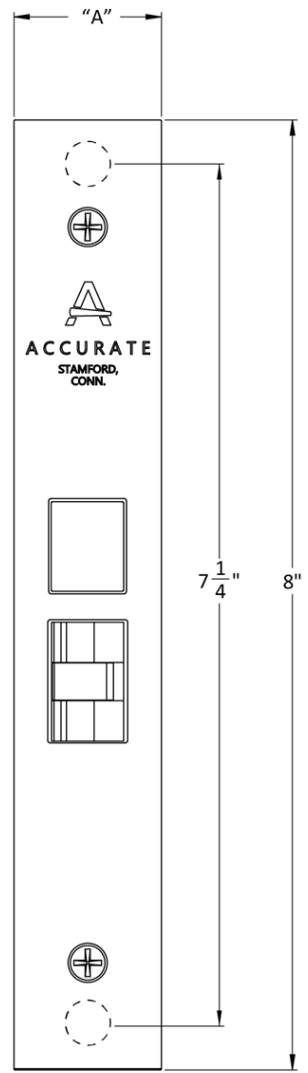
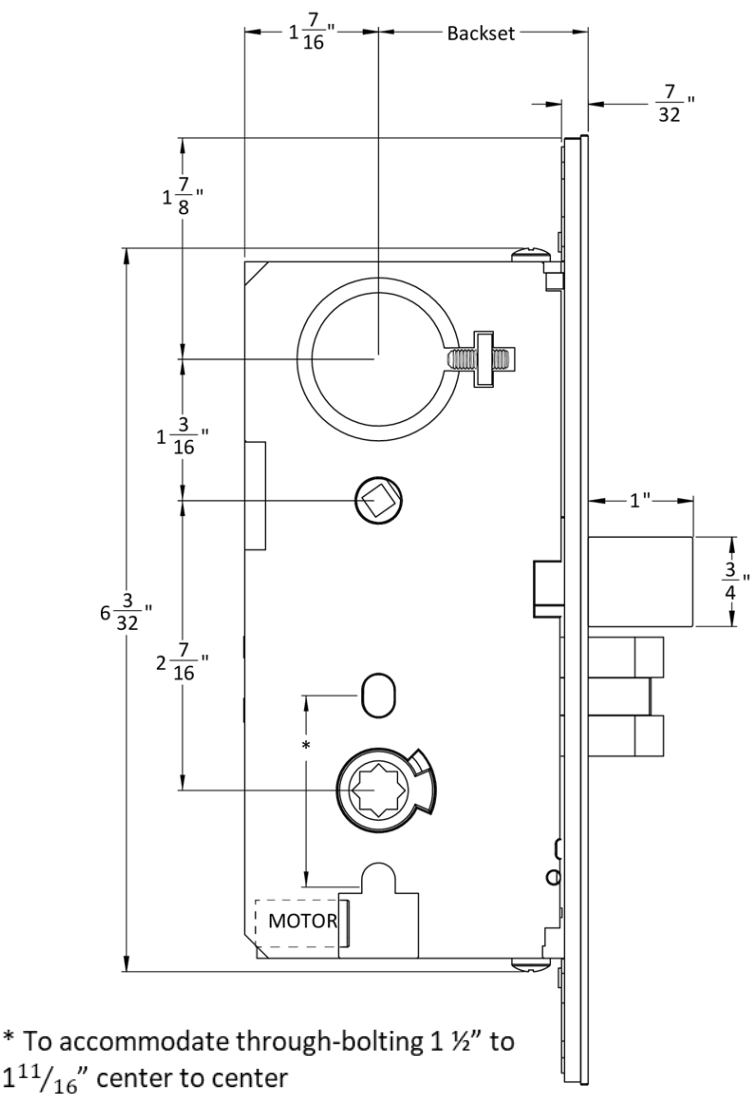

A:
1 1/4" (8800 locks, for 1 3/4" thick doors)
1" (8700 locks, for 1 3/8" thick doors)

M8858E | M8859E Dimensions

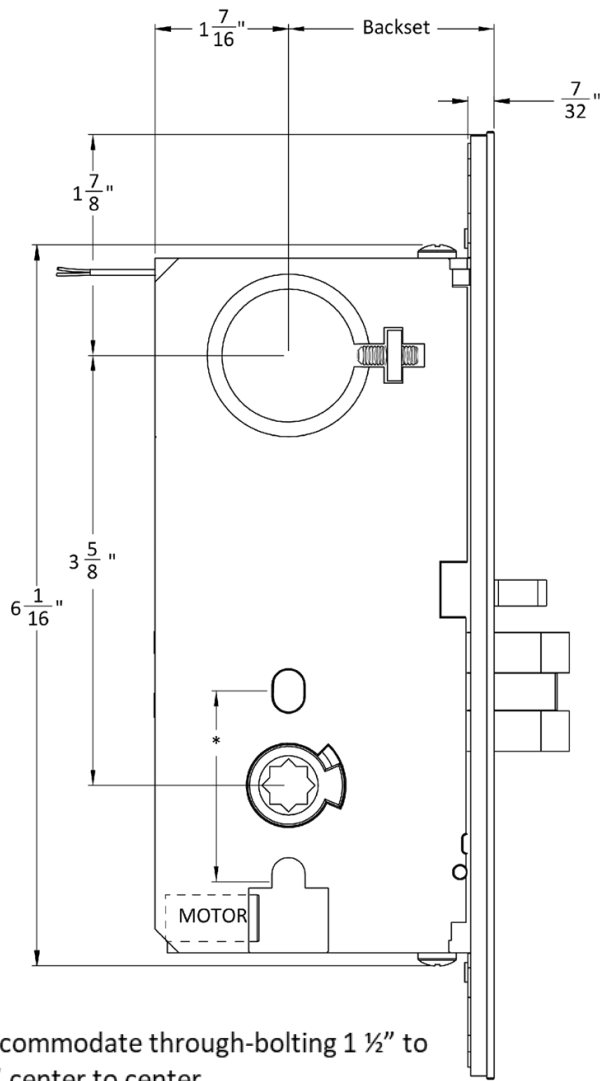

* To accommodate through-bolting $1\frac{1}{2}"$ to $1\frac{11}{16}"$ center to center

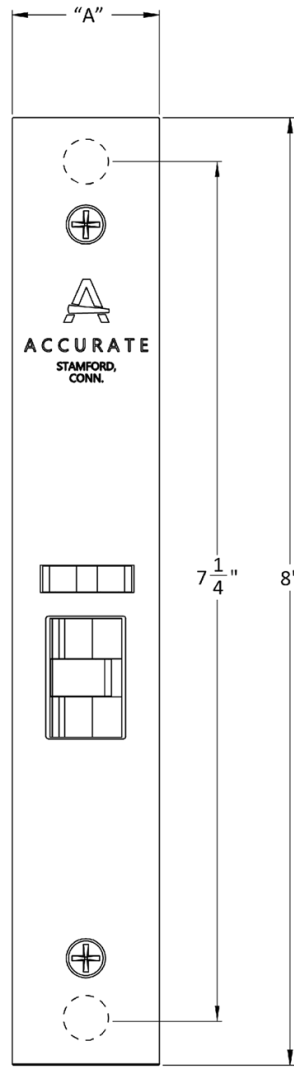

A:
 $1\frac{1}{4}"$ (8800 locks, for $1\frac{3}{4}"$ thick doors)
1" (8700 locks, for $1\frac{3}{8}"$ thick doors)

M8800E Functions

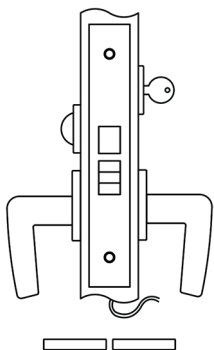

M8724E for doors 1³/₈" minimum
M8824E for doors 1¹/₂" minimum

Non-deadbolt secure allows user to enter home via credential even if deadbolt is thrown.

Deadbolt is MANUALLY projected/retracted by key outside or thumb turn inside.

When electronically unlocked, outside lever will simultaneously retract latch and deadbolt.

Inside lever always free, retracting latch and deadbolt simultaneously.

No auxiliary latch deadlock when deadbolt is retracted.

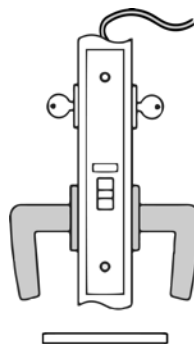

M8758E for doors 1³/₈" minimum
M8858E for doors 1¹/₂" minimum

Latch bolt by key either side.

Auxiliary latch deadlocks latch bolt.

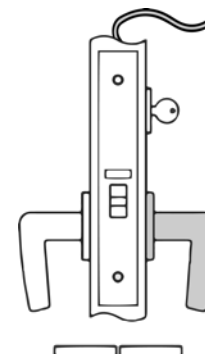

M8759E for doors 1³/₈" minimum
M8859E for doors 1¹/₂" minimum

Inside trim always free.

Latch bolt by key outside.

Auxiliary latch deadlocks latch bolt.

FAIL SECURE OPERATION*: Inside and outside trim unlocked when power is applied and locked when power is removed.

FAIL SAFE OPERATION: Inside and outside trim locked when power is applied and unlocked when power is removed. Lockset will unlock in the event of power failure.

**Lock is furnished as FAIL SECURE and can easily be changed to FAIL SAFE.*

M8800E Function/Backset

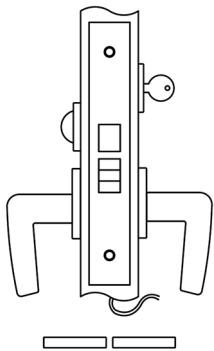

M8724E
M8824E

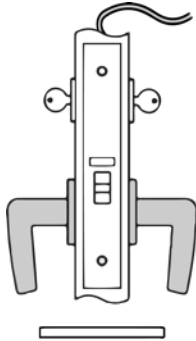

M8758E
M8858E

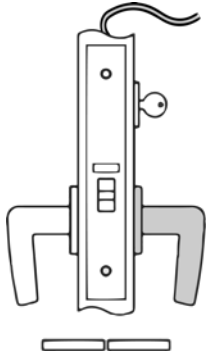

M8759E
M8859E

	M8724E/M8824E	M8758E/M8858E	M8759E/M8859E
1 ½"	X*	X*	X*
1 ¾"	X*	X	X
2"	X*	X	X
2 ¼"	X*	X	X

**CPU and capacitor are outside the lock (Image pg. 4).*

M8800E Technical Details

MONITORING FUNCTION

AE - AUTHORIZED EGRESS (or REQUEST TO EXIT, RX switch)

When specified, a mechanical switch monitors the use of the INSIDE trim when the OUTSIDE trim is locked

ELECTRICAL SPECIFICATIONS:

SPDT Mechanical switch

Voltage	Current
30 VDC	0.5 AMP

Lock is furnished as FAIL SECURE and can easily be changed to FAIL SAFE via the switch on the front. Cycle power once after switching from one function to the other.

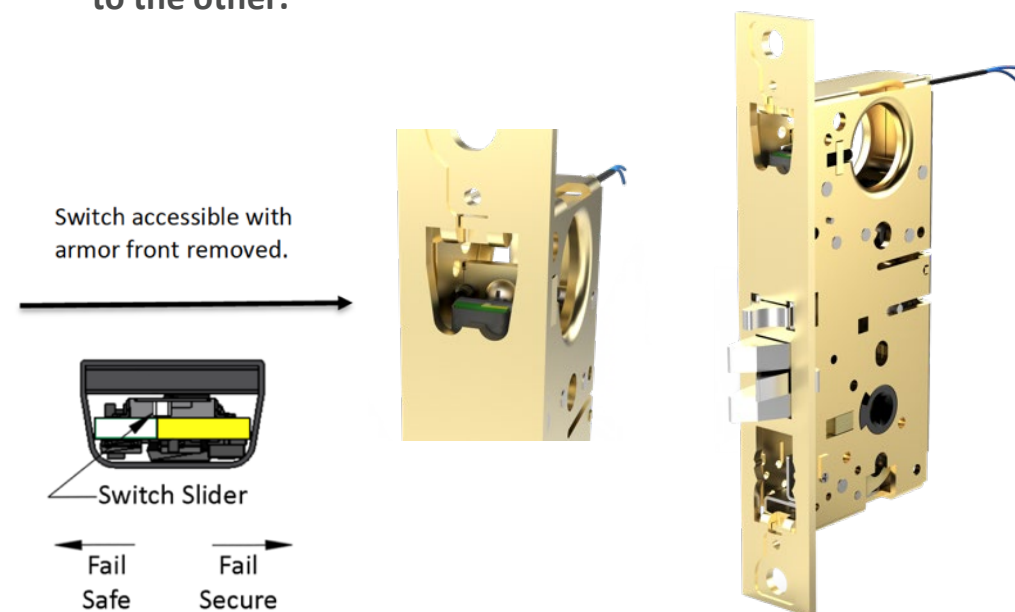

M8858E SHOWN

M8800E Trim Example



2R ROSE + 19L LEVER

ACCURATE TRIM

Specify Accurate levers, roses, escutcheons.

[Click or scan to see trim options.](#)

SCAN HERE



**Note: For compatibility with other manufacturers' trim please call for assistance.*

HOW TO SPECIFY

HANDING

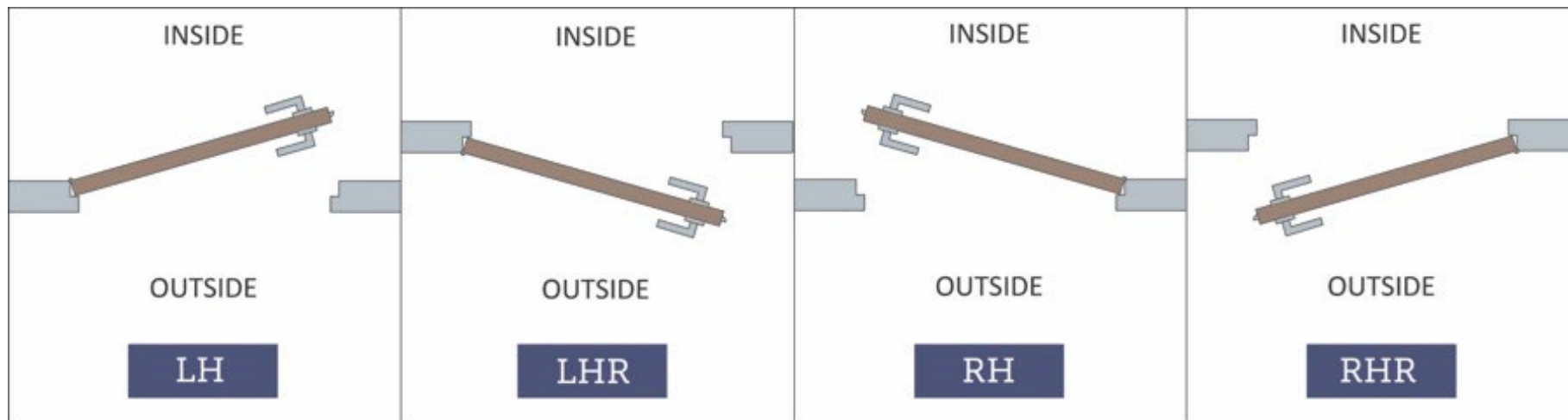

FINISHES

GROUP 1: US4, US4NL, US32D*, US26D

GROUP 2: US3, US3NL, US26, US32*, US9*, US10*, US10B, US14, US15, US19

GROUP 3: BN, BB, TN, TB, DURO, ESN, US15A, US5

* Trim options (including Accurate Levers) may not be available in US32D, US32, US9, or US10 finish. Please call for assistance.

To view example of finishes visit: [Accurate Finishes.](#)

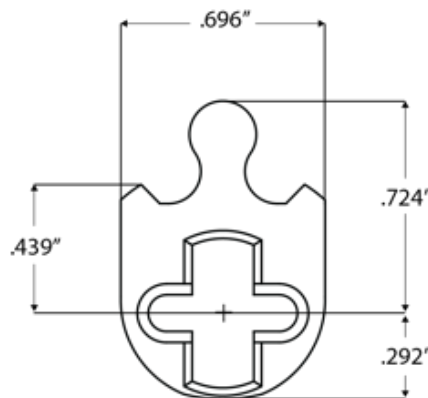

CYLINDERS & KEYING

M8800E Series locks accept any standard American mortise cylinder. For details on required cams and compatibility with other manufacturers' cylinders, please visit: [Accurate Support.](#)

HOW TO SPECIFY

FUNCTION-MONITOR.BACKSET.TRIM.FINISH.HAND.DOORTHICKNESS

Functions

See available functions (pg. 7)

Backset

1 ½", 1 ¾", 2", 2 ¼"

Trim

Accurate trim

or specify other trim manufacturers or spindle size

Finishes

See available finishes (pg. 11)

EXAMPLES

Narrow Backset Electrified Lock | Authorized Egress | Accurate Trim

E.g.: M8759E-AE.2.29L/2R.US26D.RH.138

Narrow Backset Electrified Lock | Other Manufacturers' Trim*

E.g.: M8824E.134.7mm.US3NL.LH.134

Narrow Backset Electrified Lock | UL Listed | Accurate Trim

E.g.: M8759E-UL.2.19L/1R.US19.RH.138

*Note: For compatibility with other manufacturers' trim please call for assistance.

NOTES

FURNISHED STANDARD WITH ANTI-FRICTION LATCH BOLT (solid latch bolt available, special order).

Special Options:

- Specify: M8800E-UL for fire-rated applications (¾" Latch bolt throw)
- SS-Security Strikes
- USD K x K Upside Down (cylinder/thumb turn below knobs)
 - *UL version not available for USD configuration*
- USD L x L Upside Down (cylinder/thumb turn below levers)
 - *UL version not available for USD configuration*
- SilentPac™ Lever Dampening Disc
 - *Not available with 2R/4R roses*

*1 ½" Backset only available for M8858E & M8859E

**ACCURATE LOCK & HARDWARE
MANUFACTURERS OF LOCKS AND
CUSTOM ARCHITECTURAL HARDWARE**

1 Annie Place | Stamford, CT 06902

P: 203.348.8865

F: 203.348.5234

E: sales@accuratelockandhardware.com

www.accuratelockandhardware.com

