



ACCURATE

LOCK & HARDWARE

AMERICAN CRAFTED SINCE 1972

T2200 TUBULAR LATCH

PREMIUM QUALITY, REIMAGINED TECHNOLOGY

TUBULAR LATCH

T2200

Accurate's Tubular Latch combines the simplicity of tubular design with a variety of premium upgrades to make it the most durable and feature-rich product in its class.

Including:

- Stainless steel construction
- Field adjustable hub orientation to prevent lever tilt
- Adjustable latch projection
- Removable latch bolt to conveniently complement faceplate finish
- Removable faceplate allows for finish flexibility

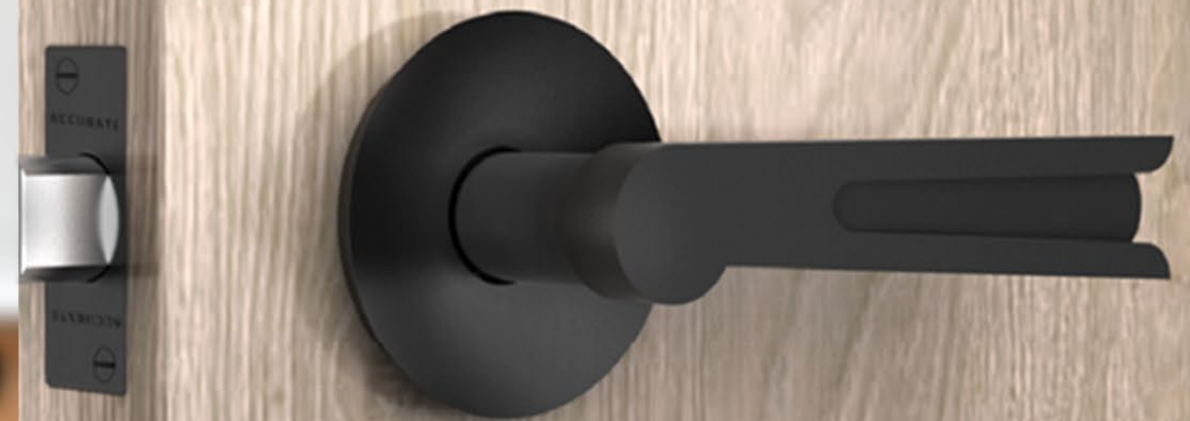

TUBULAR LATCH PAIRED WITH THOM FILICIA FOR
ACCURATE GRANBY LEVER IN US19

T2200 Tubular Latch: Technical Details



BACKSET: $2\frac{3}{8}$ ", $2\frac{3}{4}$ " standard

CASE: Heavy gauge, stainless steel

FRONT: Brass, bronze, aluminum or stainless steel, finished as required.
Field removable faceplate, swivel front for bevel or flat doors.

LATCH BOLT: Brass, stainless steel or plastic (for quiet option).

THROW: Standard $\frac{1}{2}$ " throw. Projection can be increased up to $\frac{1}{8}$ " in the field to help accommodate a larger gap.

STRIKE: T-Strike.

HUBS: Field adjustable. 3° up or 3° down to compensate for lever pitch tilt.*

DUST BOX: Brass, stainless steel or oil rubbed bronze

**Hub sizes available to fit most decorative hardware brands.*

T2200 Tubular Latch Functions

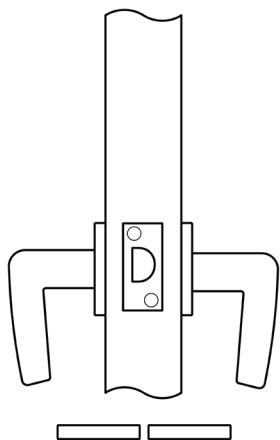

T2225/T2225 PASSAGE

Latch bolt by lever either side.

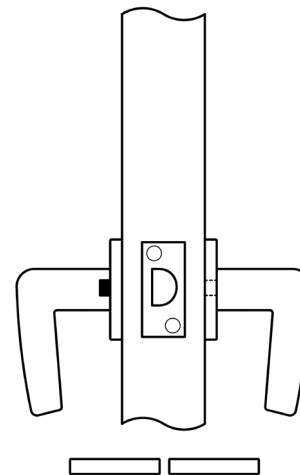

T2239 PRIVACY BEDROOM/BATHROOM

Latch bolt by lever either side except when outside lever is locked by inside push pin.

Operating inside lever or outside emergency release unlocks outside lever.

Closing door will retract latch and unlock outside lever.

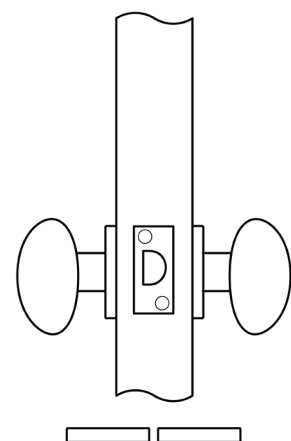

T2225 PASSAGE

Latch bolt by knob either side.

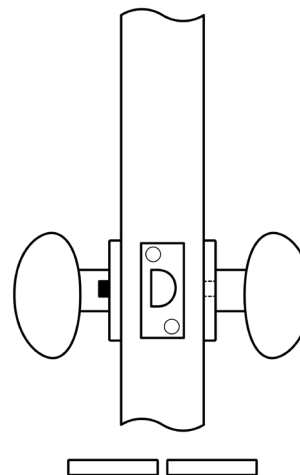

T2239 PRIVACY BEDROOM/BATHROOM

Latch bolt by knob either side except when outside knob is locked by inside push pin.

Operating inside knob or outside emergency release unlocks outside knob.

Closing door will retract latch and unlock outside knob.

T2200 Tubular Latch Dimensions | 2-3/8" Backset

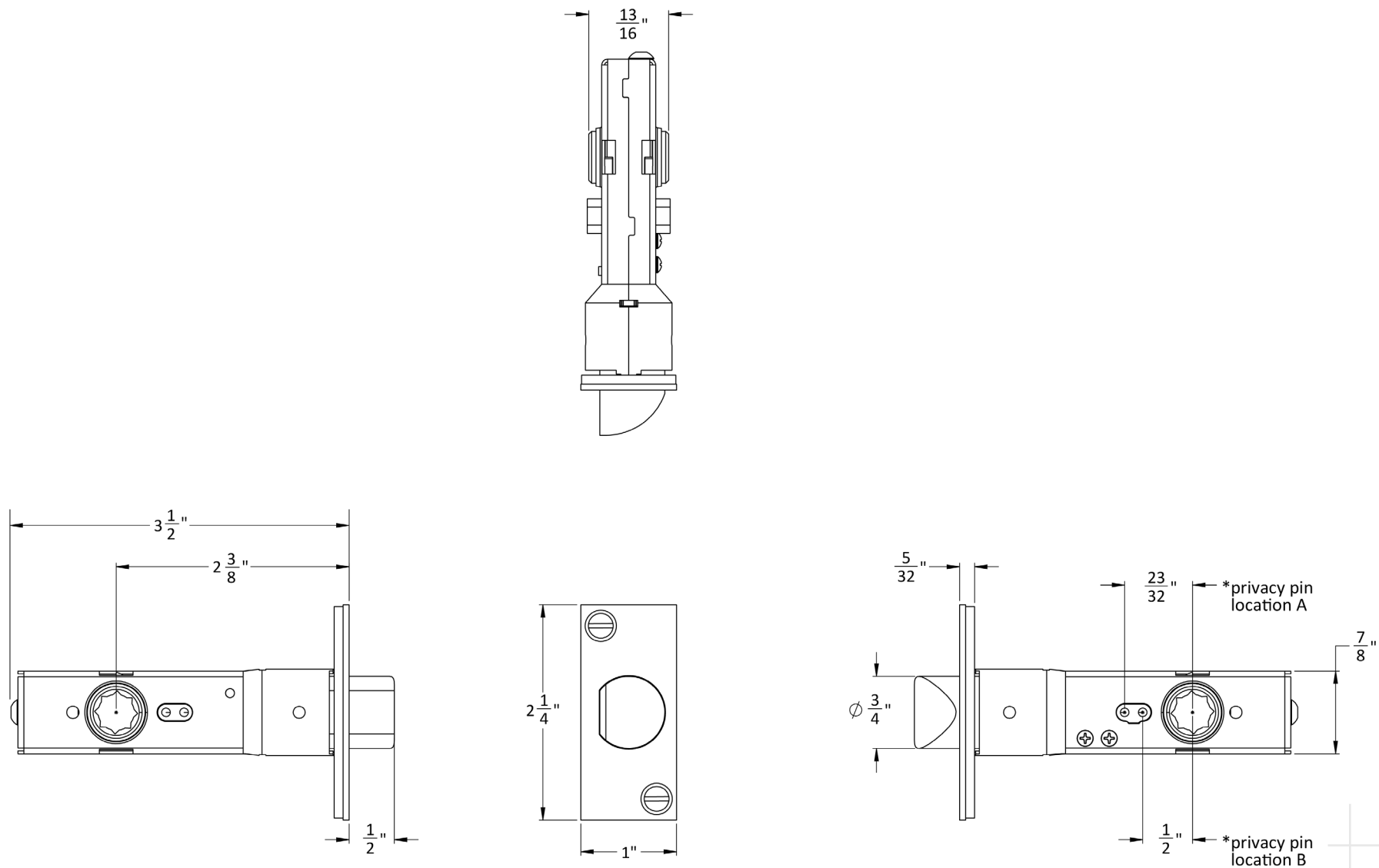

T2200 Tubular Latch Dimensions | 2-3/4" Backset

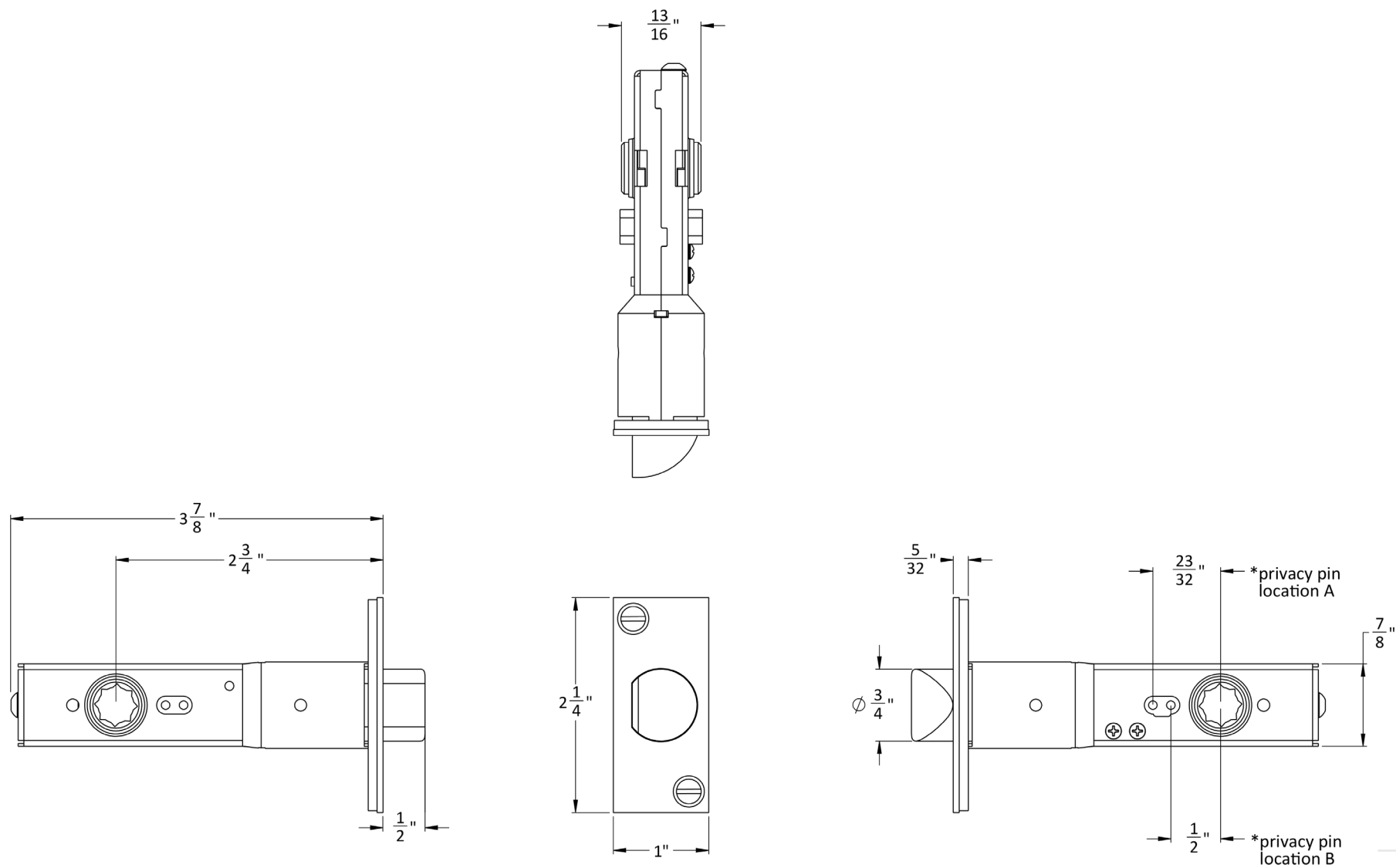

HOW TO SPECIFY

HANDING

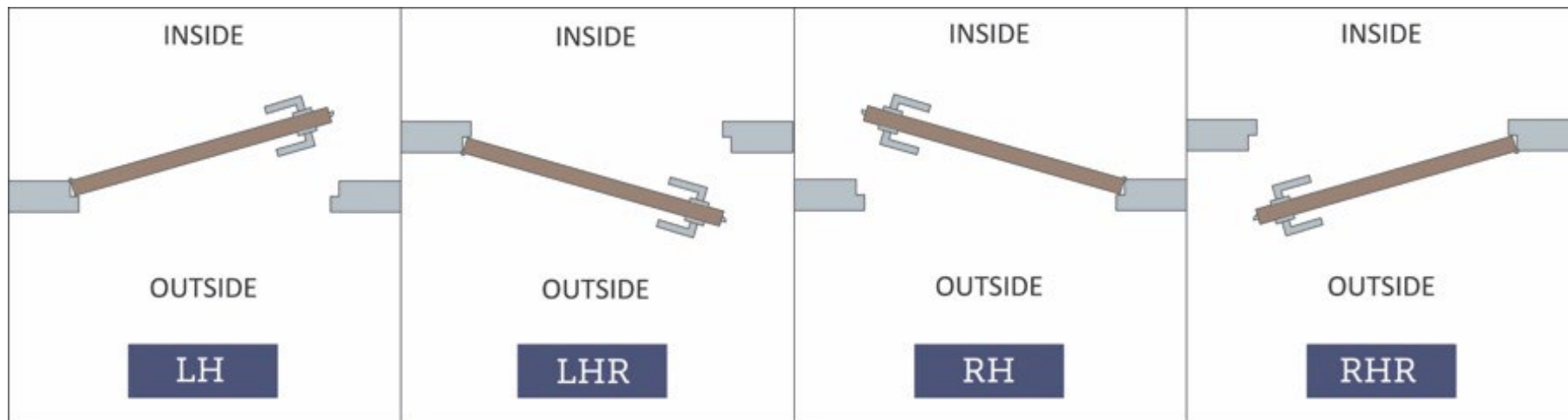

FINISHES

GROUP 1: US4, US4NL, US32D*, US26D

GROUP 2: US3, US3NL, US26, US32*, US9*, US10*, US10B, US14, US15, US19

GROUP 3: BN, BB, TN, TB, DURO, ESN, US15A, US5

* Trim options (including Accurate Levers) may not be available in US32D, US32, US9, or US10 finish. Please call for assistance.

To view example of finishes visit: [Accurate Finishes](#).

HOW TO SPECIFY

FUNCTION.**BACKSET**.**TRIM**.**FINISH**.**HAND**.DOOR**THICKNESS**

BACKSET

2³/₈" or 2³/₄"

TRIM

Knob by Knob (KxK)
Lever by Lever (LxL)
Specify trim brand
or hub size

FINISHES

See available finishes (pg.7)

DOOR THICKNESS

1 ³/₈ "
1 ³/₄ "
2"
2 ¹/₄ "

EXAMPLES

Tubular Latch | Passage | Accurate Lever Trim

E.g.: T2225.**238**.T-19L/T-1R.**US4**.RH.134

Tubular Latch | Passage | Other Manufacturers' Knob Trim

E.g.: T2225.**234**.KxK.8mm.**US19**.RH.134

Tubular Latch | Privacy | Accurate Lever Trim

E.g.: T2239.**238**.T-21L/T-2R.**US10B**.LH.138

Tubular Latch | Privacy | Other Manufacturers' Knob Trim

E.g.: T2239.**238**.KxK.8mm.**US3NL**.LH.214

NOTES

- For other manufacturers' trim, specify push pin position for privacy functions, call for compatibility.
- Accurate trim available for use with tubular lock, specify T-XXL, or T-XR (e.g. T-19L, T-1R)

ACCURATE LOCK & HARDWARE MANUFACTURERS OF LOCKS AND CUSTOM ARCHITECTURAL HARDWARE

1 Annie Place | Stamford, CT 06902

P: 203.348.8865

F: 203.348.5234

E: sales@accuratelockandhardware.com

www.accuratelockandhardware.com



AMERICAN CRAFTSMAN
— SINCE 1972 —