

SPiit 431

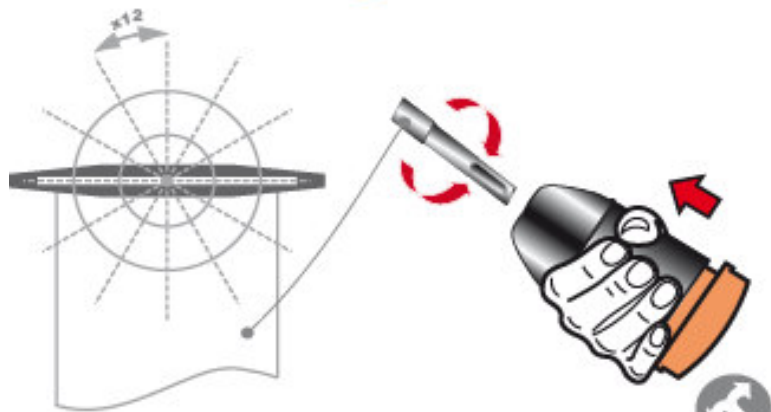

	SDS-plus
	$L_{wA} = 105 \text{ dB(A)}$ $L_{pA} = 94 \text{ dB(A)}$ $K = 3 \text{ dB(A)}$
	$a_h = 16 \text{ m/s}^2$ $k = 2 \text{ m/s}^2$ EN 60 745
	4,3 Joules 0-3500 min ⁻¹
	3,6 kg
	220 - 240 V 50 / 60 Hz
	650 W

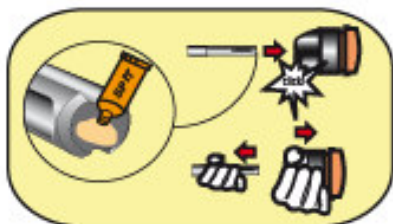

1 619 929 709 - Ind A