

SPIELPLATZ FLAPPI

(370 x 303 x h272cm)

003_03435_13122017

MONTAGEANLEITUNG

Garantiezeit - 2 Jahre ab Kaufdatum

Période de garantie - 2 ans à compter de l'achat



AIRE DE JEUX FLAPPI

(370 x 303 x h272cm)

003_03435_13122017

GUIDE D'INSTALLATION

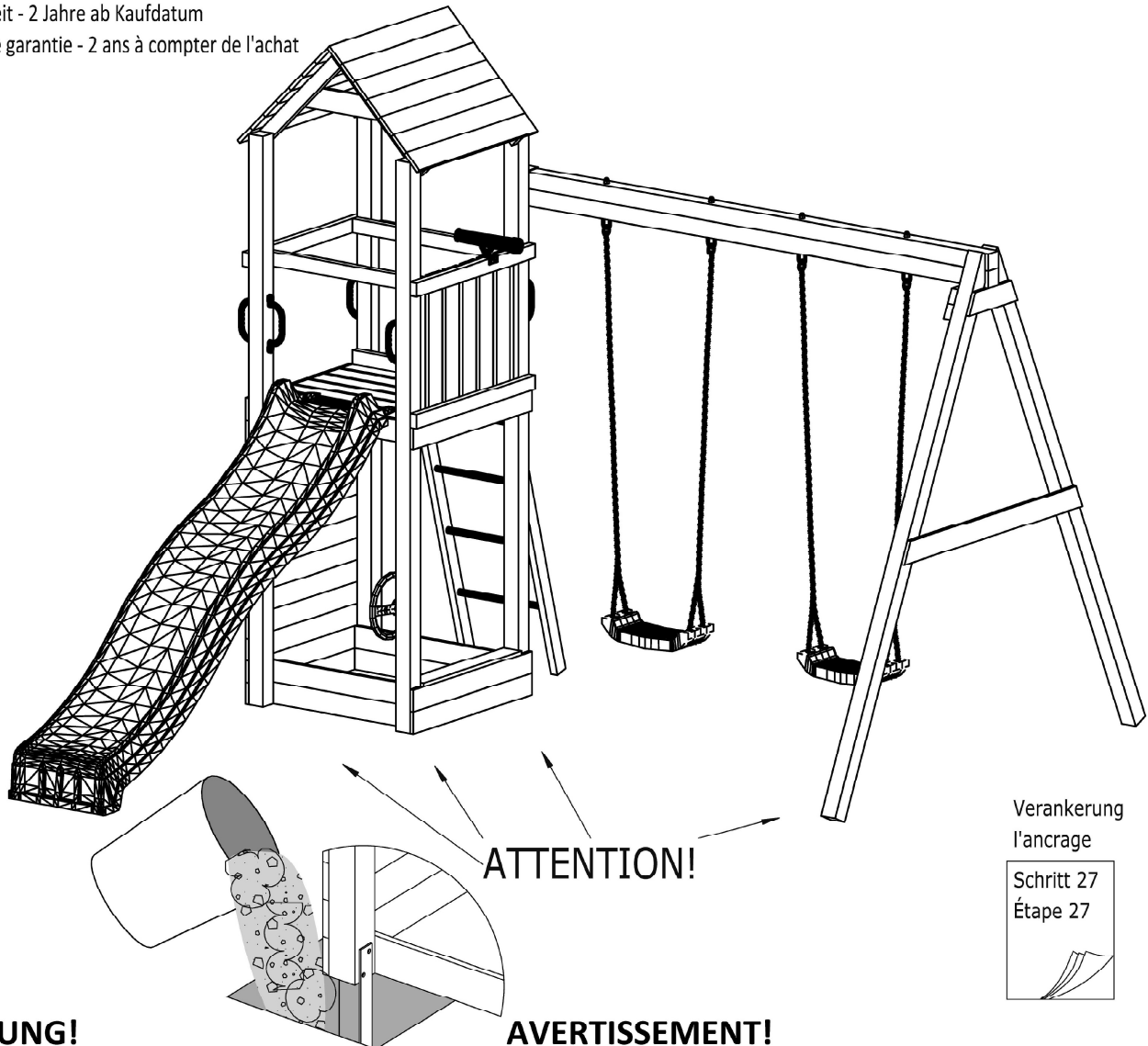

Verankerung
l'ancrage

Schritt 27
Étape 27

ACHTUNG!

Nur für den privaten, häuslichen Bereich.
Ausschließlich für die Verwendung im Freien.
Nicht geeignet für Kinder unter 3 Jahren.
Stolper- und / oder Sturzgefahr
Höchstgewicht pro Einzelkind beträgt 50 kg
Der Aufenthalt auf diesem Spielturn ist max. : 6.
Kindern gleichzeitig erlaubt.

AVERTISSEMENT!

Aire exclusivement destinée à un usage privé.
Aire exclusivement destinée à un usage en extérieur.
Prévue pour les enfants de plus de 3 ans.
Danger de chute ou de choc.
Poids maximal d'un utilisateur : 50 kg.
Nombre maximal d'utilisateurs présents en
même temps sur la même aire de jeux: 6.

CE
EN 71

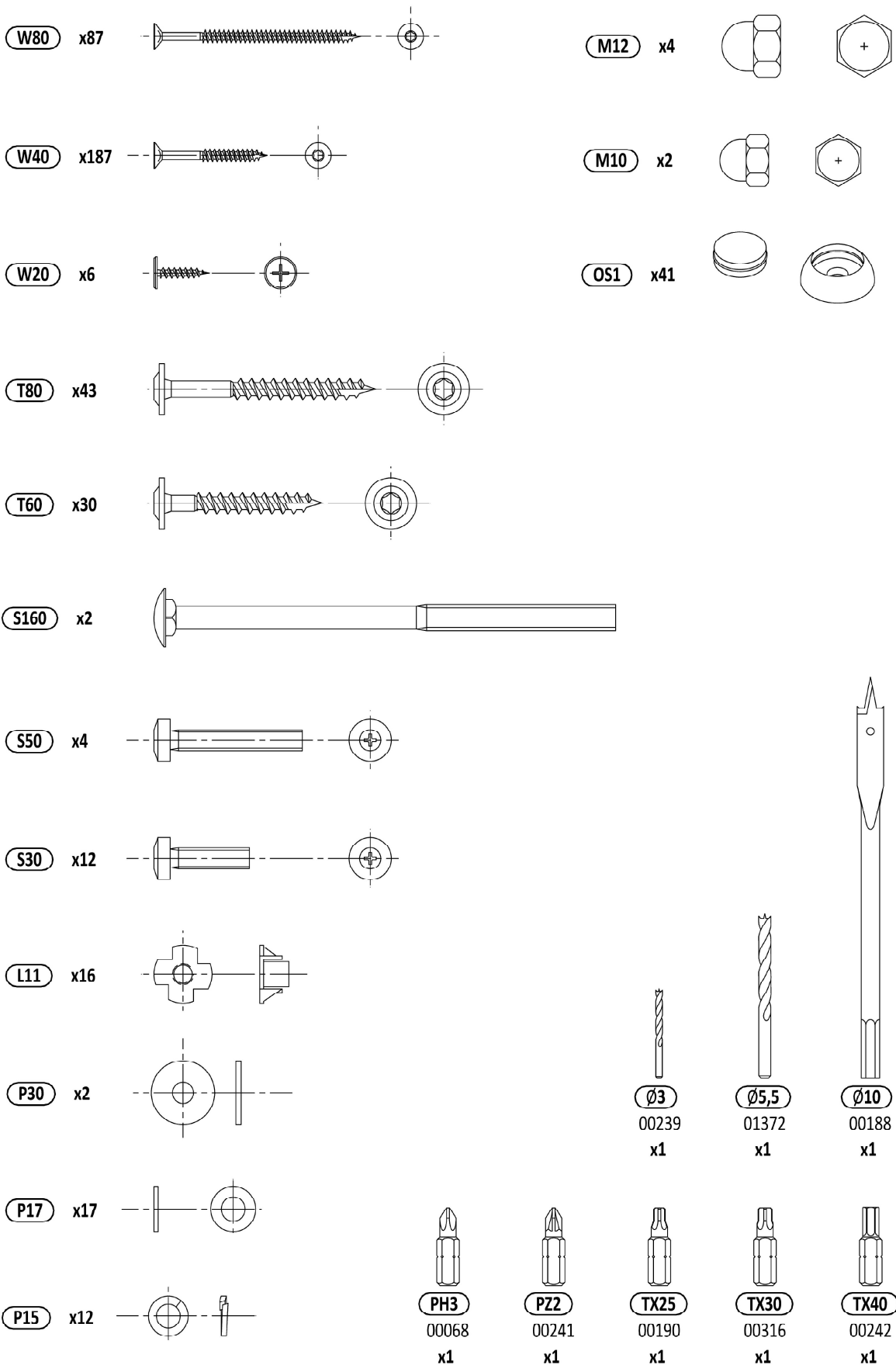

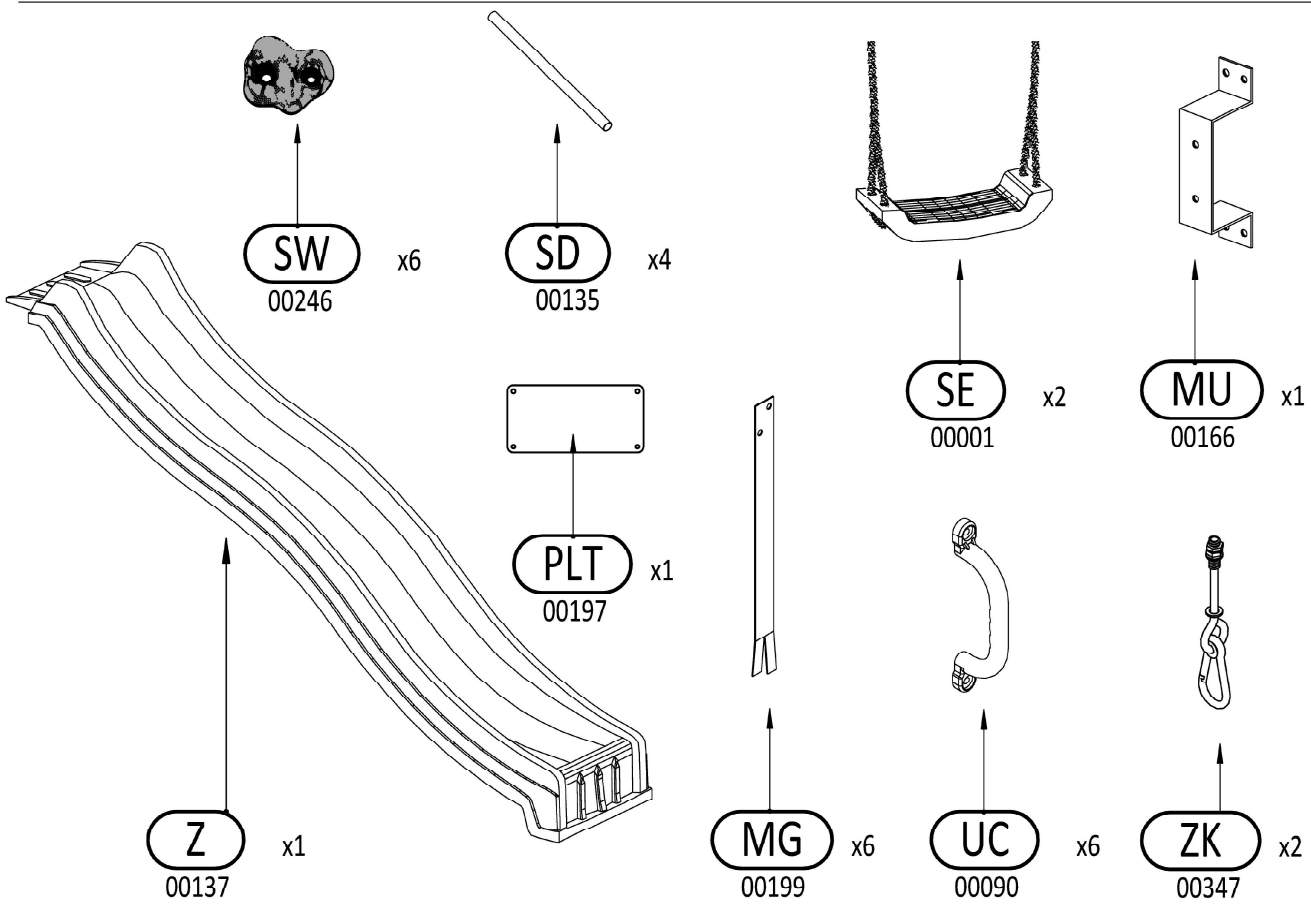
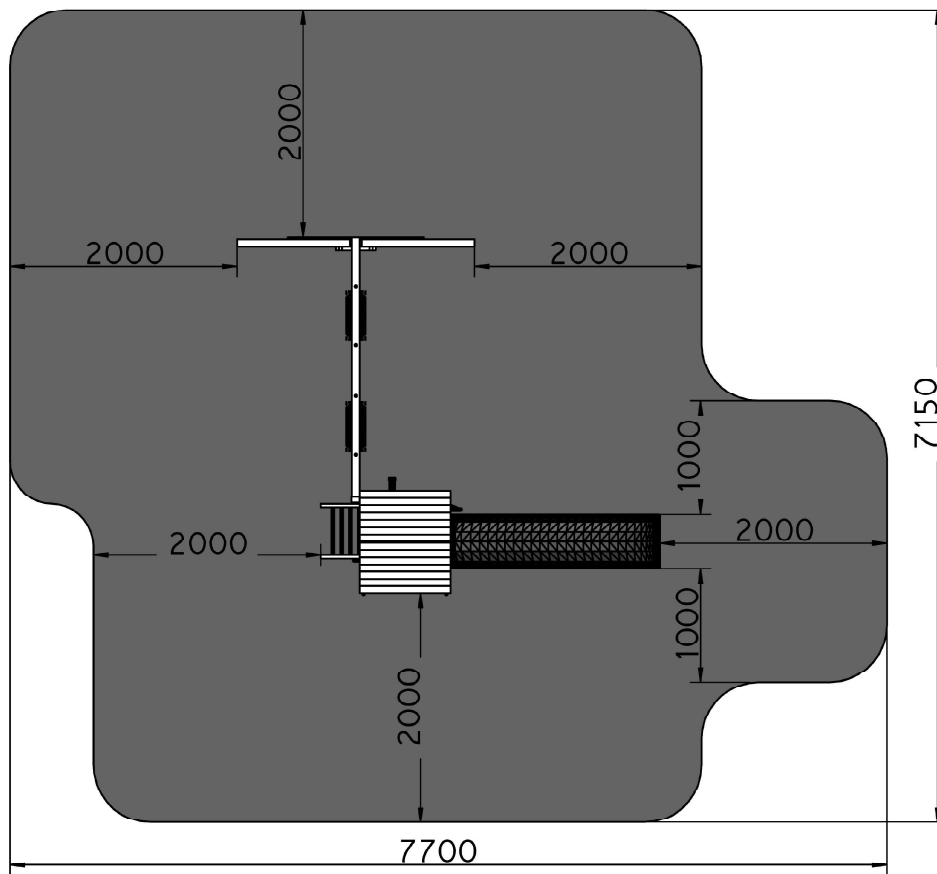

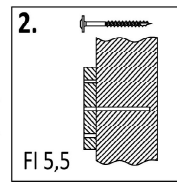
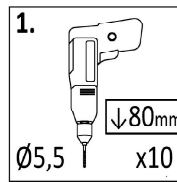
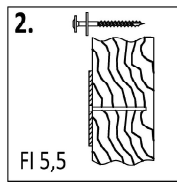
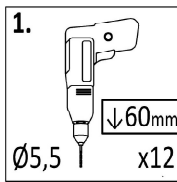
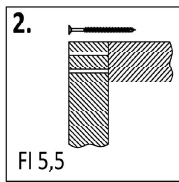
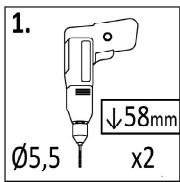
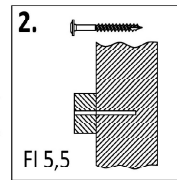
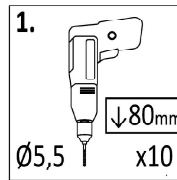
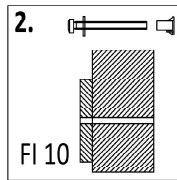
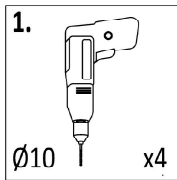
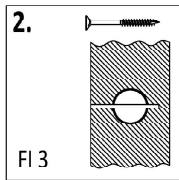
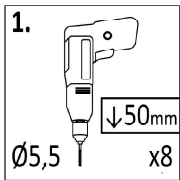
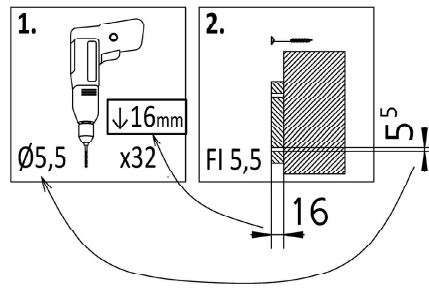
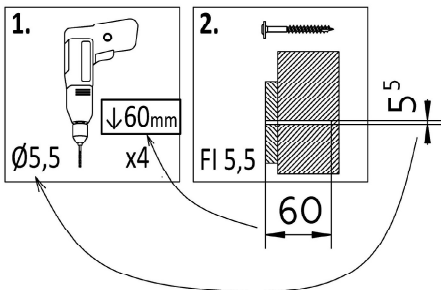
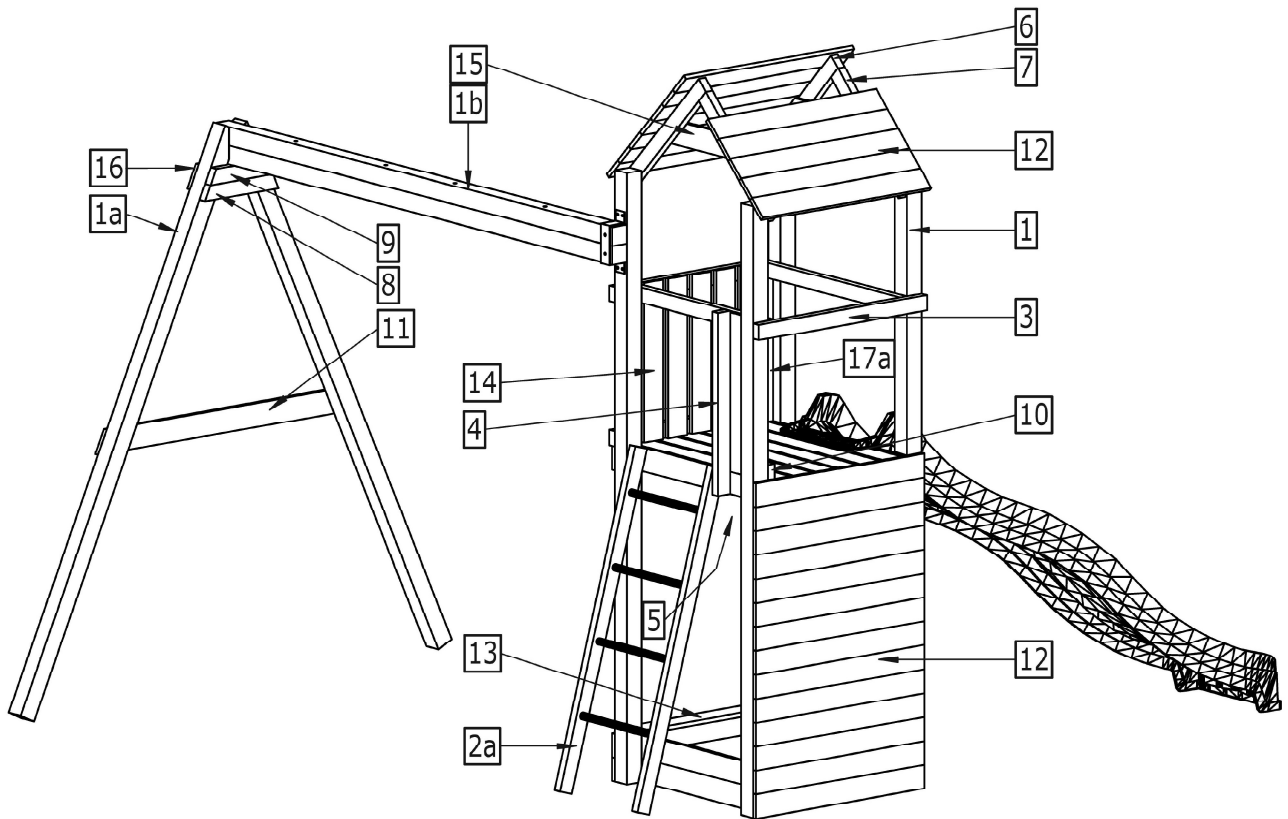

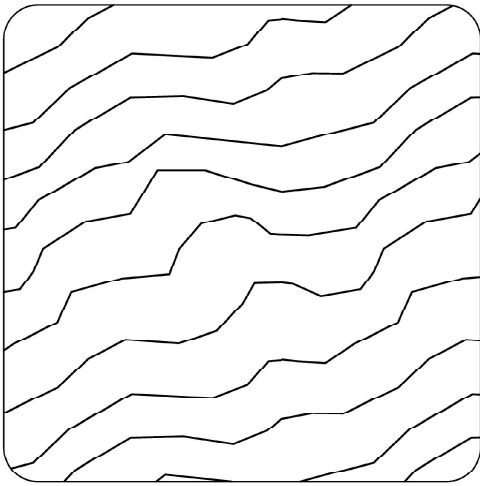

7 x 7 cm

Lp.	Wymiary [mm]	szt.
1	70x70x2300mm	4
1a	70x70x2300mm	2
1b	70x70x2300mm	2

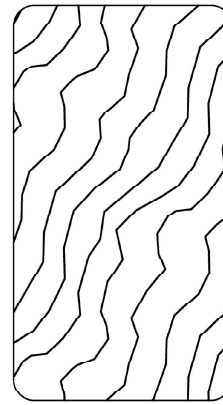

3,2 x 5,8 cm

Lp.	Wymiary [mm]	szt.
2a	32x58x1300mm	2
3	32x58x800mm	5
4	32x58x690mm	1
5	32x58x628mm	3
6	32x58x610mm	2
7	32x58x550mm	2
8a	32x58x350mm	1
9a	32x58x296mm	1
10	32x58x250mm	1

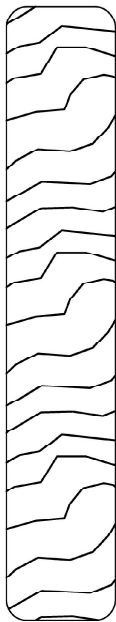

1,6 x 9,0 cm

Lp.	Wymiary [mm]	szt.
11a	16x90x1200mm	1
12	16x90x800mm	43
13	16x90x660mm	1
14	16x90x600mm	6
15a	16x90x560mm	2
16a	16x90x326mm	1

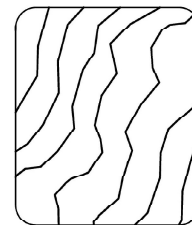

2,7 x 3,2 cm

Lp.	Wymiary [mm]	szt.
17a	27x32x542mm	2

01

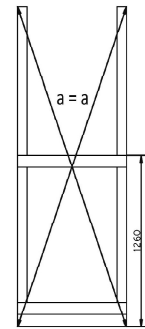
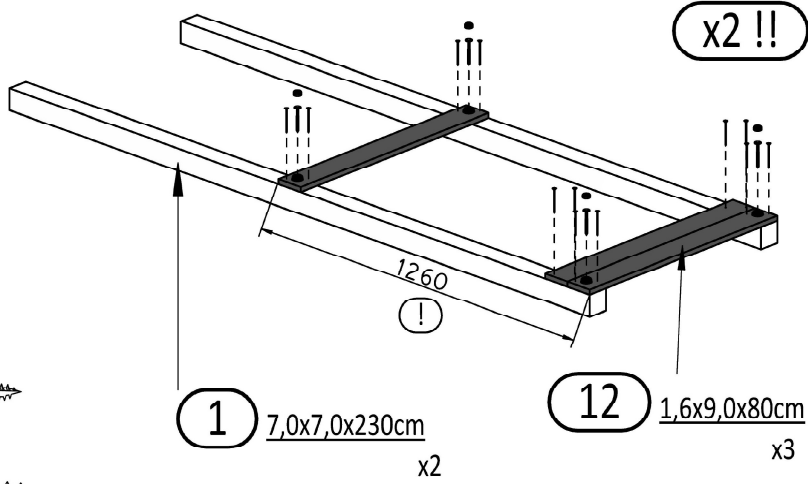
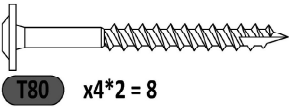
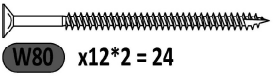
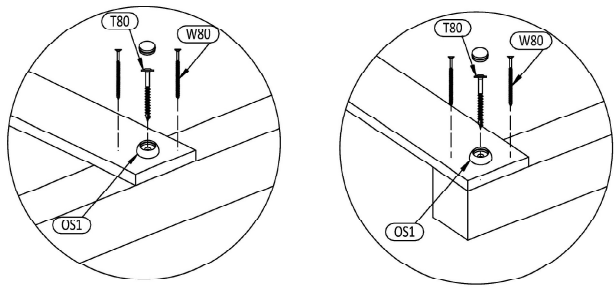
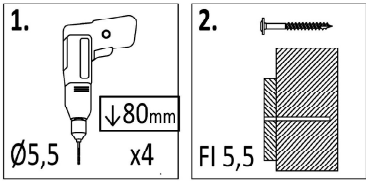

02

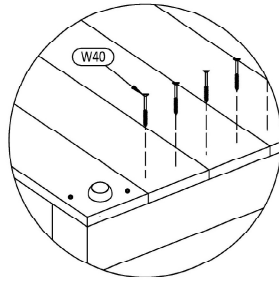
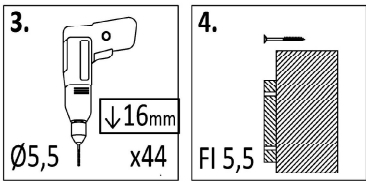

12 1,6x9,0x80cm x11

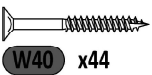
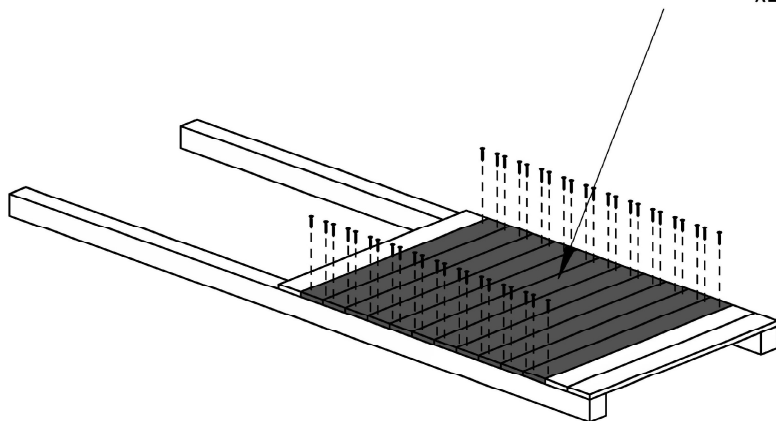

6 FLAPPI

Zgodnie z normą PN-EN 71 stosuj zalecenia producenta odnośnie odległości oraz metody mocowania poszczególnych elementów
In compliance with the standard PN-EN 71, apply guidelines of the producer in relation to distances and methods of fastening individual elements

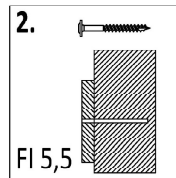
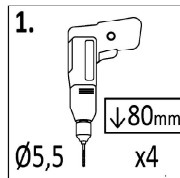
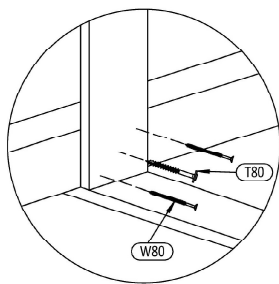

03

12 1,6x9,0x80cm
 x6

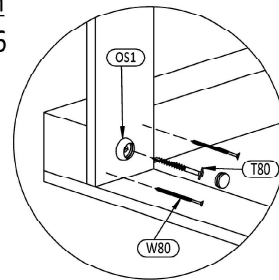
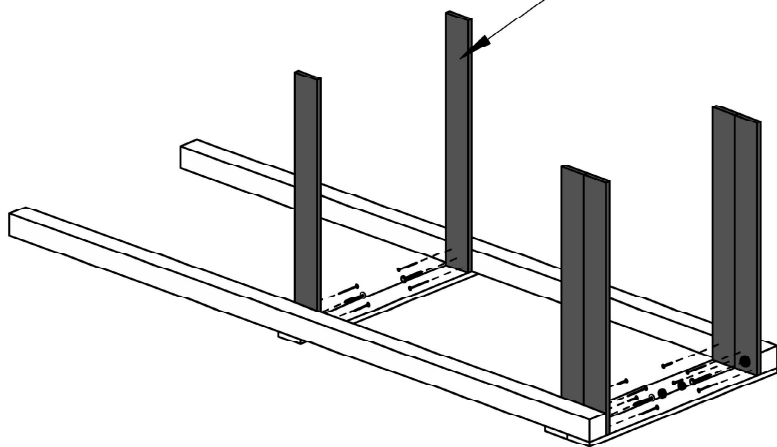

OS1 x2



W80 x12

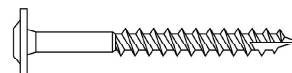

T80 x4

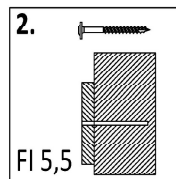
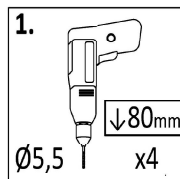
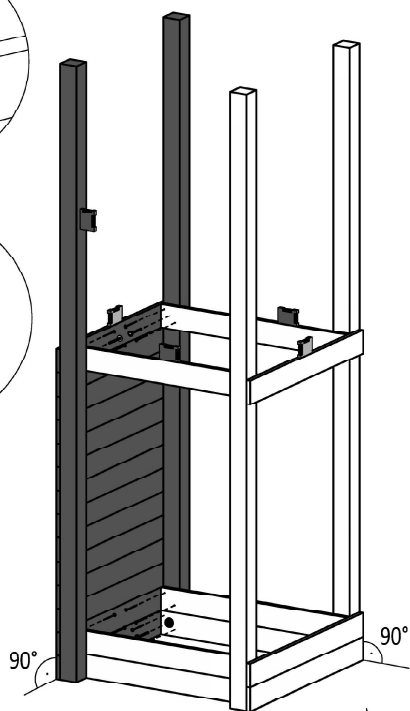
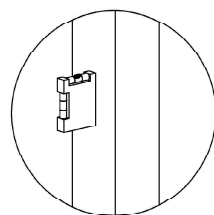
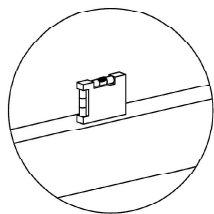

04

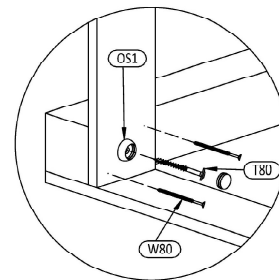
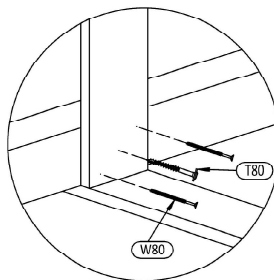

OS1 x2



W80 x12



T80 x4

ATTENTION!

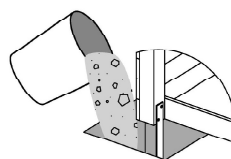

Zgodnie z normą PN-EN 71 stosuj zalecenia producenta odnośnie odległości oraz metody mocowania poszczególnych elementów
 In compliance with the standard PN-EN 71, apply guidelines of the producer in relation to distances and methods of fastening individual elements

05

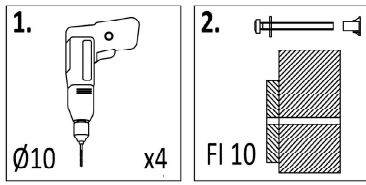

5 3,2x5,8x62,8cm
x2



OS1 x4



W40 x4

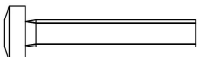

S50 x4



P17 x4



L11 x4

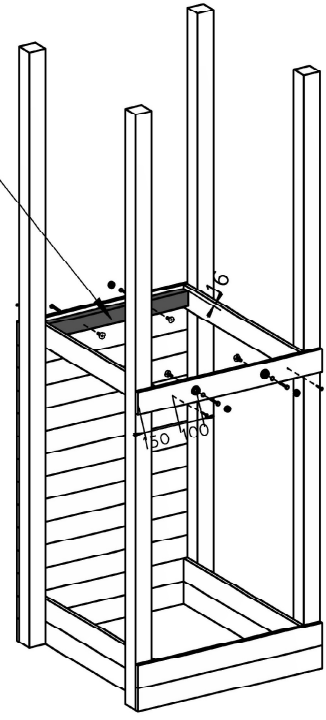
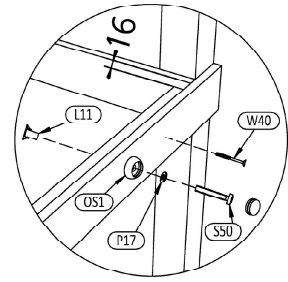

06

5 3,2x5,8x62,8cm
x1

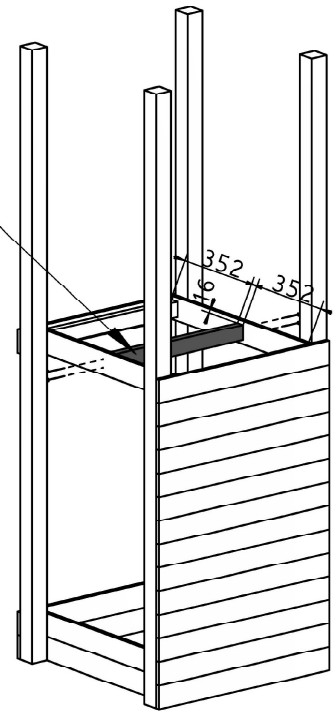
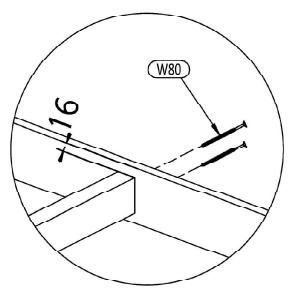

W80 x4

8 FLAPPI

Zgodnie z normą PN-EN 71 stosuj zalecenia producenta odnośnie odległości oraz metody mocowania poszczególnych elementów
In compliance with the standard PN-EN 71, apply guidelines of the producer in relation to distances and methods of fastening individual elements

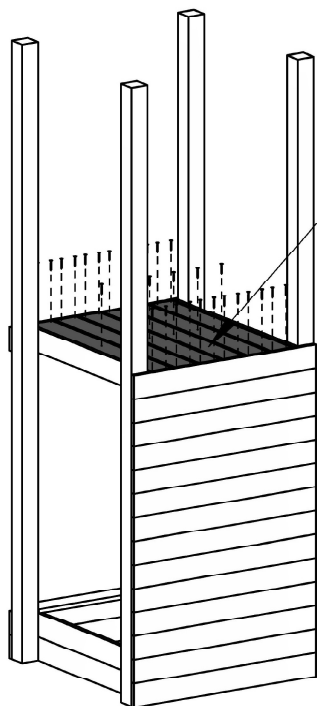
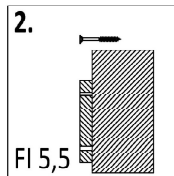
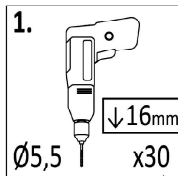

12 $1,6 \times 9,0 \times 80\text{cm}$
x6

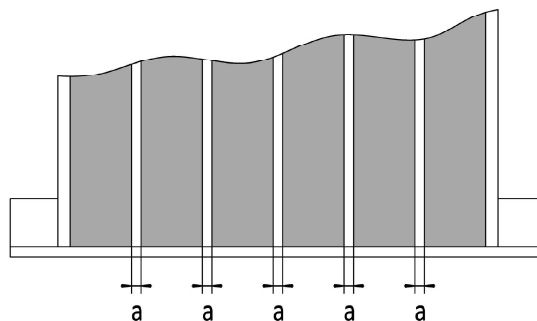

!!!min 13mm < a < !!!max 18mm

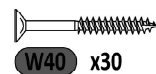

3 $3,2 \times 5,8 \times 80\text{cm}$

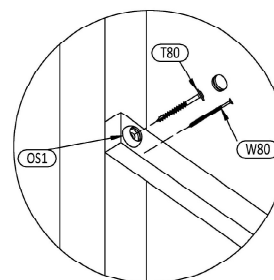
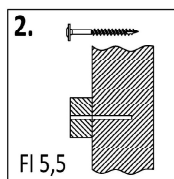
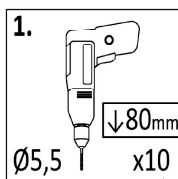
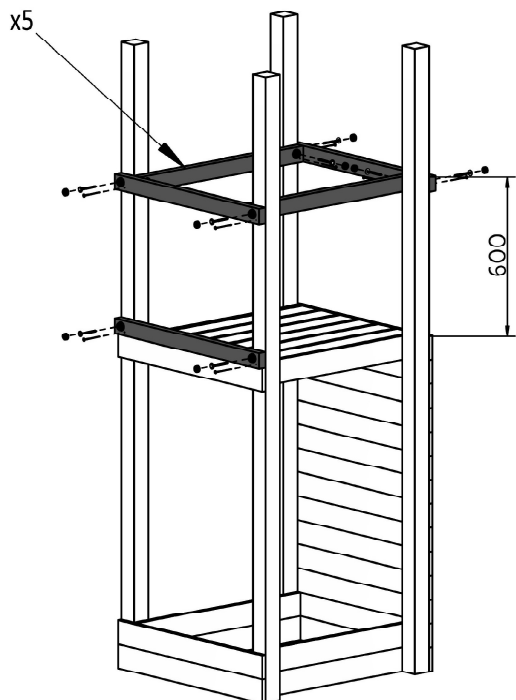

OS1 x10

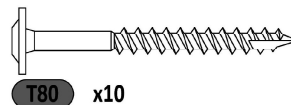

09

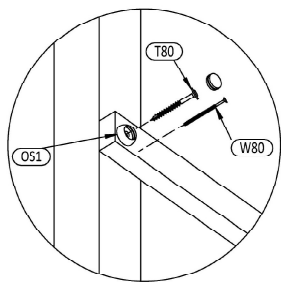
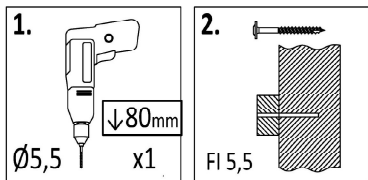

10 3,2x5,8x25cm
x1

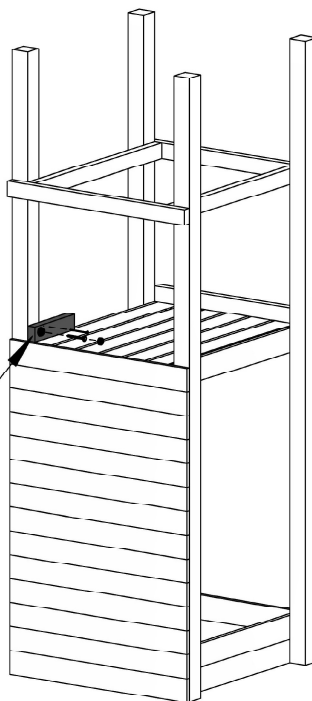

OS1 x1



W80 x1

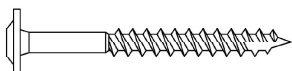

T80 x1

10

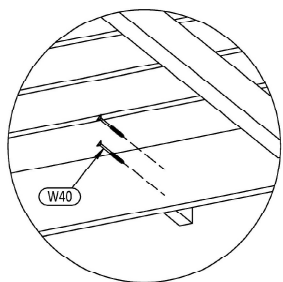
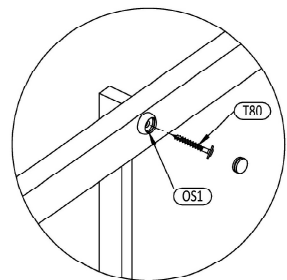
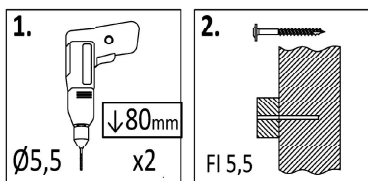

4 3,2x5,8x69cm
x1

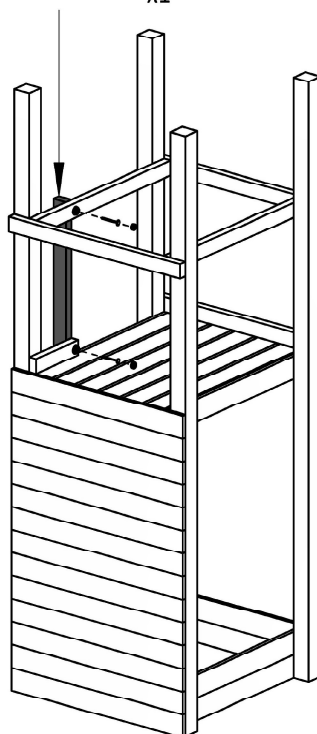

OS1 x2



W40 x2



T80 x2

10 FLAPPI

Zgodnie z normą PN-EN 71 stosuj zalecenia producenta odnośnie odległości oraz metody mocowania poszczególnych elementów
In compliance with the standard PN-EN 71, apply guidelines of the producer in relation to distances and methods of fastening individual elements