



flue gas temperature controller RTC 80

Part no. 63833

flue gas temperature controller

Application

Flue gas temperature controller RTC for gas and oil-fired systems

Technical Specifications

Nominal size

80

measuring element

Bimetal helix

accuracy class

2 (EN 13190)

Range

0/350 °C

application area

Full scale value

Connection

Stem: Stainless steel 316 L
plain, with magnetic ring holder

mounting position

centre back

Dial

Aluminium, grey
Scaling: black
with green and red reference zones

Pointer

Aluminium, black
with additional maximum pointer, red

Housing

Sheet steel, galvanised

push on bezel

Sheet steel, nickel-plated

window

Plastic

Technical Drawings

Centre back connection

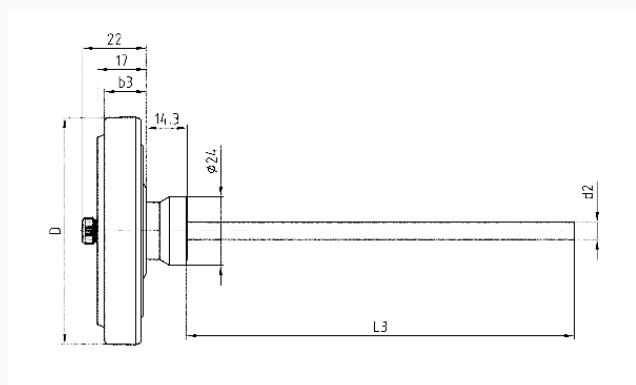

Dimensions (mm)

NG	b3	D	d2	L3
80	15	80	6	86
80	15	80	6	136

Versions

Type	housing \varnothing	Range	Type	Type	Part no.
RTC 80	80 mm	0/350 °C	RTC 80	<input checked="" type="radio"/>	63833

- in-stock items
- Non-stock items