



## flue gas temperature controller RTC 80

Part no. 63832

flue gas temperature controller

### Application

Flue gas temperature controller RTC for gas and oil-fired systems

### Technical Specifications

**Nominal size**

80

**measuring element**

Bimetal helix

**accuracy class**

2 (EN 13190)

**Range**

0/350 °C

**application area**

Full scale value

**Connection**

Stem: Stainless steel 316 L  
plain, with magnetic ring holder

**mounting position**

centre back

**Dial**

Aluminium, grey  
Scaling: black  
with green and red reference zones

**Pointer**

Aluminium, black  
with additional maximum pointer, red

**Housing**

Sheet steel, galvanised

**push on bezel**

Sheet steel, nickel-plated

**window**

Plastic

## Technical Drawings

### Centre back connection

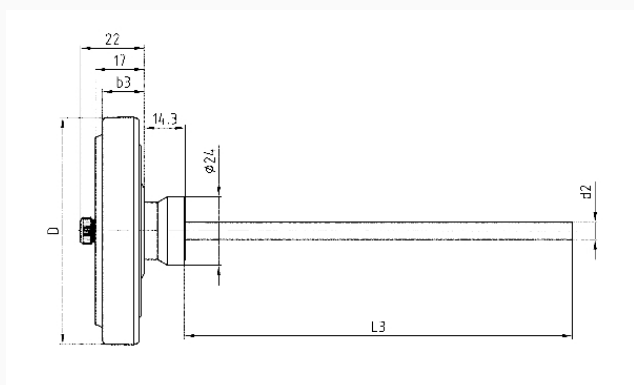

### Dimensions (mm)

NG	b3	D	d2	L3
80	15	80	6	86
80	15	80	6	136

## Versions

Type	housing ø	Range	Type	Type	Part no.
RTC 80	80 mm	0/350 °C	RTC 80	<input checked="" type="radio"/>	63832

- in-stock items
- Non-stock items