



Stonedge
COLLECTION

Röcka

DESCRIPTION: Wall & edge double-sided **TEXTURE:** Natural stone (Fossil stone)

PALLET OVERVIEW - ROW 1

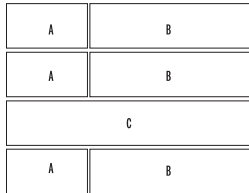

PALLET OVERVIEW - ROW 2

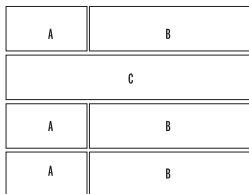

PALLET OVERVIEW - ROW 3

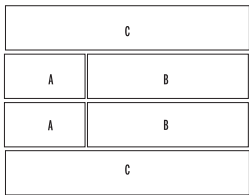

Specifications per pallet	Imperial	Metric
Cubing	19.88 ft ²	1.85 m ²
Weight	1 860 lbs	844 kg
Number of rows	3	
Coverage per row	6.63 ft ²	0.62 m ²
Coverage per unit	A 0.55 ft ²	0.05 m ²
	B 1.10 ft ²	0.10 m ²
	B 1.66 ft ²	0.15 m ²



Unit dimensions	in	mm	Units/pallet
A			8 units
Height	6	152	
Depth 1	7 3/4	197	
Depth 2	8	203	
Length	13 1/4	337	



B



B			8 units
Height	6	152	
Depth 1	7 3/4	197	
Depth 2	8	203	
Length	26 1/2	673	

C



C			4 units
Height	6	152	
Depth 1	7 3/4	197	
Depth 2	8	203	
Length	39 3/4	1 010	



NOTES

* For an authentic look, each color option is composed of a variety of darker & lighter tones. Natural ingredients such as granite are present within the recipe to allow for a range in tones, veining and textures from one stone to another.

See page 97 to 118 for more technical information.

The dimensional tolerance for Stonedge wet cast retaining wall units is: $\pm 3/16"$ (5 mm) for height and $\pm 1/2"$ (13 mm) for length and width. During the installation, the level between adjacent wall units will vary (usually more than for a dry cast wall unit) in order to obtain a more realistic appearance of a natural stone wall.

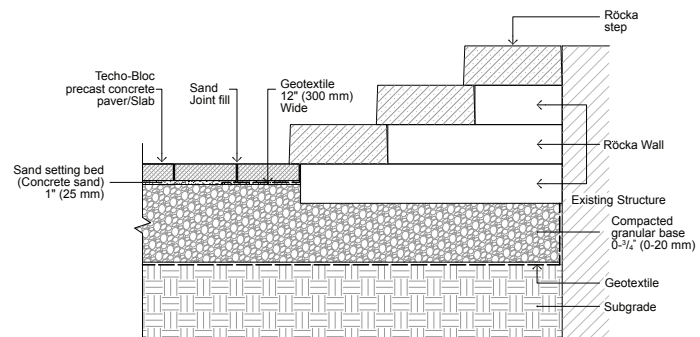

01 | Linear pattern

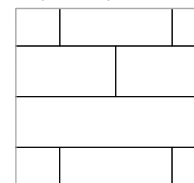

riviera rock garden brown chocolate brown baja beige

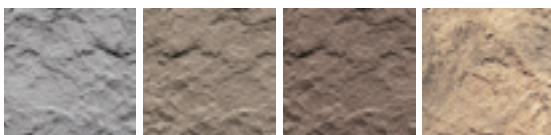

TONE DISTRIBUTION
MEDIUM