

Insert Selection Guide

Material Group	Light Machining (Light geometry)		General Purpose		Heavy Machining (Strong geometry)	
	wear resistance		↔		toughness	
	Geometry	Grade	Geometry	Grade	Geometry	Grade
P1-P2	.E..GE	KCPM40	.S..GE	KCPM40	.S..GEM	KCPM40
P3-P4	.E..GE	KCPM40	.S..GE	KCPK30	.S..GEM	KCPK30
P5-P6	.E..GE	KC725M	.S..GE	KC725M	.S..GEM	KCPK30
M1-M2	.E..GE	KCSM40	.S..GE	KCSM40	.S..GEM	KCPM40
M3	.E..GE	KCPM40	.S..GE	KCPM40	.S..GEM	KCPM40
K1-K2	.S..GE	KC520M	.S..GE	KCK15	.S..GEM	KC520M
K3	.S..GE	KC520M	.S..GE	KCK15	.S..GEM	KC520M
N1-N2	.E..GEJ	KC422M	.E..GEJ	KC422M	.E..GEJ	KC422M
N3	.E..GEJ	KC422M	.E..GEJ	KC422M	.E..GEJ	KC422M
S1-S2	.E..GE	KC725M	.S..GE	KC725M	.S..GE	KC725M
S3	.E..GE	KCSM40	.S..GE	KCSM40	.S..GE	KCSM40
S4	.E..GE	KCSM40	.S..GE	KCSM40	.S..GE	KCSM40
H1	-	-	-	-	-	-

Indexable Inserts • Mill 4-15™

- EGEJ is the first choice for roughing and finishing of aluminium and other non-ferrous alloys.

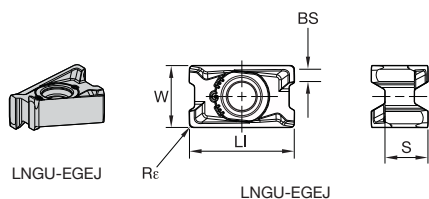

- first choice
- alternate choice

P	●	○	○	○	○	○	○	○	○
M	○	○	○	○	○	○	○	○	○
K	○	○	○	○	○	○	○	○	○
N	○	○	○	○	○	○	○	○	○
S	○	○	○	○	○	○	○	○	○
H	○	○	○	○	○	○	○	○	○

■ LNGU15-EGEJ • For Aluminium and Other Non-Ferrous Alloys

catalogue number	LI	S	W	BS	Rε	hm	cutting edges	KC422M	KC520M	KC522M	KC725M	KCK15	KCPK30	KCPM40	KCSM30	KCSM40
LNGU15T604ERGEJ	17,00	6,96	10,00	2,20	0,4	0,03	4	●	-	-	-	-	-	-	-	-
LNGU15T608ERGEJ	17,00	6,96	10,00	1,80	0,8	0,03	4	●	-	-	-	-	-	-	-	-

Shoulder Milling

- EGE is the first choice for stainless steel and high-temp alloys.
- Best choice for finishing operations in steels, stainless steels, and high-temp alloys.

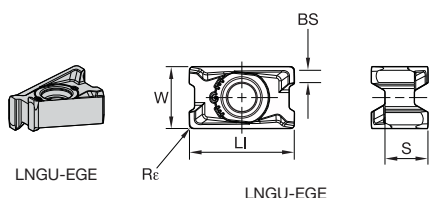

■ LNGU15-EGE • Precision Ground • For Stainless Steel and High-Temp Alloys

catalogue number	LI	S	W	BS	Rε	hm	cutting edges	KC422M	KC520M	KC522M	KC725M	KCK15	KCPK30	KCPM40	KCSM30	KCSM40
LNGU15T604ERGE	17,01	6,96	10,00	2,20	0,4	0,08	4	-	-	●	●	-	-	●	●	-
LNGU15T608ERGE	17,01	6,96	10,00	1,80	0,8	0,08	4	-	-	●	●	-	-	●	●	●
LNGU15T612ERGE	17,01	6,96	10,00	1,40	1,2	0,08	4	-	-	●	●	-	-	●	●	●
LNGU15T616ERGE	17,01	6,96	10,00	1,07	1,6	0,08	4	-	-	●	●	-	-	●	●	-

beyond

- SGE is the universal geometry for Mill 4-15.
- First choice when machining steel.
- Suitable for stainless steel and high-temp alloys in medium-heavy applications.

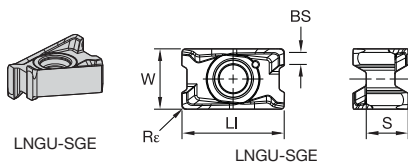

- first choice
- alternate choice

■ **LNGU15-SGE • Precision Ground • For Steel Machining, Finishing, and Light Roughing**

catalogue number	LI	S	W	BS	Rε	hm	cutting edges	KC422M	KC520M	KC522M	KC725M	KCK15	KCPK30	KCPM40	KCSM30	KCSM40
LNGU15T604SRGE	17,00	6,96	10,00	2,20	0,4	0,10	4	-	●	●	●	●	●	-	-	-
LNGU15T608SRGE	17,01	6,96	10,00	1,80	0,8	0,10	4	-	●	●	●	●	●	-	-	-
LNGU15T612SRGE	17,01	6,96	10,00	1,40	1,2	0,10	4	-	●	●	●	●	●	-	-	-
LNGU15T616SRGE	17,01	6,96	10,00	1,07	1,6	0,10	4	-	●	●	●	●	●	-	-	-

- SGE is the universal geometry for Mill 4-15. First choice when machining steel, as well as stainless steel and high-temp alloys in heavy applications.

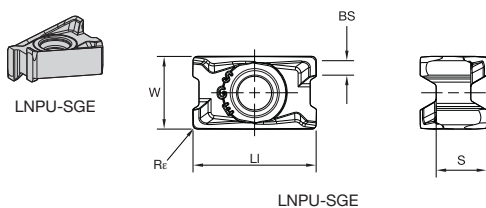

■ **LNPU15-SGE • Precision Pressed • For Steel Machining in Medium-Heavy Roughing**

catalogue number	LI	S	W	BS	Rε	hm	cutting edges	KC422M	KC520M	KC522M	KC725M	KCK15	KCPK30	KCPM40	KCSM30	KCSM40
LNPU15T604SRGE	16,90	6,96	10,00	2,20	0,4	0,10	4	-	●	●	●	●	●	-	-	-
LNPU15T608SRGE	16,90	6,96	10,00	1,80	0,8	0,10	4	-	●	●	●	●	●	-	-	-
LNPU15T612SRGE	16,90	6,96	10,00	1,50	1,2	0,10	4	-	●	●	●	●	●	-	-	-
LNPU15T616SRGE	16,90	6,96	10,00	1,10	1,6	0,10	4	-	●	●	●	●	●	-	-	-
LNPU15T620SRGE	16,92	6,96	10,00	0,70	2,0	0,10	4	-	●	●	●	●	●	-	-	-

- SGEM geometry is the first choice for cast iron machining in medium and heavy applications.

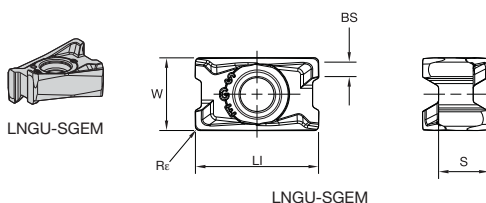

■ **LNGU15-SGEM • For Cast Iron Machining**

catalogue number	LI	S	W	BS	Rε	hm	cutting edges	KC422M	KC520M	KC522M	KC725M	KCK15	KCPK30	KCPM40	KCSM30	KCSM40
LNGU15T608SRGEM	17,01	6,96	10,00	1,70	0,8	0,10	4	-	●	-	-	-	●	-	-	-
LNGU15T612SRGEM	17,01	6,96	10,00	1,30	1,2	0,10	4	-	●	-	-	-	●	-	-	-
LNGU15T616SRGEM	17,01	6,96	10,00	0,95	1,6	0,10	4	-	●	-	-	-	●	-	-	-
LNGU15T620SRGEM	17,01	6,96	10,00	0,34	2,0	0,10	4	-	●	-	-	-	●	-	-	-



Shoulder Milling



## Mill 4-15 Starter Kits

Order one of our starting kits and test the performance of our new Mill 4 platform. The kits are set up to serve the majority of shoulder milling applications and workpiece materials, delivered with a cutter body as well as 20 inserts from a premium Kennametal grade.

**Order one Mill 4™ kit, and experience the next level of shoulder milling!**

Detailed order information can be found in the table below:



### ■ Mill 4-15 Metric Starter Kits

material group	order number	catalogue number	cutter kit	application range	content				
					cutter	qty	insert	grade	qty
P	5956817	M4KITD25Z02A25SGEKC725M	D25z2	∇∇	M4D025Z02A25LN15L100	1	LNPU15T608SRGE	KCPM40	20
P	5956818	M4KITD32Z03A32SGEKC725M	D32z3	∇∇	M4D032Z03A32LN15L110	1	LNPU15T608SRGE	KCPM40	20
P	5956819	M4KITD40Z04S16SGEKC725M	D40z4	∇∇	M4D040Z04S16LN15	1	LNPU15T608SRGE	KCPM40	20
P	5956820	M4KITD50Z05S22SGEKC725M	D50z5	∇∇	M4D050Z05S22LN15	1	LNPU15T608SRGE	KCPM40	20
P	5956872	M4KITD50Z06S22SGEKC725M	D50z6	∇∇	M4D050Z06S22LN15	1	LNPU15T608SRGE	KCPM40	20
P	5956873	M4KITD63Z06S22SGEKC725M	D63z6	∇∇	M4D063Z06S22LN15	1	LNPU15T608SRGE	KCPM40	20
P	5956874	M4KITD80Z07S27SGEKC725M	D80z7	∇∇	M4D080Z07S27LN15	1	LNPU15T608SRGE	KCPM40	20
P	5956875	M4KITD100Z08S32SGEKC725M	D100z8	∇∇	M4D100Z08S32LN15	1	LNPU15T608SRGE	KCPM40	20
M + S	5956876	M4KITD25Z02A25EGEKC725M	D25z2	∇∇∇	M4D025Z02A25LN15L100	1	LNGU15T608ERGE	KC725M	20
M + S	5956877	M4KITD32Z03A32EGEKC725M	D32z3	∇∇∇	M4D032Z03A32LN15L110	1	LNGU15T608ERGE	KC725M	20
M + S	5956878	M4KITD40Z04S16EGEKC725M	D40z4	∇∇∇	M4D040Z04S16LN15	1	LNGU15T608ERGE	KC725M	20
M + S	5956879	M4KITD50Z05S22EGEKC725M	D50z5	∇∇∇	M4D050Z05S22LN15	1	LNGU15T608ERGE	KC725M	20
M + S	5956880	M4KITD50Z06S22EGEKC725M	D50z6	∇∇∇	M4D050Z06S22LN15	1	LNGU15T608ERGE	KC725M	20
M + S	5956891	M4KITD63Z06S22EGEKC725M	D63z6	∇∇∇	M4D063Z06S22LN15	1	LNGU15T608ERGE	KC725M	20
M + S	5956892	M4KITD80Z07S27EGEKC725M	D80z7	∇∇∇	M4D080Z07S27LN15	1	LNGU15T608ERGE	KC725M	20
K	5956893	M4KITD25Z02A25SGEMKC520M	D25z2	∇	M4D025Z02A25LN15L100	1	LNGU15T608SRGEM	KC520M	20
K	5956894	M4KITD32Z03A32SGEMKC520M	D32z3	∇	M4D032Z03A32LN15L110	1	LNGU15T608SRGEM	KC520M	20
K	5956896	M4KITD40Z04S16SGEMKC520M	D40z4	∇	M4D040Z04S16LN15	1	LNGU15T608SRGEM	KC520M	20
K	5956897	M4KITD50Z05S22SGEMKC520M	D50z5	∇	M4D050Z05S22LN15	1	LNGU15T608SRGEM	KC520M	20
K	5956898	M4KITD50Z06S22SGEMKC520M	D50z6	∇	M4D050Z06S22LN15	1	LNGU15T608SRGEM	KC520M	20
K	5956899	M4KITD63Z07S22SGEMKC520M	D63z7	∇	M4D063Z07S22LN15	1	LNGU15T608SRGEM	KC520M	20
K	5956900	M4KITD80Z09S27SGEMKC520M	D80z9	∇	M4D080Z09S27LN15	1	LNGU15T608SRGEM	KC520M	20
K	5956901	M4KITD100Z11S32SGEMKC520M	D100z11	∇	M4D100Z11S32LN15	1	LNGU15T608SRGEM	KC520M	20

∇ Heavy/Roughing  
∇∇ Medium  
∇∇∇ Light machining/Finishing