

XS Inline

Integrate the most compact
laser solution on the market

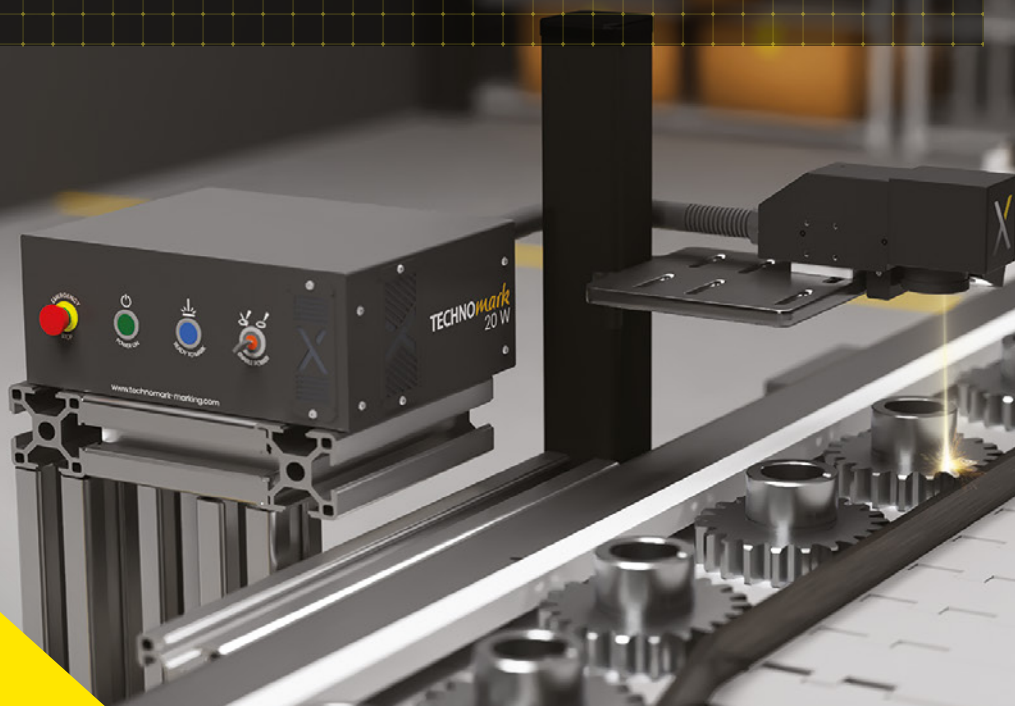

GRAPHIX.series®

INCREASE THE PACE

XS Inline model



EASY TO INTEGRATE



NETWORK CONNECTION



READ & VERIFY FUNCTION

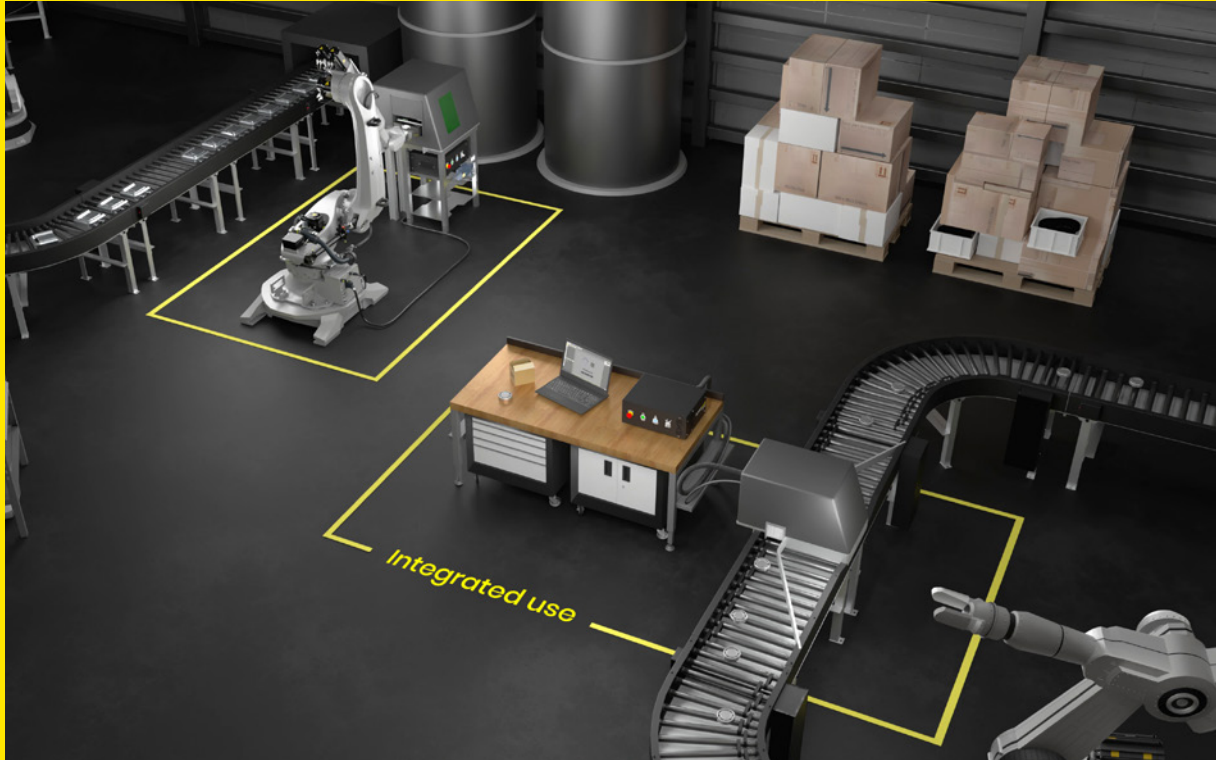

We have rethought the way we design and develop our products. Today, our marking solutions are the result of direct customer feedback across a wide range of applications.



Integrated use

1.

The machine is mounted **on a line or a production unit**

2.

Markings are produced in **large series**

3.

Marking on **parts of any size**



Laser Technology

- **High-intensity, fine-focused laser beam** directed at the part to be marked.
- **Non-contact permanent marking** on all types of surface

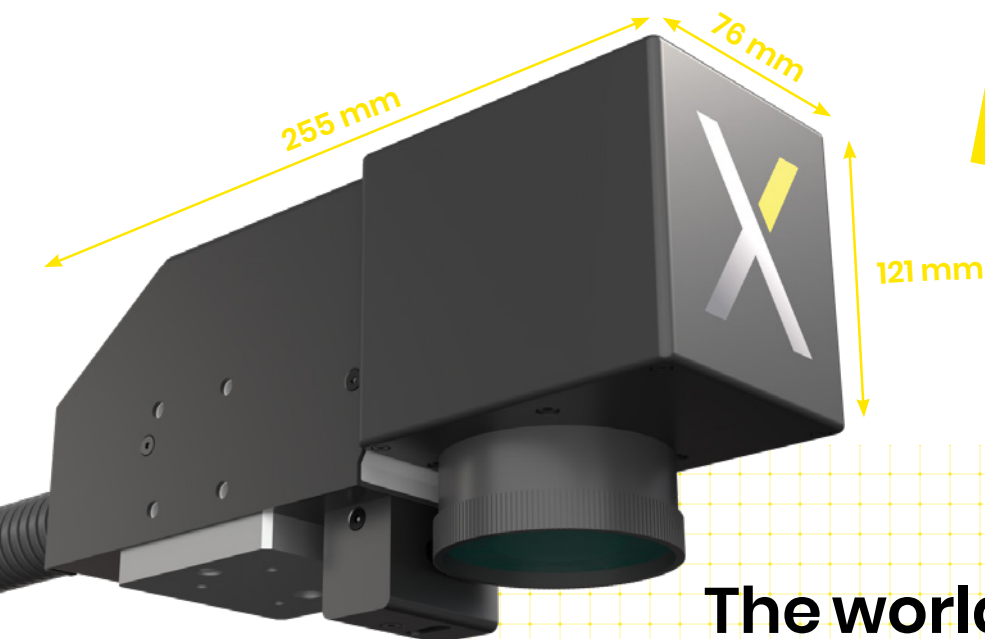

Class 4
marking
laser



2 power ratings
available: 20W
and 30W



MARKING HEAD

The world's smallest integrated laser head



Easy to integrate on a production line

- Multi-position marking head (360°) thanks to 3 fixing faces
- Fits into the most confined spaces thanks to its compact design
- Precise adjustment of focal length using the mounting plate (20 mm stroke) and cross laser pointer
- 3m laser fibre cable between head and controller
- Single energy source: electricity

2 window sizes available
depending on focal length

160 focal
length
100x100 mm

254 focal
length
140x140 mm



« Read & Verify » function ensures legibility of marking

- Camera-based reading and validation of 1D and 2D codes after marking
- Guarantees that the marking can be read
- Reduced risk of errors

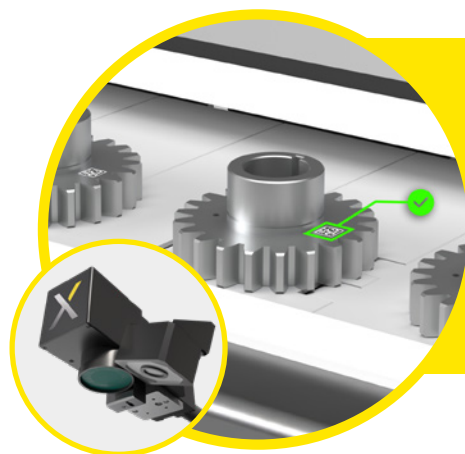

Productivity

Developed for continuous
operation 24/7



ROBUSTNESS

Laser machine designed with resistant and light materials, compatible with a demanding working environment:

- Aluminium marking head (2.1 kg)
- Aluminium sheet metal controller (8.9 kg)

Marking
medium to
large series



CONNECTIVITY

The answer to Industry 4.0 requirements



Network connection

up to 3 Ethernet ports

• PC control:

- PC connected to the same network as the station
- File and logo saving on the network
- Slave control with RS232 and Ethernet TCP/IP

• Standalone operation:

- Ethernet TCP/IP
- **Ethernet/IP** or **PROFINET** field network
- Backup of files and logos to a shared network folder

Power supply button

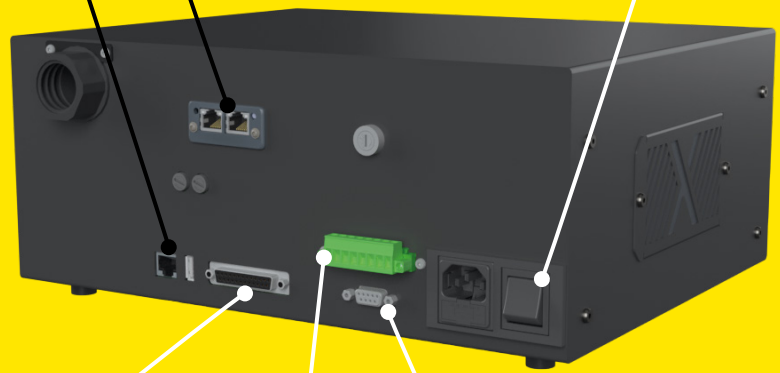

Inputs/outputs

- **8 inputs:** launch marking, upload file, reset serial number, etc.
- **8 outputs:** system ON, laser error, marking in progress, etc.

8-pin terminal block

Safety sensors and 24V output

Accessories

Motorised D-axis or Z-axis connection



Controller:

- Emergency stop button
- Security key to activate marking mode
- « Laser operating » and « machine ready to mark » indicators

Many types of marking possible



Alphanumeric



Bar-code



Timestamp



2D Datamatrix



Logo

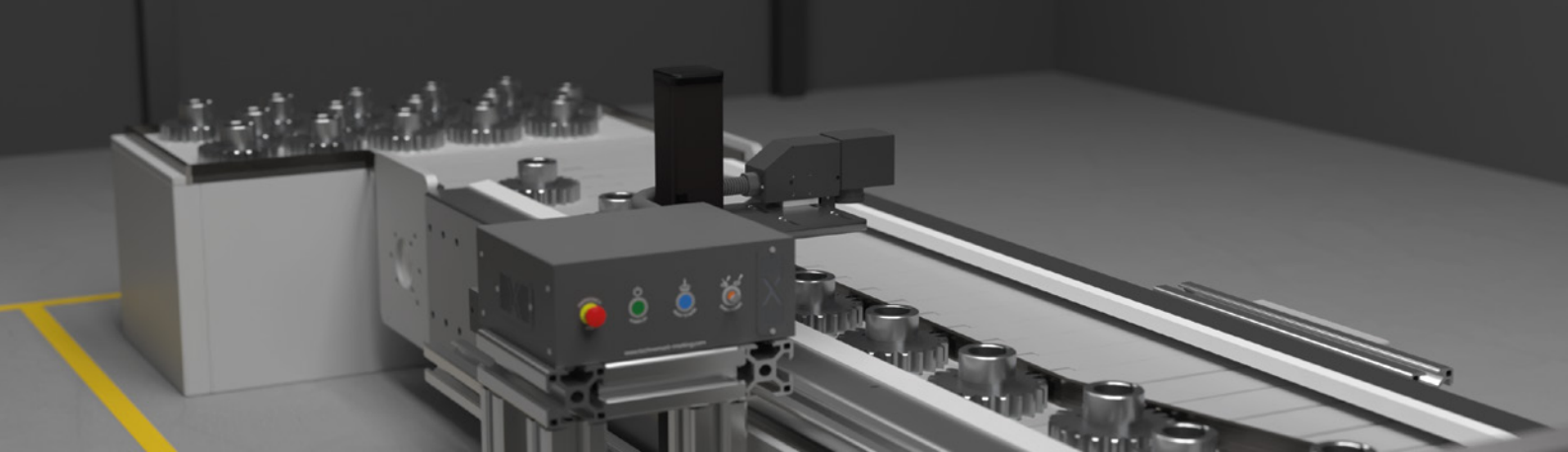

DRIVING SOFTWARE

Capacity to meet your expectations

Advanced functionality

- Possibility of control from a distance
- Offline file creation
- Recovery of marking data via a SQL or CSV database
- 2 types of profile: supervisor and user
- Marking history
- Marking parameters test mode to obtain the required result easily
- Numerous marking options: logos, alphanumeric, 1D and 2D codes, shapes, images, etc.
- Multilingual: 7 languages available



MATERIALS TO BE MARKED			
METALS	Steel	PLASTICS	PVC
	Stainless steel		Polyamide
	Aluminium		Polycarbonate
	Brass		Polyethylene
	Titanium		Polypropylene
	Silver		ABS
	Bronze		Acrylic

Non-exhaustive list

Available licences

- **« Read & Verify » licence**
Reading of 1D/2D codes after marking
- **« Standalone » licence**
Machine-independent operation
- **Field network licence**
Control with Ethernet/IP or Profinet
- **Database licence**
Import of marking data

OUR ADDED VALUE

Long-term support

Pre-sale



FEASIBILITY
STUDY



SAMPLES
MARKING

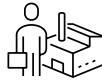

ON-SITE
TESTING



CUSTOMIZATION

After sales



HELPLINE



TRAINING



SERVICE AND
MAINTENANCE CONTRACT



REPAIR



LOAN OF EQUIPMENT

TECHNOmark[®]
— smart traceability



1, allée du développement
42350 La Talaudière - France
+33 (0)4 77 22 25 91
info@technomark-marking.com

www.technomark-marking.com



47 countries

WORLDWIDE PRESENCE THROUGH OUR
DISTRIBUTORS AND 3 SUBSIDIARIES

99%

AVERAGE CUSTOMER SATISFACTION
RATE OVER 3 YEARS

23 500

YELLOW MACHINES IN SERVICE
WORLDWIDE, ALL TECHNOLOGIES

10%

OF TURNOVER DEDICATED TO R&D

