



Experience
Dubai
At Your Own Tempo

HILTON DUBAI AL HABTOOR CITY

Located in the heart of Dubai and on the banks of the Dubai Water Canal the iconic Hilton Dubai Al Habtoor City offers guests a vibrant stay with every aspect transformed into a refreshing experience.

ROOMS & SUITES

From 1,004 well-appointed guest rooms including 142 spacious suites and signature suites (the Chairman Suite and Presidential Suite) are designed to provide exceptional comfort and a truly relaxing stay with sweeping views of the Dubai Water Canal or Burj Khalifa. Guests can stay at the executive rooms or selected suites with complimentary access to the Executive Lounge featuring delightful services and private meeting room access.

SUCCESSFUL MEETINGS

Be it a small session or a city-wide conference. Venues designed to motivate, with a dedicated banquet and catering crew of experts crafting every detail to ensure all attendees feel most energized and creative. Every meeting room is named after an exotic flower and each has a story of its own. Whether hosting a conference, celebrating a milestone or just need a change of scenery with natural day light and gorgeous views of the Dubai Water Canal. Or the 1,425 sqm Al Joud Ballroom, with a separate entrance and a pre function hall ideal for weddings.

DINING DELIGHTS

Guests can enjoy direct access to over 30+ dining venues throughout Al Habtoor City. Start the day with a hearty meal at The Market with a wide range of cuisines from around the world. Followed by a lazy afternoon at Firefly poolside or for the sports fans, enjoy a night of gourmet comfort food at an American gastropub Ribs & Brews. Guests can also bowl at the highest bowling alley in the world at The 44.

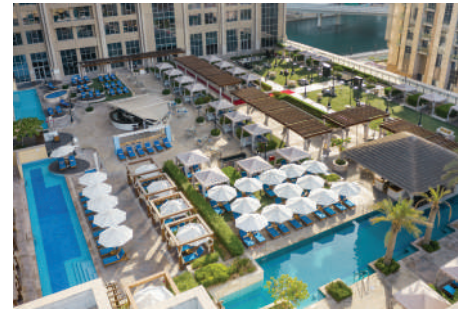
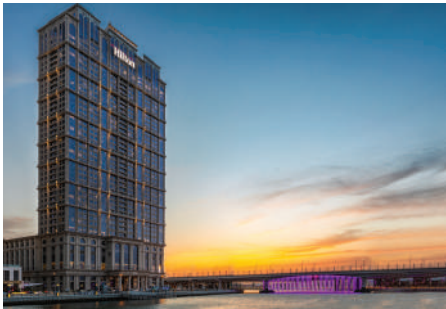

ROOM NAME	DIM -LxW (METRES)	AREA (SQM)	HEIGHT (METERS)	BANQUET	THEATRE	COCKTAIL	CLASSROOM	U-SHAPE	CABARET 7 SEATS	BOARDROOM
GROUND LEVEL										
AL JOUD BALLROOM A	147x30.65	450	7.85	210	250	250	182	55	147	60
AL JOUD BALLROOM B	172x30.65	525	7.85	300	324	350	195	60	168	80
AL JOUD BALLROOM C	147x30.65	450	7.85	210	250	250	182	55	147	60
AL JOUD BALLROOM ABC	46.6x30.65	1425	7.85	850	1200	1,100	550	110	420	180
PRE-FUNCTION AREA	39x16	625	5.9	-	-	500	-	-	-	-
BRIDAL SUITE	-	65	-	-	-	-	-	-	-	-
LEVEL 1										
DAHLIA	9x9.8	88	4.5	50	60	60	30	19	30	16
CARNATION	9x9.9	89	4.5	50	60	60	30	19	30	16
CHIA	9 x 9.9	89	4.5	50	60	75	30	19	30	16
ARFAJ	10.1 x 8.2	82	4.5	40	40	30	18	16	18	16
LEVEL 2										
SENNA	16 x 7	110	5.27	60	42	80	24	25	36	22
LILAC	7 x 9	63	5.27	30	30	30	12	15	18	12
FREESIA	7 x 9	63	5.27	30	30	30	12	15	18	12
LILAC + FREESIA	14 x 9	126	5.27	60	70	80	30	32	36	32
IRIS	11.2 x 8.6	96	5.27	50	48	50	16	19	24	16
LILY	11.2 x 8.6	96	5.27	50	48	50	16	19	24	16
IRIS + LILY	22.4 x 8.6	192	5.27	100	-	130	-	-	-	-
LOTUS	8.5 x 7	60	5.27	-	-	-	-	11	-	12
MALVA	8.6 x 6.8	58	5.27	30	40	30	12	15	18	12
MAGNOLIA	8.6 x 6.8	58	5.27	30	40	30	12	15	18	12
MALVA + MAGNOLIA	17.2 x 6.8	116	5.27	60	70	80	32	32	36	32
ORCHID	15.8 x 7	110	5.27	60	42	100	24	25	30	22
LEVEL 7										
FIREFLY OUTDOOR	-	260	-	180	170	195	125	25	84	30

*The above figures will vary depending on the event layout.

- MEETING SPACE
- PRE FUNCTION

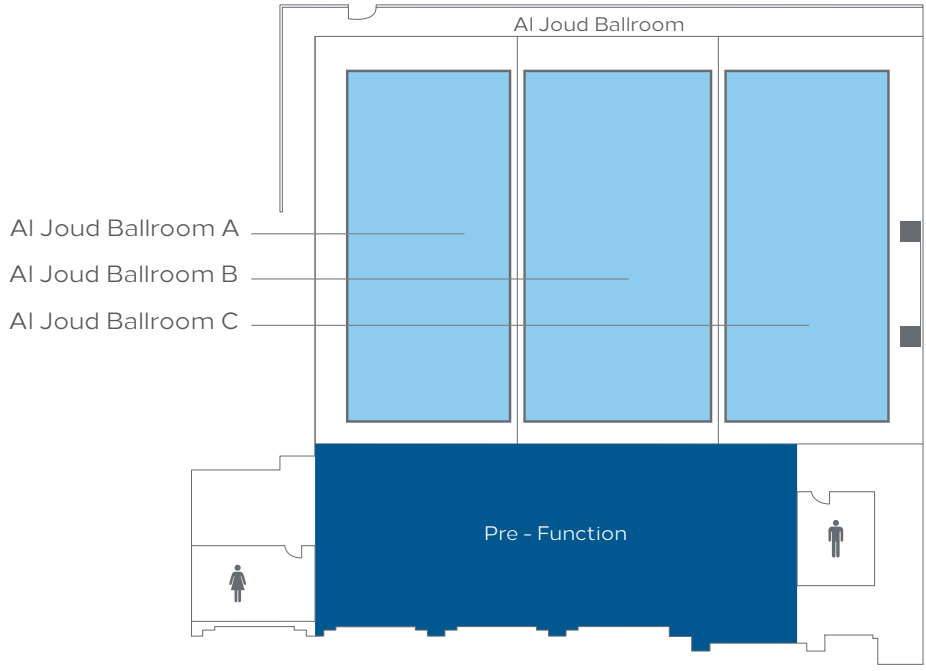

LEVEL 1

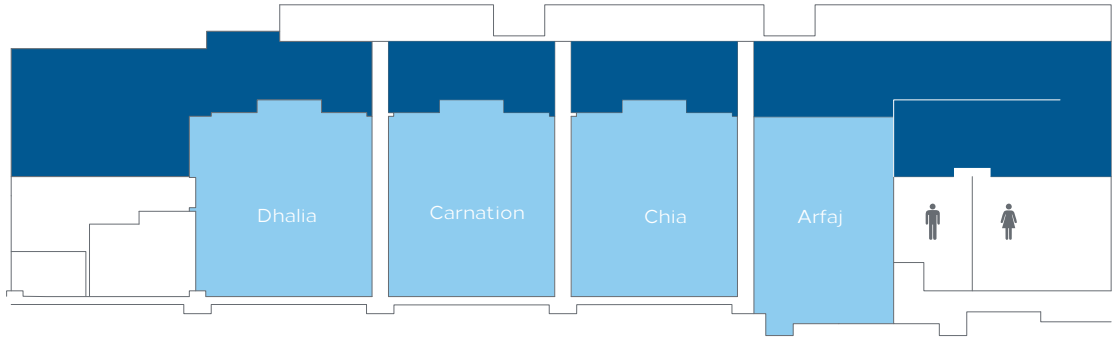

LEVEL 2

