

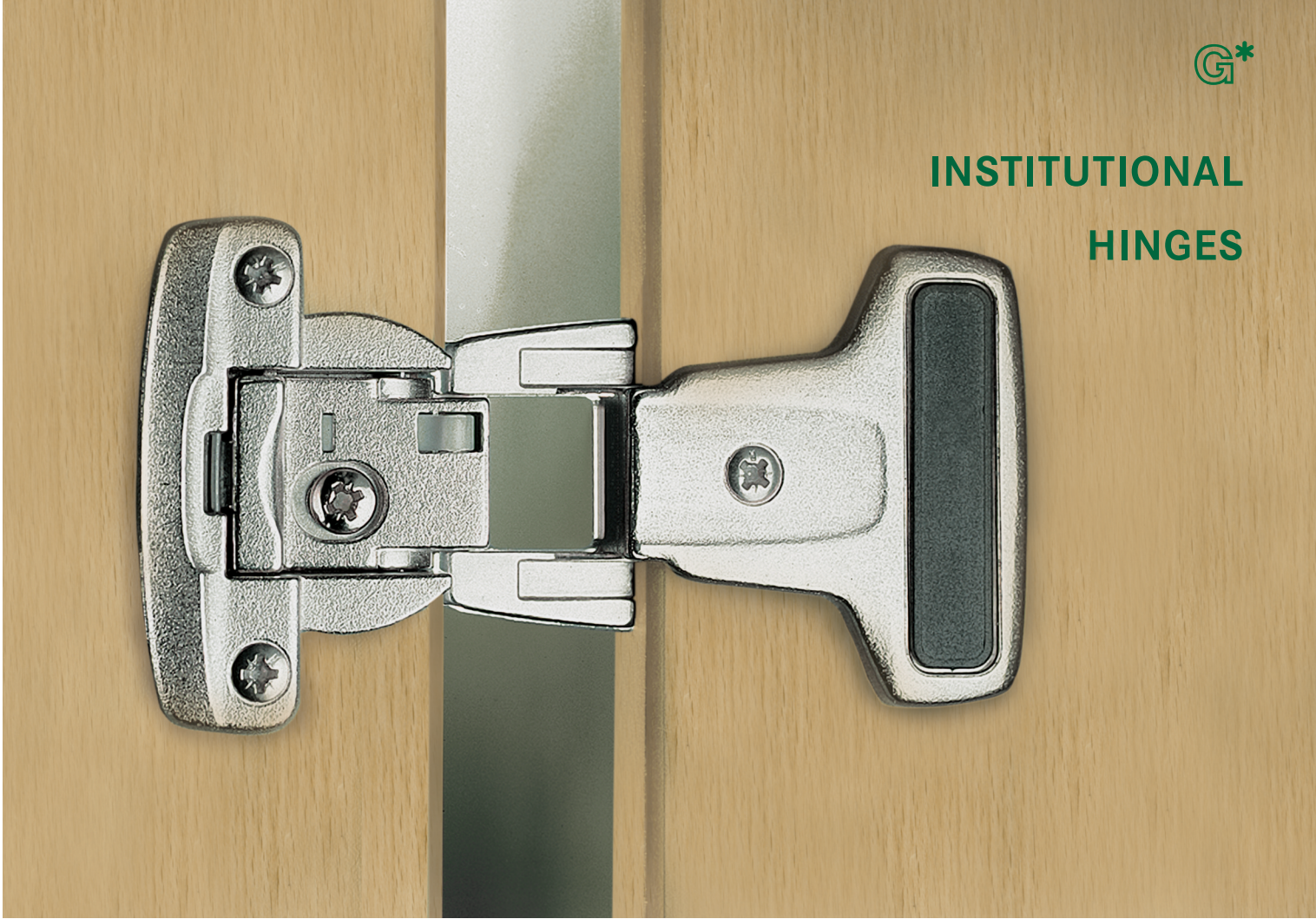

INSTITUTIONAL HINGES



G* GRASS®

INSTITUTIONAL HINGES

The perfect solution for institutional casework. Engineered to exceed your hardware expectations.



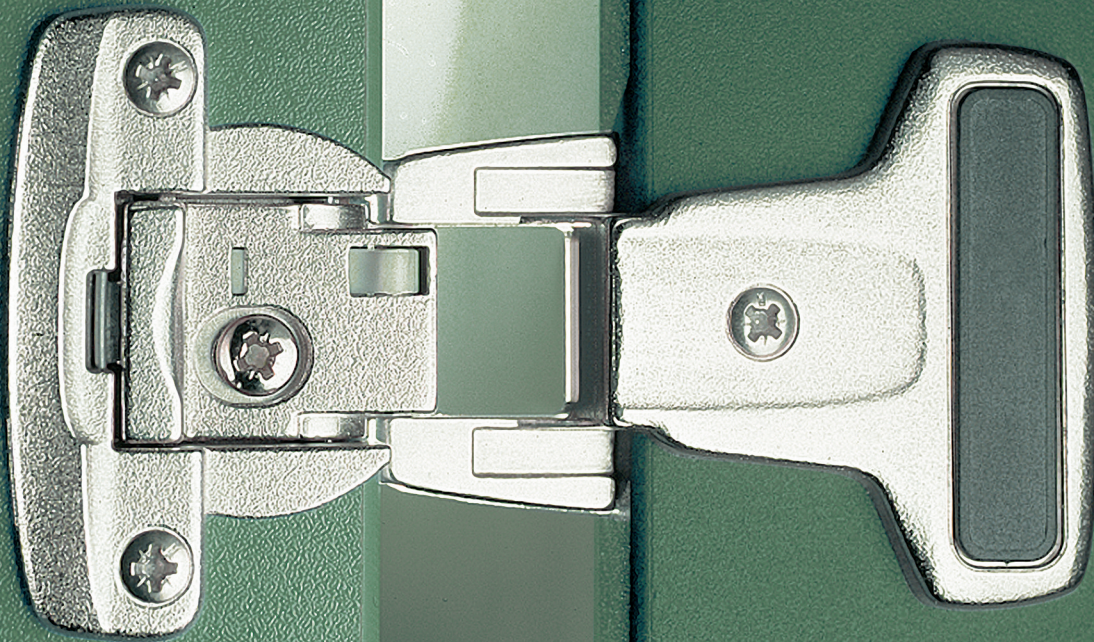

Grass Institutional Hinges offer the perfect solution for institutional casework in schools, hospitals, commercial, and furniture environments where the cabinetry has a considerable amount of use. Distinguished by its outstanding durability based on all metal construction, this institutional hinge system is designed for frameless cabinetry and offers high load

weight bearing capabilities. Its sturdy design makes it your first choice in institutional cabinetry.

The Grass Institutional Hinge has a 35 mm cup diameter with a 45/9.5 mm boring pattern. Mounting the hinge is extremely easy and can be achieved without the use of tools. The hinge cup and the hinge arm can be attached with

the slight press of the finger. Your application, from an overlay, half overlay or inset, determines the opening angle from 180° to 270°.

Engineered to exceed your hardware expectations, the Grass Institutional Hinge System is backed by our limited lifetime warranty.

Institutional hinges



Nickel



Black

Grass offers the best choice for institutional applications:

- Hinges made of zinc die-cast construction for extreme durability
- Recommended for side panel thicknesses of 19 mm [¾"]
- Toolless snap-on mounting - quick and easy installation
- All types of hinge mounting (corner and center wall)
- Side-to-side adjustment of - 2mm [⅛"]
- Height adjustment of +/- 2mm [⅛"]
- Cover cap conceals mounting screws
- Available in black and nickel plated
- Designed for frameless cabinet construction
- Opening angles range from 180° to 270°
- *Meets ANSI/BHMA A156.9 - 2003 Grade I requirements

*Meets Grade I requirements when third screw and adjustment tabs are in place.

How to specify hardware:

1. Choose screw-on or dowelled cup: one cup fits all hinge arms.
2. Choose hinge arm based on application (cover cap included).
3. Special #6.3 x 13.5 mm Euro screws (2) required for hinge arm mounting. Must be ordered separately.

MB 8010 Hinge Cup - 45mm pattern		Hinge Cup Item No.	
 <ul style="list-style-type: none"> • Choose hinge arm below 	Type	Nickel Plated	Black
	Screw-on	F15000006233	F150145123233
	Dowelled	F150000021233	F150145124233
	PU 200 pieces		

MB 8310 Hinge Arm - Full Overlay		Hinge Arm Item No.	
 <ul style="list-style-type: none"> • 15 mm [½"] overlay 	Nickel Plated	Black	
	F150000014223	F150145125223	
	PU 100 pieces		

MB 8510 Hinge Arm - Half Overlay		Hinge Arm Item No.	
 <ul style="list-style-type: none"> • 5.5 mm [¼"] overlay 	Nickel Plated	Black	
	F150000015223	F150145399223	
	PU 100 pieces		

MB 6110 Hinge Arm - Inset		Hinge Arm Item No.	
 <ul style="list-style-type: none"> • Inset hinge 	Nickel Plated	Black	
	F150000007223	-	
	PU 100 pieces		

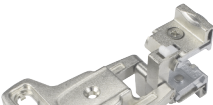
Common Panel		Hinge Arm Item No.	
 <ul style="list-style-type: none"> • 5.5 mm [¼"] overlay 	Nickel Plated	Black	
	F150000016223	F150145394223	
	PU 100 pieces		

Cover cap included with hinge arm.

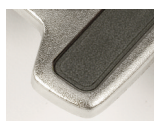

Euro Screws for Hinge Arm mounting		
Size	Item # - Nickel Plated	Box Qty.
6.3 x 13.5 mm	B405.000.51.25	100

PU = packaging unit

Technical Specifications

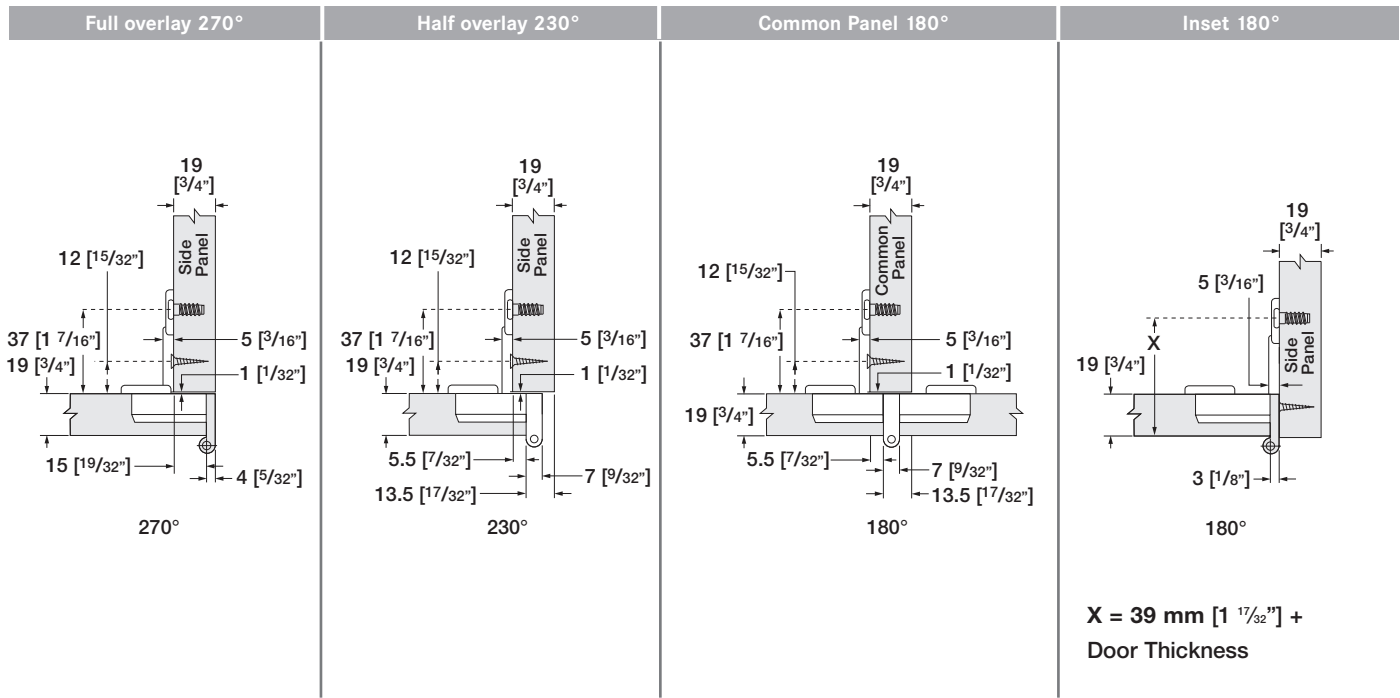

Assembly Details

Institutional hinges
32mm compatible

Hinge Arm

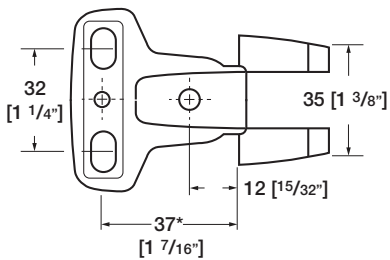

*For inset doors use:
39 mm [1 17/32"] + Door Thickness

Specifications			
Application	Reveal	Opening Angle	Overlay
Full Overlay	4 [5/32"]	270°	15 [19/32"]
Half Overlay	13.5 [17/32"]	230°	5.5 [7/32"]
Common Panel	7 [9/32"]	180°	5.5 [7/32"]
Inset	3 [1/8"]	180°	-

IMPORTANT

To determine the correct application Grass strongly recommends a trial mounting for all hinges and base plates.

Cup Depth

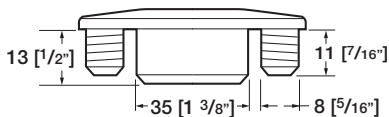

Hinge Cup

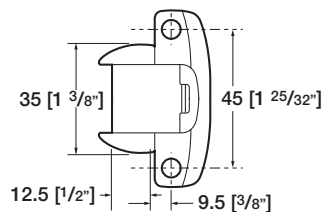

Cup Drilling

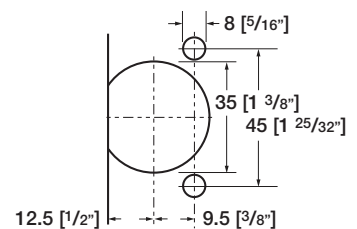

Mounting to cabinet



A slight press with the thumb securely connects the door with the cabinet.

Detaching from cabinet



Use flathead screwdriver to remove hinge arm from hinge cup with a simple twist.

Adjustments

Height

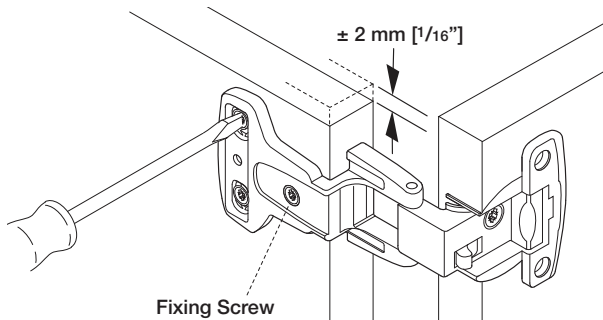

1. Loosen fixing screw.
2. Adjust door ± 2 mm up and down.
3. Tighten fixing screw.

Side-to-side

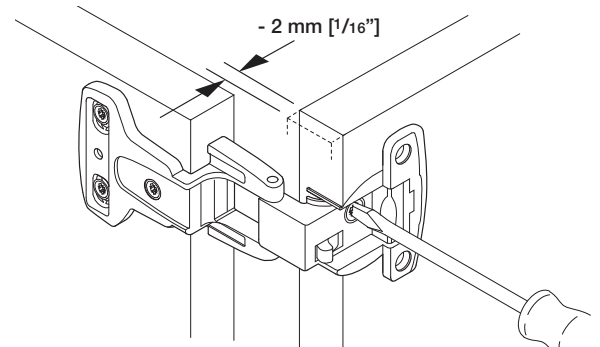

1. Adjust door 2 mm out via Cam adjustment screw.

Number of Hinges Per Door

The number of hinges required depends on the size and weight of the door. The distance between the hinges should be spaced as wide as possible. Use the diagram to determine the number of hinges needed. These recommendations are for doors without accessory attachments.

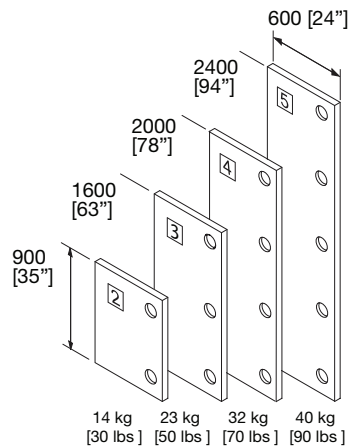

Subject to technical modifications without notice.



Grass America Inc.
1202 Highway 66 South
Kernersville, NC 27284

Phone 1-800-334-3512
Fax 1-800-525-8406

Internet: www.grassusa.com
E-Mail: info@grassusa.com

www.grassusa.com

GRASS Canada Inc.
10 Newgale Gate, Unit 7
Toronto, ON M1X 1C5

Phone: 1-800-461-4975
Fax: 1-416-335-5907

Internet: www.grasscanada.com
E-Mail: info@grasscanada.com