



INSTITUTIONAL HINGES



G*GRASS®

INSTITUTIONAL HINGES

The perfect solution for institutional casework.
Engineered to exceed your hardware expectations.



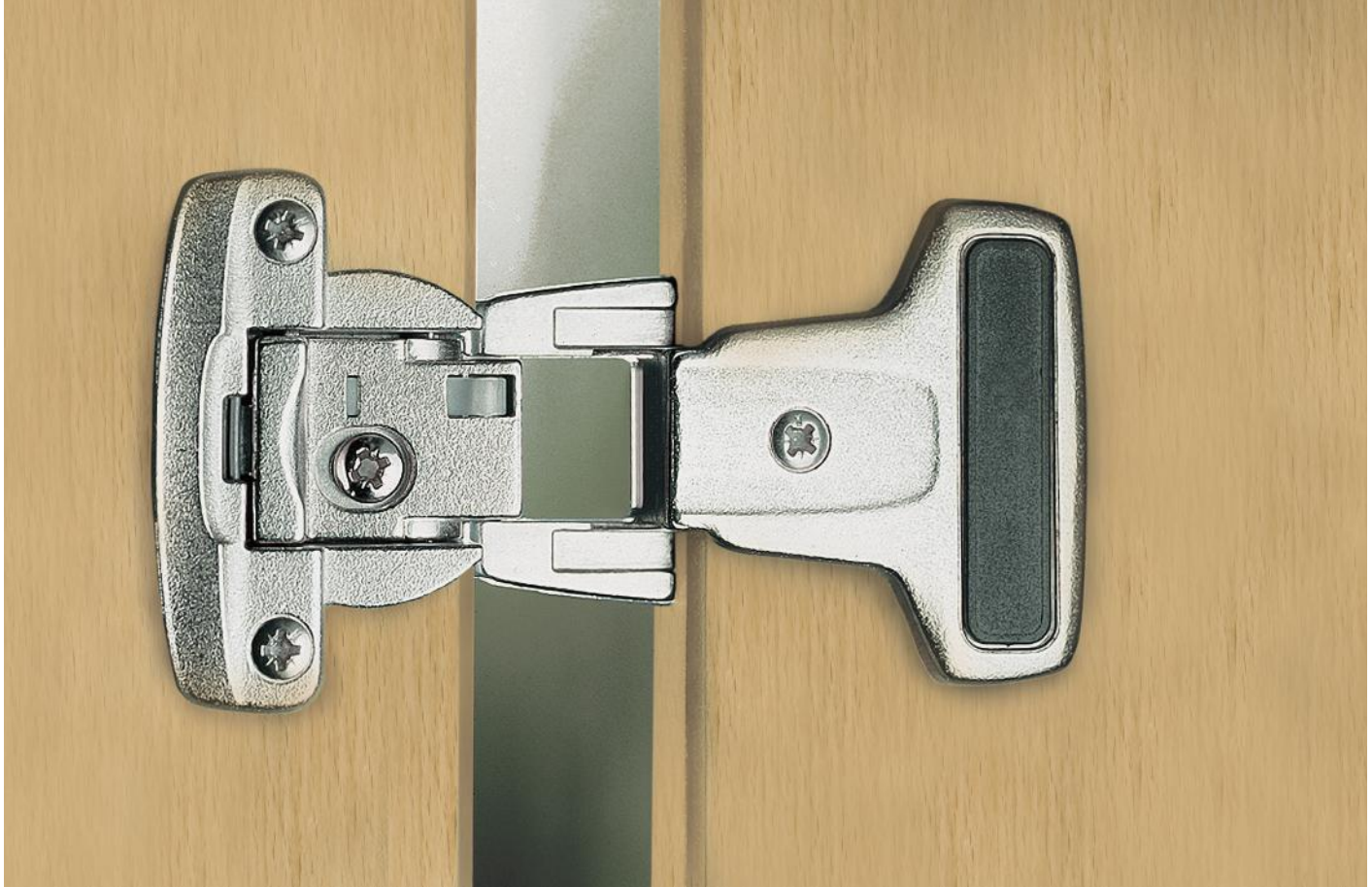

INSTITUTIONAL HINGES

Designed for high use environments

Grass Institutional Hinges offer the perfect solution for institutional casework in schools, hospitals, commercial, and furniture environments where the cabinetry has a considerable amount of use. This institutional hinge system is designed for frameless cabinetry and offers high load weight bearing capabilities.



Institutional Hinge

Technical Information

Hinge Insertion



A slight press with the thumb securely connects the door with the cabinet.

Hinge Removal



Use flathead screwdriver to remove hinge arm from hinge cup with a simple twist.

Adjustments

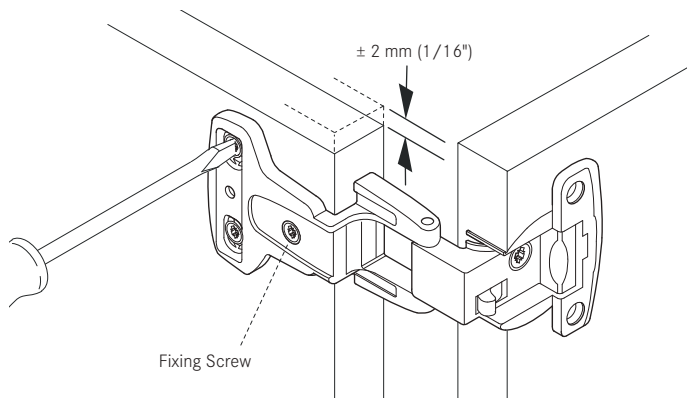

Height Adjustment

1. Loosen fixing screw.
2. Adjust door ± 2 mm up and down.
3. Tighten fixing screw.

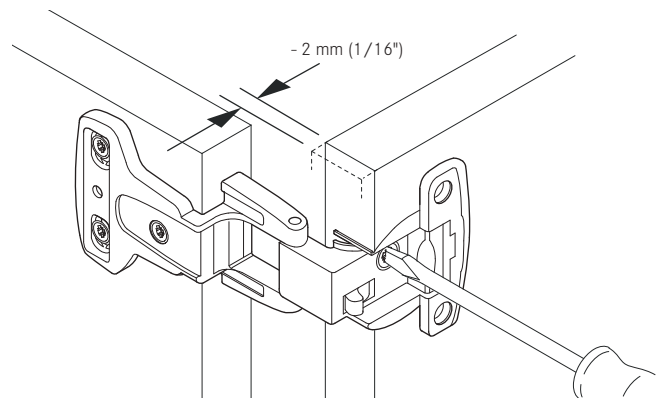

Side Adjustment

1. Adjust door 2mm out via Cam adjustment.

Number of Hinges per Door

The number of hinges required depends on the size and weight of the door. The distance between the hinges should be spaced as wide as possible.

Use the diagram to determine the number of hinges needed. These recommendations are for doors without accessory attachments.

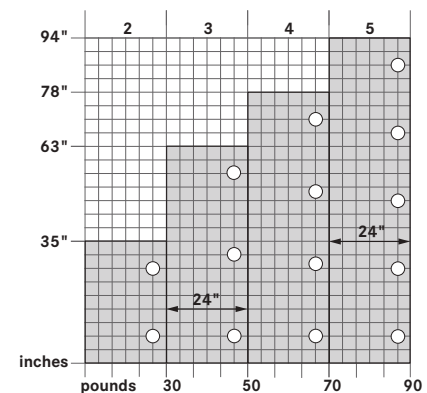

Institutional Hinge

MB series barrel hinge



- Hinges made of zinc die-cast construction for extreme durability
- Recommended for side panel thicknesses of 19mm (3/4")
- Tool-free snap-on mounting - quick and easy installation
- All types of hinge mounting (corner and center wall)
- Side-to-side adjustment of - 2mm (1/16")
- Height adjustment of +/- 2mm (1/16")
- Cover cap conceals mounting screws
- Available in nickel plated and black** finishes
- Designed for frameless cabinet construction
- Opening angles range from 180° to 270°
- Meets ANSI/BHMA A156.9 - Grade I requirements

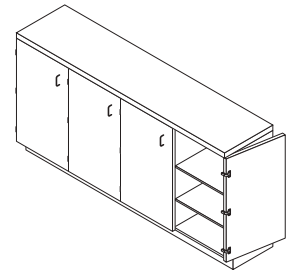

MB 8010 Hinge Cup

Hinge Cup	Pattern	Material	Item No.	Item No.	PU
MB 8010 Hinge Cup - 45mm pattern	45	Nickel Plated	F150000006233	F150000021233	200
	45	Black**	-	F150145124233	200



MB 8010 Hinge Cup - 45mm pattern

**product lead time approximately 12 weeks.

Hinge Arms



Description	Material	Item No.	PU
MB 8310 Hinge Arm - Full Overlay -15mm (19/32")	Nickel Plated	F150000014223	100
	Black**	F150145125223	100

Description	Material	Item No.	PU
MB 8510 Hinge Arm - Half Overlay - 5.5mm (7/32")	Nickel Plated	F150000015223	100

Description	Material	Item No.	PU
MB 6110 Hinge Arm - Inset	Nickel Plated	F150000007223	100

Common Panel Hinge Arm



Description	Material	Item No.	PU
MB 8610 Common Panel Hinge Arm - 5.5mm (7/32")	Nickel Plated	F150000016223	100

Euro Screws for Hinge Arm Mounting	Item No.	PU
6.3 x 13.5mm Nickel Plated (two per hinge)	B405.000.51.25	100

Cover Cap



Cover cap included with hinge arm

*Meets Grade I requirements when third screw and adjustment tabs are in place.

PU - Packaging unit

Full Overlay 270°

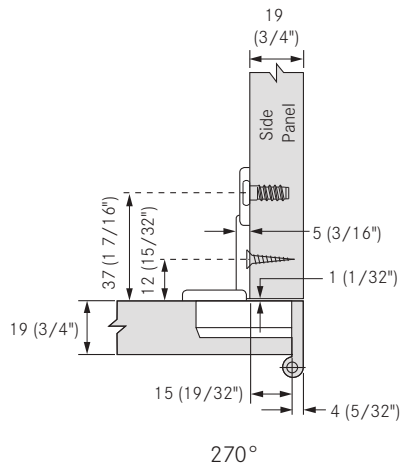
 270°

Half Overlay 230°

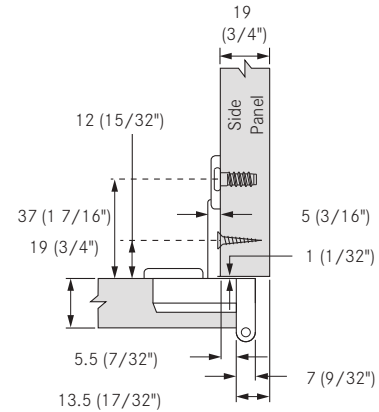
 230°

Common Panel 180°

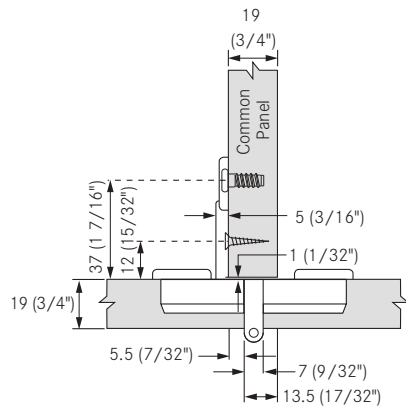
 180°

Inset 180°

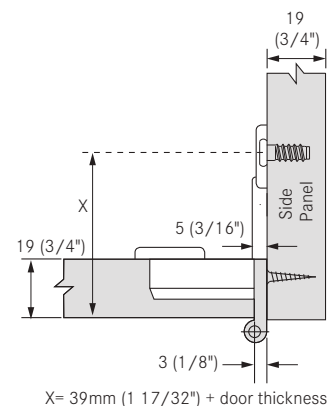

X= 39mm (1 17/32") + door thickness

 180°

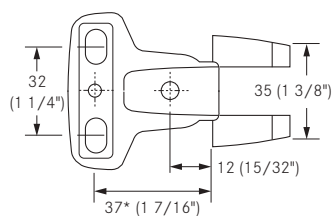

Hinge Arm Dimensions



Institutional hinges
32mm compatible

*For Inset doors use:
39mm (1 17/32") + Door Thickness

Specifications

Application	Reveal	Opening Angle	Overlay
			
Full Overlay	4mm (5/32")	270°	15mm (19/32")
Half Overlay	13.5mm (17/32")	230°	5.5mm (7/32")
Common Panel	7mm (9/32")	180°	5.5mm (7/32")
Inset	3mm (1/8")	180°	-

Cup Depth

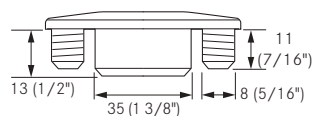

Hinge Cup

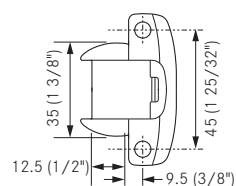

Cup Drilling

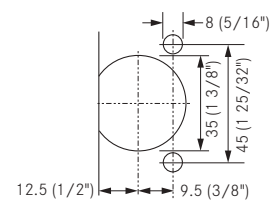

IMPORTANT

To determine the correct application Grass strongly recommends a trial mounting for all hinges and base plates.

Nexis Slide-on 73

270° single-joint Institutional hinge



- 3-dimensional adjustment with suitable base plate
- For door thicknesses 15 to 21mm
- For door overlay up to 16mm (5/8")
- Automatic hold-closed function
- Meets ANSI/BHMA A156.9 - Grade II requirements

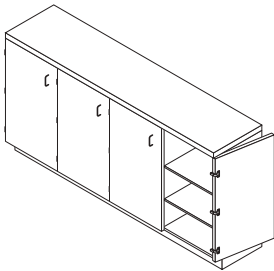

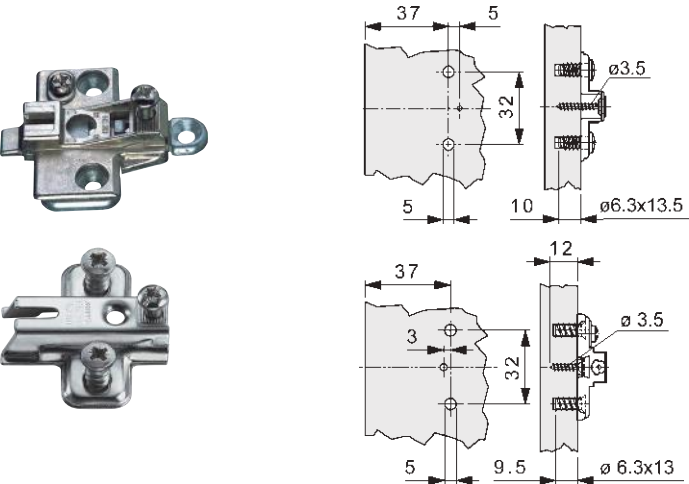

Nexis 73		Opening Angle 270°		Screw-On		Dowelled	
Full Overlay	Cranking 00	Pattern	Type	Item No.	Item No.	PU	
	Hinge cup: diecast, nickel-plated	48	Hold-close	F016073084225	F016073094225	125	
	Hinge arm: diecast, nickel-plated						

Base Plates, 2 and 3-Point Fixing



Height	Description	Item No.	PU
00	Zinc die-cast, nickel plated for Euro Screw	F063073357236	250

Height	Description	Item No.	PU
00	Steel, nickel plated with pre-attached Euro Screws	F062073316236	250

Cover Caps	Cranking 08 and 15	Item No.	PU	Wood Screw, Nickel-plated	Item No.	PU	
	Black plastic	F069073497261	1000		#6 x 5/8" FHP, NI	81001-43	500

PU - Packaging unit



GRASS America Inc.
1202 NC Highway 66 South
Kernersville, NC 27284

Phone: 1-800-334-3512
Fax: 1-800-525-8406

www.grassusa.com
info@grassusa.com

GRASS Canada Inc.
10 Newgale Gate, Unit 7
Toronto, ON M1X 1C5

Phone: 1-800-461-4975
Fax: 1-416-335-5907

www.grasscanada.com
info@grasscanada.com

