

# Comfort Series

## SUBMITTAL DATA

TOP VIEW

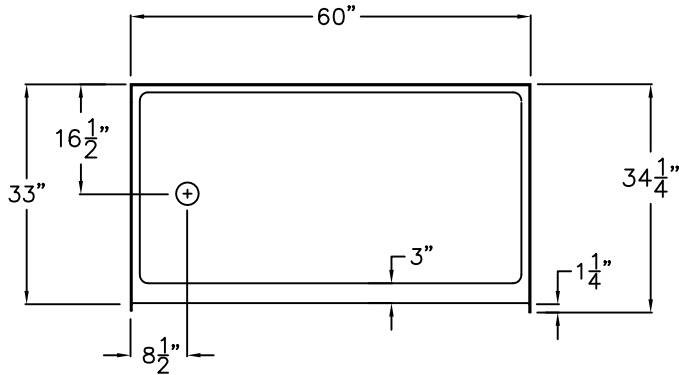

SIDE VIEW

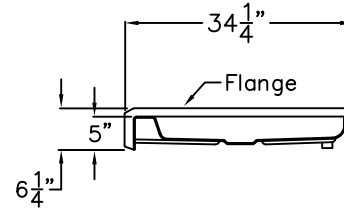

FRONT VIEW

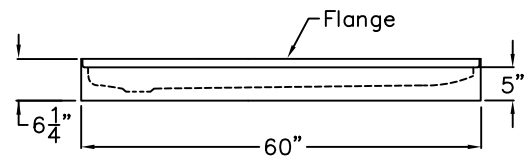

### Shower Pan

This shower pan shall be Praxis Model G 6033 SH PAN right or left. Finished surface shall be of sanitary-grade applied acrylic. The unit shall have outside dimensions of 60" x 34 1/4" x 6 1/4". The unit shall meet IAPMO Z124-2011, and CSA B45.5-11.

The enclosure shall be equipped with the following factory installed accessories:

- 1) Right or left hand drain,
- 2) Mounting flange,
- 3) 5.0" threshold.

DUE TO THE NATURE OF THE MATERIALS INVOLVED  
UNIT DIMENSIONS MAY VARY ± 1/2 INCH

Job Name:	PRAXIS
Approved By Print Name:	Drawing#: G 6033 SH 5.0 PAN
Approved By Signature:	Date: 8-25-14      Revised: 11-16-16
Rep.:	Wholesaler:      Quote No.

PRAXIS INDUSTRIES, INC.  
ROUTE 1, BOX 46D - SAVANNAH, TN 38372  
1 (800) 443-7269 - FAX (901) 925-4290