

EZ-WALL TRIM KIT INSTALLATION

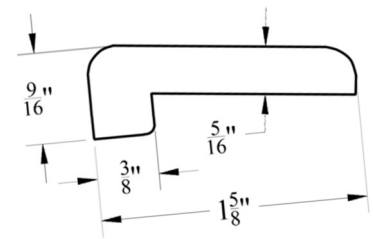

After attaching your new Clarion tub or shower unit in to your prepared pocket you can complete your installation by trimming out the attachment flanges with Clarion Bathware's EZ-Wall Trim Kit. Our trim kit is a composite material that is impervious to water, can be attached with silicon caulking, finishing nails or screws, and can be painted to match your décor.

The EZ-Wall Trim is available in Large (5 pieces @ 84" Ea) or Small (4 Pieces @ 84" Ea) kits. If the depth of the unit (at "BH" or "CH" is greater than 38", a Large EZ-Wall Trim Kit will be used. The EZ-Wall Trim Kit pre-cut pieces, some mitered, are listed below:

Vertical face pieces (Qty 2) - "E" & "F"
-each piece has one end mitered at 45°

Horizontal side pieces (Qty 2) - "BH" & "CH"
-each piece will have one end mitered at 45°
- in small kits these will be cut from single piece "H"
- "H" has (2) 45° mitered ends

Horizontal back piece (Qty 1) - "A"
-no ends are mitered

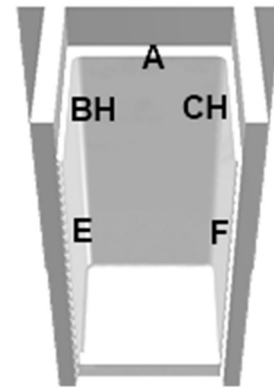

Additional trimming with a saw or sharp knife will still be required to allow for a proper fit.

- 1) Measure and cut the horizontal back piece "A" to fit along the back wall of the shower unit and against the dry wall finish (See Fig 1). Install using preferred technique.
- 2) Install both horizontal side pieces "BH" and "CH" along the side walls of the shower unit and against the dry wall finish with the edge angled end facing the front opening of the shower. The back of these pieces will need to be trimmed to fit prior to installation. They are intentionally left long for construction variances.
- 3) Finally install the Vertical side pieces "E and F" over the front flanges of the shower unit. The bottom of these pieces will need to be trimmed to fit prior to installation. They are intentionally left long for construction variances.

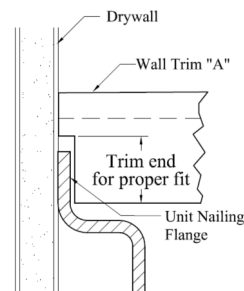

Fig. 1

