



Shower Bases

cast acrylic | AcrylX™ | solid surface

SHOWER BASES AcrylX™ | solid surface | cast acrylic

PG 2 **AcrylX™** patent pending technology

PG 12 **MY PLACE** barrier free accessible & code compliant shower bases

PG 20 **CAST ACRYLIC** thermal cast acrylic

PG 22 **WATER RETAINMENT** accessories

PG 23 **THRESHOLD** details

PG 24 **EASYBASE™** information



WARRANTY

Cast acrylic bases are warranted for five years.
AcrylX™ bases have a lifetime limited warranty.
CenturyStone™ Solid Surface have a lifetime warranty.

For custom installations, consult with your builder or contractor.



THE PERFECT COMPLIMENT for tile or marble

Strong, Long Lasting,
Seamless, Non-Porous,
Lifetime Limited Warranty



MPB 6030 BF shown in CenturyStone™ solid surface NATURALS cotton seed

- CenturyStone™ **NATURALS**
-  starlight
 -  rabbit
 -  quail
 -  cotton seed
 -  ashley
 -  almond granite
 -  beach
 -  dune
 -  mink
 -  violet
 -  coco
- CenturyStone™ **SOLIDS**
-  white
 -  biscuit
 -  bone

upgrade to **SOLID SURFACE**

CenturyStone™ solid surface finishes are offered in white, bone or biscuit to compliment any interior design scheme.

CenturyStone™ solid surface goes one step beyond and is offered in granite NATURALS seamless simulated solid surface finishes.

Solid surface shower bases are beautifully designed in CenturyStone™ solid surface, and are the perfect compliment for tile or marble.

APPEAL Renewable solid surface is easy to clean. Solid surface is seamless, durable and the non-porous surface resists stains and odors.

ADVANTAGES Praxis quality construction, traditional bath replacement sizes, shower bases available as left, right or center drain units, and a double entry base unit, barrier free and low threshold EasyStep™ bases available with No-Flex™ bottoms.

EASY INSTALLATION No mud set required with EasyBase™ factory reinforced, self-sustaining shower base - available on barrier free bases only.

WARRANTY CenturyStone™ solid surface bases offer a lifetime limited warranty.

NOTE: Solid Surface upgrade is available for AcrylX™ bases only.



G 6034 TR PAN shown above in AcrylX™ white

AcrylX™ shower bases



AcrylX™ SHOWER BASES

AcrylX™ finishes offered standard in white, bone or biscuit to compliment any interior design scheme. Solid Surface is available as an upgrade.

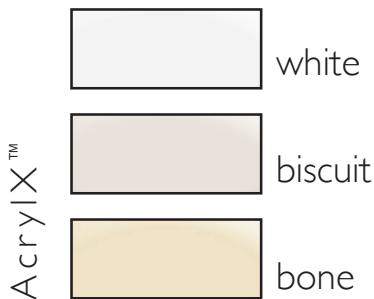

AcrylX™ shower bases are beautifully designed utilizing Patent Pending technology, and are the perfect compliment for tile or marble.

APPEAL The superior finish of AcrylX™ has a visibly true white, deep lustrous finish to better match white porcelain fixtures- providing a more aesthetic appeal to bathrooms. AcrylX™ product will resist scratching, cracking and chipping and will maintain a “factory-new” finish over its lifetime. This means a more beautiful bathroom for years to come.

ADVANTAGES Praxis quality construction, traditional bath replacement sizes, shower bases available as left, right or center drain units, and a double entry base units with low threshold EasyStep™ bases available with No-Flex™ bottoms.

WARRANTY AcrylX™ bases have a lifetime limited warranty.



G 5434 SH PAN 54" x 34" x 6"
AcryIX™ shower base with 5" EasyStep™ threshold.

HANDED center drain
WEIGHT 68



G 3660 SH IS PAN 36" x 60" x 19"
AcryIX™ shower base with one seat and 5" EasyStep™ threshold.

HANDED center drain
WEIGHT 76



G 4836 SH IS PAN 48" x 36" x 19"
AcryIX™ shower base with one seat and 5" EasyStep™ threshold.

HANDED seat
WEIGHT 84



G 6036 SH IS PAN 60" x 36" x 19"
AcryIX™ shower base with one seat and 5" EasyStep™ threshold.

HANDED seat
WEIGHT 97

G 7236 SH IS PAN 72" x 36" x 19"
AcryIX™ shower base with one seat and 5" EasyStep™ threshold.

HANDED seat
WEIGHT 96

upgrade to **SOLID SURFACE**

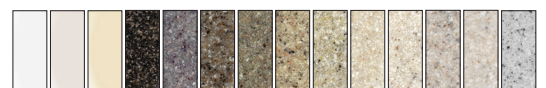



G 4836 SH DE PAN 42" x 36" x 6"
AcryIX™ double entry shower base with EasyStep™ 5" threshold.

HANDED entry side - front left or front right
WEIGHT 56



G 4842 SH PAN 48" x 42" x 6"
AcryIX™ shower base with EasyStep™ 5" threshold.

HANDED center drain
WEIGHT 66



G 9648 SH IS PAN 96" x 48" x 25.25"
AcryIX™ shower base with 7.75" threshold.

HANDED center drain
WEIGHT 70



G 6032 TR L/R 59.5" x 31.75" x 3"
AcryIX™ trench drain shower base with 3" threshold.

HANDED left or right drain
WEIGHT 69

G 6034 TR L/R 59.5" x 33.75" x 3"
AcryIX™ trench drain shower base with 3" threshold.

HANDED left or right drain
WEIGHT 71



AcrylX

Superior Finish

Exceptional Strength

Truer White

SAFE. ACCESSIBLE.
BATHING SOLUTIONS.

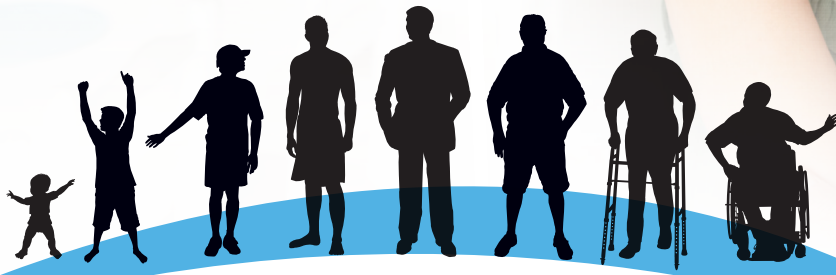

MyPlace™ AcrylX™ shower bases



ACCESSIBLE SHOWER BASES

AcrylX™ finishes are offered in white, bone or biscuit to compliment any interior design scheme. Solid Surface is available as an upgrade.



APPEAL A new collection of classically styled shower pans offers a realistic approach towards renovation with a focus on accessibility.

The Praxis My Place shower base collection is designed for those who value independence- no matter what your place in your life.

With the Praxis My Place collection, you can have the best of both worlds - beauty and safety- bathware that makes living life easier.

ADVANTAGES Praxis quality construction, traditional bath replacement sizes, shower bases available as left, right or center drain units, and a double entry base unit, barrier free and low threshold EasyStep™ bases available with No-Flex™ bottoms.

EASY INSTALLATION No mud set required with EasyBase™ factory reinforced, self-sustaining shower base - *available on barrier free bases only.*

WARRANTY My Place bases have a lifetime limited warranty.



MPB 3838 BF .5 38.625" x 38.4375" x 4.5"
 ADA compliant AcryIX™ shower base with 1/2" barrier free threshold.

HANDED center drain
 WEIGHT 85
 CODES ADA, ICC ANSI, ANSI I 17.1, MAS, TAS



MPB 5430 BF 1.0 L/R 54" x 31" x 4.25"
 AcryIX™ shower base with 1" barrier free change of level. Change of level threshold has a manageable 1/4" vertical rise to easily coordinate with minimum finished flooring.

HANDED drain left or right
 WEIGHT 56
 CODES IPC, UPC, ANSI Z 124.2



MPB 5436 BF 1.0 L/R 54" x 36.875" x 4.25"
 AcryIX™ shower base with 1" barrier free change of level. Change of level threshold has a manageable 1/4" vertical rise to easily coordinate with minimum finished flooring.

HANDED drain left or right
 WEIGHT 58
 CODES IPC, UPC, ANSI Z 124.2



MPB 6232 BF .75 62.4375" x 32.25" x 4.5"
 AcryIX™ shower base with 3/4" barrier free change of level. Change of level threshold has a manageable 1/4" vertical rise to easily coordinate with minimum finished flooring.

HANDED center drain
 WEIGHT 102
 CODES ADA, ICC ANSI, ANSI I 17.1, MAS



upgrade to **SOLID SURFACE**

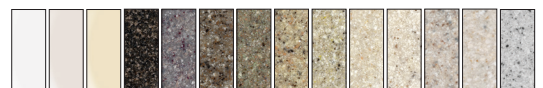



MPB 6232 BF 1.0 LR 62.438" × 32.25" × 4.5"
AcrylX™ shower base with 1" barrier free change of level. Change of level threshold has a manageable 1/4" vertical rise to easily coordinate with minimum finished flooring.

HANDED left or right drain
WEIGHT 62
CODES IPC, UPC, ANSI Z 124.2



MPB 6238 BF .75 62.4375" × 38.25" × 4.5"
AcrylX™ shower base with 3/4" barrier free change of level. Change of level threshold has a manageable 1/4" vertical rise to easily coordinate with minimum finished flooring.

HANDED center drain
WEIGHT 110
CODES ADA, ICC ANSI, ANSI 117.1, MAS, CAL-24



MPB 4836 BF .875 48" × 37" × 4.5"
AcrylX™ shower base with 7/8" barrier free change of level. Change of level threshold has a manageable 1/4" vertical rise to easily coordinate with minimum finished flooring.

HANDED center drain
WEIGHT 96
CODES IPC, UPC, ANSI Z 124.2



MPB 4848 BF DE 1.0 C 50" × 50" × 4.5"
AcrylX™ double entry shower base with 1" barrier free change of level. Change of level threshold has a manageable 1/4" vertical rise to easily coordinate with minimum finished flooring.

HANDED center drain
WEIGHT 102
CODES IPC, UPC, ANSI Z 124.2



MPB 5050 BF 1.0 C 50.5" x 50.125" x 4.25"

AcrylX™ shower base with 1" barrier free change of level. Change of level threshold has a manageable 1/4" vertical rise to easily coordinate with minimum finished flooring.

HANDED center drain
 WEIGHT 84
 CODES IPC, UPC, ANSI Z 124.2



MPB 6030 BF .75 C 60" x 31" x 4.25"

AcrylX™ shower base with 3/4" barrier free change of level. Change of level threshold has a manageable 1/4" vertical rise to easily coordinate with minimum finished flooring.

HANDED center drain
 WEIGHT 96
 CODES IPC, UPC, ANSI Z 124.2



MPB 6030 BF 1.0 LR 60" x 31" x 4.5"

AcrylX™ shower base with 1" barrier free change of level. Change of level threshold has a manageable 1/4" vertical rise to easily coordinate with minimum finished flooring.

HANDED left or right drain
 WEIGHT 96
 CODES IPC, UPC, ANSI Z 124.2



MPB 6033 BF .75 C 60" x 33.375" x 4.5"

AcrylX™ shower base with 3/4" barrier free change of level. Change of level threshold has a manageable 1/4" vertical rise to easily coordinate with minimum finished flooring.

HANDED center drain
 WEIGHT 96
 CODES IPC, UPC, ANSI Z 124.2

upgrade to **SOLID SURFACE**

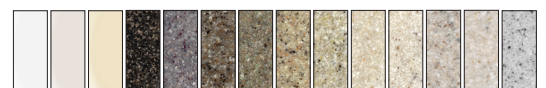



MPB 6033 BF 1.0 LR 60" × 33.375" × 4.5"
AcrylX™ shower base with 1" barrier free change of level.
Change of level threshold has a manageable 1/4" vertical rise
to easily coordinate with minimum finished flooring.

HANDED left or right drain
WEIGHT 96
CODES IPC, UPC, ANSI Z 124.2



MPB 6036 BF .875 C 60" × 37" × 4.5"
AcrylX™ shower base with 7/8" barrier free change of level.
Change of level threshold has a manageable 1/4" vertical rise
to easily coordinate with minimum finished flooring.

HANDED center drain
WEIGHT 103
CODES IPC, UPC, ANSI Z 124.2



MPB 6036 BF 1.0 LR 60" × 36.875" × 4.5"
AcrylX™ shower base with 1" barrier free change of level.
Change of level threshold has a manageable 1/4" vertical rise
to easily coordinate with minimum finished flooring.

HANDED left or right drain
WEIGHT 103
CODES IPC, UPC, ANSI Z 124.2



MPB 6048 BF .875 60" x 49" x 4.5"

AcrylX™ shower base with 7/8" barrier free change of level. Change of level threshold has a manageable 1/4" vertical rise to easily coordinate with minimum finished flooring.

HANDED center drain
 WEIGHT 124
 CODES IPC, UPC, ANSI Z 124.2



MPB 6060 BF DE 1.25 61" x 61" x 4.5"

AcrylX™ double entry shower base with 1 1/4" barrier free change of level. Change of level threshold has a manageable 1/4" vertical rise to easily coordinate with minimum finished flooring.

HANDED center drain
 WEIGHT 166
 CODES IPC, UPC, ANSI Z 124.2



MPB 6060 BF 1.125 60" x 61" x 4.5"

AcrylX™ shower base with 1 1/8" barrier free change of level. Change of level threshold has a manageable 1/4" vertical rise to easily coordinate with minimum finished flooring.

HANDED center drain
 WEIGHT 166
 CODES IPC, UPC, ANSI Z 124.2

upgrade to **SOLID SURFACE**

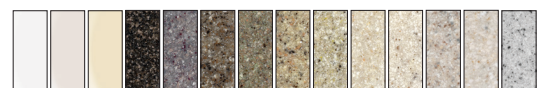



MPB 3260 SH 4.0 60" × 32" × 22"
 AcrylX™ shower base with 4" EasyStep™ threshold. Left or right molded seat is at 21" for comfort and compliments the integrated foot ledge.

HANDED left or right seat
 WEIGHT 151
 CODES IPC, UPC, ANSI Z 124.1



MPB 3060 SH 4.0 60" × 33" × 14"
 AcrylX™ shower base with 4" EasyStep™ threshold. Features a stylish bow front and tile pattern on back wall.

HANDED center drain
 WEIGHT 96
 CODES IPC, UPC, ANSI Z 124.2



MPB 6032 SH IS 4.0 60" × 33" × 27.25"
 AcrylX™ shower base with 4" EasyStep™ threshold. Left or right molded seat is at 21" for comfort and compliments the integrated foot ledge. Features tile pattern on back wall.

HANDED left or right seat
 WEIGHT 151
 CODES ANSI 124.2, UPC, NAHB, CSA



MPB 3648 SH IS 4.0 62.4375" × 32.25" × 22.5"
 AcrylX™ shower base with 4" EasyStep™ threshold. Left or right sculpted seat is at 21" for comfort and compliments the integrated soap and foot ledge. Features tile pattern on back wall.

HANDED left or right seat
 WEIGHT 170
 CODES ANSI 124.2, UPC, NAHB, CSA



CAST ACRYLIC FINISHES

Standard premium cast acrylic finishes are offered in white, bone or biscuit to compliment any interior design scheme.



CAST ACRYLIC shower bases

Cast acrylic shower bases are beautifully designed in high gloss premium thermal cast acrylic, and are the perfect compliment for tile or marble.

APPEAL High gloss cast acrylic is non-porous and easy to clean.

ADVANTAGES Praxis quality construction, traditional bath replacement sizes, shower bases available as corner units, left, right or center drain units, and a double base unit, sturdy No-Flex™ bottom.

EASY INSTALLATION Substantial and durable cast acrylic flanges along with pre-levelled bases and no mud set required.

WARRANTY Five year limited warranty.

CAST ACRYLIC shower bases



AB 3672 36.25" x 71.75" x 7.125"
Acrylic shower double base with 6" EasyStep™ threshold.

HANDED center drain
WEIGHT 68



ABC 3838 38" x 38" x 5.25"
Acrylic corner shower base with 4" EasyStep™ threshold.

HANDED center drain
WEIGHT 68

ABC 4242 42" x 42" x 7.25"
Acrylic corner shower base with 6" EasyStep™ threshold.

HANDED center drain
WEIGHT 69



AB 3636 36" x 36" x 7.25"
Acrylic shower base with 6" EasyStep™ threshold.

HANDED center drain
WEIGHT 68

AB 4242 42" x 42" x 7.25"
Acrylic shower base with 6" EasyStep™ threshold.

HANDED center drain
WEIGHT 67



AB 3448 48" x 34" x 5.25"
Acrylic shower base with 4" EasyStep™ threshold.

HANDED center drain
WEIGHT 67

AB 3460 60" x 34" x 5.25"
Acrylic shower base with 4" EasyStep™ threshold.

HANDED center drain
WEIGHT 81



AB 6032 60" x 32" x 7.25"
Acrylic shower base with 6" EasyStep™ threshold.

HANDED left, right drain
WEIGHT 83

AB 4260 60" x 42" x 6.25"
Acrylic shower base with 4" EasyStep™ threshold.

HANDED center drain
WEIGHT 81

AB 6032 60" x 32" x 7.25"
Acrylic shower base with 6" EasyStep™ threshold.

HANDED center drain
WEIGHT 83

CONTROL WATER SPILLAGE HELP PREVENT FALLS

Preventing water spillage is a must. Safety is increased by retaining water in the shower areas to keep the rest of the area dry. Praxis offers the most effective forms of water retainment - the collapsible dam, semi-permanent dam and weighted shower curtains.



collapsible dam with vertical end caps



collapsible dam self-adhesive



collapsible dam flexes easily



semipermanent dam



premium weighted shower curtain

COLLAPSIBLE DAM with end caps

Designed specifically for barrier-free, curbless showers and shower bases that require water control. When combined with a weighted shower curtain, the flexible collapsible dam prevents water spillage. The collapsible dam collapses easily by foot or wheelchair and returns to the original shape after it has been rolled or stepped on. The collapsible dam size is customized to your shower or base- you cut the strip to the length you need. Self-adhesive, double-sided, water resistant tape on the bottom ensures a secure seal. Praxis collapsible dams are certified bacteria resistant. End caps for showers and bases with radius or square end walls are available.

SEMIPERMANENT DAM

Semipermanent dams are custom made to fit each shower base and are siliconed in place. The semipermanent dam allows for a low step entry into the shower and excellent water spillage protection. Since the dams are siliconed in place, dam can be removed and reused if necessary.

WEIGHTED SHOWER CURTAIN

Premium weighted shower curtains are necessary for a complete water retainment system to work properly. Praxis offers heavy gauge institutional grade shower curtains that contain one inch heavy tape weights embedded in the bottom seam of the curtain. When combined with a collapsible dam or semipermanent dam, the weighted curtain will catch the top of the dam and the curtain will be prevented from blowing out over the dam. The curtains are sized 15% larger than the shower opening for effective containment.

THRESHOLD details

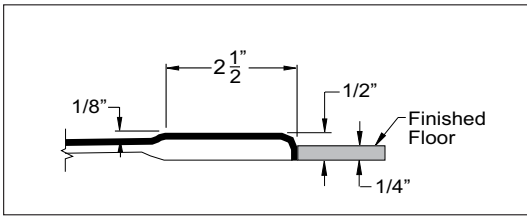

0.5" Barrier Free

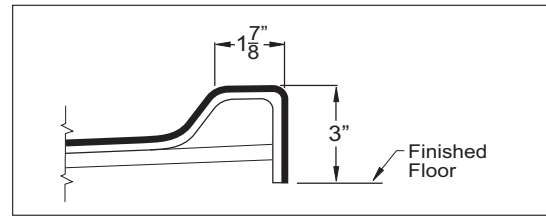

3" EasyStep™

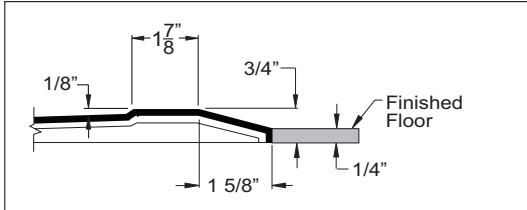

0.75" Change of Level*

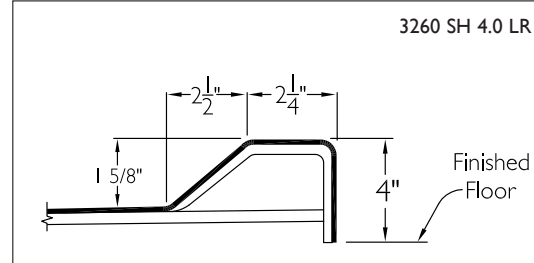

4" EasyStep™

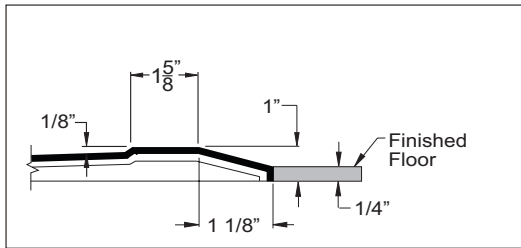

1" Change of Level*

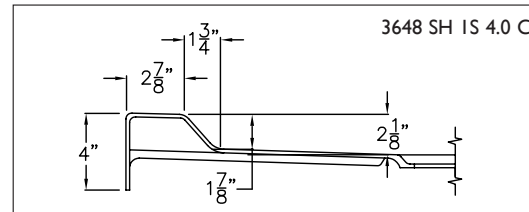

4" EasyStep™

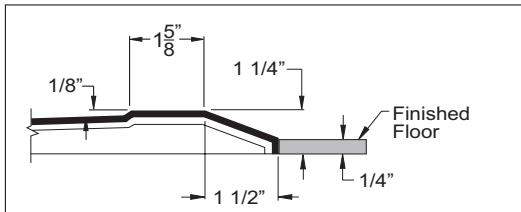

1.25" Change of Level*

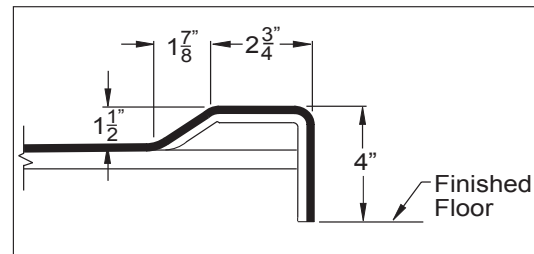

4" EasyStep™

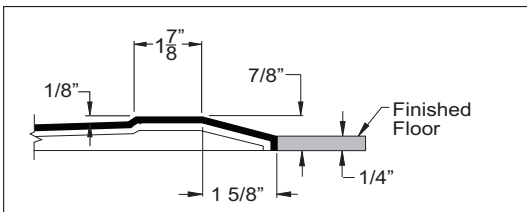

0.875" Change of Level*

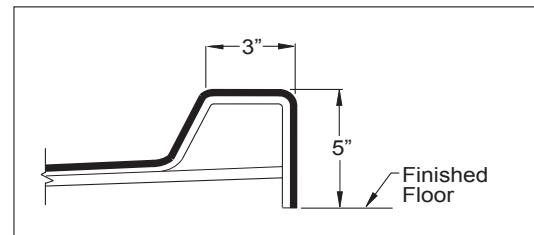

5" EasyStep™

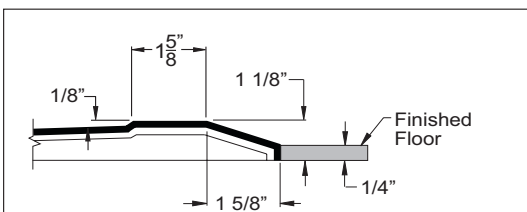

1.125" Change of Level*

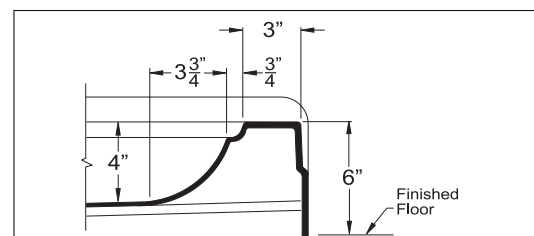

6" EasyStep™

* Change of level threshold has a manageable 1/4" vertical rise to easily coordinate with minimum finished flooring.



hamiltonbathware.com
customer service: 800.443.7269



Hamilton Bathware is a proud member of the ABG Family – **Building a Better Bathware Industry**