

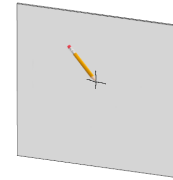

## Round Soap Dish –

Installation Instructions – Access to Front only

1. Read through entire directions before beginning installation.
2. Determine the location where you would like to mount the soap dish. Keep in mind on certain units the framing members of the framing pocket may interfere with the installation of the soap dish, avoid mounting the soap dish where the framing members are located.
3. Mark the centerpoint of the soap dish (**Fig. 1**), you may wish to drill a pilot hole on the center mark with a 1/4" drill bit, if using a hole saw.
4. Drill or cut a 6" diameter hole using a hole saw, jig saw with fine tooth blade, or rotary tool (**Fig. 2**).
5. The soap dish and bracket should come preassembled. If so skip to **Step 8**.
6. Center the mounting bar behind the soap dish (**Fig. 3**) so that the flanges of the mounting bar and soap dish are parallel, and the groove in the mounting bar is aligned with the mounting screw holes.
7. Start the mounting screws into the groove in the mounting bar through the mounting screw holes; allow 1/4" of screw to protrude behind the mounting bar.
8. Apply a 1/4"- 3/8" bead of 100% silicone caulking to the backside of the soap dish around the perimeter (**Fig. 4**).
9. Push the screws completely through the holes so that there is a gap between the mounting plate and soap dish. Start one end of the mounting plate through the 6" hole, and tip the other end through the hole.
10. Center and level the soap dish, then tighten the screws until the soap dish is secure (**Fig. 5**).
11. Clean up any excess silicone caulking and verify the location and level of the soap dish is correct; allow the silicone to cure before using the soap dish.



(Fig. 1)

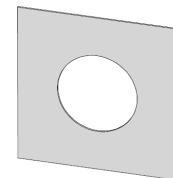

(Fig. 2)

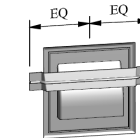

(Fig. 3)

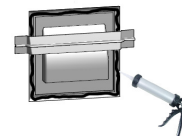

(Fig. 4)

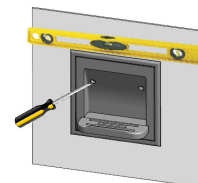

(Fig. 5)

**IF THERE ARE ANY QUESTIONS CONCERNING INSTALLATION OF THIS PRODUCT, WE URGE THAT THE INSTALLER CONTACT CLARION BATHWARE'S CUSTOMER SERVICE DEPARTMENT AT (800) 576-9228 Ext. #5218.**