

# QZSB-2522

## Granite Single Bowl Kitchen Sink



### Manufactured from Quartz

Recommended for high-use traffic areas and commercial surfaces.

### FEATURES

- Made with 80% quartz stone, only a diamond is harder.
- Virtually indestructible, will not damage from kitchen use.
- Standard sink size.
- Ideal for remodeling or new construction.
- Offers design flexibility, installs as a drop-in or undermount.
- Warranty: Limited Lifetime – Residential  
Limited 10-year – Commercial

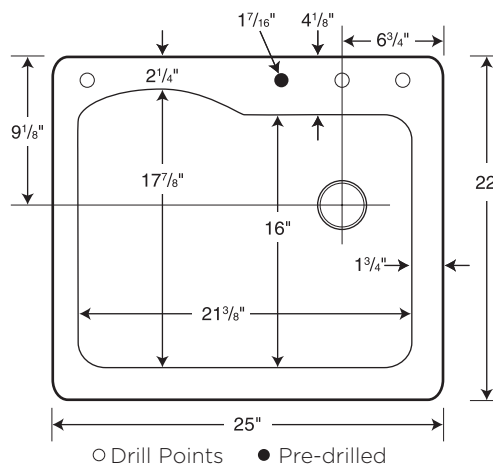
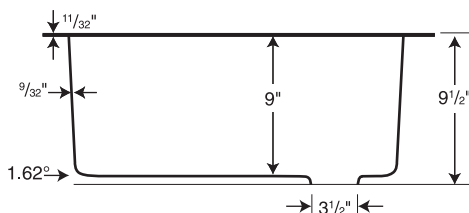

Capacity: 13 gallons

### SPECIFICATIONS

Model	Part	Nominal Dimensions	Ship Wt. Lb.	Ship FedEx	Carton Dims. In.	Cu. Ft.
QZSB-2522	QZ02522SB	25" W x 22" D (635 mm x 559 mm)	37	FedEx	28 x 25 x 14	5.7

### COLORS

- Opal White (210)
- Espresso (170)
- Granito (076)
- Metallico (173)
- Nero (077)

### STANDARDS AND RATINGS

American National Standard Institute—ANSI Z124.6

International Association of Plumbing and Mechanical Officials (IAPMO) – listed

cUPC listed – Certified to CSA Standard B45 by IAPMO

Heat resistance to 392°F, 200°C

### MAINTENANCE AND CLEANING INFORMATION

Clean your Swan Granite Sink by using warm water and a soft clean cloth, or sponge. Non-abrasive liquid cleaners and detergents can also be used. Hard water, calcium and lime deposits can be removed with white vinegar on a paper towel and rinsing after 20 minutes. To restore luster and extend time between cleanings Granite Cleaner & Polish is recommended. Staining liquids, such as dyes and vegetable juices should be rinsed off as soon as possible. **Do not** use abrasive cleaners, metal-scouring pads, and bleach or alkali cleaners, such as ammonia.

### SUPPORT DOCUMENTS

Installation instructions available at [swanstone.com](http://swanstone.com).

Undermount clips sold separately. Faucet options are limited to available hole placement. Please contact your dealer for more information.