

R-36DTF

Veritek® Double Threshold Shower Pans With Fit-Flo™ Drain



Manufactured from Veritek®

FEATURES

- Will not mold or mildew, no grout to clean.
- Coordinates with other Swanstone or Veritek® products.
- Pebbled, slip-resistant surface.
- Made of Veritek® with no surface coating to chip or crack.
- Warranty: Limited Lifetime - Residential
Limited 5-year - Commercial

Model	Nominal Size	Rough-In Dimensions			
		36"	36"	18"	18"
R-36DTF	36" x 36"	36 1/16"	36 1/16"	18 3/16"	18 3/16"

IMPORTANT: Rough-in dimensions are provided for reference only. You must measure the actual shower pan and check local building code requirements before construction of the stud wall.

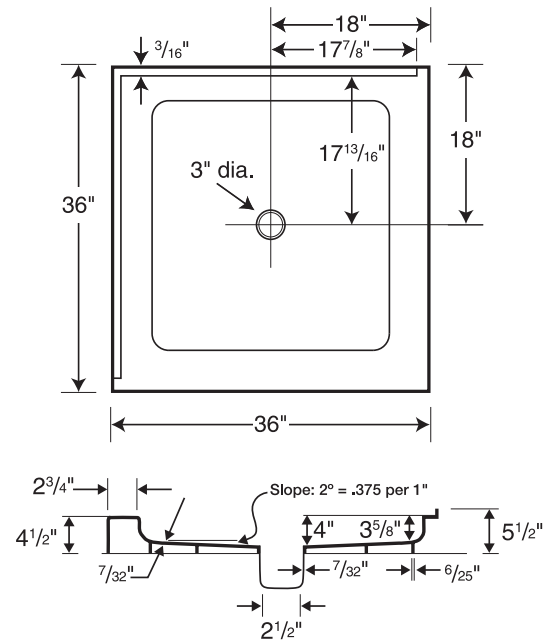

SPECIFICATIONS

Model	Part	Ship Wt. Lb.	Carton Dims. In.	Cu. Ft.
R-36DTF	FD03636MD	44	42 x 41 x 10	10

Includes: One code-approved compression-molded Veritek® shower pan with molded-in Fit-Flo drain.

Packaging: Each pan packed in a rectangular carton.

COLORS

Solid Colors:

- White (010)
- Bisque (018)
- Bone (037)

STANDARDS AND RATINGS

American National Standard Institute—ANSI Z124.1.2

International Association of Plumbing and Mechanical Officials (IAPMO)—Listed

CSA Standard B45.5 by IAPMO

Uniform Plumbing Code (UPC)

For a complete list of tests and results see the Technical Data Sheet.

MAINTENANCE AND CLEANING INFORMATION

Clean regularly with common household liquid cleaners and a sponge or soft cloth. For hard water stains, scale removers can be used. If necessary, abrasive cleaners can be used with a nylon brush or pad to remove build up on the shower pan surface. **Do not** use a metal-scouring pad or a wire brush, as it will damage the surface. **Do not** use "leave on" cleaning products, such as automatic spray shower cleaners. Prolonged contact with harsh chemicals could have an adverse reaction over time and discolor surfaces. **Do not** use cleaning agents that caution use on acrylic, polyester or plastics.

SUPPORT DOCUMENTS

Installation instructions available at swanstone.com.

