

# Swanstone Undermount Vanity Bowls

## Manufactured from Swanstone Solid Surface

Recommended for high-use traffic areas and commercial surfaces.

## FEATURES

- Reinforced solid surface means color and texture run all the way through and cannot wear away.
- Coordinates with other Swanstone products.
- Chemical resistant—acetone will not harm.
- Make-up and hair-dye can be buffed with household cleansers.
- Heat, stain and scratch resistant for lasting beauty.
- Undermount style bowl installs into most countertop materials, including solid surface, tile and granite.
- ADA-compliant when installed to ADA guidelines.
- Warranty: Limited Lifetime – Residential  
Limited 30-year – Commercial

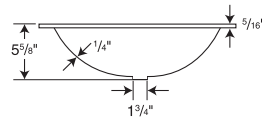
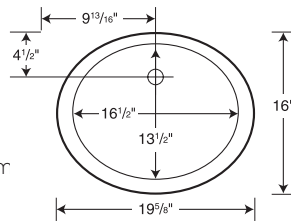

**UL-1613**  
Undermount  
Capacity:  
1 3/4 gallons to overflow

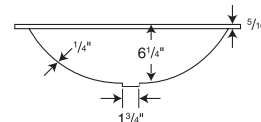
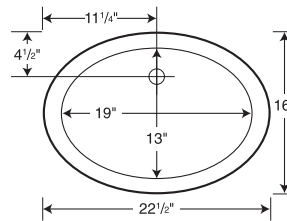

**UL-1913**  
Undermount  
Capacity:  
2 gallons to overflow

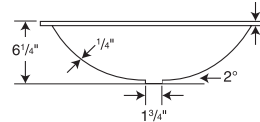
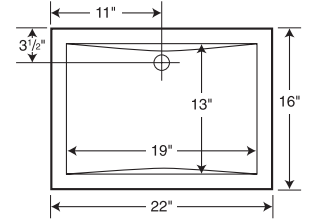

**UC-1913**  
Contour Undermount  
Capacity:  
2 gallons to overflow

## SPECIFICATIONS

Model	Part	Nominal Dimensions	Ship Wt. Lb.	Ship FedEx	Carton Dims. In.	Cu. Ft.
UL-1613	UL01613	13 1/2" D x 16 1/2" W	8	FedEx	26 x 22 x 9	2.98
UL-1913	UL01913	13" D x 19" W	15	FedEx	25 x 21 x 8	2.43
UC-1913	UC01913	13" D x 19" W	14	FedEx	25 x 21 x 8	2.43

**Includes:** One compression-molded vanity bowl.

**Packaging:** Each unit is packed in a rectangular carton.

## COLORS

### Solid Colors:

- White (010)
- Bisque (018)
- Bone (037)

### Aggregate Colors:

- Bermuda Sand (040)
- Black Galaxy (015)
- Carrara (221)
- Concrete Ash Gray (203)
- Concrete Birch (226)
- Concrete Charcoal Gray (209)
- Concrete Clay (212)
- Concrete Limestone (218)
- Concrete Sandstone (215)
- Ice (130)
- Tahiti White (011)

## STANDARDS AND RATINGS

American National Standard Institute—ANSI Z124.3

International Association of Plumbing and Mechanical Officials (IAPMO)—Listed

cUPC listed—Certified to CSA Test Standard B45.5 by IAPMO

Uniform Plumbing Code (UPC)

For a complete list of tests and results see the Technical Data Sheet.

## MAINTENANCE AND CLEANING INFORMATION

Cleaning regularly with common household liquid cleaners is recommended. If necessary abrasive liquids or detergents are safe and effective for use with nylon scouring pads, sponges, Mr. Clean® Magic Eraser® or other similar products. Mineral-stain removers are acceptable as well. **Do not** use metal scouring pads.

## SUPPORT DOCUMENTS

Installation instructions available at [swanstone.com](http://swanstone.com).