

OWNERS MANUAL

Mainstream® 4-Piece Shower Wall Set 2950SWT32

INSTALLATION INSTRUCTIONS

Thank you for selecting American Standard – the benchmark of fine quality for over 150 years. To ensure this product is installed properly, please read these instructions carefully before you begin. Certain installations may require professional help.

INSTALLATION PREPARATION

- Please unpack carefully and identify all parts needed for installation by using the Box Contents as a reference. Inspect the product and report any damages or missing parts immediately to customer care by calling 800-442-1902. Follow the prompts for consumer/bathing products.

NOTE: Take extra care in handling the front surfaces of the walls. Use only non-abrasive cloths to avoid scratching.

- These Mainstream Walls were developed to be installed with Mainstream Shower Bases and Mainstream Shower Doors. If you are using a different base or door, you may need additional hardware and tools to complete the installation.
- Wear protective equipment during installation to avoid injury.
- Please keep these instructions for after care and customer service details.



BEFORE YOU BEGIN

Inspect your product thoroughly before installing. Take extra care in handling surfaces of the walls and use only non-abrasive cloths to avoid scratching. Observe all local plumbing and building codes.

RECOMMENDED TOOLS AND MATERIALS

Installation steps will indicate which tools should be used with associated letter



Level

A



Tape Measure

B

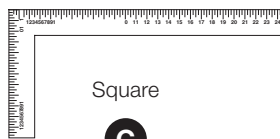

Square

C



Pencil

D



Painter's
Masking Tape

E

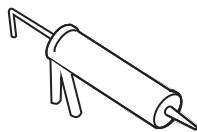

Caulking Gun

F



Hole Saw

G



Safety
Equipment

H

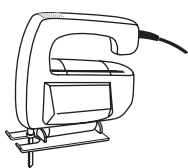

Jig Saw with fine
tooth blade

I

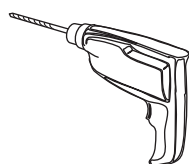

Drill

J

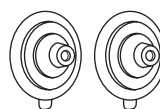

Suction Cups - optional

K

SOLD SEPARATELY
x4 Tubes Waterproof Instant
Grab Construction Adhesive
x2 Tubes Tub & Tile Sealant

INSTALLATION INSTRUCTIONS

IMPORTANT GENERAL INFORMATION

This unit is best installed by two people.

Cover drain with tape prior to installation to prevent the loss of small parts.

Unpack your unit carefully and inspect for freight damage. Lay out and identify all parts using Box Contents as a reference. If any parts are damaged or missing refer to the description noted in the instructions when inquiring about replacements. Be sure to wear safety glasses whenever drilling or cutting.

BOX CONTENTS

1 - 72" x 24" Side Panel

1 - 72" x 24" Rear Panel

1 - 72" x 31.44" Side Panel

1 Corner Panel

1

PREPARATION

PREPARATION: Must be installed over SHEETROCK/GREENBOARD.

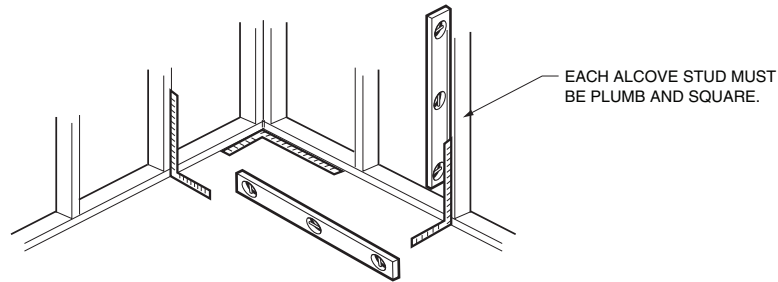

1a. WALL SURFACE PREPARATION

NOTE: For best adhesion, we suggest priming walls prior to installation.

Ensure wall surface is dry, smooth, and free of dust, soap scum, mold or other contaminants. Wipe wall surfaces with a damp cloth and allow to dry. Wall surface must be dry before panels can be applied. Ensure that alcove is plumb and square. (See Illustration)

1b. ROUGH PLUMBING & FITTINGS MUST BE INSTALLED BEFORE WALLS

Turn off hot & cold water supplies. Remove faucet handles, escutcheons, filler spouts and any other fixtures & fittings (e.g. towel bars, soap dishes, etc.).

1c. IF YOU PLAN TO INSTALL A SHOWER DOOR

Follow manufacturer's instructions and prepare stud wall accordingly.

2

DRY FITTING THE PANELS ON THE WALL

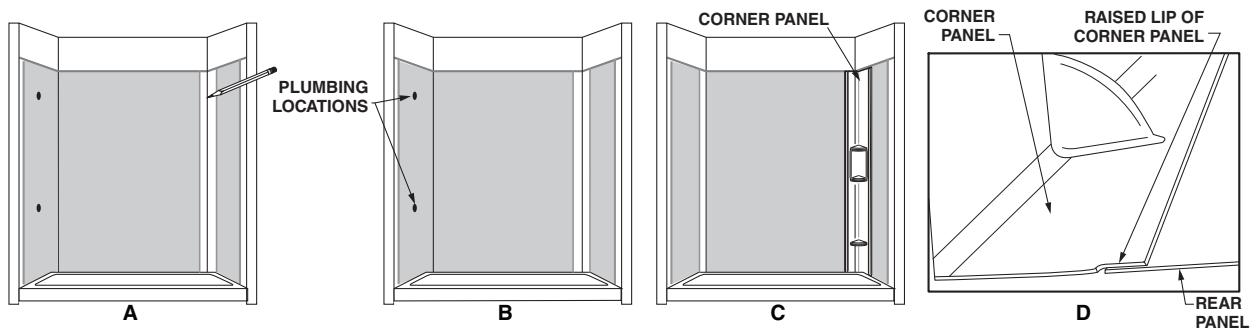

2a. Dry fit the panels starting with the 72" x 24" panel first and determine what corner of the shower the Corner Panel will be installed (left or right). Place the 72" x 24" Rear Panel into the opposite corner of the shower where the Corner Panel will be installed and use masking tape to hold the Rear Panel on the rear wall. Mark a vertical line top to bottom at the corner edges of the panel on the rear wall. (Ref. Illustration A)
NOTE: If any trimming is needed, measure and mark dimensions. Cut with a fine tooth Jig Saw.

2b. When dry fitting 72" x 24" Side Panel, place the panel entrance edge at the desired location on wall while also ensuring a gap or distance no greater than 7-3/4" (197mm) exists at the panel's back corner to the Rear Wall. Use masking tape to hold panel in position. Mark a vertical line top to bottom on the side wall near the corner at back edge of Side Panel to reference later. Place the 72" x 31.44" Side Panel on the opposite side wall into the rear corner and ensure there are no gaps in the corner. Trim panel to fit if needed.
NOTE: Verify that the gap at the rear corner can be covered by the corner panel by dry fitting.
 (Ref. Illustrations C & D)

2c. Once side panels are properly dry fitted, mark all plumbing locations where shower valves come through the side panel. Drill holes at each location using a Hole Saw large enough to accommodate the opening but small enough to be covered by the trim plates. (Ref. Illustration B)

3

INSTALLING BACK AND SIDE WALLS

NOTE: INSTALL ONLY ONE WALL AT A TIME AND REMOVE FILM FROM WALLS PRIOR TO INSTALLATION.

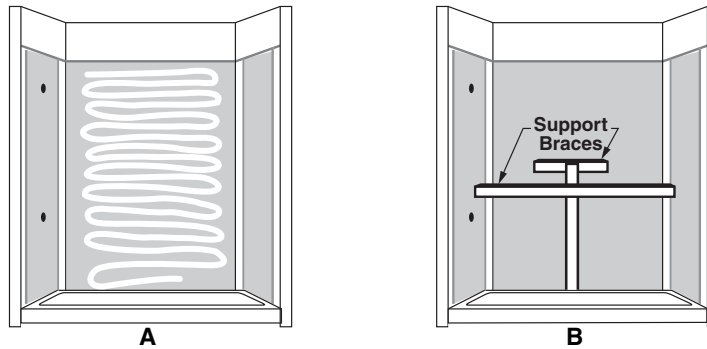

- 3a.** Wipe back side of all panels and walls with a damp cloth to remove any dust or debris and allow to fully dry.
- 3b.** Apply adhesive in a zig-zag pattern on the wall within marked lines, keeping bead thickness to 1/8" (3mm) or less. (Ref. Illustration A)
NOTE: Applying beads of adhesive thicker than 1/8" (3mm) may make it difficult to spread behind the panel once it is up and installed creating a ripple effect on the panel.
- 3c.** Move Rear Panel onto the wall keeping a space of approximately 1/8" (3mm) off of the surface of the shower base and keeping panel between the marked line previously drawn. Press panel firmly over entire surface to ensure firm contact of panel to adhesive on wall. (Ref. Illustration B)
NOTE: It may be necessary to brace or support the panel against the wall until the panel stays securely in place. **Place a cloth under the supports to prevent marring of the walls surface.**
- 3d.** Install side panels in the same manner using the same adhesive pattern. Wipe off any excessive adhesive with mineral spirits.

4

INSTALLING THE CORNER PANEL

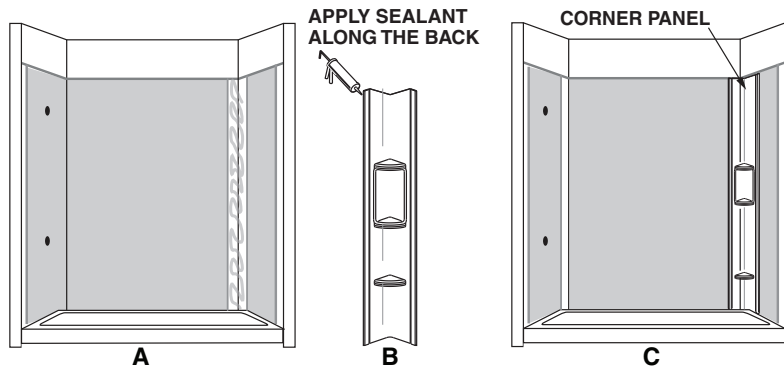

- 4a.** Place Corner Panel into rear corner of shower and check for proper fit to shower walls.
NOTE: Make sure corner panel is aligned right side up so that flat shelving surface is facing upward. Ensure Corner Panel completely overlaps Rear and Side Panels by at least 1/4" (6mm).
- 4b.** Apply adhesive to rear corner (Ref. Illustration A) top to bottom, side to side and on back of the Corner Panel (Ref. Illustration B) and place into rear corner of shower (Ref. Illustration C). Press firmly to hold in place.
NOTE: It may be necessary to brace or support the corner panel in position until the adhesive dries.
Use cloth under any support to prevent any marring of the walls finished surface.
- 4c.** Wipe the panel down with a damp rag while continuing to apply pressure to the panel to ensure it makes complete contact.
NOTE: Wipe any excess adhesive from the panel with a damp rag or mineral spirits.

5

APPLYING SEALANT AND INSTALLING SHOWER HANDLE AND SHOWER HEAD

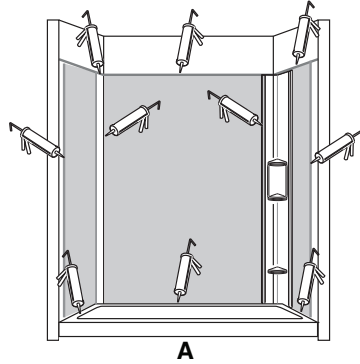

NOTE: Allow 24 hours for the wall panel adhesive to dry before applying the sealant.

5a. Apply a bead of sealant around all corners, outside edges of panels, corner panel and deck of shower base. (Ref. Illustration A)

5b. Install the shower handle and shower head per the manufacturer's instructions. Be sure to apply sealant to all trim plates.

NOTE: ALLOW 24 HOURS FOR THE SEALANT TO DRY BEFORE USE.

Install the shower door or shower curtain rod according to the manufacturer's instructions.

POST INSTALLATION CLEAN-UP

Remove all construction debris. Install any accessories, shelves or doors according to manufacturer's installation instructions.

Post installation clean-up can be completed using 50/50 mixture of isopropyl alcohol and water.

AFTERCARE AND CLEANING

⚠ WARNING: Cleaning products with labels that say "not suitable for use with ABS, acrylic or polystyrene" SHOULD NOT BE USED. Read all labels carefully.

Clean shower walls with warm soapy water and soft sponge. For stubborn stains, use a 50/50 mix of isopropyl alcohol and water.

HARSH CHEMICALS SHOULD NEVER BE USED ON SHOWER WALL SURFACE. Clean after use with a mild liquid household detergent cleaner. **Do not use** Lestoil®, Lysol® Disinfectant (spray or concentrate), or Lysol® Basin, Tub and Tile Cleaner, Windex®, Mr. Clean®, Dow® Disinfectant Bathroom Cleaner, or cleaning products in aerosol cans.

Do not use wire brushes, knives or sharp objects to remove stains or other surface blemishes.

Abrasive cleaners or powders should not be used as they will dull the surface.

Do not allow nail polish remover, acetone, paint remover or other solvents to come into contact with the surface.

Spic And Span® Is A Registered Trademark Of The Spic And Span Company