

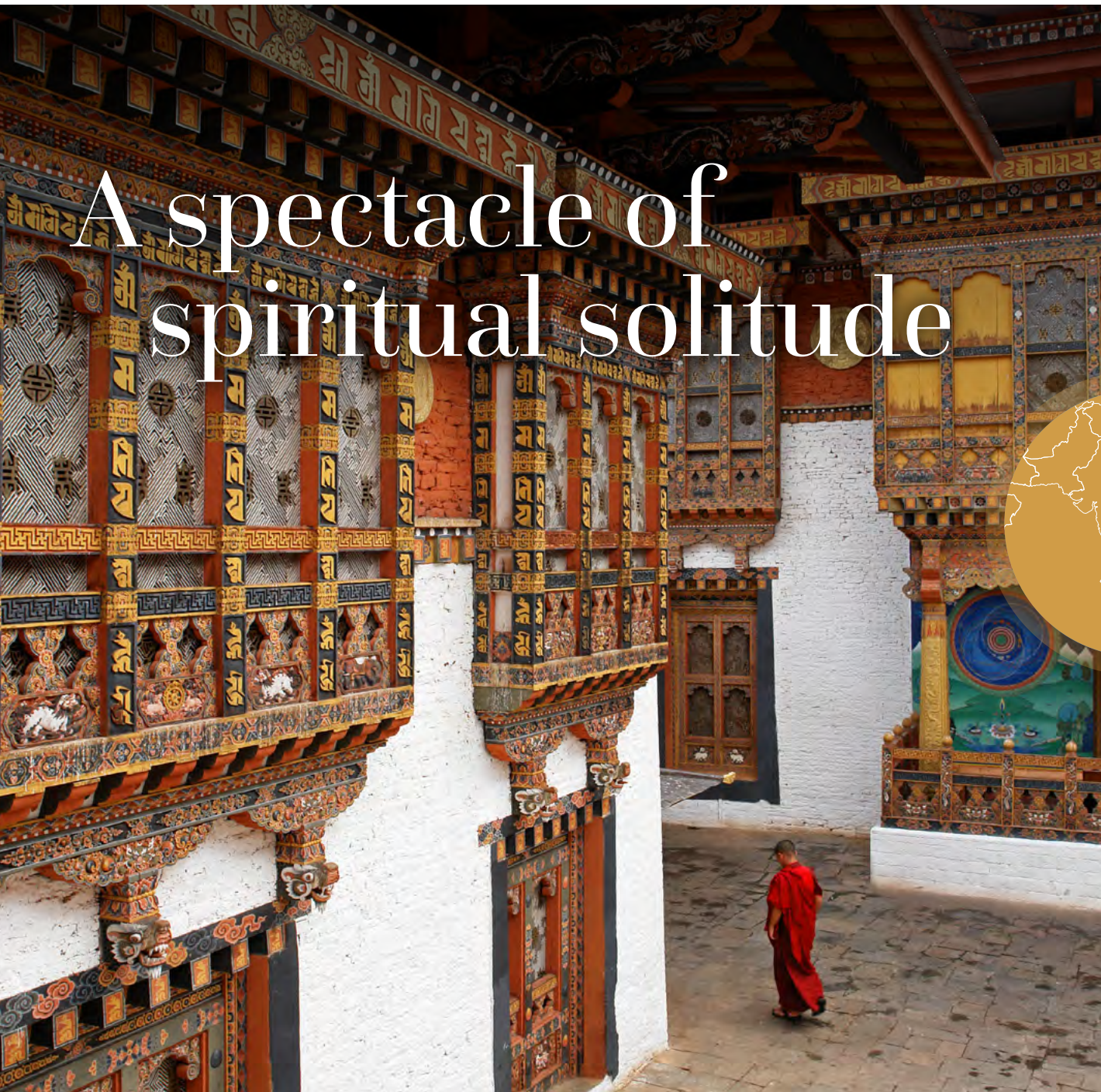

BEYOND

Discover Punakha

IN THE HIMALAYAN KINGDOM OF BHUTAN



A spectacle of spiritual solitude



A historic and cultural wonder, engulfed by lush forested hills and idyllically set at the junction of the eminent Pho and Mo Chu rivers, the ancient capital city of Punakha is steeped in tradition and charm.

DISCOVER PUNAKHA, BHUTAN

Why visit Punakha?

Inextricably connected to Bhutanese history, this wholly-blessed destination is a celebration of tradition and culture, set to captivate even the most discerning traveller.



1

ACTIVE ADVENTURES

Travellers can enjoy myriad excursions; from gentle village strolls, treks over Himalaya passes and off-road mountain bike trails to traditional bow and arrow archery, whitewater river rafting, and seasonal paddy ploughing and planting. Adventures abound in the Punakha Valley suited for the whole family.

2

CULTURAL SPECTACULAR

Punakha is home to the Punakha Dzong; Bhutan's second oldest Dzong, the Khamsum Yuelley Namgyal Chorten; the sacred Buddhist temple, the Punakha Tshechu; one of the country's most popular festivals, and the Sangchhen Dorji Lhuendrup Lhakhang Nunnery; a Buddhist college for nuns. Discover a plethora of historical sites well-worthy of their worldly praise.

3

SPIRITUAL AWAKENING

Spread merit by hoisting colourful prayer flags, rejuvenate your mind and spirit by practicing yoga against a backdrop of the Himalaya, chant sacred prayers with Bhutanese monks, take lessons on Buddhism from a Buddhist master, soothe your inner soul through indigenous therapies and meditation techniques, and light butter lamps for good fortune. Punakha's divine splendour is endless.

4

NATURAL BEAUTY

Recognised as one of the world's few carbon-negative countries, with almost 70% of Bhutan covered in dense forest, it comes as no surprise Punakha too is highly-acclaimed for its varied biodiversity and widely-protected flora and fauna. This area is home to over 600 bird species, including the endangered white-bellied heron, plus the Himalayan black bear, red panda, leopard, and Bengal tiger.

Why travel with &Beyond?

1 TRAVEL WITH HEART
Our core ethos of 'Care of the Land, Wildlife and People' drives all that we do. When you travel with us you make a meaningful contribution to the preservation of our world's cultures and wildlife, and leave with an opportunity to gain first-hand experience in some of our conservation and community initiatives.

2 IN OUR HANDS
We are on call 24/7 to assist you throughout your journey. Over 2 000 &Beyonders, including guides and ground logistic teams on three continents, means that you are in our hands from the moment you arrive to the moment you leave. Additionally, we offer a personal concierge service that is only a phone call away should you require any assistance at any point during your trip.

3 FINEST GUIDES
We operate three ranger training schools and are renowned for having the most highly-trained, professional and knowledgeable guides, rangers, naturalists and trackers, who offer cultural insights as well as interpretive wildlife experiences.

4 TRAVEL EXPERTS
Big or small, we are all about tailoring trips around your specific interests and expectations. Our expert travel specialists are able to personalise a range of experiences for individual travellers, groups, families, wedding parties, and special interest groups.

5 PERFECT MOMENTS
With journeys lovingly crafted of perfect moments, you will return from an &Beyond adventure feeling that nothing will take your breath away quite like this ever again. Our collection of signature experiences are often exclusive to &Beyond, ensuring a unique adventure.



It's far beyond just a holiday. It's an experience, a journey, and a way of life. It is unlike anything we've ever been part of. ”

DISCOVER PUNAKHA, BHUTAN

Travel Bhutan and beyond

Travelling to and around Bhutan requires careful consideration and attention to detail. Contact your preferred travel specialist to assist with your travel plans.



GETTING THERE

TO AND AROUND BHUTAN
Paro International Airport in Paro is Bhutan's sole international airport.

Easily accessible to and from India, Nepal, Thailand and Singapore. All guests flying into Bhutan must fly with Druk Air or Bhutan Airlines. We recommend Druk Air owing to its good international connectivity.

Travel by road is the most common and efficient mode of transport in Bhutan. It is mandatory to travel with a private local guide and driver.

Self-drive and travel is not recommended as the public transport system is not evolved nor suited for international travellers.

TO BEYOND PUNAKHA RIVER LODGE
All guests must fly into Paro International Airport in Paro. At the airport, an Beyond guide will meet and transfer you to the lodge in Punakha (approximately three and a half hours with stops). Helicopter transfers available on request and dependant on availability.

AVERAGE TRAVEL TIMES BY ROAD





PARO			
1hr 15mins	THIMPHU		
3hrs 21mins	3hrs 15mins	PUNAKHA	
4hrs 50mins	3hrs 30mins	2hrs 15mins	GANGTEY
8hrs 30mins*	7hrs 40mins	6hrs 20mins	5hrs 30mins
BUMTHANG			

Timings include sightseeing stops.
*35-minute internal flight available

Explore Punakha, Bhutan

PLACES TO STAY

- 1 Beyond Punakha River Lodge
- 2 Amankora Punakha
- 3 COMO Uma Punakha
- 4 Six Senses, Punakha
- 5 Dhensa Boutique Resort

-  Place of interest
-  Town / village
-  Region boundary
-  Main road
-  River



Regional information

Language	Dzongkha (Bhutanese) is Bhutan's official language and the most widely spoken of Bhutan's 19 national languages.
Currency	The Bhutanese ngultrum is the unit of currency and has the same value as the Indian rupee which is readily accepted in Bhutan.
Altitude	Approximately 1 400 m (4 593 ft) N 27°38'18.32748" E 89°48'9.66924"
Airport	Paro International Airport is approximately three and a half hours from Punakha by vehicle.
Best time to travel	While most popular from March to November, Punakha is a fantastic year-round destination. As a lower-altitude district, Punakha has a much milder all-round climate year-round than its neighbours Thimphu, Paro, and Gangtey, making it a pleasant place to visit even in winter.
Weather	Punakha experiences warm to hot summers (from June to August) and moderate to cool winters (from December to February). June is typically the start of the monsoon season.
Rainfall	Monsoon season (from June to mid-September) is warm with heavy rainfall.
Temperature averages	Winter (December to February): 4°C to 22°C / 42°F to 72°F Summer (June to August): 7°C to 28°C / 45°F to 85°F

Punakha is an incredibly rich and mindful place that truly celebrates the spiritual being. ”





BEYOND

DISCOVER PUNAKHA, BHUTAN

Adventures of a lifetime

Celebrated for its magical treks, traditional phenomena and mystical insights, tailormake your own one-of-a-kind Punakha adventure suited to your travel desires.

DISCOVER PUNAKHA, BHUTAN

Adventures of a Lifetime

For the cultural creatures

A diverse array of captivating experiences provide travellers with a sneak-peek into the enriching and fascinating lives of the Bhutanese people.



1

BHUTAN'S ROYAL PUNAKHA DZONG

Translated to mean 'palace of great happiness or bliss', this 17th-century Dzong is celebrated as one of Bhutan's oldest, largest and most striking fortified monasteries. The first National Assembly was held here in 1953, and all of Bhutan's kings are crowned here before they can take their throne in Thimphu.



2

THE TEMPLE OF THE DIVINE MADMAN

Located on a round hillock on the edge of the Punakha Valley, Chimi Lhakhang was built in 1499 by the 14th Drukpa hierarch, Ngawang Choegyel, after the site was blessed by 'the Divine Madman' the maverick saint, Drukpa Kunley. This Buddhist temple is famously known as a place of fertility.



3

KHAMSUM YUELLEY NAMGYAL CHORTEN

Built by Her Majesty the Queen Ashi Tshering Yangdon, the Khamsum Yuelley Namgyal Chorten houses representations of the tantric form of Buddhist deities that subjugate enemies and ward off harmful influences on the people of Bhutan. Built for the protection of the country and the present king, the chorten also offers impressive views of the valley below.



4

SANGCHHEN DORJI LHUENDRUP LHAKHANG

Steeped in tradition and culture, the Sangchhen Dorji Lhuendrup Lhakhang houses a 4.2 m (14 ft) bronze statue of Avalokiteshvara, made by local Bhutanese artisans. Other sacred statues include those of The Buddha, Guru Rinpoche, Zhabdrung Ngawang Namgyel, Tsela Namsum, and the 21 Taras. It is also a permanent school of higher learning and a meditation centre for nuns.



5

PUNAKHA SUSPENSION BRIDGE

Stretching across the majestic Pho Chu, the Punakha suspension bridge is 180 m (590 ft) in length, making it one of the longest suspension bridges in Bhutan. Strongly strengthened with iron chains and metal netting, this extraordinary bridge adorned in fluttering prayer flags, connects Punakha Dzong to the surrounding villages.

DISCOVER PUNAKHA, BHUTAN
Adventures of a Lifetime

For the eager explorers

Punakha rewards travellers with a plethora of active experiences to choose from that can be tailored according to your personal preference, ability and level of difficulty.



1

DOCHU LA PASS HIKE

Peaking at an impressive 3 140 m (10 302 ft) above sea level, this legendary mountain pass boasts exceptional views of the snow-capped eastern Himalaya on a clear day. From here you can opt to hike through beautiful forests down to the Lampelri Botanical Garden or for something more strenuous, hike up to the Lungchutse Temple.



2

HOKATSHO LAKE HIKE

Beginning at the 15th century temple, Chorten Nyeabu, this two to three hour hike follows a man-made irrigation channel almost all the way to the beautiful Hokatsho Lake tucked between dense jungle vegetation. Upon reaching the lake, a small path leads down to the water, offering magnificent views of the peaceful and untouched surrounds.



3

WHITewater RAFTING*

The Pho Chu offers thrill-seekers a 16 km (9.9 mi) course, loaded with 15 rapids, ranging from class 2 to 4. Its gentler counterpart, the Mo Chu, is 10 km (6.2 mi), with 10 rapids graded class 2. Witness breathtaking views of sub-tropical scenery, plus secluded stretches of serene sparkling water.



4

MOUNTAIN BIKING

Immerse yourself exploring Punakha Valley's sacred, forested landscapes off-road, on two wheels. Ideal for beginners to experienced riders, the area offers an array of mountain bike routes; from easy-going, non-technical single tracks to extreme, adrenaline-pumping off-road trails.



5

BIRDWATCHING

Ideal for first-time or serious birders, Punakha's unique landscape of mountains, hills, rivers and forests offers the perfect landscape to search for native and migratory species in the area. At times, bird calls might lead you to sightings of the common kestrel, pallas fish eagle, crested kingfisher, white-bellied heron, and chestnut-headed tesia, to name a few.



6

ARCHERY

Archery is the national sport of Bhutan, and even more so, a nationwide obsession with every Bhutanese village sporting an archery field. Enjoyed as a group activity, targets are typically set approximately 145 m (475 ft) from the archer, making for a fun experience suited for the whole family.

*This experience is at an additional cost

DISCOVER PUNAKHA, BHUTAN
Adventures of a Lifetime

For the spiritual souls

Become immersed in the Bhutanese culture, taking part in an array of once-in-a-lifetime experiences that offer far beyond the expected.



1

TSHEWANG CEREMONY (TEMPLE OR NUNNERY)*

Take part in a traditional Tshewang (blessing) ceremony held by a Bhutanese monk in a temple or nunnery for personal empowerment and wish fulfilment. The prayer will be approximately 30-minutes, during which you can make an offering by lighting butter lamps at the monastery altar. The sacred ceremony gently ends with the monk giving his blessings and assisting in a private circuit of the holy shrine.



2

GUIDED WALK THROUGH A LOCAL VILLAGE

Step into another culture with a guided walk through a local village. Visit an authentic Bhutanese farmhouse to learn about the local people's traditional farming ways and techniques. A guided village walk is a humbling and enriching experience.



3

TRADITIONAL BHUTANESE COOKING CLASSES*

The Bhutanese food culture is a powerful tradition. While greatly influenced by Indian and Chinese cuisines, Bhutan's food is prepared with its own twist making for an enlightening gastronomic experience. Learn about Bhutan's unique way of preparing food by embarking on a traditional Bhutanese cooking class in the lodge's outdoor interactive kitchen.



4

PICTURESQUE PICNIC EXCURSIONS

Book a private breakfast, lunch or late afternoon picnic for an enlightening experience that not only highlights Bhutan's local cuisine but also its scenic surrounds. Soak in the warming sun with the Mo Chu as your backdrop or lounge lazily in the valley's verdant paddy fields. Other options include picnicking at Khamsum Yuelley Namgyal Chorten or on a guided village walk.



5

THE COLOURFUL PUNAKHA TSHECHU FESTIVAL

The Punakha Tshechu festival is one of Bhutan's most popular celebrations. Celebrated over several days, the festival features an array of dances performed by monks in beautiful costumes and masks. The unfurling of the Thongdrol (a large silk painting) of Guru Rinpoche on the last day is a highlight of the festival for local communities.

*This experience is at an additional cost

DISCOVER PUNAKHA, BHUTAN
Adventures of a Lifetime

For the wellness warriors

Quieten your inner-being and indulge your mind, body and soul in a wide variety of traditional Bhutanese treatments and self-care philosophies.



1

YOGA AND MEDITATION

Balance your chakras and enjoy a meditative yoga session that harmonises the body, mind and spirit. Find your inner peace and enjoy the nature and serenity the area has to offer with the tranquil sounds of the streaming Mo Chu in the background. Classes can be accommodated to suit all levels of experiences and preferred styles, and can be taken in private or as part of a group.

2

WELLNESS TREATMENTS

Unwind and reconnect with a soul-soothing wellness treatment in the lodge's exquisite spa. We have a wide range of indulgent therapies on offer, suited to all wellness needs. All products used are 100% natural, made with only local ingredients.

3

BLESSINGS AND CEREMONIES

Celebrate special occasions, such as weddings, dedications and engagements, with traditional Tshewang (blessing) ceremony held by a Bhutanese monk in a temple or nunnery. The prayer will be approximately 30-minutes, during which you can make an offering by lighting butter lamps at the monastery altar.

4

BHUTANESE HOT STONE BATH

Hot stone baths are imbued in Bhutanese culture. A unique therapeutic healing process, a Bhutanese hot stone bath is typically made from local pinewood and uses Menchu, a traditional medicinal water (fresh river water mixed with Artemisia leaves), and river stones heated by fire. It is believed the process of using the hot stones to heat the cool water releases an array of key minerals with medical benefits.

DISCOVER PUNAKHA, BHUTAN
Adventures of a Lifetime

Seasonal highlights

Punakha is an exceptional year-round destination with four distinct seasons, offering an array of unforgettable activities throughout the year.

YEAR-ROUND ACTIVITIES

- | | | |
|-----------------------------|----------------------------|-------------------------------|
| ✓ Punakha suspension bridge | ✓ Community visits | ✓ Wellness treatments |
| ✓ Festivals | ✓ Guided village walks | ✓ Yoga and meditation |
| ✓ Nunnery and temple visits | ✓ Ceremonies and blessings | ✓ Traditional cooking classes |

TIMING IS EVERYTHING

- | | | |
|-------------------------------------|-----------------------------|--------------------------|
| ✓ Mountain biking* | ✓ Birdwatching | ✓ Kayaking and canoeing* |
| ✓ Trekking and hiking* | ✓ Wildlife viewing | ✓ Helicopter tours* |
| ✓ Traditional bow and arrow archery | ✓ Whitewater river rafting* | |

*These activities are weather dependent and are not available between June and August



DISCOVER PUNAKHA, BHUTAN

Adventures of a Lifetime

Tailormade tours

Our expert travel specialists are able to personalise a range of experiences for individual travellers, groups, families, and special interest groups.

YOUR PRIVATE BHUTAN

For first-time travellers / Punakha | Gangtey | Paro



This immersive 10-day journey through Bhutan highlights a trio of extraordinary areas, each abundant with breathtaking natural beauty, fascinating Dzongs and places of worship.

Your adventure starts in Punakha with phenomenal views of the Himalaya snow-capped peaks, beautiful hikes to Khamsum Yuelley Namgyal Chorten, and Chimi Lhakhang visits. Next, explore Gangtey and the surrounding Phobjikha Valley. Your journey culminates in Paro hiking to the iconic Taktsang Monastery (Tiger's Nest). Your extraordinary adventure through this enchanting country is sure to entice you to return for more.

HIMALAYAN MOUNTAINS TOUR IN BHUTAN

For intrepid travellers / Thimphu | Gangtey | Punakha | Paro



This exceptional 10-day adventure is filled-to-the-brim with awe-inspiring landscapes and experiences, and extensively covers some of Bhutan's finest cultural attractions.

Discover the Himalaya heights of Bhutan, starting in the capital of Thimphu, where you can admire spectacular mountain views, Buddhist monuments and statues. Traditional architecture and ancient monasteries await in Punakha. Stock up on traditional handicrafts, marvel at the magnificent scenery and visit an ancient watchtower in Paro. Strap on your hiking boots for a truly memorable journey to the legendary Taktsang Monastery (Tiger's Nest).

&BEYOND

Punakha River Lodge

Tucked deep in the lush green Punakha Valley,
exclusively draped on the banks of the Mo Chu,
amidst awe-inspiring mountain vistas, a
harmonious blend of tradition and grace await.



&BEYOND



DISCOVER PUNAKHA, BHUTAN
Beyond Punakha River Lodge

Why stay?

1 EXCLUSIVITY ON THE RIVER
Boasting uninterrupted views of the Himalaya, idyllically set on the banks of the Mo Chu, the lodge rewards guests with direct, and exclusive, access to the river. Soft tranquil notes from the nearby perennial stream can be heard from the lodge's exquisite suites.

2 UNLIKE ANY OTHER
Intricately built and delicately furnished, the lodge draws inspiration from its natural surrounds and combines traditional Bhutanesque style with a unique twist, in perfect harmony with its surrounding terrain. Unrivalled luxury with a light footprint, this is Beyond's first lodge in the magnificent Himalayan kingdom of Bhutan.

3 EXTRAORDINARY EXPERIENCES
A unique early-morning adventure, the lodge offers easy access to the Khamsum Yuelley Namgyal Chorten (only a 45-minute hike from the lodge along the river) – a major drawcard for travellers. Other attractions in the area include the famed Punakha Dzong, as well as the Sangchhen Dorji Lhuendrup Lhakhang Nunnery.

4 AN ADVENTURE PLAYGROUND
With over 20 hectares (50 acres) to explore, the lodge and its surrounds are brimming with active adventures making it the ideal base for intrepid outdoor enthusiasts. Choose from an array of activity-based experiences, including archery, river rafting, kayaking, and mountain biking, as well as a wide selection of breathtaking hikes and walking trails.

5 MIND AND SPIRIT
Those looking to be pampered can indulge in a range of restful treatments and wellness therapies in the beautifully positioned lodge spa, lulled by the wonders of the surrounding orchard and foothills. Balance your chakras with a gentle yoga session, or sink into the bliss of a traditional Bhutanesque massage and hot stone bath.



Travelling to Bhutan, and especially Punakha, is an awe-inspiring experience – one that truly gives more than it takes. ”

Lodge amenities



1

DINING LOCATIONS

Enjoy sundowners, a picnic or your meals in a variety of al fresco locations such as the outdoor lodge deck, the swimming pool, amongst the lush paddy fields, overlooking the river, the suspension bridge or the privacy of your suite.



2

SPA TREATMENTS

Set in a tranquil orange orchard with views of snow-capped peaks, we invite you to lay back and relax in our beautifully decorated massage rooms. Spoil yourself with one of our signature Bhutanese treatments at a time that suits you. All wellness products used are 100% natural, made with only local ingredients.



3

YOGA STUDIO

Meditate to the tranquil sounds of the streaming Mo Chu or mindfully flow to the beat of your own heart in the lodge's yoga studio before indulging in a classic Bhutanese massage and hot stone bath in the traditional Bhutanese lodge spa to ease your mind and body.



4

ADVENTURE SHOP

Within the lodge's Adventure Shop, expect to find a range of high-quality, handpicked authentic handicrafts and fashion wear that showcase the very best of the region. Sourced from local artisans, these unique items, such as a range of traditional Bhutanese textiles, provide the perfect memento of your stay in Bhutan.



5

INTERACTIVE KITCHEN

Our food is locally-inspired and seasonal, not to mention, wholesome and delicious. An extensive organic vegetable garden highlights the lodge's dedication to sourcing local, sustainably-grown ingredients. A traditional Bhutanese cooking class in our outdoor interactive kitchen allows you to learn more.



6

SWIMMING POOL

The lodge's sparkling rim-flow swimming pool is incredibly inviting on a warm day. Boasting fantastic views over the river, engulfed by the surrounding mountain ranges, this is the perfect spot to not only refresh yourself, but to also enjoy a delectable Bhutanese meal and beverage.

DISCOVER PUNAKHA, BHUTAN

&Beyond Punakha River Lodge



&BEYOND Punakha River Lodge

- Road
- Footpaths
- Tented Suites

DISCOVER PUNAKHA, BHUTAN

Beyond Punakha River Lodge

Lodge overview

LODGE

Maximum number of guests	20
Number of rooms	9
Room types	6 Tented Suites 1 River House 1 Family Suite
Family accommodation	Children of all ages are welcome 2 triple rooms (for children 16-years and younger only) 1 interconnected Family Suite (max. 4 adults or 2 adults and 2 children – three children on request)
Pilot / Guide accommodation	Yes, only for accompanying tour leaders at an extra cost
WILDchild programme	No
Check-in and check-out times	14h00 / 11h00, with early check-in and late check-out on request
Lodge closure	Open year-round

DINING

Food / Dietary options	Halal meals are available on request While Kosher meals cannot be provided, vegetarian options are readily available. For guests comfortable with halal meat, it can be served with meat and dairy prepared separately Please advise the lodge well in advance of any dietary requirements
Private butler service	Yes
Plated service	Yes
Private dining	Yes

FACILITIES

Power	220v AC (50 Hz) plug points in rooms
Internet access	Yes, Wi-Fi in guest suites
Wine store or cellar	No, but the lodge bar does stock a diverse selection of wine
Boma	No
Fire pit	Yes
Outdoor dining	Yes
Bar	Yes
Interactive outdoor kitchen	Yes
Swimming pool	Yes, lodge swimming pool
Wellness offering	Yes, spa and yoga studio
Fitness centre	No
Conference facilities	No
Wedding and blessings	Yes
Wheelchair accessibility	No wheelchair access
Complimentary laundry service	Yes
Beyond Adventure Shop	Yes

PAYMENT TYPES ACCEPTED

Credit cards accepted	Visa, Diners, Amex and Mastercard
Currency	All major currencies accepted

DISCOVER PUNAKHA, BHUTAN
8Beyond Punakha River Lodge

Inclusions

RATE INCLUSIONS

Accommodation	✓
Three meals daily	✓
Soft drinks, house wines, local brand spirits and beers, teas and coffees, and refreshments	✓
Laundry	✓
Guided village walks, picnics and sundowners	✓
Gratuities for lodge staff	✓
Applicable government taxes	✓

RATE EXCLUSIONS

All items of personal nature	✓
Travel insurance	✓
Emergency medical evacuation insurance	✓
Monument fees and ground service costs	✓
Administration fees	✓
Telephone calls	✓
8Beyond Adventure Shop purchases	✓
Champagne, cognacs, fine wines, and premium brand spirits	✓
River rafting and kayaking activities	✓

NOTE: All Unmanned Aerial Vehicles (drones) are banned in Bhutan and will be confiscated on arrival.

Punakha is easily one of the most beautiful destinations in Bhutan. It's a must-visit. ”

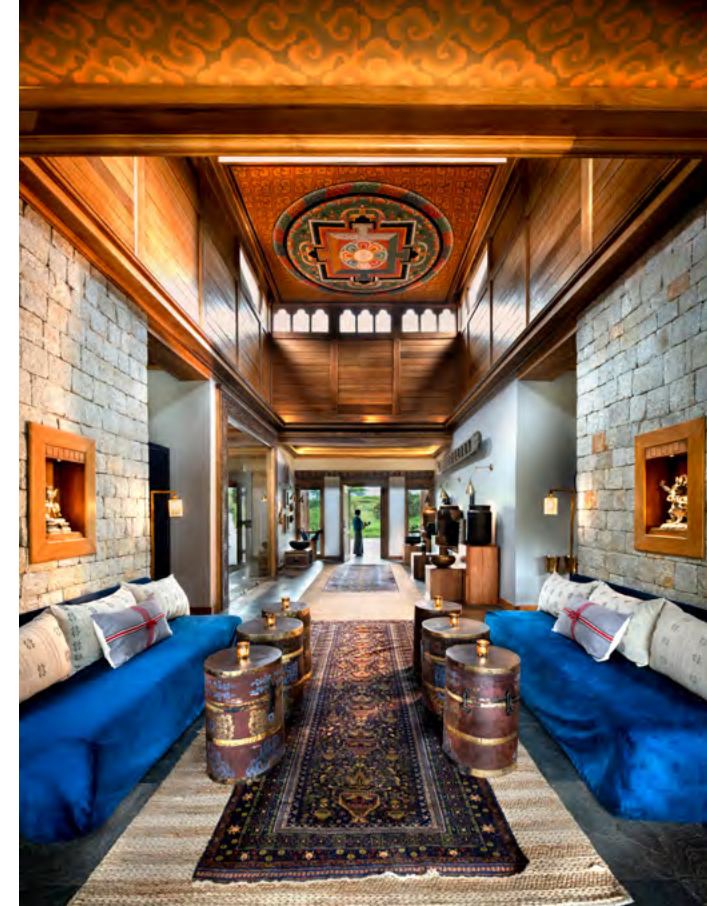

&BEYOND PUNAKHA RIVER LODGE

Accommodation

Intimate accommodation boasting never-ending views of the Mo Chu and Himalaya beyond.



DISCOVER PUNAKHA, BHUTAN
Beyond Punakha River Lodge Accommodation

Rich in culture and heritage

The lodge offers six Tented Suites, a River House and a Family Suite, all with an uninterrupted sightline to the Himalaya. Discover a true sense of place.



RIVER HOUSE PRIVATE PLUNGE POOL AND VERANDAH

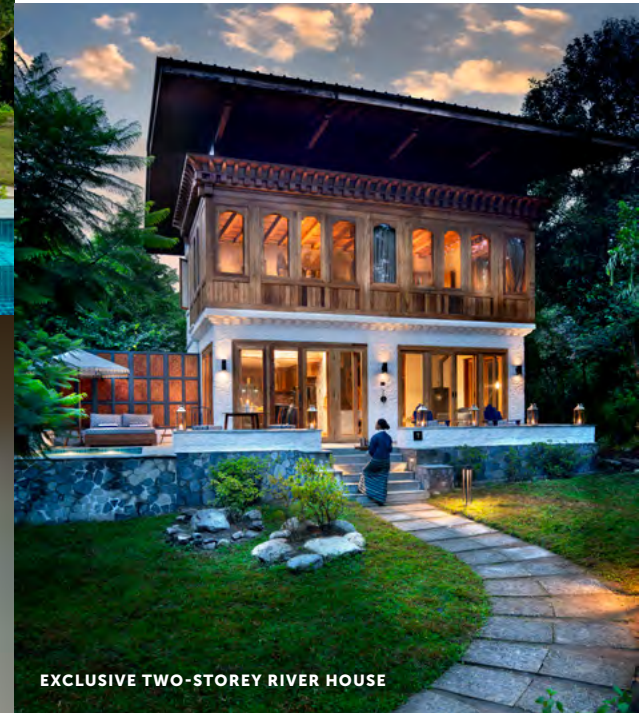

EXCLUSIVE TWO-STOREY RIVER HOUSE



BHUTANESE-INSPIRED ENSUITE TENTED SUITE BATHROOM

DISCOVER PUNAKHA, BHUTAN
Beyond Punakha River Lodge Accommodation

TENTED SUITE

6 Suites / Max. 2 guests per Suite



LUXURIOUSLY INTIMATE

Six safari-style Tented Suites are delicately suspended from a traditional Bhutanese timber structure, blending seamlessly into the natural surrounds. Cleverly positioned to ensure the utmost privacy, each suite features an ensuite bathroom with an indoor and outdoor shower plus a star bath, and a private verandah.

ROOM FACILITIES

Number of suites	6
Suite size (square metres)	89 m ² (958 ft ²) for the room and bathroom
Suite configuration	One bedroom with an ensuite bathroom with an indoor and outdoor shower and star bath, plus a private outdoor verandah
Private verandah	Yes
Private plunge pool	No
Personal bar or coffee station	No, but there is a coffee plunger in each suite
Air conditioning / heating	Yes
Overhead fans	No
Mosquito nets	No
Bath	Yes
Indoor and outdoor shower	Yes
Separate WC	Yes
Telephone	Yes
Hairdryer	Yes
Internet access	Yes
In-room safe	Yes
Plug type	220V AC Plug Type D, F and G Adapters available
Triple bed option	Yes, for children 3 – 16 years, sharing with one or two adults Subject to availability
Twin bed option	Yes, however, beds are within the same bedframe
Double bed option	Yes
Wheelchair accessibility	No

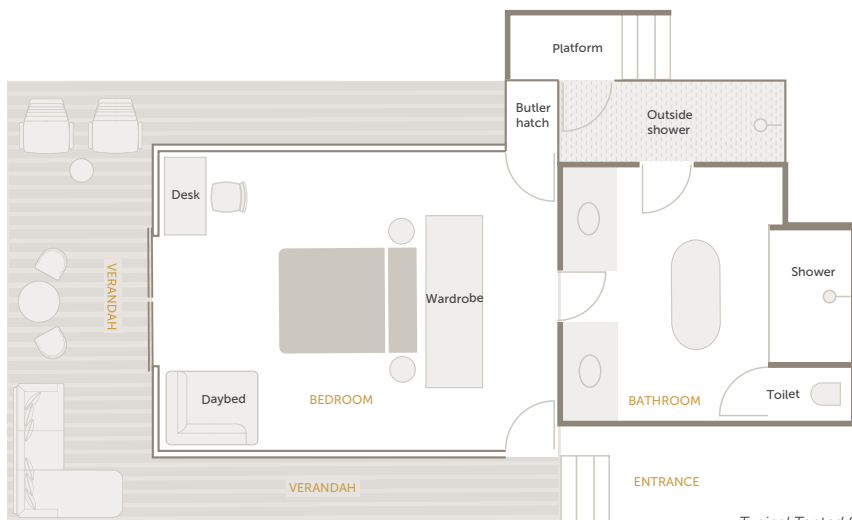

Typical Tented Suite layout

Cots (for children 0 – 2 years) subject to availability, sharing with one or two adults

DISCOVER PUNAKHA, BHUTAN
Beyond Punakha River Lodge Accommodation

RIVER HOUSE

1 bedroom / Max. 2 guests



RIVER ROMANCE
Set along a peaceful perennial stream with unrivalled Himalaya views, the exclusive River House is designed for couples. Comprising two levels, the suite's ground floor hosts a spacious lounge and dining area while upstairs boasts a lavish bedroom with an open ensuite bathroom. A private plunge pool and outdoor verandah complete the space.

ROOM FACILITIES

Number of house	1
Number of rooms in house	1
House size (square metres)	150 m ² (1 615 ft ²) Two levels
House configuration	Ground floor: Lounge and dining room area, kitchen, outdoor private verandah, plunge pool and bathroom First floor: One bedroom with an ensuite bathroom with a standalone bath
Private verandah	Yes
Private plunge pool	Yes
Personal bar	Yes
Personal coffee station	Yes
Air conditioning / heating	Yes
Overhead fans	Yes
Mosquito nets	No
Bath	Yes
Indoor shower	Yes
Outdoor shower	No
Separate WC	Yes
Telephone	Yes
Hairdryer	Yes
Internet access	Yes
In-room safe	Yes
Plug type	220V AC Plug Type D, F and G Adapters available
Triple bed option	Yes
Twin bed option	No
Double bed option	Yes
Wheelchair accessibility	No

GROUND FLOOR

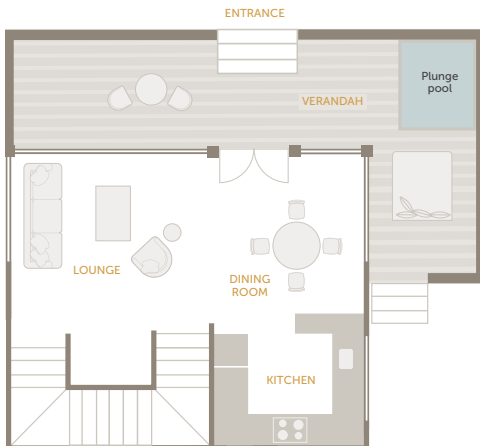

FIRST FLOOR

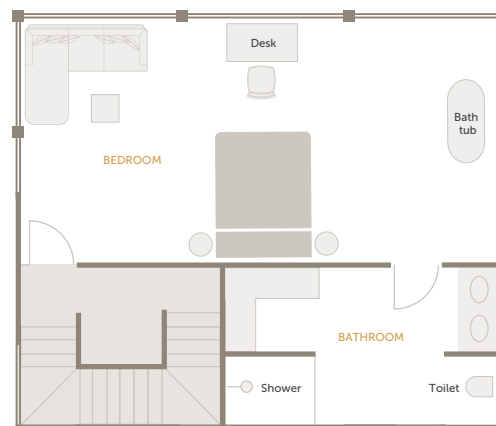

DISCOVER PUNAKHA, BHUTAN
Beyond Punakha River Lodge Accommodation

Full of family-fun

FAMILY SUITE

2 interleading bedrooms
Max. 4 guests per Family Suite

Spend your family fun-filled holiday at the lodge's Family Suite, comprising two interconnected suites each with its own ensuite bathroom, and private outdoor verandah and shower. The suite also features a spacious shared lounge area, personalised bar, outdoor verandah and sparkling swimming pool.

Ideally positioned with a view of the Khamsum Yuelley Namgyal Chorten amidst paddy fields, the suite is secluded enough to ensure family-time is a priority but also close enough to the lodge for everyone to enjoy the main guest area with its world-class facilities and exciting activities.



SPACIOUS FAMILY LOUNGE AREA



INTERCONNECTED SUITE WITH PRIVATE VERANDAH

DISCOVER PUNAKHA, BHUTAN
 Beyond Punakha River Lodge Accommodation

FAMILY SUITE FACILITIES

Number of suites	1
Number of rooms in suite	2
Suite size (square metres)	310 m ² (3 337 ft ²)
Suite configuration	Two interconnected suites with its own living room, personalised bar, outdoor verandah and pool. The suites also have a private sunken outdoor verandah and shower.
Private verandah	Yes
Private plunge pool	Yes
Personal bar	Yes
Personal coffee station	Yes
Air conditioning / heating	Yes
Overhead fans	Yes
Mosquito nets	No
Bath	Yes
Indoor shower	Yes
Outdoor shower	Yes
Separate WC	Yes
Telephone	Yes
Hairdryer	Yes
Internet access	Yes
In-room safe	Yes
Plug type	220V AC Plug Type D, F and G Adapters available
Triple bed option	Yes
Twin bed option	Yes
Double bed option	Yes
Wheelchair accessibility	Yes, with assistance

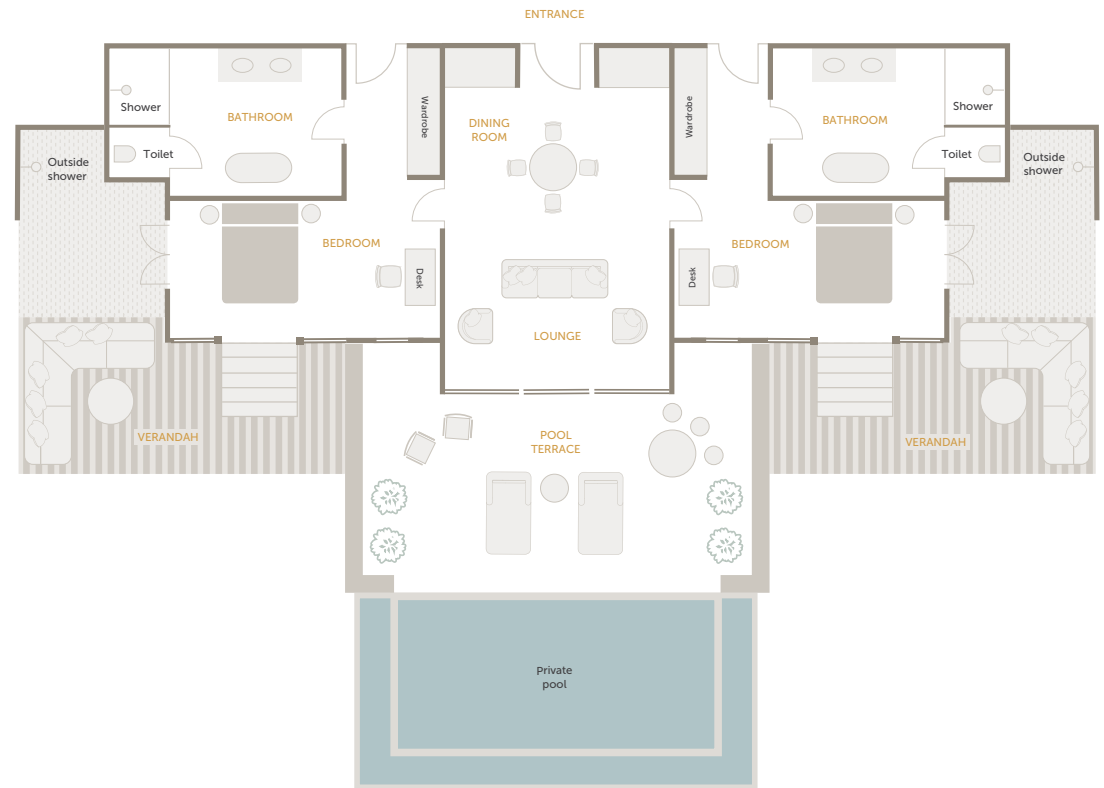

Maximum four adults or two adults and two children (three children on request – third child must be 3 – 16 years old)

Cots (for children 0 – 2 years) subject to availability, sharing with one or two adults

Accommodation comparison

	TENTED SUITE	RIVER HOUSE	FAMILY SUITE
Number of rooms	6	1	2
Room size (square metres)	89 m ² (958 ft ²) for the suite and bathroom	150 m ² (1 615 ft ²) Two levels	310 m ² (3 337 ft ²)
Room configuration	One bedroom with an ensuite bathroom with an indoor and outdoor shower and star bath, plus a private outdoor verandah	Ground floor: Lounge and dining room area, kitchen, outdoor private verandah, plunge pool and bathroom First floor: One bedroom with an ensuite bathroom with a standalone bath	Two interconnected suites with its own living room, personalised bar, outdoor verandah and pool The suites also have a private sunken outdoor verandah and shower
Private verandah	Yes	Yes	Yes
Private plunge pool	No	Yes	Yes
Personal bar	No	Yes	Yes
Personal coffee station	No, but there is a coffee plunger in each suite	Yes	Yes
Air conditioning / heating	Yes	Yes	Yes
Overhead fans	No	Yes	Yes
Mosquito nets	No	No	No
Bath	Yes	Yes	Yes
Indoor shower	Yes	Yes	Yes
Outdoor shower	Yes	No	Yes
Separate WC	Yes	Yes	Yes
Telephone	Yes	Yes	Yes
Hairdryer	Yes	Yes	Yes
Internet access	Yes	Yes	Yes
In-room safe	Yes	Yes	Yes
Plug type	220V AC Plug Type D, F and G Adapters available	220V AC Plug Type D, F and G Adapters available	220V AC Plug Type D, F and G Adapters available
Triple bed option	Yes, for children 16-years or younger only Can accommodate a crib or extra bed	Yes	Yes
Twin bed option	Yes	No	Yes
Double bed option	Yes	Yes	Yes
Wheelchair accessibility	No	No	Yes, with assistance



andBEYOND



@andbeyondtravel
#seewhatliesbeyond

andBeyond.com